

METAL BRACKETS

PART NUMBER	DESCRIPTION	STEEL	COATING	GAUGE	MOUNTING BOLT SIZE	WEIGHT lb./pc (g)	PCS PER BAG/CARTON
RTCBES10-TL	RANGE TAKING CLAMP FLAT BRACKET	ASTM A572 GRADE 50	CLEAR ZINC	14 GA	3/8" (M10)	0.13 (57.4)	250 (CARTON)
RTCBE90S10-C	RANGE TAKING CLAMP 90 DEGREE BRACKET			14 GA		0.16 (71.4)	100 (CARTON)

PLASTIC MOUNTS

PART NUMBER	DESCRIPTION	MATERIAL	COLOR	USE WITH CABLE TIES	WEIGHT lb./100 pc (g)	PCS PER BAG/CARTON
RTCM3EBL-L350	RANGE TAKING CLAMP MOUNT WITH 3" CRADLE	NYLON 6.6 HS, WR & IM	BLACK	S, LH, H & EH	3.35 (1,520)	50 (BAG) 500 (CARTON)

RTCBES10-TL

RTCBE90S10-C

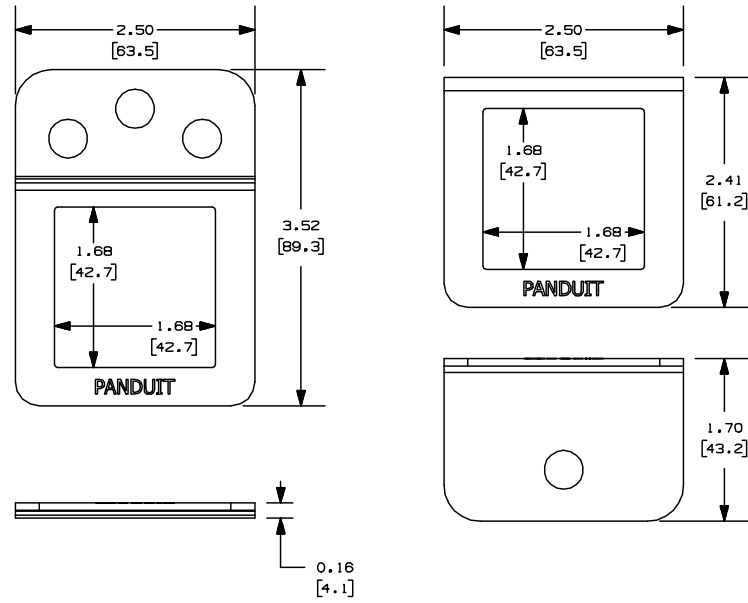

RTCM3EBL-L350

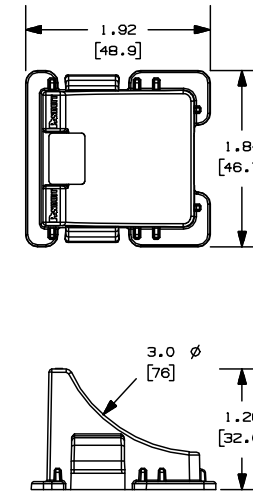

TITLE									
RANGE TAKING CLAMP									
CUSTOMER DRAWING									
ITEM REVISION NAME					01071EAA/00				
DATASET FILE NAME					01071EAA_DC/00				
PANDUIT									
UNLESS OTHERWISE SPECIFIED, DIMENSIONAL TOLERANCES ARE: IN [mm]									
.x ± .1 [2.54]					.xxx ± .005 [.127]				
.xx ± .01 [.25]					ANGLES ± 1°				
DRAWING NUMBER: 01071EAA_DC									
THIRD ANGLE PROJECTION									
DRAWN BY		DATE		CHK		SCALE		SIZE	
DJSL		1/24/22		ALP		NONE		B	
SHT 1 OF 1									

REV	DATE	BY	CHK	APR	DESCRIPTION	ECN
00	1/24/22	DJSL	RMHI	ALP	DRAWING RELEASED	115545/00

NXGLOBAL_BSIZE