

LOC	DIST	REVISIONS			
P	LTN	DESCRIPTION	DATE	DWN	APVD
GP	00				
	D1	REVISED PER ECO-11-004835	11MAR2011	RK	HMR
	E	REVISED PER ECO-14-000886	20FEB2014	JW	SH
	E1	REVISED PER ECO-14-004667	26MAR2014	JW	SH
	E2	REVISED PER ECO-14-010419	11JUL2014	JW	SH

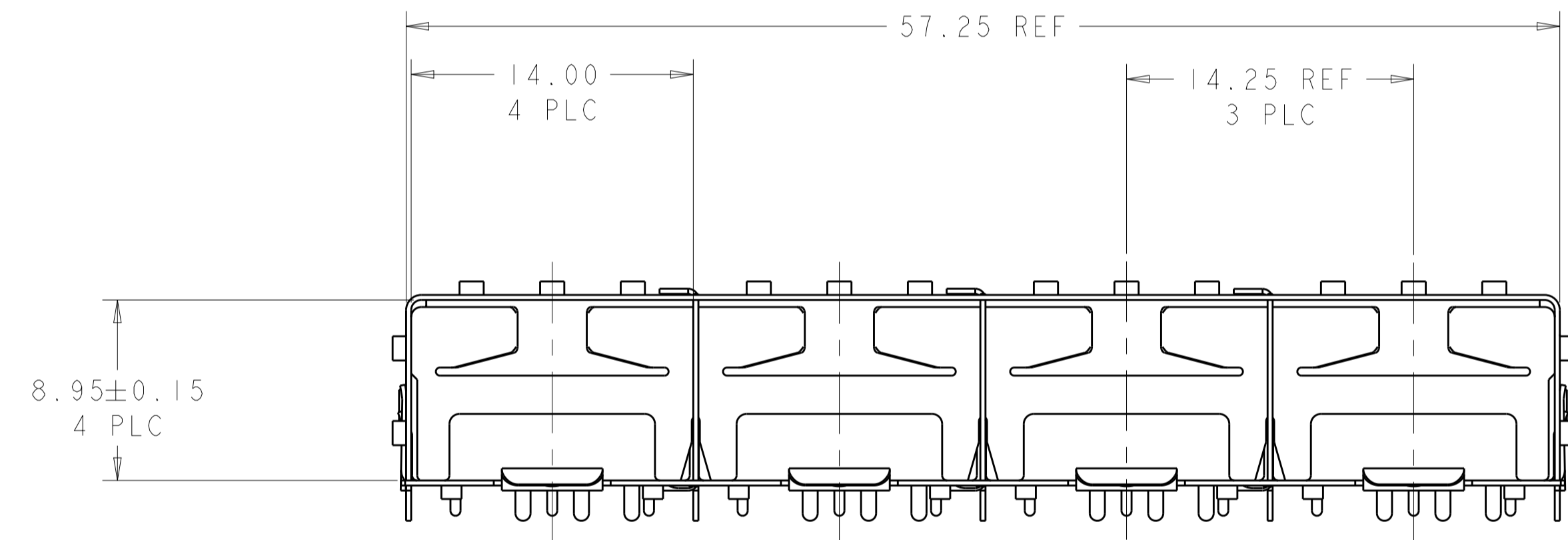

- △ MATERIAL: 0.25MM THICK COPPER ALLOY.
- △ FINISH: 1.25µm MINIMUM TIN PER ASTM B 545 OVER NICKEL FLASH PER QQ-N-290. NONPLATED EDGES PERMISSIBLE.
- △ PADS AND VIAS CHASSIS GROUND.
- △ DATUM AND BASIC DIMENSION ESTABLISHED BY CUSTOMER.
- △ COMPANY LOGO IN APPROXIMATE AREA SHOWN.
- △ DATE CODE AND PART NUMBER IN APPROXIMATE AREA SHOWN.
- △ MATERIAL: 0.25MM THICK NICKEL SILVER ALLOY,
- △ FINISH: 0.002 MM MIN TIN DIPPED ON SOLDER PINS

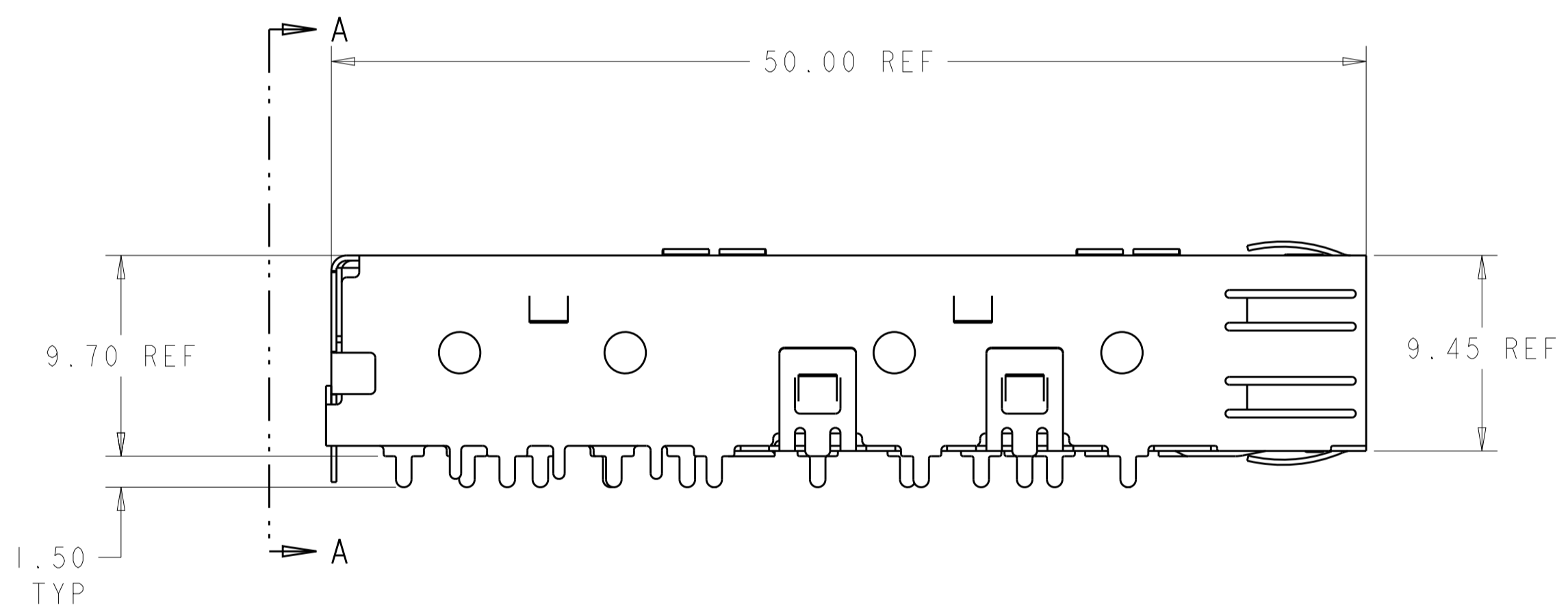
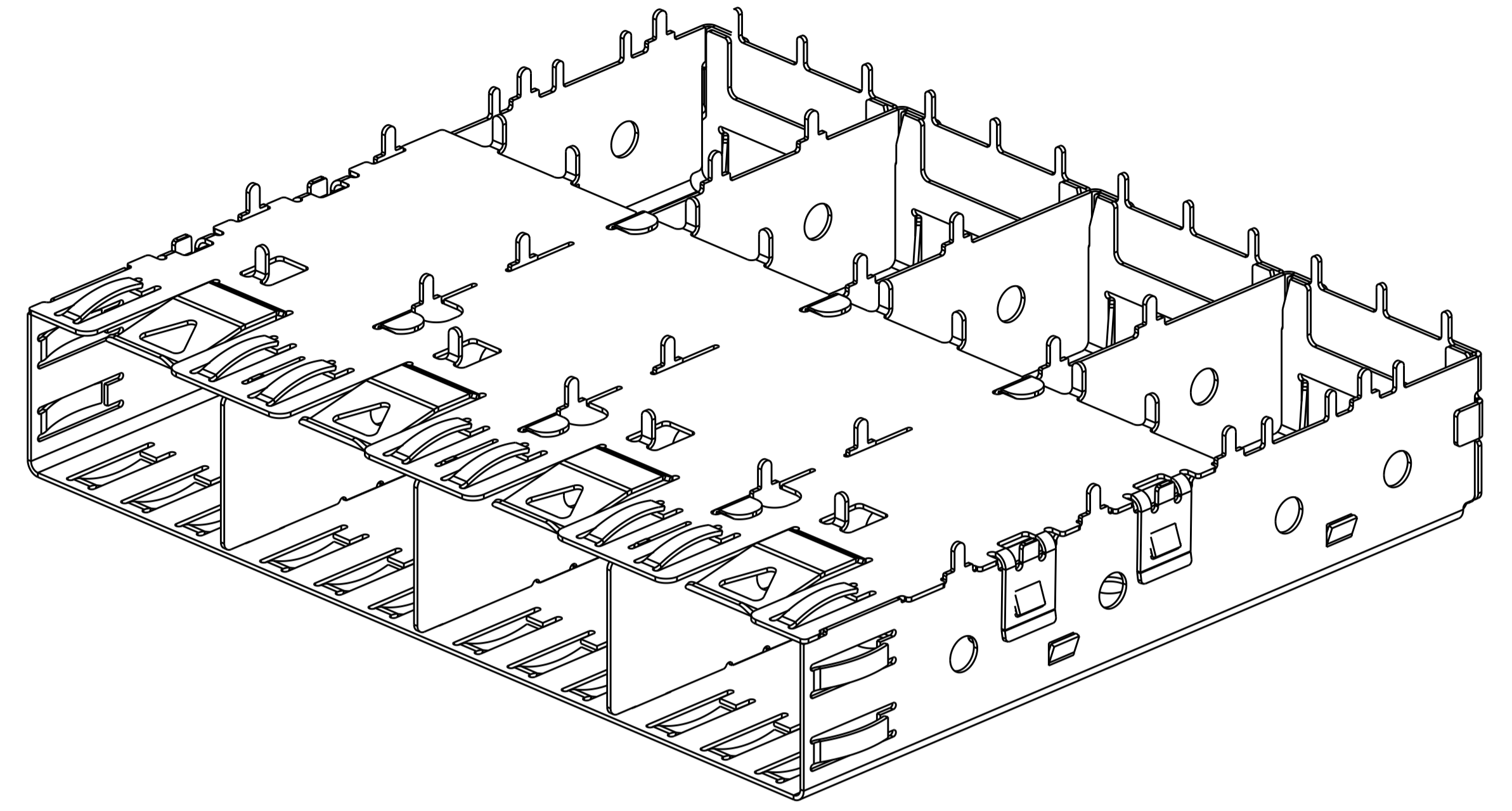
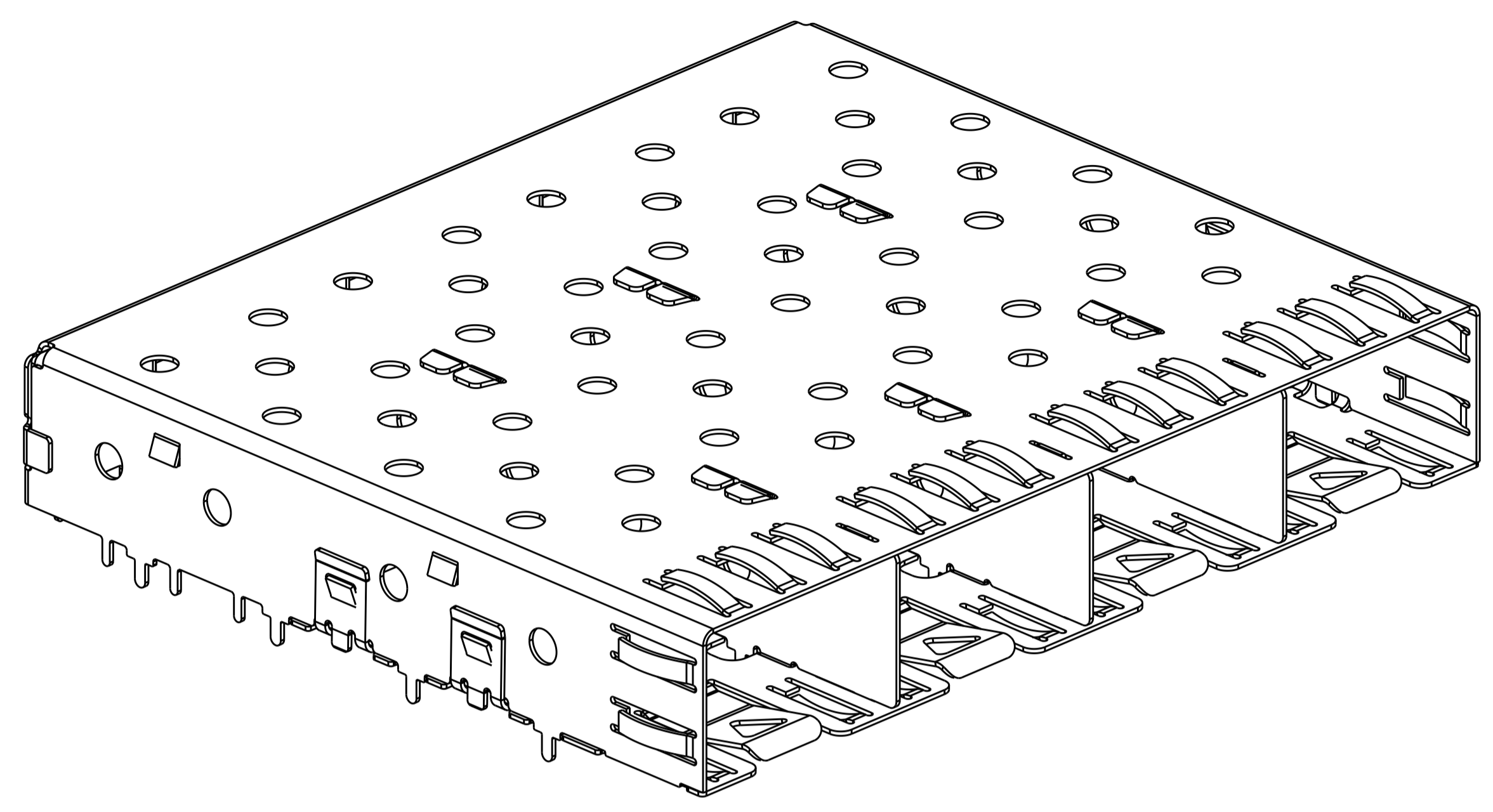
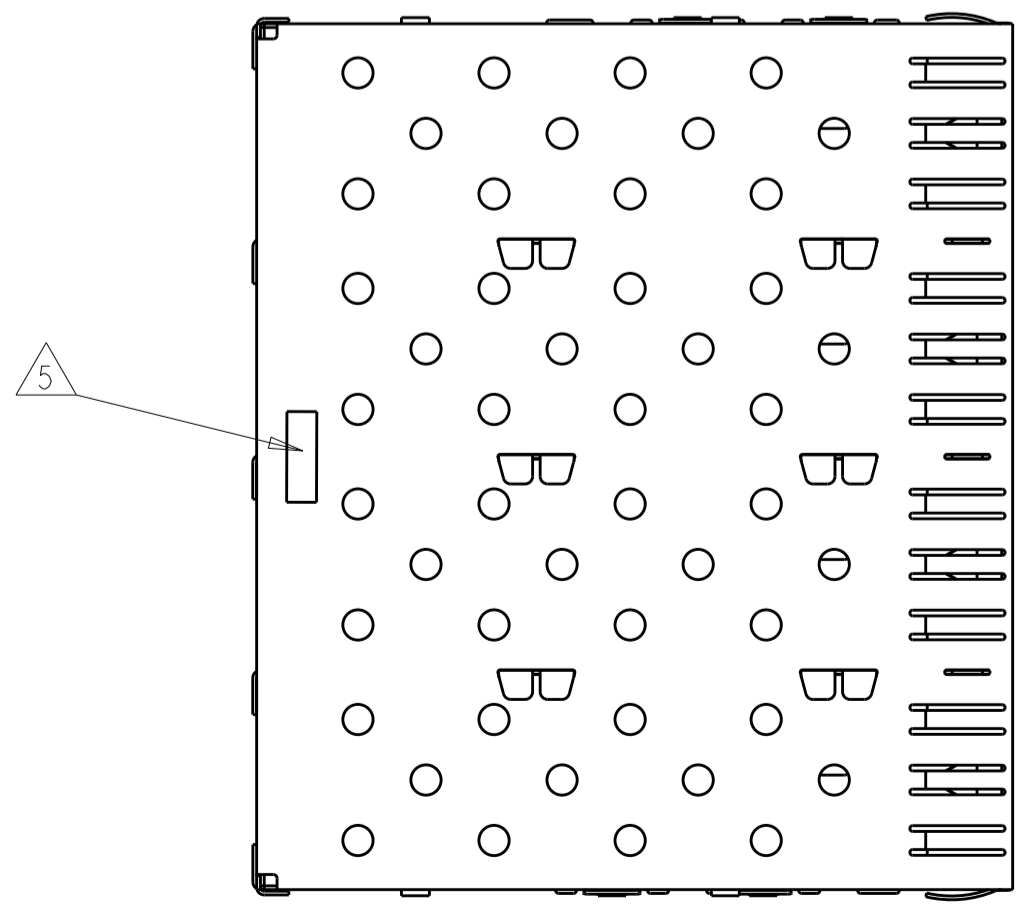

SCALE 2:1

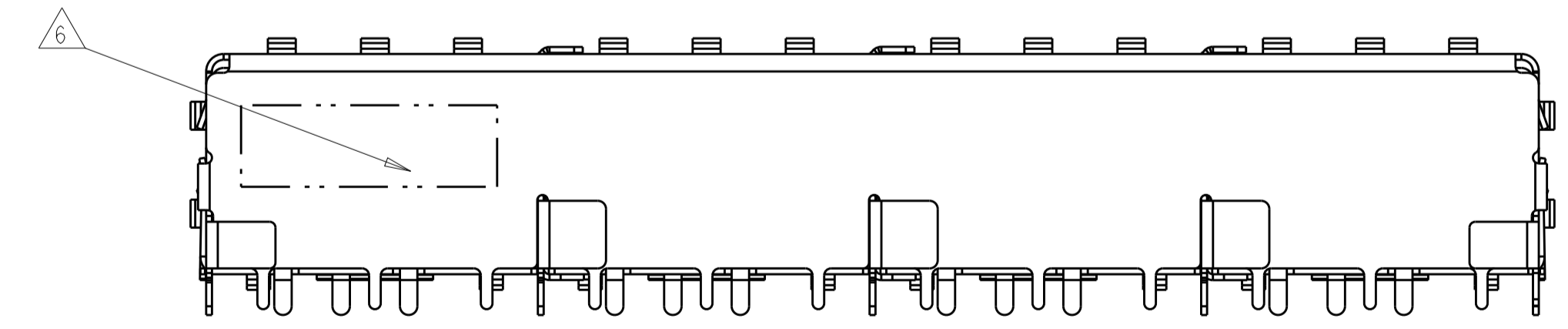

SECTION A-A

NO	△	1658723-2
△	△	1658723-1
FINISH	MATERIAL	PART NUMBER

THIS DRAWING IS A CONTROLLED DOCUMENT.		DWN	M. SHIRK	13MAY03
DIMENSIONS:		CHK	J. KOPPENHEFFER	06MAY04
mm	0 PLC ±	APVD	M. WALMSLEY	06MAY04
	1 PLC ±0.10	NAME		
	2 PLC ±	PRODUCT SPEC		
	3 PLC ±	108-1950		
	4 PLC ±	APPLICATION SPEC		
	ANGLES ±	SIZE CAGE CODE DRAWING NO		
		114-13017		
MATERIAL	FINISH	WEIGHT		
△	△	A100779C=1658723		
CUSTOMER DRAWING		RESTRICTED TO		
		SCALE	4:1	SHEET 1 OF 2 REV E2

LOC		DIST		REVISONS			
GP	00	P	LTM	DESCRIPTION	DATE	OWN	APVD
				SEE SHEET 1			

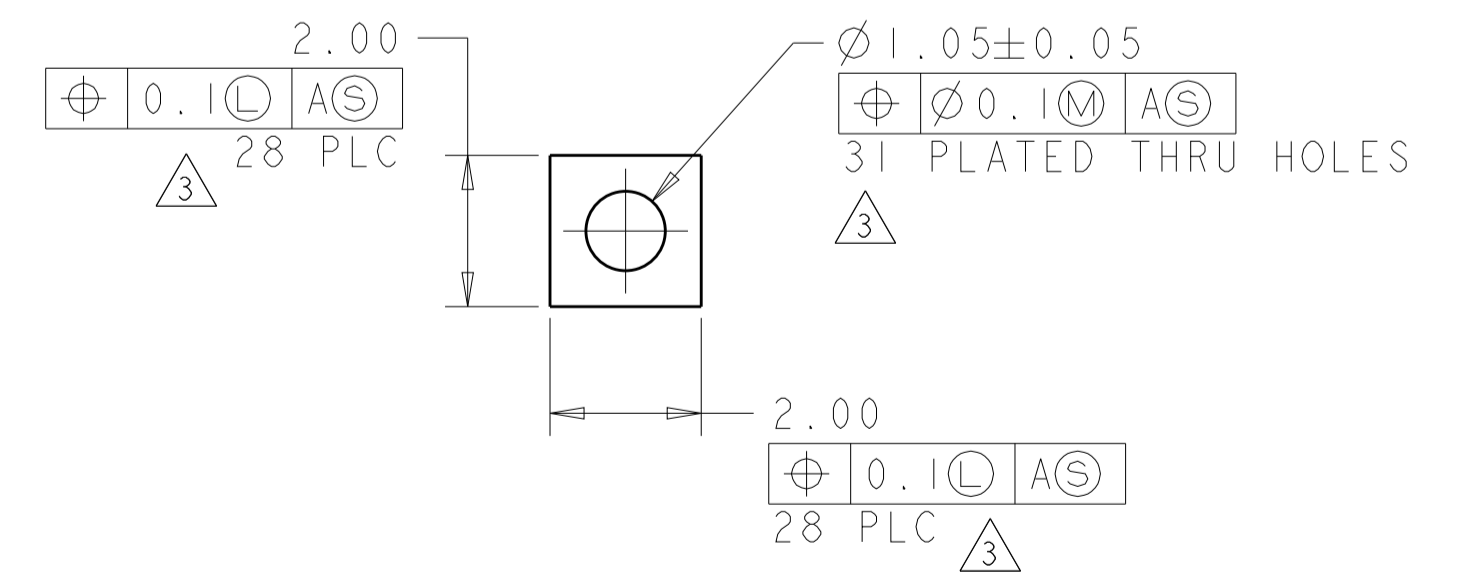
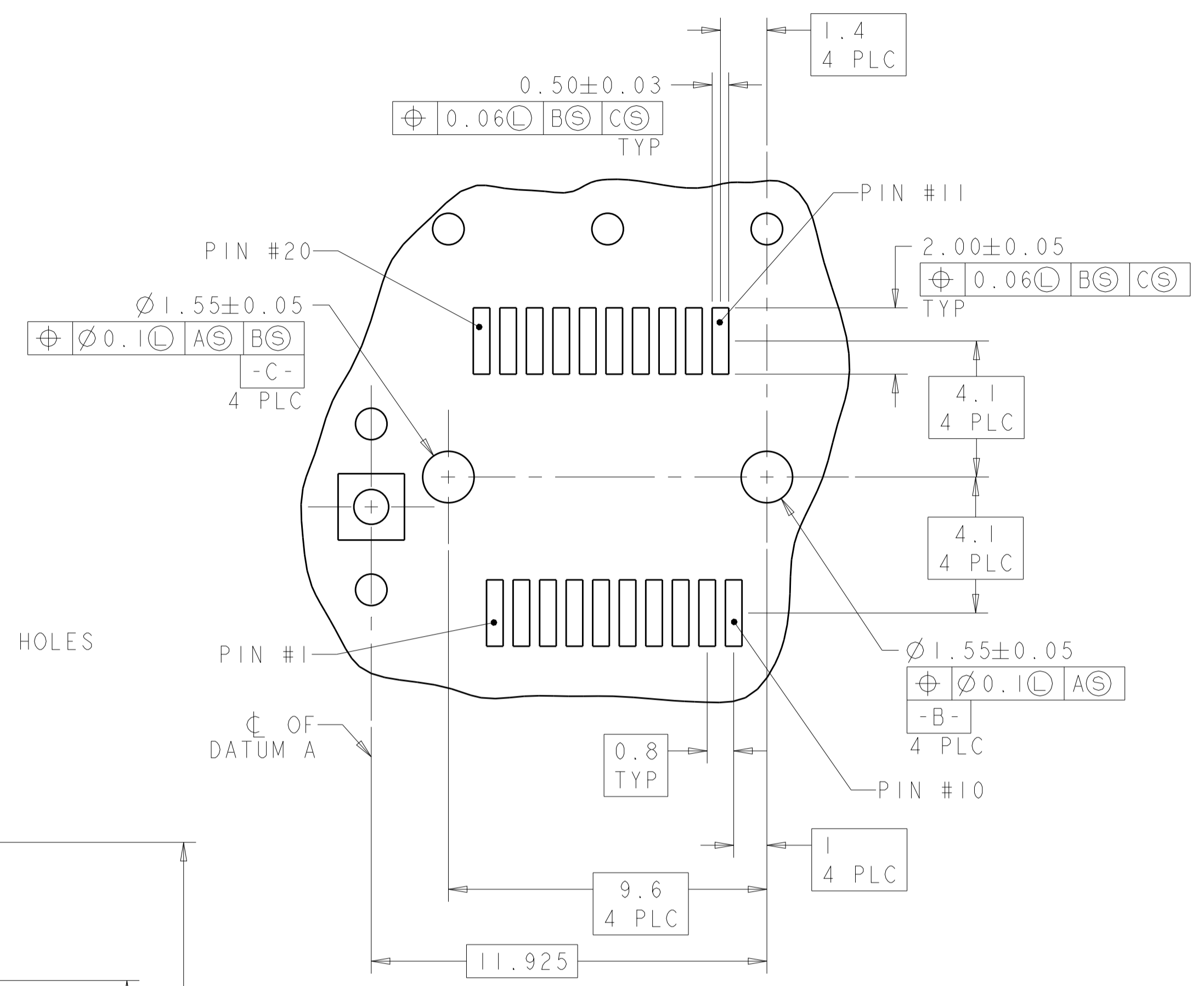
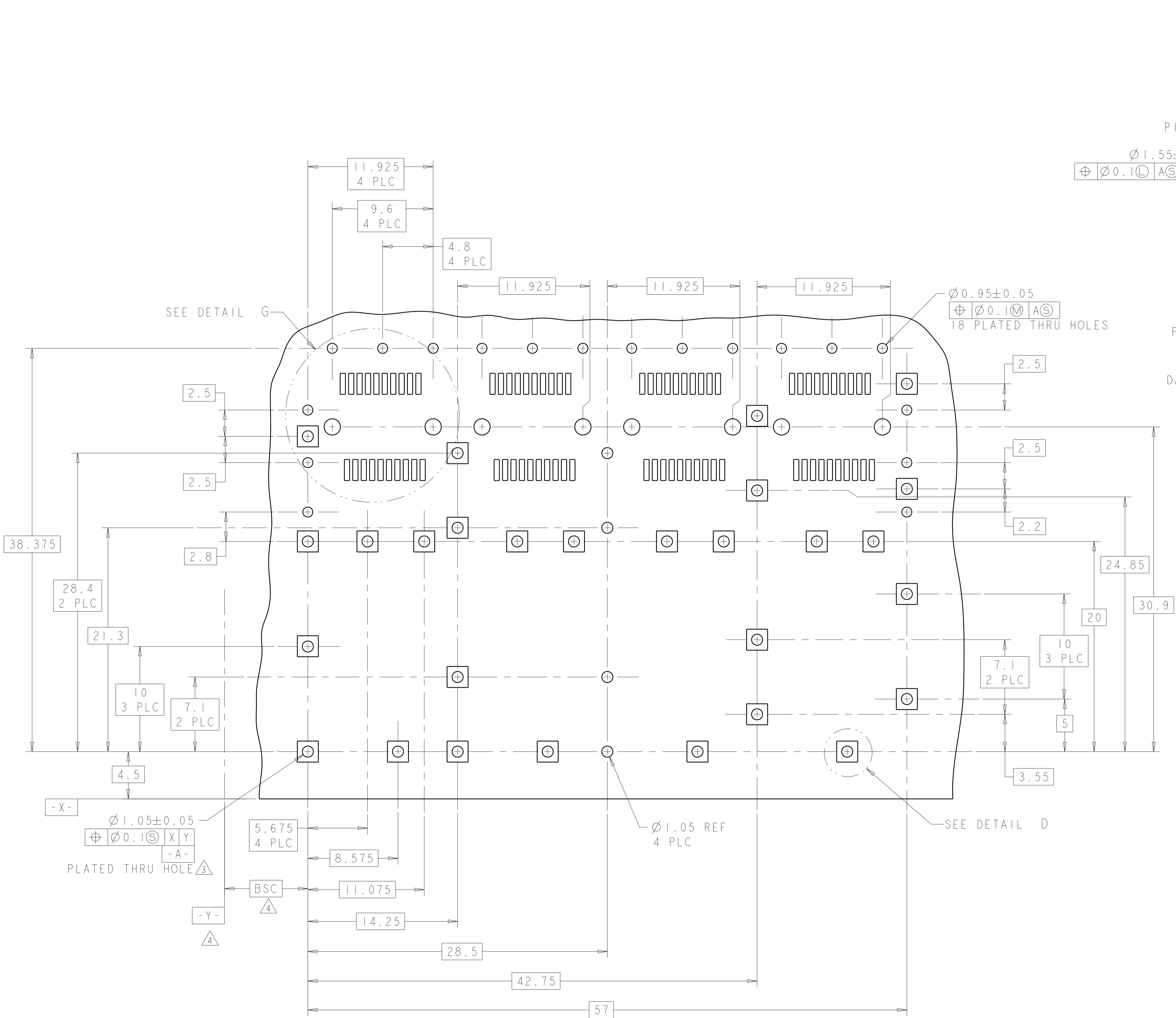

RECOMMENDED PCB LAYOUT
 SCALE 5:1

THIS DRAWING IS A CONTROLLED DOCUMENT.		OWN	M. SHIRK	13MAY03	TE Connectivity
DIMENSIONS:		CHK	J. KOPPENHEFFER	06MAY04	
mm		APVD	M. WALMSLEY	06MAY04	NAME
0 PLC ± 1 PLC ± 2 PLC ±0.10 3 PLC ± 4 PLC ± ANGLES ±	TOLERANCES UNLESS OTHERWISE SPECIFIED: 0 PLC ± 1 PLC ± 2 PLC ±0.10 3 PLC ± 4 PLC ± ANGLES ±	PRODUCT SPEC	108-1950		CAGE CODE
MATERIAL	FINISH	APPLICATION SPEC	114-13017		DRAWING NO
		WEIGHT			A100779C=1658723
		CUSTOMER DRAWING	SCALE	4:1	SHEET 2 OF 2