

APPROVED: _____
 DATE: _____ TITLE: _____

| Rev | AWO # | Description | Date | Appr |
|-----|-------|---------------------------|----------|-------|
| - | | RELEASED | 6/6/18 | |
| A | | ADD O-RING SPEC. | 04/27/20 | TW |
| B | | UPDATE TITLE SPEC. & DIM. | 8/7/20 | AY/RC |
| C | | UPDATED DRAWING | 5/4/22 | JJ/KL |

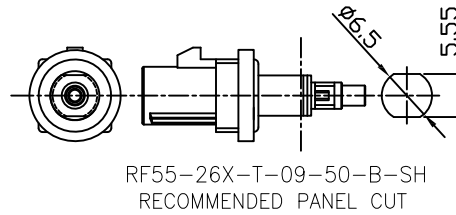

| Type | Color | For Cable | Item No |
|------|-----------------|--------------------------|-----------------------|
| A | BLACK | 1.13/1.32 1.37mm Dia. | RF55-26A-T-09-50-X-SH |
| B | WHITE | | RF55-26B-T-09-50-X-SH |
| C | BLUE | | RF55-26C-T-09-50-X-SH |
| D | BORDEAUX VIOLET | | RF55-26D-T-09-50-X-SH |
| E | GREEN | | RF55-26E-T-09-50-X-SH |
| F | BROWN | | RF55-26F-T-09-50-X-SH |
| G | GREY | | RF55-26G-T-09-50-X-SH |
| H | VIOLET | | RF55-26H-T-09-50-X-SH |
| I | BEIGE | | RF55-26I-T-09-50-X-SH |
| K | CURRY | | RF55-26K-T-09-50-X-SH |
| Z | WATER BLUE | | RF55-26Z-T-09-50-X-SH |
| L | CARMINE RED | | RF55-26L-T-09-50-X-SH |
| M | PASTEL ORANGE | | RF55-26M-T-09-50-X-SH |
| N | PASTEL GREEN | | RF55-26N-T-09-50-X-SH |

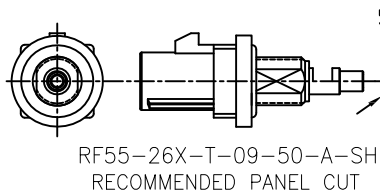
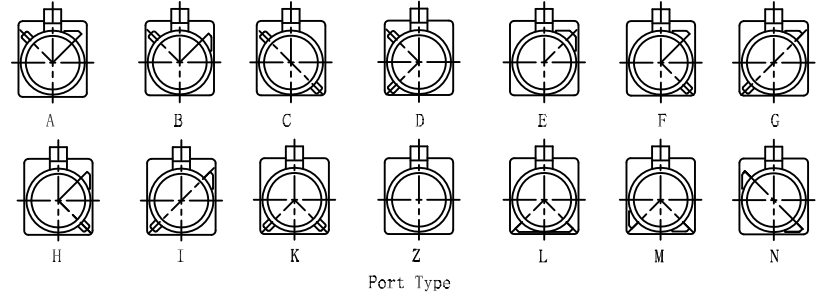
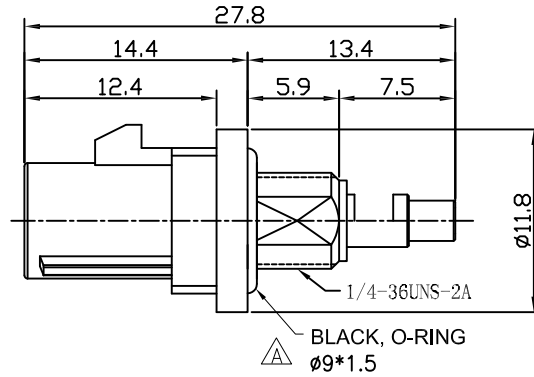
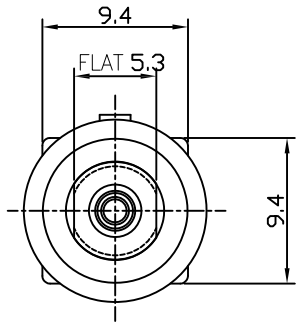
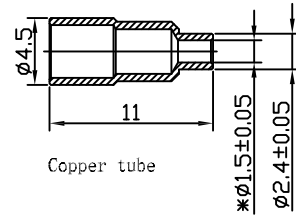
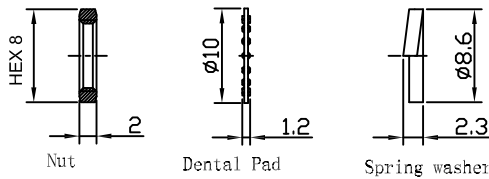

| DESCRIPTION | MATERIAL | FINISH |
|---------------|------------------|---------------------|
| O-RING | BLACK SILICA GEL | |
| PLASTIC SHELL | PA66+30%GF | |
| COPPER TUBE | BRASS | NICKEL |
| INSULATOR | PTFE | |
| PIN CONTACT | BRASS | GOLD |
| BODY | BRASS | TRREE ELEMENT ALLOY |

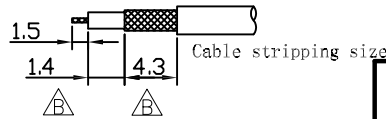

SPECIFICATIONS:
 Electrical:
 Frequency range: DC~6 GHz
 Nominal Impedance: 50 ohms
 Withstanding voltage: 335 V
 Insulator Resistance: 1000 MΩ
 Contact Resistance: 6 Milliohms max. (Center Contact)
 1 Milliohms max. (Outer Contact)

Temperature Rating:
 Operating temperature: -40°C to +85°C
 Environmental:
 Lead free, RoHS compliant.



See sht 2 for assembly instructions

UNLESS OTHERWISE SPECIFIED ALL DIMENSIONS ARE INCHES [MM]. TOLERANCES: EXCEPT AS NOTED

| INCHES | | HOLES | |
|--------|-------|-------|-------|
| .X | ±.10 | Ø.X | ±.10 |
| .XX | ±.020 | Ø.XX | ±.015 |
| .XXX | ±.015 | Ø.XXX | ±.010 |

| | | |
|----------|----|--------|
| DRAWN | AY | 6/6/18 |
| CHECKED | MY | 6/6/18 |
| APPROVED | | |

THIS DRAWING CONTAINS INFORMATION THAT IS PROPRIETARY AND SHOULD NOT BE USED WITHOUT PRIOR WRITTEN PERMISSION FROM ADAM TECH



909 Rahway Avenue,
 Union, NJ 07083
 Phone: 908-687-5000
 Fax: 908-687-5710

TITLE
FAKRA PLUG SMB TYPE STRAIGHT, BULKHEAD (IP67)

| SIZE | PART NO. | REV. |
|------|-----------------------|-------------------------|
| X | RF55-26X-T-09-50-X-SH | C |
| REF: | S00134C | SCALE: NTS SHEET 1 OF 2 |

4

3

2

1

Rev

AWO #

Description

Date

Appr

SEE SHT 1 OF 2 FOR REVISION

FAKRA connector cable assembly instructions

STEP 1 PARTS NEEDED

A = Fakra Connector B = Metal Sleeve C = Heat Shrink Tubing
(customer supplied)

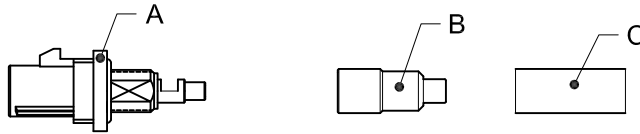

STEP 2 Strip Cable per below stripping lengths
Conductor 1.5mm / Dielectric 1.2mm / Braid 3.2mm

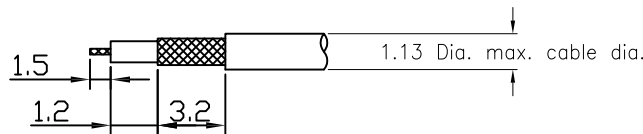

STEP 3 Slide cable through metal sleeve "B" and heat shrink "C"

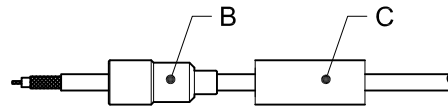

STEP 4 Insert cable into back of connector and solder conductor

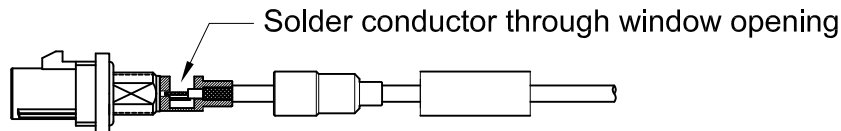

STEP 5 Slide metal sleeve "B" over back of connector.

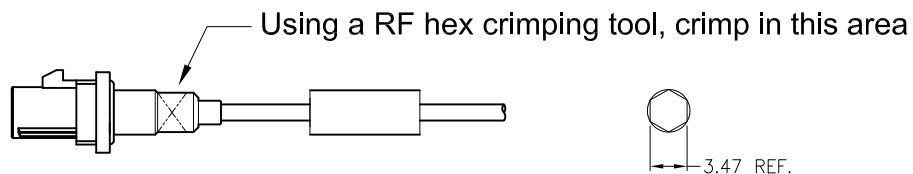

STEP 6 Slide heat Shrink over back of connector and heat with heat gun

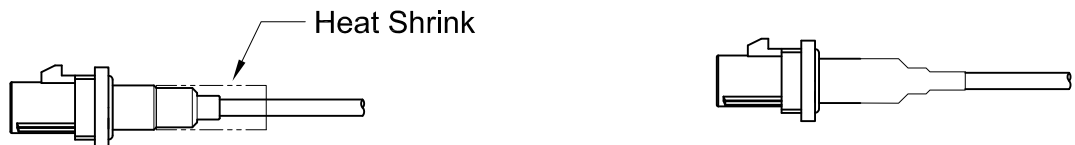

UNLESS OTHERWISE SPECIFIED ALL DIMENSIONS
ARE INCHES [MM]. TOLERANCES: EXCEPT AS NOTED

| INCHES | | HOLES | |
|--------|--------|-------|--------|
| .X | ± .10 | ∅X | ± .10 |
| .XX | ± .020 | ∅XX | ± .015 |
| .XXX | ± .015 | ∅XXX | ± .010 |

ADAM
TECH

909 Rahway Avenue,
Union, NJ 07083
Phone: 908-687-5000
Fax: 908-687-5710

| | | |
|----------|----|--------|
| DRAWN | AY | 6/6/18 |
| CHECKED | MY | 6/6/18 |
| APPROVED | | |

TITLE

FAKRA PLUG SMB TYPE STRAIGHT, BULKHEAD (IP67)

THIS DRAWING CONTAINS INFORMATION THAT IS PROPRIETARY
AND SHOULD NOT BE USED WITHOUT PRIOR WRITTEN
PERMISSION FROM ADAM TECH

SIZE
X

PART NO.

RF55-26X-T-09-50-X-SH

REV.
C

REF: S00134C

SCALE: NTS

SHEET 2 OF 2

4

3

2

1