

THIS DRAWING IS UNPUBLISHED. RELEASED FOR PUBLICATION
 © COPYRIGHT - By - ALL RIGHTS RESERVED.

| REVISIONS | | | | | |
|-----------|-----|---------------------------|-----------|-----|------|
| P | LTR | DESCRIPTION | DATE | DWN | APVD |
| | AK | REVISED PER ECR-19-015400 | 14OCT2019 | PC | SE |

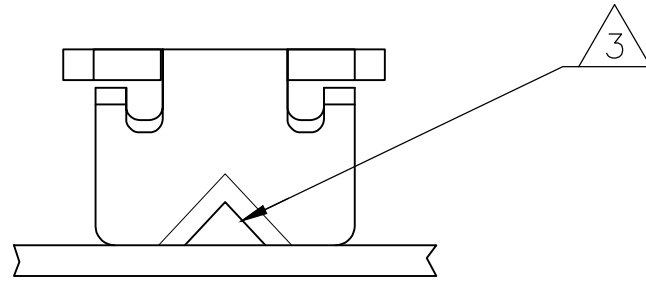

- 1 CONTINUOUS STRIP ON REELS WITH TERMINALS LOCATED ON 5.59±0.08 [.220±.003] CENTERS.
- 2 SLOT ACCEPTS EITHER A SINGLE OR DOUBLE MAGNET WIRE OF THE SAME SIZE AND TYPE.
COPPER RANGE 0.36-0.57mm [#27-#23 AWG].
ALUMINUM RANGE 0.51-0.64mm [#24-#22 AWG].
ALUMINUM WIRE RANGE IS APPLICABLE FOR POST TIN PLATED PART NUMBERS ONLY
- 3 POKE-IN ACCEPTS A 0.50-0.90mm? [#20-#18] AWG SOLID OR FUSED STRANDED LEAD WIRE.
- 4 SPECIAL REEL QUANTITY - SPAIN PRODUCTION ONLY.
- 5 PRELIMINARY - NOT FOR PRODUCTION.
- 6 NON-US PRODUCTION ONLY.
- 7 PREPRODUCTION - FASR REQUIRED

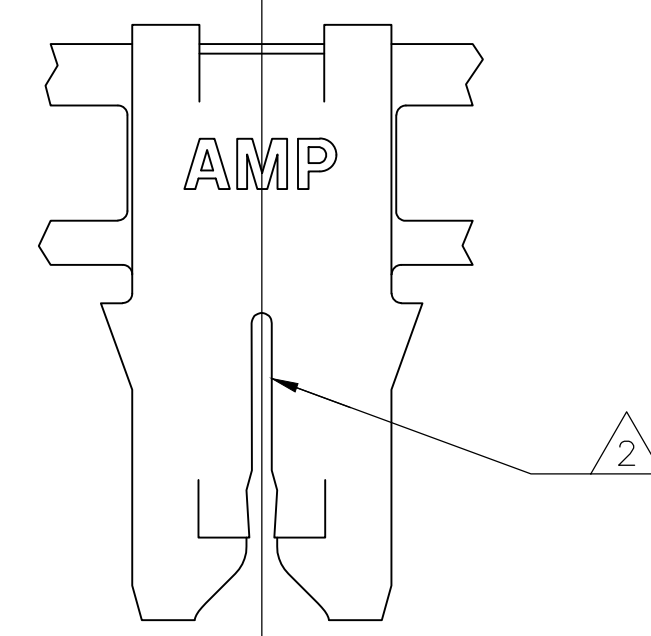
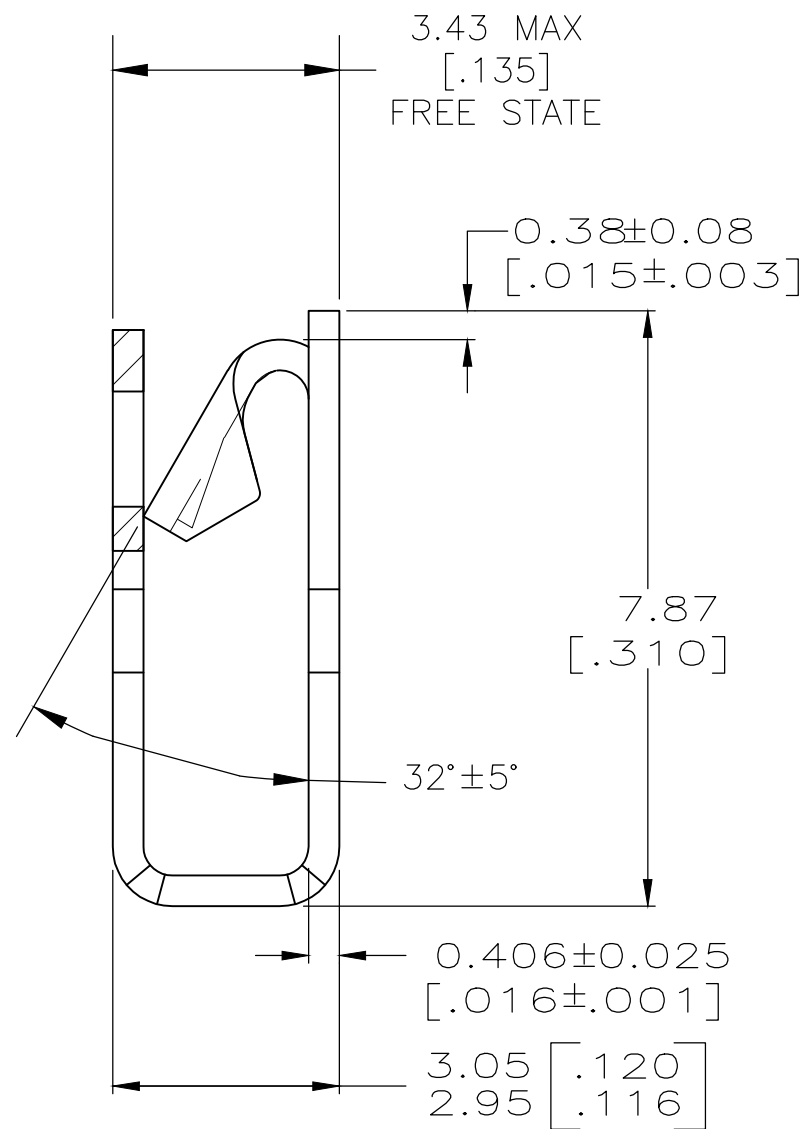
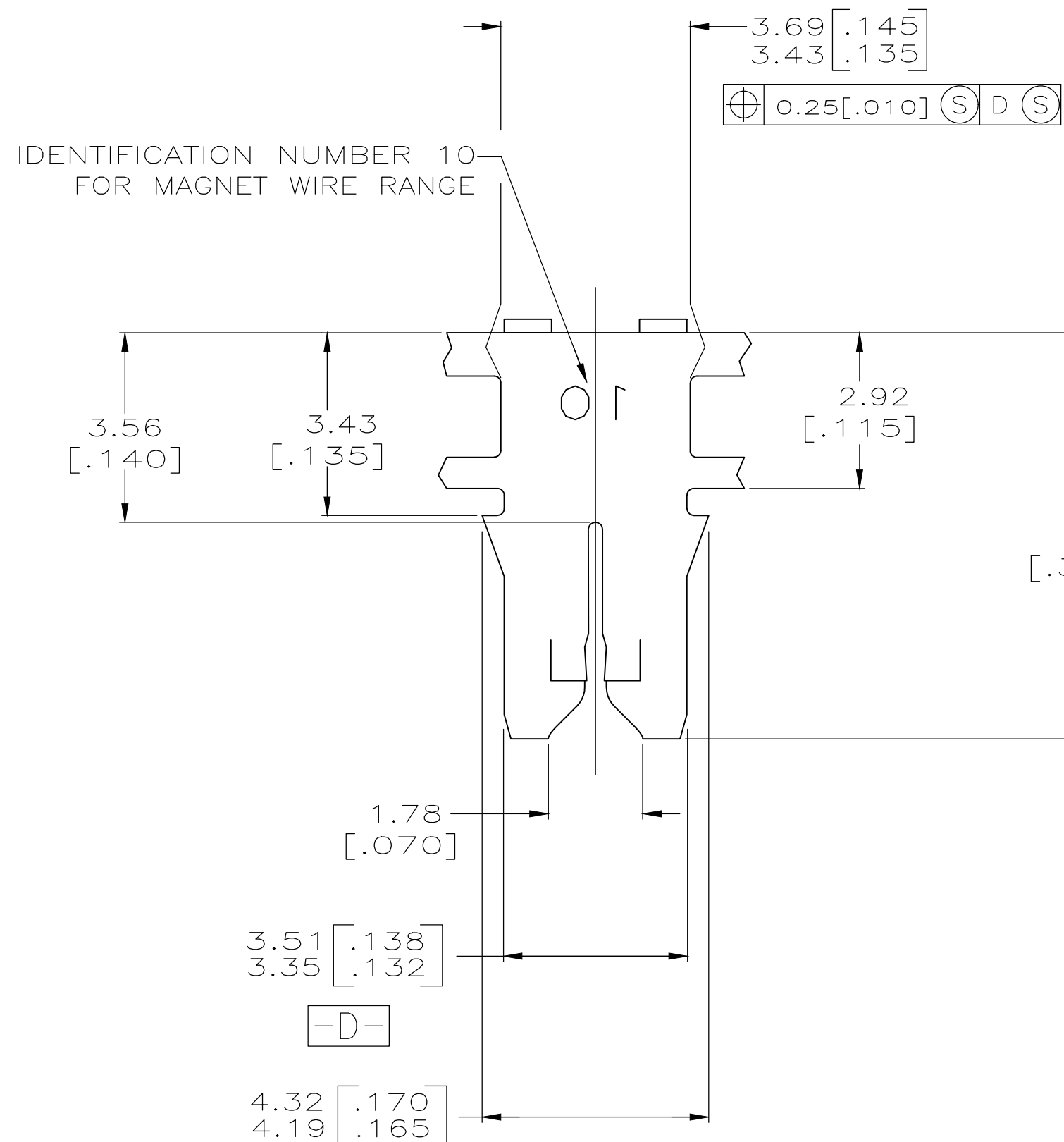

| | | | | | |
|-------------------|--------------|-----------------------|------------|----------|-------------|
| STANDARD | PAPER SPLICE | WITH PAPER | TIN PLATED | BRASS | 1-62935-2 |
| STANDARD | PAPER SPLICE | WITHOUT PAPER | TIN PLATED | CuNiSi | 62935-9 |
| STANDARD | PAPER SPLICE | WITHOUT PAPER | TIN PLATED | BRASS | 62935-8 |
| STANDARD | SPLICE FREE | WITH PAPER | TIN PLATED | BRASS | 62935-7 |
| REVERSE | PAPER SPLICE | WITHOUT PAPER | TIN PLATED | BRASS | 62935-6 |
| OBSOLETE | STANDARD | WELD SPLICE | TIN PLATED | BRASS | 62935-5 |
| OBSOLETE | STANDARD | SPLICE FREE | TIN PLATED | BRASS | 62935-4 |
| STANDARD | PAPER SPLICE | WITH PAPER | TIN PLATED | BRASS | 62935-3 |
| STANDARD | PAPER SPLICE | PLASTIC REEL W/ PAPER | NONE | BRASS | 62935-2 |
| STANDARD | PAPER SPLICE | WITHOUT PAPER | TIN PLATED | BRASS | 62935-1 |
| REELING DIRECTION | SPLICE | REELING | FINISH | MATERIAL | PART NUMBER |

THIS DRAWING IS A CONTROLLED DOCUMENT.

| | | | | | |
|---------------------|--|----------------------------------|---------------------|---------------------|------------------|
| DIMENSIONS: INCHES | TOLERANCES UNLESS OTHERWISE SPECIFIED: | DWN: MICHAEL S. FEHER 15MAR2004 | TE Connectivity | | |
| | 0 PLC ± - | CHK: KURT A. RANDOLPH 15MAR2004 | | | |
| | 1 PLC ± - | APVD: KURT A. RANDOLPH 15MAR2004 | | | |
| | 2 PLC ± 0.25 [.010] | NAME: KURT A. RANDOLPH | | | |
| | 3 PLC ± - | PRODUCT SPEC: 108-2012 | | | |
| 4 PLC ± - | APPLICATION SPEC: 114-2046 | SIZE: A2 | CAGE CODE: 00779 | DRAWING NO: C-62935 | RESTRICTED TO: - |
| ANGLES ± - | FINISH: SEE TABLE | WEIGHT: 0 | SCALE: 10:1 | SHEET: 1 OF 1 | REV: AK |
| MATERIAL: SEE TABLE | SEE TABLE | CUSTOMER DRAWING | | | |