

THIS DRAWING IS UNPUBLISHED. RELEASED FOR PUBLICATION, 19 .
 © COPYRIGHT 19 BY AMP INCORPORATED. ALL INTERNATIONAL RIGHTS RESERVED.

LOC	DIST	P	F	ZONE	LTR	REVISIONS	DATE	APPD
CM	52				E	REV & REDWN PER EC 0730-0059-95	3-21-95	KS

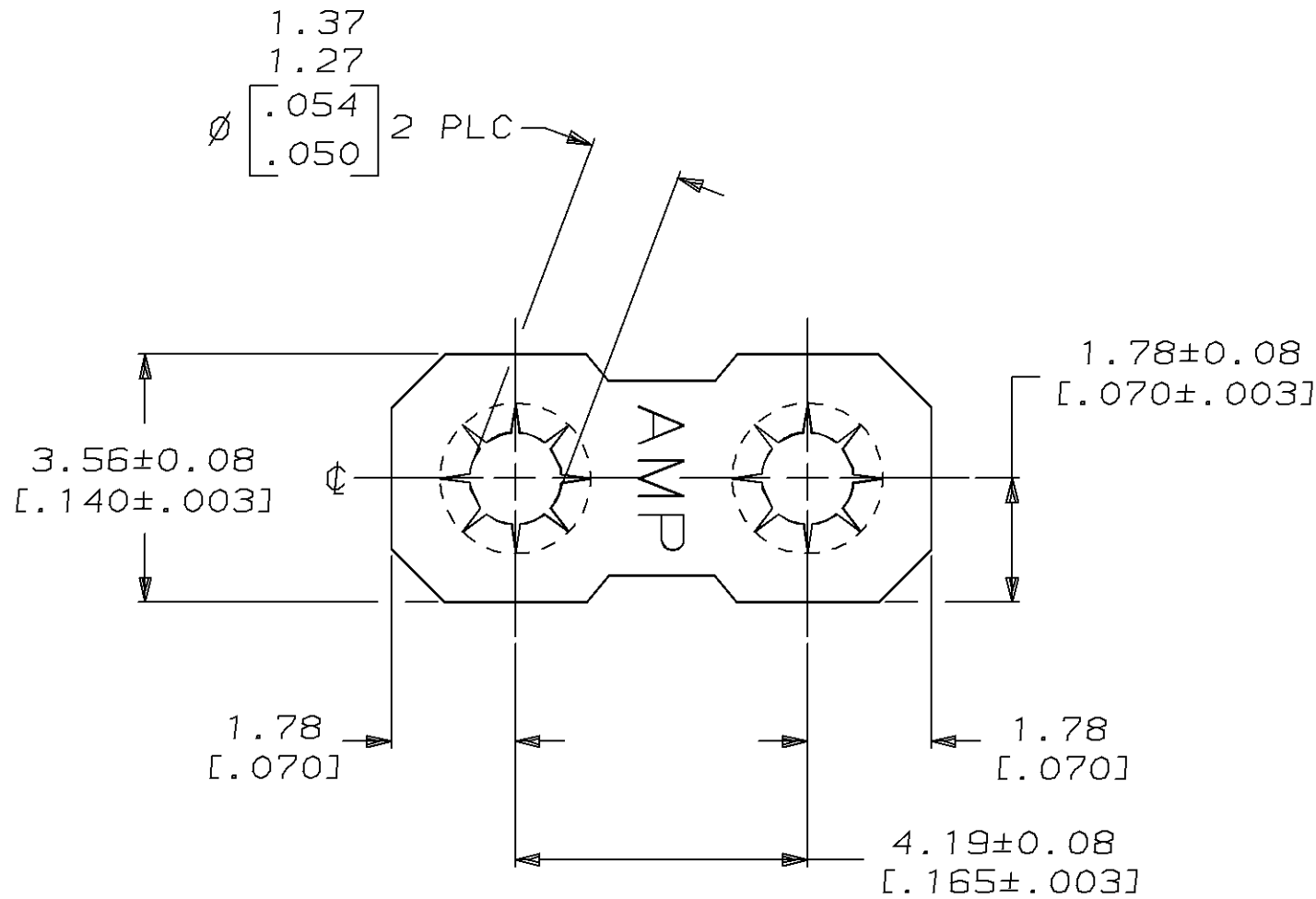

- 1. 0.00076 [.000030] MIN GOLD OVER
0.00127 [.000050] MIN NICKEL.
- 2. DIMENSIONS IN BRACKETS ARE IN INCHES.

GOLD ¹	0.20 [.008] BRASS	350020-2
PRE-TIN	0.20 [.008] BRASS	350020-1

METRIC

THIS DRAWING IS A CONTROLLED DOCUMENT FOR AMP INCORPORATED. IT IS SUBJECT TO CHANGE AND THE CONTROLLING ENGINEERING ORGANIZATION SHOULD BE CONTACTED FOR THE LATEST REVISION.

DO NOT SCALE PRINT. UNLESS SPECIFIED DIMENSIONS IN mm [INCHES] TOLERANCES ON:		DR 3-21-95 K. SALMON		AMP AMP Incorporated Harrisburg, PA 17105-3608
2 PLC DEC ± 0.13 [.005]		CHK 3-21-95 R. SWING		
3 PLC DEC ± -		APPD 3-21-95 W. LONG		NAME COMMONING BAR, 2 POSITION
ANGLES ± -		APPD 3-21-95 W. LONG		
MATERIAL	SEE TABLE	PRODUCT SPEC	-	SIZE B
FINISH	SEE TABLE	APPLICATION SPEC	-	CAGE CODE 00779
		WEIGHT	-	DRAWING NO C-350020
			SCALE 10:1	SHEET 1 OF 1