

# .039" [1.00MM] CONTACT CENTERS

## FEATURES

- \* Accommodates .062 + - .008" PCboard  
(Consult factory for other board thicknesses)
- \* PPS or PCT insulator
- \* Molded-in key available
- \* 1 amp current rating
- \* Highly reliable high cycle hairpin bellow contacts
- \* 150 grams normal force minimum

## READOUT

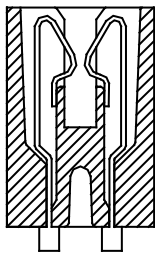

DUAL (D)

## TERMINATION TYPE

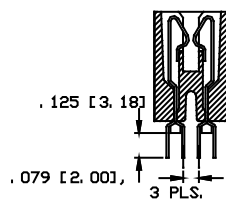

STAGGERED DIP  
SOLDER (HR)

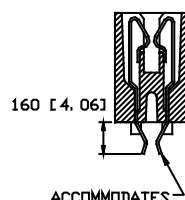

CARD EXTENDER  
(HR)

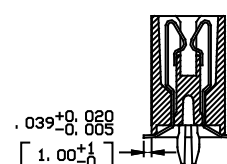

SURFACE MOUNT  
(HF)

## P.C.B. LAYOUTS

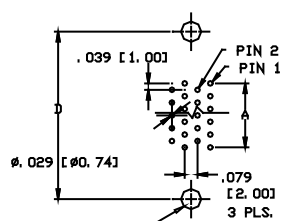

Ø.125 [3.18], 2 PLS.  
OPTIONAL FOR (D) OR  
(T) MOUNTING

CONNECTOR SIDE

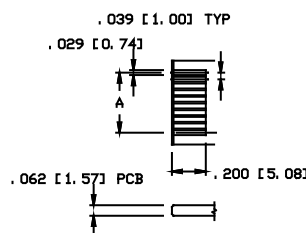

SOLDER END

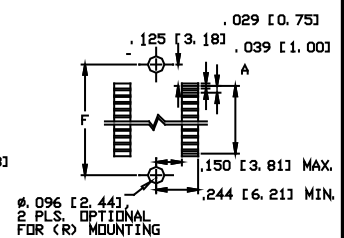

Ø.096 [2.44]  
2 PLS. OPTIONAL  
FOR (R) MOUNTING

CONNECTOR SIDE

## MOUNTING STYLE

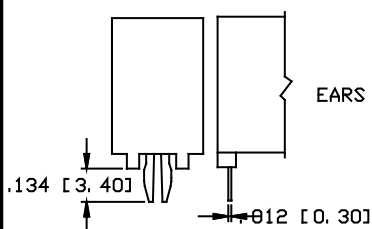

BOARD LOCK (R)

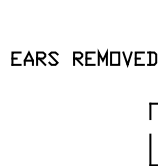

NO MOUNTING EARS (N)

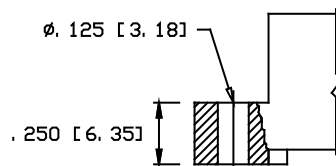

FLUSH MOUNTING (D)

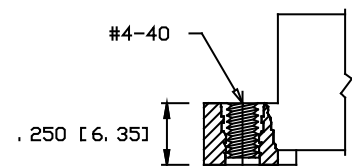

THREADED INSERT (T)

