

# EMC Components

## Clamp Filters For Cable

## ZCAT Series

### FEATURES

- Unique plastic case ensures simple, convenient installation and includes a self-holding mechanism to prevent slippage on cables.
- Ferrite core provides excellent absorption of high-frequency EMC.
- Highly effective as countermeasure against common mode EMC without adverse effect on signal quality.
- Large core size prevents saturation during large signal surges.

### INTERNAL CONSTRUCTION

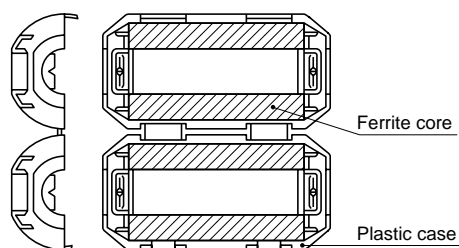

### APPLICATIONS

Personal computers, word processors, monitors, hard disk drives, digital telephones, audio devices, electronic musical instruments, video games, copiers and facsimiles.

### PRODUCT IDENTIFICATION

ZCAT 24 36 - 13 30 A - M - BK  
(1) (2) (3) (4) (5) (6) (7) (8)

- (1) Series name  
 (2) Outer dimensions(mm)  
 (3) Length(mm)  
 (4) Inner dimensions(mm)  
 (5) Material code  
 (6) Fixed type code  
 A: Cable fixed  
     Hold the cable to secure it with the main body  
 AP: Cable fixed  
     (with lock mechanism)  
 B: Clamp fixed  
 C: Cable coil securing type  
     (Coil the cable one time within the case to fix it/with lock mechanism.)  
 D: Flat cable type  
 DT: Flat cable type (Hold with adhesive pad.)  
 Non code: Band fixed  
     (Secure the cable and main body with the nylon belt.)  
 (7) TDK internal code  
 M: Standard type  
 Non code: High impedance type  
 (8) Outer color code  
 BK: Black  
 Non code: Gray



### ZCAT-C TYPE

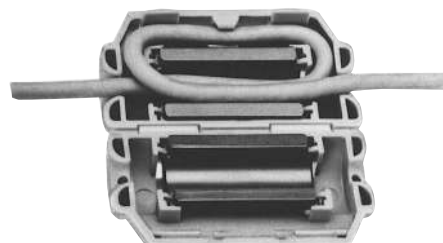

### PACKAGING STYLE AND QUANTITIES

| Part No.   | Quantity       |
|------------|----------------|
| ZCAT3035   | 140 pieces/box |
| ZCAT2017-B | 350 pieces/box |
| ZCAT2235   | 350 pieces/box |
| ZCAT2436   | 350 pieces/box |
| ZCAT2032   | 400 pieces/box |
| ZCAT2035   | 400 pieces/box |
| ZCAT2132   | 400 pieces/box |
| ZCAT2749   | 400 pieces/box |
| ZCAT1730   | 500 pieces/box |
| ZCAT2017   | 800 pieces/box |
| ZCAT1325   | 900 pieces/box |
| ZCAT1518   | 900 pieces/box |
| ZCAT1525   | 900 pieces/box |
| ZCAT4625-D | 240 pieces/box |
| ZCAT6819-D | 160 pieces/box |

# EMC Components

## ZCAT Series

### Clamp Filters For Cable

#### SHAPES AND DIMENSIONS

##### ZCAT TYPE

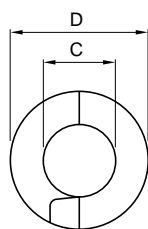
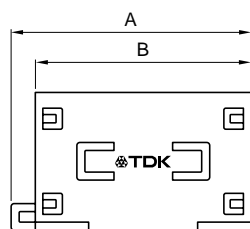

##### ZCAT-A, ZCAT-AP TYPE

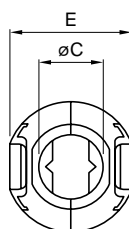
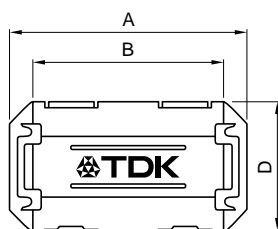

##### ZCAT-B TYPE

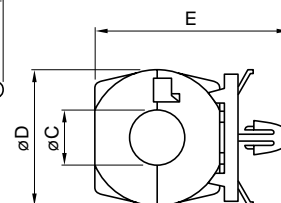
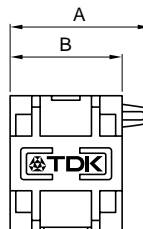

##### ZCAT-C TYPE

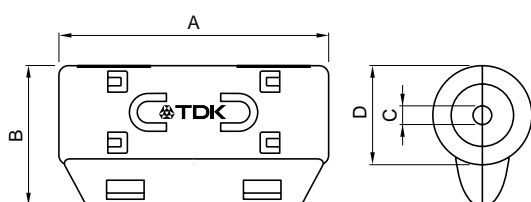

##### ZCAT-D TYPE

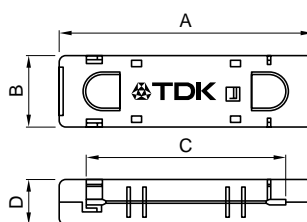

Applicable cable thickness:  
1.3mm max.

Dimensions in mm

| Part No.                | A      | B      | øC    | øD     | E      | Applicable cable outer dia. | Weight(g) | Impedance<br>freq. characteristics<br>Fig. |
|-------------------------|--------|--------|-------|--------|--------|-----------------------------|-----------|--|
| ZCAT1518-0730-M(-BK)*1  | 22±1   | 18±1   | 7±1   | 15±1   | –      | 7max.                       | 6         | 1  |
| ZCAT1518-0730(BK)*2     | 22±1   | 18±1   | 7±1   | 15±1   | –      | 7max.                       | 6         | 2  |
| ZCAT2017-0930-M(-BK)    | 21±1   | 17±1   | 9±1   | 20±1   | –      | 9max.                       | 11        | 3  |
| ZCAT2032-0930-M(-BK)*1  | 36±1   | 32±1   | 9±1   | 19.5±1 | –      | 9max.                       | 22        | 4  |
| ZCAT2032-0930(-BK)*2    | 36±1   | 32±1   | 9±1   | 19.5±1 | –      | 9max.                       | 22        | 5  |
| ZCAT2132-1130-M(-BK)*1  | 36±1   | 32±1   | 11±1  | 20.5±1 | –      | 11max.                      | 22        | 6  |
| ZCAT2132-1130(-BK)*2    | 36±1   | 32±1   | 11±1  | 20.5±1 | –      | 11max.                      | 22        | 7  |
| ZCAT3035-1330-M(-BK)*1  | 39±1   | 34±1   | 13±1  | 30±1   | –      | 13max.                      | 63        | 8  |
| ZCAT3035-1330(-BK)*2    | 39±1   | 34±1   | 13±1  | 30±1   | –      | 13max.                      | 63        | 9  |
| ZCAT1525-0430AP-M(-BK)  | 25±1   | 20±1   | 4±1   | 15±1   | 11.5±1 | 2.5 to 4(USB)               | 7         | 6  |
| ZCAT1325-0530A-M(-BK)*1 | 25±1   | 20±1   | 5±1   | 12.8±1 | 11.2±1 | 3 to 5(USB)                 | 7         | 6  |
| ZCAT1325-0530A(-BK)     | 25±1   | 20±1   | 5±1   | 12.8±1 | 11.2±1 | 3 to 5(USB)                 | 7         | 7  |
| ZCAT1730-0730A-M(-BK)   | 30±1   | 23±1   | 7±1   | 16.5±1 | 15±1   | 4 to 7(USB/IEEE1394)        | 12        | 6  |
| ZCAT2035-0930A-M(-BK)*1 | 35±1   | 28±1   | 9±1   | 19.5±1 | 17.4±1 | 6 to 9                      | 22        | 4  |
| ZCAT2035-0930A(-BK)     | 35±1   | 28±1   | 9±1   | 19.5±1 | 17.4±1 | 6 to 9                      | 22        | 5  |
| ZCAT2235-1030A-M(-BK)   | 35±1   | 28±1   | 10±1  | 21.5±1 | 20±1   | 8 to 10                     | 27        | 4  |
| ZCAT2436-1330A-M(-BK)   | 36±1   | 29±1   | 13±1  | 23.5±1 | 22±1   | 10 to 13                    | 29        | 10   |
| ZCAT2017-0930B-M(-BK)   | 21±1   | 17±1   | 9±1   | 20±1   | 28.5±1 | 9max.                       | 12        | 3  |
| ZCAT2749-0430C-M(-BK)   | 49±1   | 27±1   | 4.5±1 | 19.5±1 | –      | 4.5max.                     | 26        | 11   |
| ZCAT4625-3430D(-BK)     | 45.5±1 | 24.5±1 | 34±1  | 12±1   | –      | For 26 wires flat cable     | 32        | 12   |
| ZCAT4625-3430DT(-BK)*3  | 45.5±1 | 24.5±1 | 34±1  | 13±1   | –      | For 26 wires flat cable     | 32        | 12   |
| ZCAT6819-5230D(-BK)     | 67.5±1 | 18.5±1 | 52±1  | 16±1   | –      | For 40 wires flat cable     | 58        | 12   |
| ZCAT6819-5230DT(-BK)*3  | 67.5±1 | 18.5±1 | 52±1  | 17±1   | –      | For 40 wires flat cable     | 58        | 12   |

\*1 Set M marking on product.

\*2 These products are delivered with fixed band.

\*3 ZCAT-DT type: Adapted for flat cables and hold with adhesive pad.

• ZCAT-B type: Clamp fixed type installation hole diameter ø4.8 to 4.9mm, thickness of board 0.5 to 2mm.

• ZCAT-AP, ZCAT-C type: Once closed, the case will not be easily opened manually.

#### STRUCTURE OF THE MOUNTING BAND

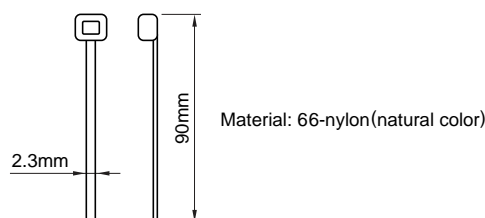

△ Specifications which provide more details for the proper and safe use of the described product are available upon request.  
All specifications are subject to change without notice.

# EMC Components

## Clamp Filters For Cable

## ZCAT Series

### ELECTRICAL CHARACTERISTICS

| Part No.          | Impedance ( $\Omega$ ) min.[50 to 500MHz] |
|-------------------|---|
| ZCAT1518-0730-M   | 35  |
| ZCAT2017-0930-M   | 35  |
| ZCAT2032-0930-M   | 80  |
| ZCAT2132-1130-M   | 50  |
| ZCAT3035-1330-M   | 100                                       |
| ZCAT1525-0430AP-M | 50  |
| ZCAT1325-0530A-M  | 50  |
| ZCAT1730-0730A-M  | 50  |
| ZCAT2035-0930A-M  | 80  |
| ZCAT2235-1030A-M  | 80  |
| ZCAT2436-1330A-M  | 50  |
| ZCAT2017-0930B-M  | 35  |
| ZCAT2749-0430C-M  | 80  |
| ZCAT4625-3430D(T) | 35  |
| ZCAT6819-5230D(T) | 35  |

- Test conditions: R-X meter at unloaded condition,  $\phi$ 1mm solder plated copper wire passes through.

### TYPICAL EMC SUPPRESSION EFFECTS

#### RADIATION LEVEL vs. FREQUENCY CHARACTERISTICS

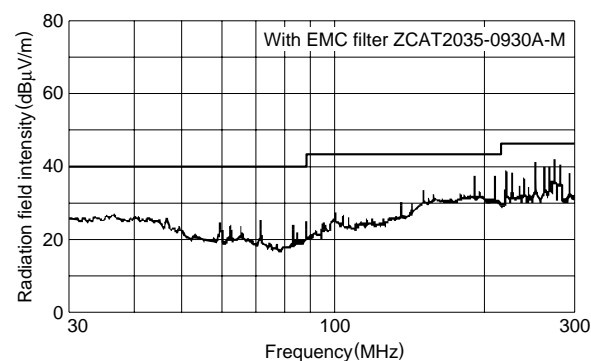
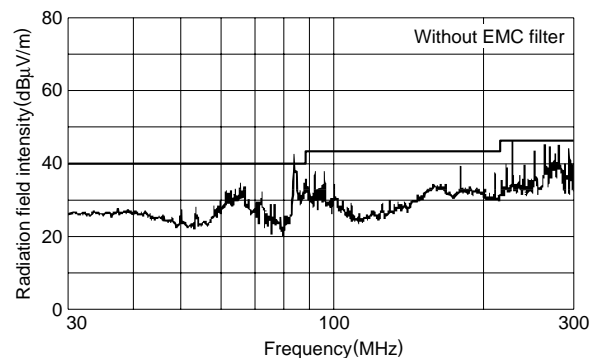

### TYPICAL ELECTRICAL CHARACTERISTICS

#### IMPEDANCE vs. FREQUENCY CHARACTERISTICS

##### ZCAT1518-0730-M

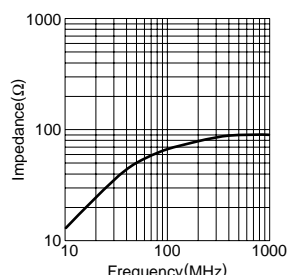

Fig.1

##### ZCAT1518-0730

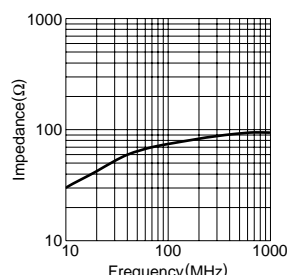

Fig.2

##### ZCAT2017-0930-M ZCAT2017-0930B-M

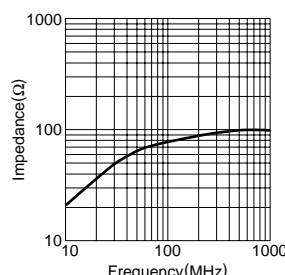

Fig.3

##### ZCAT2032-0930-M ZCAT2035-0930A-M ZCAT2235-1030A-M

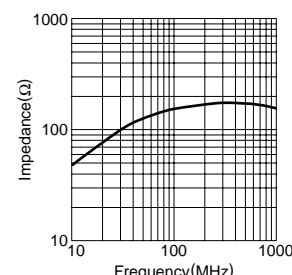

Fig.4

##### ZCAT2032-0930 ZCAT2035-0930A

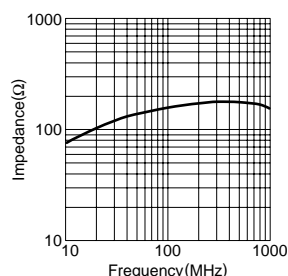

Fig.5

##### ZCAT2132-1130-M ZCAT1325-0530A-M ZCAT1525-0430AP-M ZCAT1730-0730A-M

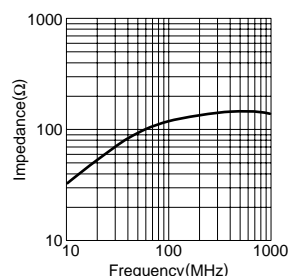

Fig.6

##### ZCAT2132-1130 ZCAT1325-0530A

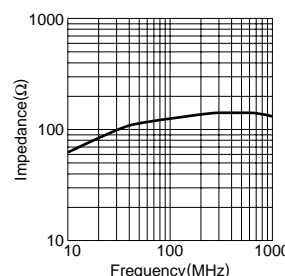

Fig.7

##### ZCAT3035-1330-M

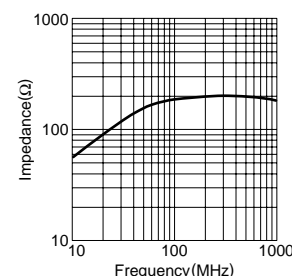

Fig.8

# EMC Components

Clamp Filters  
For Cable

## ZCAT Series

### TYPICAL ELECTRICAL CHARACTERISTICS

#### IMPEDANCE vs. FREQUENCY CHARACTERISTICS

ZCAT3035-1330

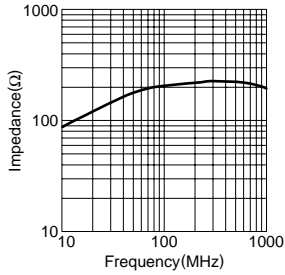

Fig.9

ZCAT2436-1330A-M

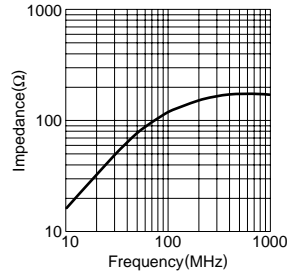

Fig.10

ZCAT2749-0430C-M(2TS)

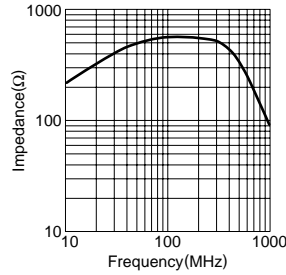

Fig.11

ZCAT4625-3430D  
ZCAT6819-5230D

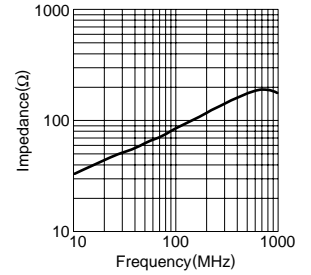

Fig.12