

**Recommended P.C. Board Layout**  
SCALE 8:1

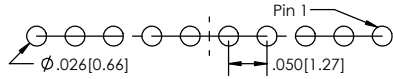

**SINGLE ROW**

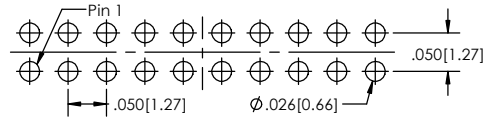

**DOUBLE ROW**

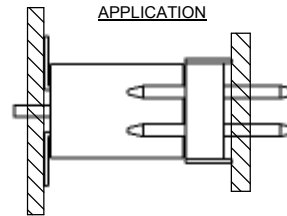
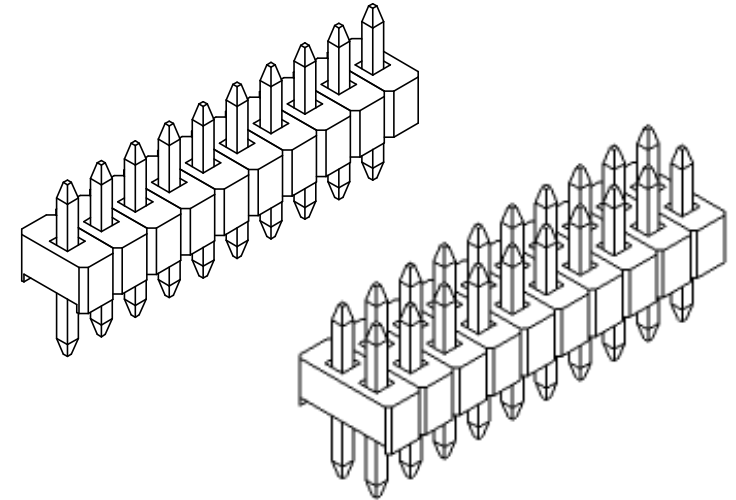

TSHS-5  -  -  -  -  -  -   
(A) (B) (C) (D) (E) (F) (G)

- A. Pins Per Row  
- 1 through 40
- B. Row Specification  
- S= Single Row  
- D= Double Row
- C. Pin Options  
- See Pin Option box below
- D. Desired Post Height  
- A= .075[1.91]  
- B= .120[3.05]
- E. Plating Options  
- See Plating Options below
- F. Polarized Position  
- Leave blank if not required  
- e.g. .200[5.08] =200
- G. Lead Free

Mates with:  
LSHSS  
SMSS  
SSHSS

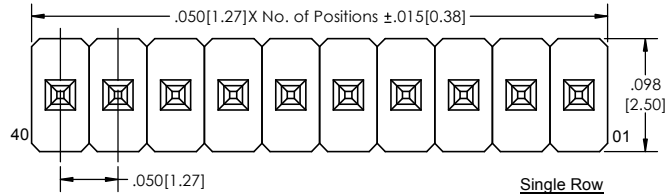
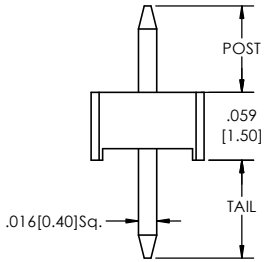

**Single Row**

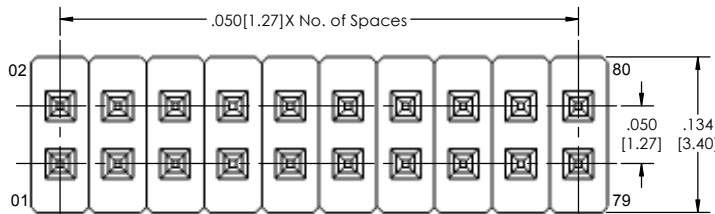

**Double Row**

Plating options	
G	-10µ Gold on Contact Area/ Flash on Tail
T	-Matte Tin all Over
GT	-10µ Gold on Contact Area/ Matte Tin on Tail
H	-30µ Gold on Contact Area/ Matte Tin on Tail
F	-Gold Flash over Entire Pin
FT	-Gold Flash on Contact Area/ Matte Tin on Tail

Pin Options		
Tail with .120 Post	Tail with .075 Post	Length
N/A	.084[2.13mm]	.219[5.56mm] 04
.148[3.76mm]	.193[4.90mm]	.328[8.32mm] 06
.250[6.35mm]	.295[7.49mm]	.430[10.92mm] 08
.300[7.62mm]	.345[8.76mm]	.480[12.19mm] 10
.350[8.89mm]	.395[10.03mm]	.530[13.46mm] 12
.400[10.16mm]	.445[11.30mm]	.580[14.73mm] 14
.450[11.43mm]	.495[12.57mm]	.630[16.00mm] 16
.500[12.70mm]	.545[13.84mm]	.680[17.27mm] 18
.550[13.97mm]	.595[15.11mm]	.730[18.54mm] 20
.600[15.24mm]	.645[16.38mm]	.780[19.81mm] 22
.650[16.51mm]	.695[17.65mm]	.830[21.08mm] 24

Specifications:  
Current Rating: 1.0 Ampere  
Insulation Resistance: 1000M Ohms Min.  
Dielectric Withstanding: 300V AC  
Contact Resistance: 20M Ohms Max.  
Operation Temperature: -40°C to +105°C  
Max. Process Temperature  
Peak: 260°C up to 10 secs.  
Process: 230°C up to 60 secs.  
Wave: 260°C up to 6 secs.  
Manual Solder: 350°C up to 5 secs.

Materials:  
Contact Material: Phosphor Bronze  
Insulator Material: Nylon 6T  
Plating: Au or Sn over 50µ" (1.27) Ni

Tails may be clipped to achieve specific dimensions.  
Products cut to specific sizes are uncancelable/nonreturnable.  
Parts are subject to change without notice.



PROPRIETARY AND CONFIDENTIAL  
THE INFORMATION CONTAINED IN THIS DRAWING IS THE SOLE PROPERTY OF Major League Electronics. ANY REPRODUCTION IN PART OR AS A WHOLE WITHOUT THE WRITTEN PERMISSION OF Major League Electronics IS PROHIBITED.

UNLESS OTHERWISE SPECIFIED:		NAME		DATE	
DIMENSIONS ARE IN INCHES		DRAWN		EOW	
TOLERANCES:		CHECKED		GWE	
ONE DECIMALS ±.100		ENG APPR.			
TWO DECIMAL ±.010		MFG APPR.			
THREE DECIMAL ±.005		ADDRESS:		2533 Centennial Blvd.	
FOUR DECIMAL ±.002		MATERIAL:		Jeffersonville, IN 47130	
NEXT ASSY		FINISH:		Phone: 812-670-4174	
USED ON:		APPLICATION:		Fax: 812-670-4175	
DO NOT SCALE DRAWING		E-Mail: mle@mlelectronics.com		E-Mail: mle@mlelectronics.com	
TITLE: TSHS-5 SERIES				REV B	
SIZE DWG. NO. C				SCALE 12:1	
SHEET 1 OF 1					

