

Revisions		Approved	Date
Description/Approval/Date	Checked	M.H.	11.18.1995
	Drawn	M.H.	11.18.1995
		K.R.E.	11.18.1995

**Tolerances**  
 1-20=+/-0.2  
 20-30=+/-0.3  
 30-40=+/-0.4  
 40-50=+/-0.5  
 50-100=+/-0.75  
 100-300=+/-1.5  
 Angles=+/-1

**Dimensions are in Millimeters**

NOTES (plating thickness in microinches):  
 1. Per QQ-B-626  
 2. Per QQ-S-764  
 3. Per QQ-C-530  
 4. Per QQ-B-750  
 5. Per MIL-P-19468  
 6. Per ZZ-R-765  
 7. Per WW-1-799  
 8. Gold pl. 5 min. over nickel pl. 50 min. over copper strike  
 9. Nickel pl. 100 min. over copper strike  
 10. Per QQ-P-35  
 11. Gold pl. 5 min. over nickel pl. 50 min. over copper strike

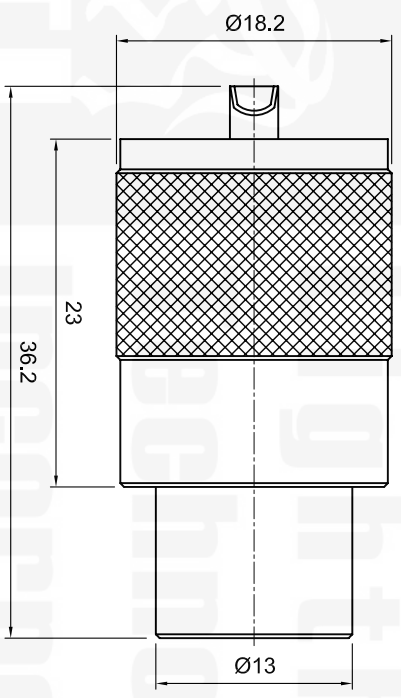

ITEM	MATERIAL	FINISH
Connector Body	Brass, Note 1	Nickel , Note 8
Center Contact: M	Brass, Note 1	Nickel, Note 8
Insulation	Delrin	None
Ferrule	--	--
Gasket	--	--
Hex Nut	--	--
Lock Washer	--	--

**Lighthorse Technologies, Inc.**  
 9511 Ridgelyaven Ct, Ste. B  
 San Diego, California 92123  
 Part Number:  
**USM211ND-213**

Description  
 UHF Plug, Twist On, PL 259, for RG 8, 213, LMR 400 cable.

Scale	Drawing No.	File Name
2:1	USM211ND-213	USM211ND-213