

REVISIONS			
REV	DESCRIPTION	DATE	APPROVED
01 <sub>0</sub>	RELEASED		
01 <sub>1</sub>	ECNs 88-0678 & 90-0493	12/9/91	CW

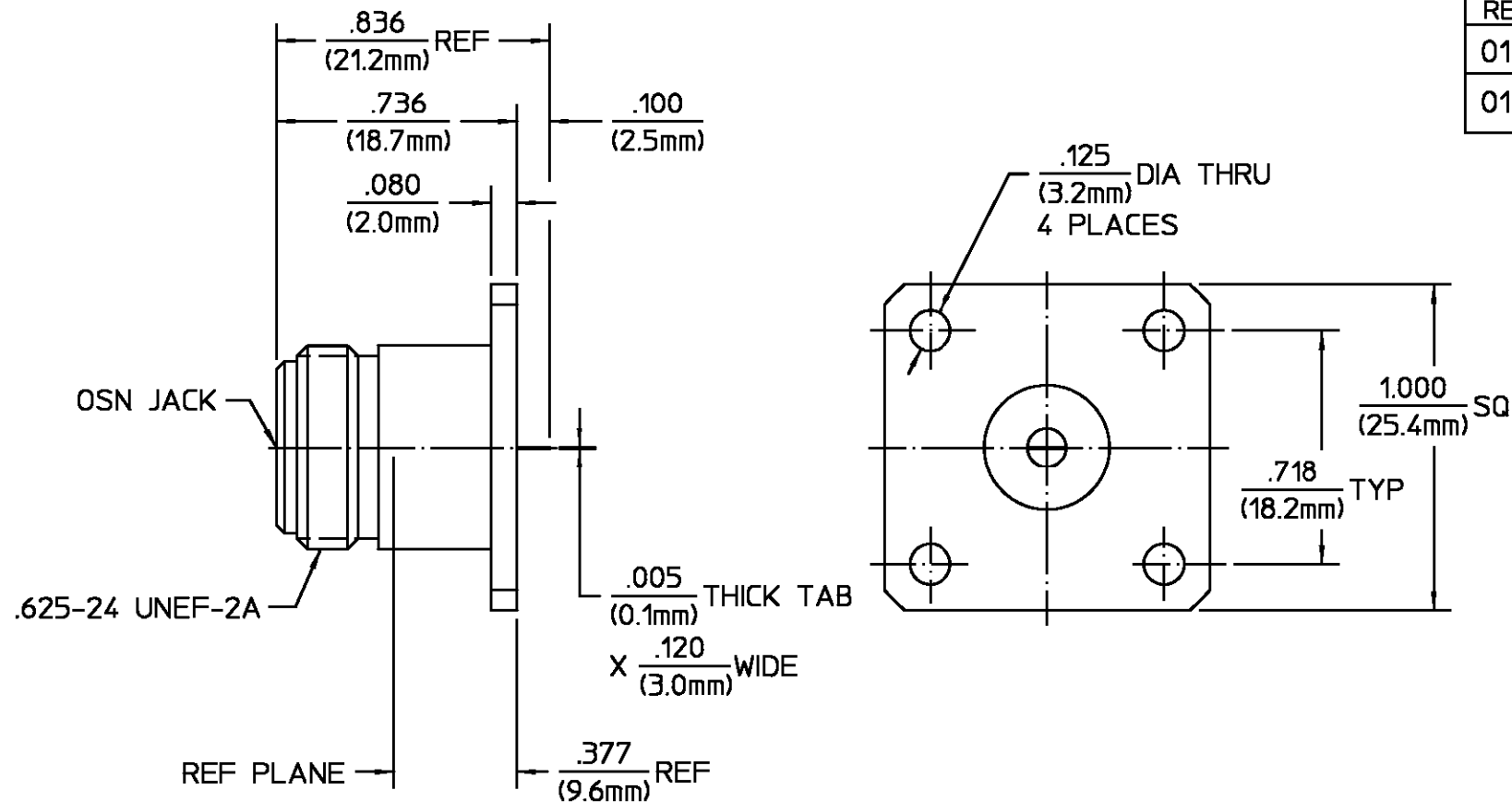

ELECTRICAL	MECHANICAL	ENVIRONMENTAL	HOUSING	MATERIAL	FINISH
Nominal Impedance (Ohms) <u>50</u>	Interface Dimensions MIL-STD-348A, Fig. 304.2	Temperature Rating <u>-65°C to +125°C</u>	BRASS PER QQ-B-626 COMP. 360, HALF HARD	NICKEL PLATE PER QQ-N-290 OVER COPPER PLATE PER MIL-C-14550	
Frequency Range (GHz) DC to <u>10</u>	Recommended Mating Torque <u>12 to 15 In-Lbs</u>	Vibration MIL-STD-202, Method 204, Condition B	DIELECTRIC TFE FLUOROCARBON PER ASTM-D-1457	N/A	
Volt Rating (VRMS MAX) @ Sea Level <u>1000</u>	Mating Characteristics: Insertion (MAX Lbs) <u>2.0</u>	Shock MIL-STD-202, Method 213, Condition I	CENTER CONTACT BERYLLIUM COPPER PER ASTM B 196, ALLOY C17300, CONDITION H	GOLD PLATE PER MIL-G-45204 MIL-G-45204 OVER COPPER PLATE PER MIL-C-14550	
VSWR <u>1.06+.007f(GHz)</u>	Withdrawal (MIN Oz) <u>2.0</u>	Thermal Shock MIL-STD-202, Method 107, Condition B, Except High Temp +115°C	COMPONENT		
Insertion Loss (dB MAX) <u>.05VfGHz</u>	Force to Engage and Disengage (In-Lbs MAX) <u>3.0</u>	Moisture Resistance MIL-STD-202, Method 106	UNLESS OTHERWISE SPECIFIED DIMENSIONS ARE IN INCHES TOLERANCE ON		
RF Leakage (dB MIN) <u>-60 @ 2 to 3 GHz</u>	Center Contact Captivation Axial (Lbs) <u>6.0</u>	Corrosion - MIL-STD-202, Method 101, Condition B, 5% salt spray	FRAC. DEC. ANGLES ± 1/64 ±.005 ± °	DRAWN BY JB DATE 10/27/75	<b>AMP Incorporated</b> 140 Fourth Avenue Waltham, MA 02451-7599
Corona, 70,000 Ft (VRMS MIN) <u>N/A</u>	Radial (In-Oz) <u>4.0</u>		CHECKED BY RMF DATE 10/27/75	APPROD BY PRB DATE 10/27/75	
Dielectric Withstanding Voltage (VRMS MIN) @ Sea Level <u>2500</u>			USE ASS'Y PROCEDURE		
Contact Resistance (Milliohms MAX) Center Contact <u>1.5</u>			NO. AP. <u>N/A</u>	TITLE OSN FLANGE MOUNT JACK RECEPTACLE TAB TERMINAL	
Outer Contact <u>2.0</u>				SIZE B	CODE IDENT NO. 26805
RF High Potential @ Sea Level (VRMS MIN @ 5 MHz) <u>1500</u>				SCALE 2:1	3052-1648-10
LR.(Megohms MIN) <u>10,000</u>					REV 01 <sub>1</sub>
					SHEET 1 OF 1

CUSTOMER DRAWING

AMP PART # 1057293-1  
SHEET 1 OF 1 REV A