

P	LTR	DESCRIPTION	DATE	DWN	APVD
	K	REV PER 0G3A-0832-04	28JAN05	JR	TM
	K1	REVISED PER ECO-17-014338	14MAY2018	RS	DR

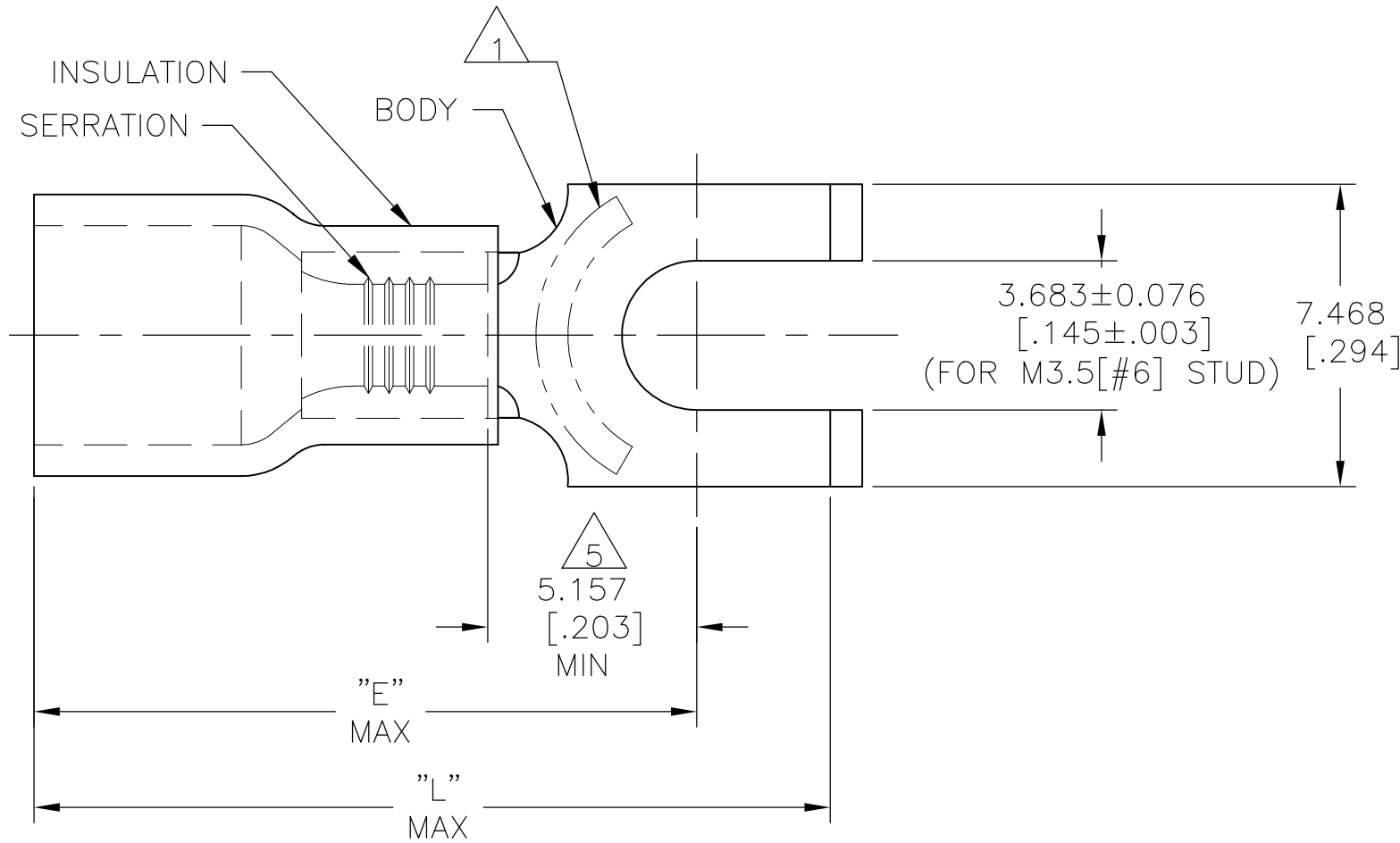

AMP WIRE RANGE	Listed FILE E13288	LR7189 Certified
16-14 AWG SOLID OR STRANDED	16-14 AWG SOLID OR STRANDED	16-14 AWG SOLID OR STRANDED

- 1 STAMP AMP 16-14* APPROX AS SHOWN
- 2 SEE TABLE FOR WIRE INSUL DIA
- 3 BODY MATL THK, 0.787±0.051[.031±.002]
- 4 MATERIAL: BODY - CU PER ASTM B152
INSULATION - PVC
- 5 APPLIES FROM CENTER OF STUD HOLE TO
EDGE OF METAL WIRE BARREL

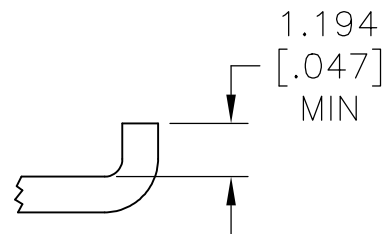

15.723 [.619]	19.025 [.749]	2.997-4.902[.118-.193]	100	LOOSE PIECE,BOX	8-324165-1
15.723 [.619]	19.025 [.749]	2.997-4.902[.118-.193]	5000	ON TAPE,REEL	2-324165-1
15.723 [.619]	19.025 [.749]	2.997-4.902[.118-.193]	1000	LOOSE PIECE	324165
"E"	"L"	WIRE INSUL DIA	QTY	PACKAGE TYPE	PART NO

**AMP INCORPORATED
CUSTOMER SERVICE SYSTEMS**

MAX RECOMMENDED OPERATING TEMPERATURE:
105°C[221°F]

THIS DRAWING IS A CONTROLLED DOCUMENT.

DWN L OLMEDA 05SEP95

STE TE Connectivity Ltd.

FOR ADDITIONAL PRODUCT INFORMATION OR COPIES OF DRAWINGS AND TECHNICAL DOCUMENTS

PRODUCT INFORMATION CENTER
1-800-522-6752

VOLTAGE RATING:
600V MAX
(1000V FIXTURE OR SIGN)

DIMENSIONS:
mm [INCHES]

TOLERANCES UNLESS OTHERWISE SPECIFIED:

CHK M ELLIS 05SEP95

NAME
TERMINAL, SPADE, FLANGED,
PLASTI-GRIP,
16-14 AWG

FOR APPLICATION TOOLING INFORMATION

TOOLING ASSISTANCE CENTER
1-800-722-1111

CIRCULAR MIL AREA:
1.04-2.62mm²[2,050-5,180]
SOLID OR STRANDED

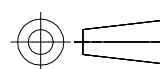

0 PLC ± -
1 PLC ± -
2 PLC ± -
3 PLC ± 0.127[.005]
4 PLC ± -
ANGLES ± -

APVD G NGO 05SEP95

PRODUCT SPEC
UL 486A-B

APPLICATION SPEC
114-2161

SIZE A3 CAGE CODE 00779 DRAWING NO C-324165 RESTRICTED TO -

FOR ORDER ENTRY 1-800-526-5142

THIS DRAWING IS A CONTROLLED DOCUMENT FOR AMP INCORPORATED. IT IS SUBJECT TO CHANGE AND THE CONTROLLING ENGINEERING ORGANIZATION SHOULD BE CONTACTED FOR THE LATEST REVISION.

MATERIAL



FINISH
BODY: TIN PER ASTM B545
INSULATION: COLOR - BLUE

WEIGHT
CUSTOMER DRAWING

SCALE 6:1 SHEET 1 OF 1 REV K1