

Recommended P.C. Board Layout
SCALE 4:1

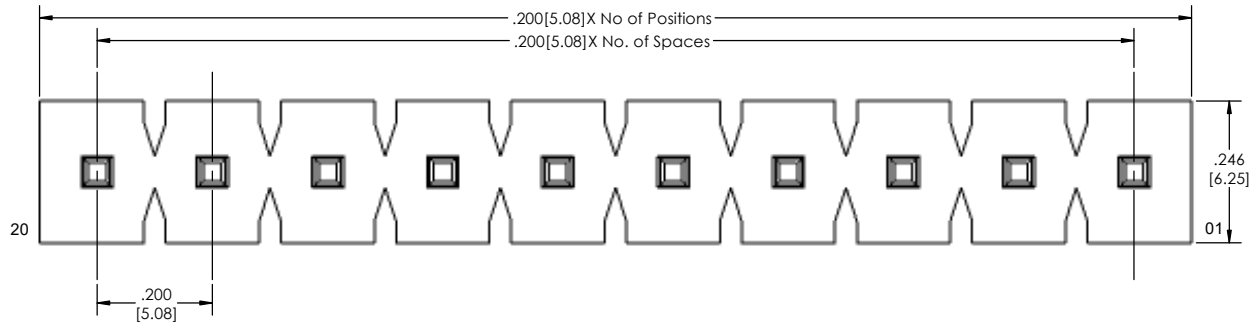
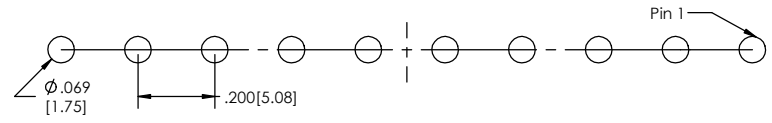
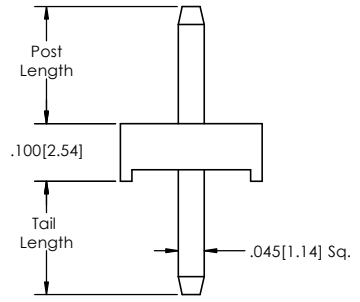

PC200H - [XX] - [S] - [XX] - [T] - [LF]
(A) (B) (C) (D) (E)

- A. Pins Per Row - 1 through 20
- B. Row Specification - S= Single Row
- C. Pin Options - See Pin Options below
- D. Plating Options - See Plating Options below
- E. Lead Free

Mates with:
PC200S-XX-S-02
PC200S-XX-S-04

Pin Options		
Post Length	Tail Length	
.150 [3.81mm]	.180 [4.57mm]	01
.470 [11.94mm]	.180 [4.57mm]	02
.520 [13.21mm]	.180 [4.57mm]	04
.829 [21.06mm]	.161 [4.09mm]	14

Plating options	
T	Matte Tin all Over

Specifications:
 Current Rating: 7.9 Ampere
 Insulation Resistance: 5000M Ohms Min.
 Dielectric Withstanding: 1500V AC
 Contact Resistance: 20M Ohms Max.
 Operation Temperature: -55°C to +125°C
 Max. Process Temperature
 IR Reflow: 280°C up to 10 secs.
 Wave: 250°C up to 10 secs.
 Manual Solder: 380°C up to 5 secs.

Materials:
 Contact Material: Brass
 Insulator Material: LCP, UL94V-0
 Plating: 120µ" Matte Tine over 50µ" (1.27)Ni
 Tails may be clipped to acheive specific dimensions.

Products cut to specific sizes are uncancellable/ nonreturnable.
 Parts are subject to change without notice.



PROPRIETARY AND CONFIDENTIAL
 THE INFORMATION CONTAINED IN THIS DRAWING IS THE SOLE PROPERTY OF Major League Electronics. ANY REPRODUCTION IN PART OR AS A WHOLE WITHOUT THE WRITTEN PERMISSION OF Major League Electronics IS PROHIBITED.

UNLESS OTHERWISE SPECIFIED:		NAME	DATE
DIMENSIONS ARE IN INCHES		DRAWN	EOW 10/11/16
TOLERANCES:		CHECKED	GWE 10/11/16
ONE DECIMALS ±.100		ENG APPR.	
TWO DECIMAL ±.010		MFG APPR.	
THREE DECIMAL ±.002		ADDRESS:	
FOUR DECIMAL ±.002		2533 Centennial Blvd.	
MATERIAL		Jeffersonville, In 47130	
FINISH		Phone: 812-670-4174	
NEXT ASSY USED ON		Fax: 812-670-4175	
APPLICATION		E-Mail: mle@mlelectronics.com	
DO NOT SCALE DRAWING		TITLE: PC200H Series	

SCALE 6:1

SIZE DWG. NO. **C**

REV **B**

SHEET 1 OF 1