

DESCRIPTION: 2MM RECEPTACLES

"L" = NO. OF CONTACTS PER ROW X .079

MATERIAL:
 HOUSING: GLASS FILLED
 THERMOPLASTIC UL 94V-0
 COLOR: BLACK
 CONTACT: PHOSPHOR BRONZE ALLOY 521
 RoHS COMPLIANT

ELECTRICAL:
 CURRENT RATING: 1 AMP
 CONTACT RESISTANCE: 2 mOHM MAX.
 DWV: 1000 Vrms/MIN.
 OPERATING TEMP:
 -55°C TO +125°C

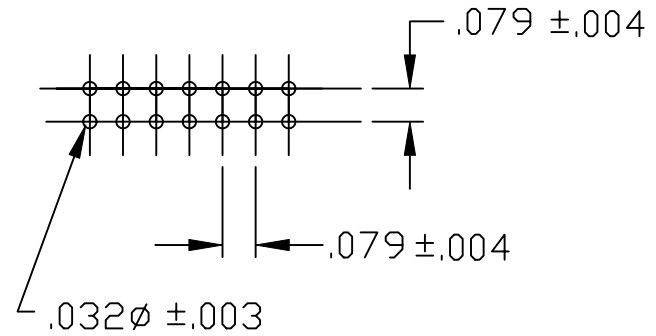
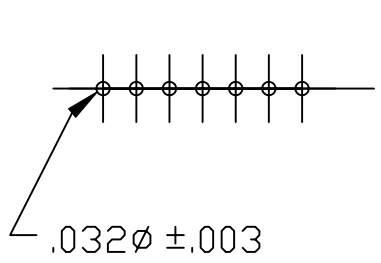
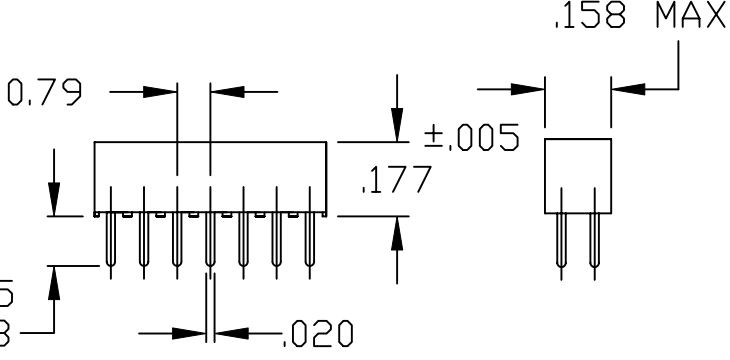
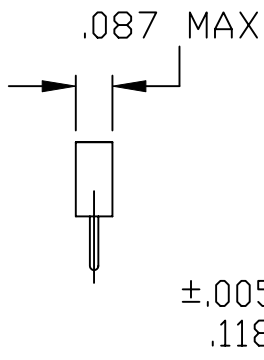
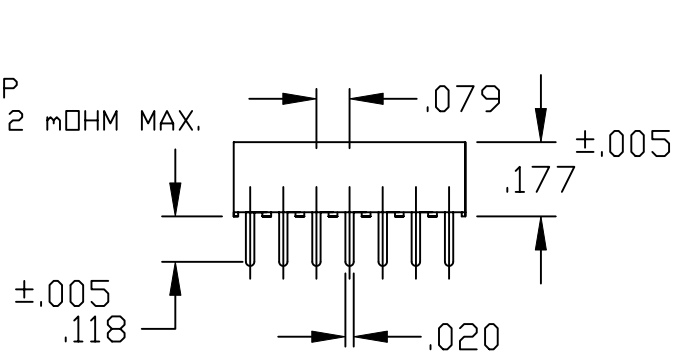
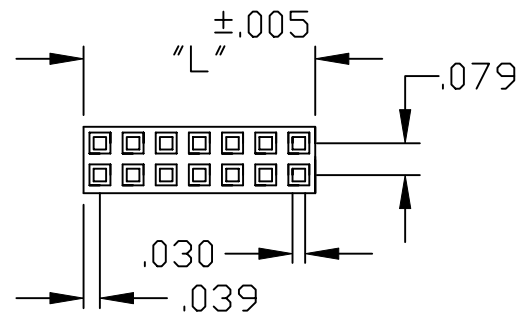
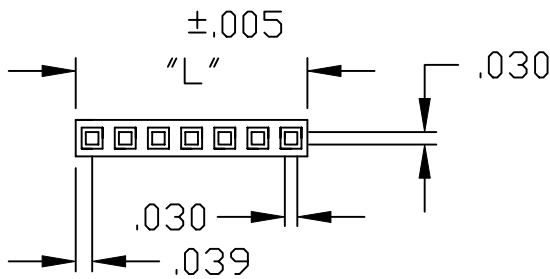

SERIES _____ 206X - XX-01RPX
 2063 = SINGLE ROW
 2064 = DUAL ROW
POSITIONS _____
 SINGLE - INCREMENTS OF 1
 DUAL = INCREMENTS OF 2
TYPE: _____
 01 = STRAIGHT
PLATING: _____
 P2 = 15 u" GOLD MATING AREA,
 100U" MIN. MATTE TIN ON TAILS

	THESE DRAWINGS AND SPECIFICATIONS ARE THE PROPERTY OF NorComp AND SHALL NOT BE REPRODUCED, COPIED OR USED AS THE BASIS FOR THE MANUFACTURE OF APPARATUS WITHOUT WRITTEN PERMISSION.		DRAWN: PAM JENKINS	DATE: 7-28-05
	<h1>NorComp</h1>		CHECKED:	DATE:
SCALE:			SHEET 1 OF 1	REV 1
DWG NO. 206X-XX-01RPX				