

NOTES:

- 1.0 ELECTRICAL SPECIFICATIONS:
- 1.1 FREQUENCY RANGE: DC to 18 GHz
- 1.2 MAXIMUM INPUT POWER: 0.5 WATTS @ +25°C
DERATED LINEARLY TO 0 WATTS @ +125°C
- 1.3 OPERATING TEMP. RANGE: -65°C to +125°C
- 1.4 IMPEDANCE: 50 OHMS
- 1.5 VSWR: 1.10 +0.01F(GHz)
- 2.0 MARKING: NONE REQUIRED
- 3.0 DIMENSIONS IN BRACKETS ARE IN MILLIMETERS.

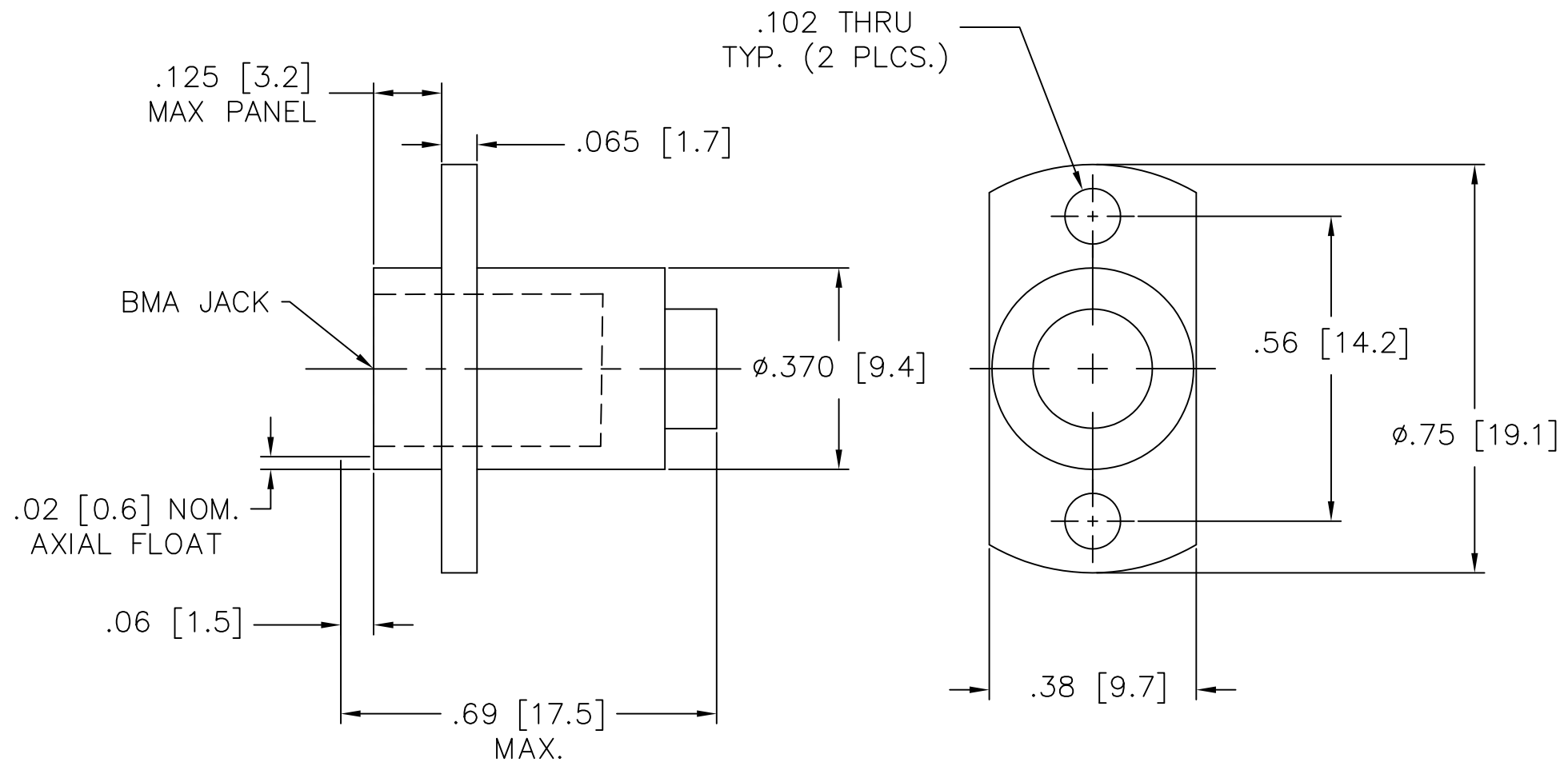

REV.	DESCRIPTION	DATE
-	RELEASED	4/19/00
B	ECO 22514	7/28/10
B1	ECO 23515	4/28/11

NOTICE: The information contained in this drawing is proprietary and must not be used without the permission of Emerson Network Power. UNLESS OTHERWISE NOTED DIMENSIONS ARE IN INCHES AND TOLERANCES ARE: 3 PLACE DECIMALS \pm .005 2 PLACE DECIMALS \pm .02 FRACTIONS \pm 1/64 PARALLELITY: T.I.R. _____ FLATNESS: T.I.R. _____ CONCENTRICITY: T.I.R. _____ ANGLES AND PERPENDICULARITY: \pm 1'	CAGE CODE 34078	MIDWEST MICROWAVE	
		TITLE TERMINATION OUTLINE DRAWING	
DRAWN/DATE M. STAFFORD 4/13/00	ENG./DATE G.KOZAK 4/19/00	DRAWING NUMBER TRM-2193-FO-BMA-02-01	REV. B1
CHECKED/DATE	APPROVED/DATE	SCALE: 3:1	SHEET 1 of 1