

order number	lens name	f-stop
0009-194-000-40	Macro-CCD-Lens -4x	5.2

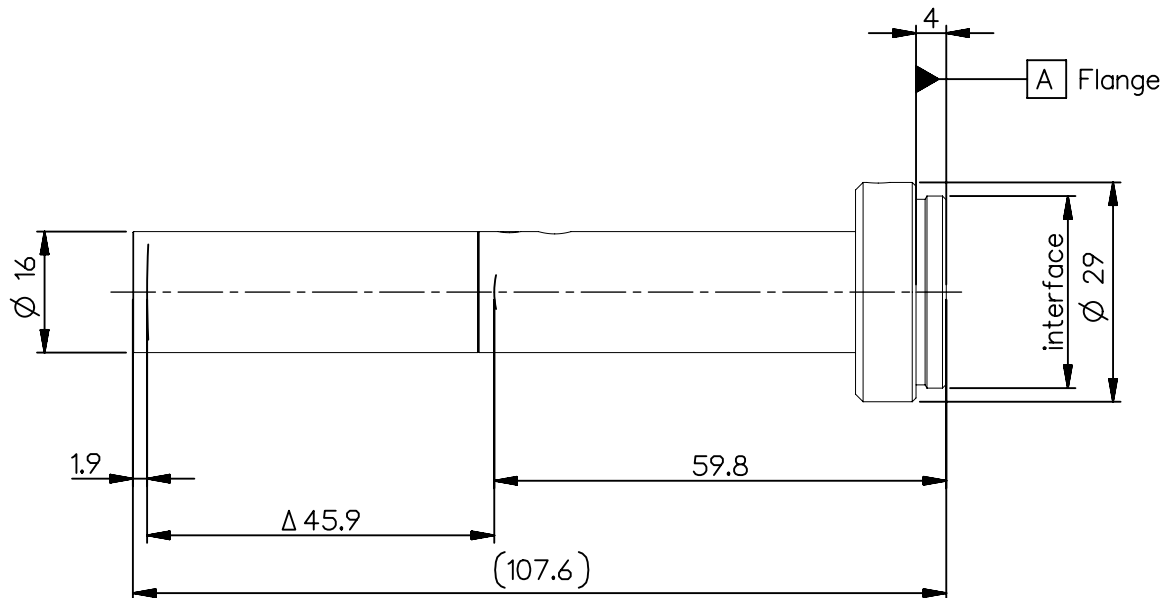

Specification		ON					
image circle max. (mm)	11	working distance (mm)	75				
focal length f' (mm)	19.8	interface	C-mount				
magnification β' [range]	-4	filter thread	-				
spectral range λ (nm)	400 - 750	weight (g)	40				
schematic diagram *) in air 		design includes CCD cover glass: no					
		SF (mm)	-72.0	f-stop		\varnothing EnP	\varnothing Exp
		S'F' (mm) *)	-5.9				
		HH' (mm) *)	72.3				
		SH (mm)	-52.2				
		S'H' (mm) *)	-25.8				
		SEnP (mm)					
		S'ExP (mm) *)					

NX PROTECTIVE NOTE "DIN ISO 16016" TO BE OBSERVED	EU-D		AL-T1A		US-D		US-ML		not export controlled		
							PDM Status Freigabe		-		
	REV	ECC	DATE	APPROVED	GENERAL TOLERANCE OF DIMENSION, FORM, POS.	SURF. TREATMT	SCALE 1:1		MATERIAL		
	a	Neuausg									
	b	11-0358	20.07.11	Kuehne							
c	14-0184	17.09.14	Schiff e								
d	17-0915	20.03.18	Denk	BASIC TOLERANCING PRINCIPLE		TITLE Macro-CCD-Lens 4x					
						FIRST DATE NAME				DRAWING NO. 0009-194-100-40-0001d	SHEET 1 OF 1
						ISSUE 17.09.14 Schifferer					
						CHKD 17.09.14 Stauder					
DIN A 4		ALL DIMENSIONS ARE IN MM AND INCLUDE SURFACE TREATMENT						REPLACES			