

Electronic housing - PC 5/11-GF-7,62 - 1720880

Please be informed that the data shown in this PDF Document is generated from our Online Catalog. Please find the complete data in the user's documentation. Our General Terms of Use for Downloads are valid (<http://phoenixcontact.com/download>)

Header, Nominal current: 41 A, Rated voltage (III/2): 630 V, Number of positions: 11, Pitch: 7.62 mm, Color: green, Contact surface: Tin, Assembly: Soldering



The figure shows a 5-pos. version of the product

Product Features

- PCB-SHIELD shroud for a professional EMC shield connection
- Vibration-resistant connection by means of threaded flange (-GF; also for screw connection in the device)
- Compatible with the Click and Lock system
- PC 5 headers for use in combination with PC 5 plugs
- CP-PC RD coding profiles as protection against mismatching



Key commercial data

| | |
|--------------------------------------|-----------|
| Packing unit | 1 pc |
| Minimum order quantity | 50 pc |
| Weight per Piece (excluding packing) | 22.22 GRM |
| Custom tariff number | 85366990 |
| Country of origin | Germany |

Technical data

Dimensions

| | |
|----------------|-----------|
| Length | 29.25 mm |
| Pitch | 7.62 mm |
| Dimension a | 76.2 mm |
| Pin dimensions | 0,8 x 1,0 |
| Pin spacing | 7.62 mm |
| Hole diameter | 1.3 mm |

General

Electronic housing - PC 5/11-GF-7,62 - 1720880

Technical data

General

| | |
|---|------------|
| Range of articles | PC 5/..-GF |
| Insulating material group | I |
| Rated surge voltage (III/3) | 6 kV |
| Rated surge voltage (III/2) | 6 kV |
| Rated surge voltage (II/2) | 6 kV |
| Rated voltage (III/3) | 630 V |
| Rated voltage (III/2) | 630 V |
| Rated voltage (II/2) | 1000 V |
| Connection in acc. with standard | EN-VDE |
| Nominal current I_N | 41 A |
| Maximum load current | 41 A |
| Insulating material | PA |
| Inflammability class according to UL 94 | V0 |
| Color | green |
| Number of positions | 11 |

Classifications

eCl@ss

| | |
|------------|----------|
| eCl@ss 4.0 | 272607xx |
| eCl@ss 4.1 | 27260701 |
| eCl@ss 5.0 | 27260701 |
| eCl@ss 5.1 | 27260701 |
| eCl@ss 6.0 | 27260704 |
| eCl@ss 7.0 | 27440402 |
| eCl@ss 8.0 | 27440402 |

ETIM

| | |
|----------|----------|
| ETIM 3.0 | EC001121 |
| ETIM 4.0 | EC002637 |
| ETIM 5.0 | EC002637 |

UNSPSC

| | |
|---------------|----------|
| UNSPSC 6.01 | 30211810 |
| UNSPSC 7.0901 | 39121409 |
| UNSPSC 11 | 39121409 |
| UNSPSC 12.01 | 39121409 |
| UNSPSC 13.2 | 39121409 |

Electronic housing - PC 5/11-GF-7,62 - 1720880

Approvals

Approvals

Approvals

UL Recognized / cUL Recognized / GOST / GOST / cULus Recognized

Ex Approvals

Approvals submitted

Approval details

| | | | |
|--------------------|-------|-------|-------|
| UL Recognized | | | |
| | B | C | D |
| Nominal current IN | 41 A | 41 A | 10 A |
| Nominal voltage UN | 300 V | 150 V | 300 V |

| | | | |
|--------------------|-------|-------|-------|
| cUL Recognized | | | |
| | B | C | D |
| Nominal current IN | 41 A | 41 A | 10 A |
| Nominal voltage UN | 300 V | 150 V | 300 V |

| | | | |
|------|--|--|--|
| GOST | | | |
|------|--|--|--|

| | | | |
|------|--|--|--|
| GOST | | | |
|------|--|--|--|

| | | | |
|------------------|--|--|--|
| cULus Recognized | | | |
|------------------|--|--|--|

Electronic housing - PC 5/11-GF-7,62 - 1720880

Drawings

Drilling diagram

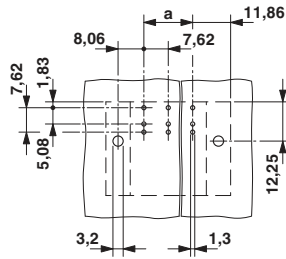

Dimensioned drawing

