

REV.	DATE	DESCRIPTION
NC	11/21/97	INITIAL RELEASE
A	05/01/04	UPDATE DRAWING FORMAT

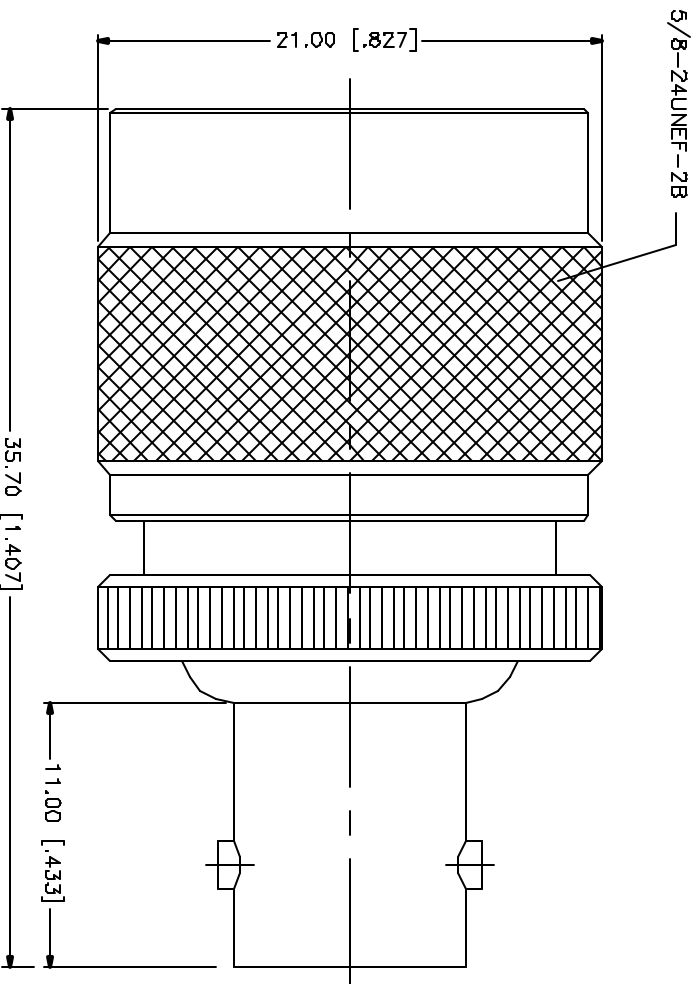

REV.	DATE	DESCRIPTION	MATERIAL	FINISH	QTY
4					
3					
2					
1					
4					
3					
2					
1					
DESCRIPTION					

UNLESS OTHERWISE SPECIFIED DIMENSIONS ARE IN MILLIMETERS. DIMENSIONS IN [ ] ARE IN INCHES AND ARE FOR DISTRICTS RESISTANCE ONLY.	APPROVALS	DATE
UNLESS OTHERWISE SPECIFIED TOLERANCES FOR MILLIMETERS ARE: 0.5 - 30mm ± 0.20mm 30 - 120mm ± 0.10mm 120 - 300mm ± 0.15mm 300 - 600mm ± 0.20mm 600 - 1200mm ± 0.30mm 1200 - 2000mm ± 0.40mm 2000 - 3000mm ± 0.50mm 3000 - 6000mm ± 0.60mm 6000 - 10000mm ± 0.70mm 10000 - 15000mm ± 0.80mm 15000 - 20000mm ± 0.90mm 20000 - 30000mm ± 1.00mm 30000 - 40000mm ± 1.10mm 40000 - 50000mm ± 1.20mm 50000 - 60000mm ± 1.30mm 60000 - 70000mm ± 1.40mm 70000 - 80000mm ± 1.50mm 80000 - 90000mm ± 1.60mm 90000 - 100000mm ± 1.70mm	DRAWN G.R.S.	05/01/04
UNLESS OTHERWISE SPECIFIED TOLERANCES FOR INCHES ARE: .020 - .315 ± 0.007 .315 - 1.180 ± 0.015 1.180 - 4.724 ± 0.020	CHECKED	
	ISSUED	
	SHEET	1 OF 1

DO NOT SCALE DRAWING	CAD FILE C:/242/242121.DWG	DWG. NO. 242121.DWG	REV. A	SIZE A	SCALE NA
----------------------	-------------------------------	------------------------	-----------	-----------	-------------

<b>Amphenol Connex</b>	
PART DESCRIPTION	
N MALE TO BNC FEMALE ADAPTER	
PART NO.	242121