

REVISION C1

NOTES:

1.  $\text{\textcircled{C}}$  REPRESENTS A CRITICAL DIMENSION.
2. MEASURED AT BEND RADIUS, NOT AT END OF PIN.
3. TUBE ONLY -05 THROUGH -50 POSITIONS.
4. GOLD PLATING TO BE ON POST, TIN PLATING ON TAIL.
5. PARTS MAY BE CUT TO POSITION.
6. MINIMUM PUSHOUT FORCE: 1.0 LB.
7. SURFACE MOUNT TAILS TO BE SHEARED TO DIMENSION ON STYLE -05 ONLY.
8. DUE TO THE HIGH AMOUNT OF INSERTION FORCE NEEDED, THE -LC OPTION IS NOT COMPATIBLE WITH AUTO PLACEMENT. SAMTEC RECOMMENDS MANUAL PLACEMENT FOR ALL ASSEMBLIES WITH THE -LC, -EC, -EBC AND -EPC OPTIONS.
9. ORDERS WILL BE PACKAGED ACCORDING TO THE SAMTEC PACKAGING EFFICIENCY STANDARDS (SPES) FOUND ON WWW.SAMTEC.COM.
10. ATTACH LABEL TO EACH REEL.

DO NOT SCALE FROM THIS PRINT

TMMH-1XX-XX-XX-DV-XXX-X-XXX-XX

No OF POS  
-02 THRU -50  
(PER ROW)

LEAD STYLE

- 01: .126 [3.20]  
(USE T-1S13-07-XX-2)
- 04: .075 [1.91]  
(USE T-1S13-04-XX-2)
- 05: .065 [1.65] MIN  
(USE T-1S13-20-XX-2)

PACKAGING

- BLANK: TUBES (SEE NOTE 3)
- TR: TAPE & REEL (SEE NOTES 9 & 10)
- FR: FULL REEL QTY TAPE & REEL (SEE NOTES 9 & 10)
- (-XR PACKAGING AVAILABLE FOR 36 POS MAX)

POLARIZATION

- XXX: POLARIZATION (SPECIFY POS -XXX TO BE OMITTED)

PICK & PLACE OPTION

- M: PICK & PLACE PAD (USE PPP-10)  
(SEE FIG 3; 5 POS MIN)

OPTIONS \*\*

- ES: END SHROUDS (SEE FIG 4, SHT 2, 9 POS MIN)
- EC: LOCKING CLIP (SEE FIG 6, SHT 3, 9 POS MIN, DO NOT USE WITH -A OR -LC, SEE NOTE 8)
- EP: GUIDE POST (SEE FIG 9, SHT 4, 9 POS MIN)
- EL: BOARD LOCK (SEE FIG 5, SHT 3, 9 POS MIN)
- LC: FLEX MOLD LOCKING CLIP (USE LC-09-TM, SEE FIG 2, SHEET 2, 5 POS MIN, SEE NOTE 8)
- A: ALIGNMENT PIN (USE TMMH-50-D-A-XX, SEE FIG 2, SHEET 2, 3 POS MIN)
- EBC: BOARD LOCK WITH LOCKING CLIP (SEE FIG 8 SHT 4, 9 POS MIN NOT AVAILABLE WITH -A OR -LC, SEE NOTE 8)
- EPC: GUIDE POST WITH LOCKING CLIP (SEE FIG 7, SHT 3, 9 POS MIN NOT AVAILABLE WITH -A OR -LC, SEE NOTE 8)

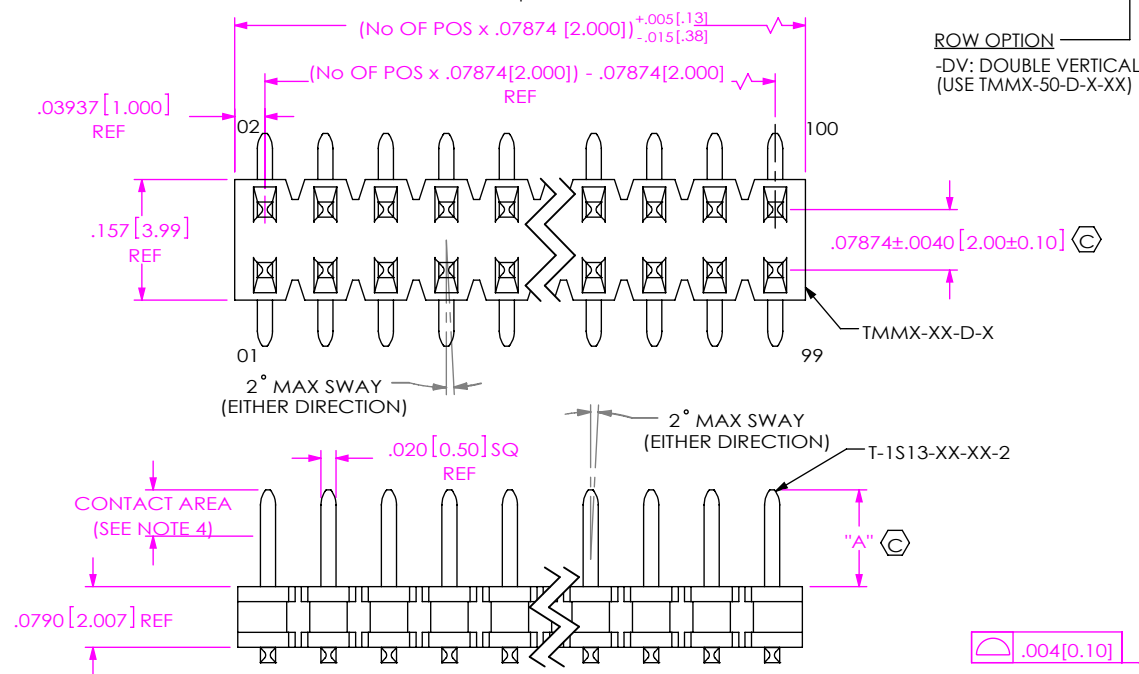
- \*\* ALL OPTIONS EXCEPT THE -EX / -A / -LC OPTIONS USE THE TMMC-50-D-X-XX  
-EX / -A / -LC OPTIONS USE THE TMMH-50-D-XX-XX

PLATING

- L: 15 $\mu$ " LIGHT SELECTIVE GOLD IN CONTACT AREA, MATTE TIN ON TAIL
- F: 3 $\mu$ " FLASH GOLD IN CONTACT AREA, MATTE TIN ON TAIL
- S: 30 $\mu$ " SELECTIVE GOLD IN CONTACT AREA, MATTE TIN ON TAIL
- G: 20 $\mu$ " GOLD IN CONTACT AREA, 3 $\mu$ " MIN GOLD ON TAIL
- T: MATTE TIN ON CONTACT AND TAIL
- H: 30 $\mu$ " HEAVY GOLD IN CONTACT AREA, 3 $\mu$ " MIN GOLD ON TAIL
- TM: MATTE TIN CONTACT AND TAIL
- LM: 15 $\mu$ " LIGHT SELECTIVE GOLD IN CONTACT AREA, MATTE TIN ON TAIL
- SM: 30 $\mu$ " SELECTIVE GOLD IN CONTACT AREA, MATTE TIN ON TAIL
- FM: 3 $\mu$ " FLASH SELECTIVE GOLD IN CONTACT AREA, MATTE TIN ON TAIL

ROW OPTION

- DV: DOUBLE VERTICAL  
(USE TMMX-50-D-X-XX)



STYLE	"A"	"B"	TERMINAL	"L"
-01	.126[3.20]	.101[2.57]	T-1S13-07-XX-2	.302[7.67]
-04	.075[1.91]	.050[1.27]	T-1S13-04-XX-2	.255[6.48]
-05	.065[1.65]	.040[1.02]	T-1S13-20-XX-2	.323[8.20]

ASSEMBLY OPERATION	IN-PROCESS INSPECTION
FILL	C1
REPRESS	C2

UNLESS OTHERWISE SPECIFIED, DIMENSIONS ARE IN INCHES.  
 TOLERANCES ARE:  
 DECIMALS ANGLES  
 .XX:  $\pm .01 [0.3]$  2°  
 .XXX:  $\pm .005 [0.13]$   
 .XXXX:  $\pm .0020 [0.051]$

MATERIAL: DO NOT SCALE DRAWING SHEET SCALE: 1:1  
 BODIES: LCP, UL 94 VO  
 COLOR: BLACK  
 TERMINAL: PHOSPHOR BRONZE, ALLOY  
 MAX. CUT FLASH: .020 [0.51]

F:\DWG\MISC\MKTG\TMMH-1XX-XX-XX-DV-XXX-X-XXX-X-MKT.SLDDRW

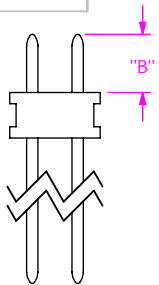
PROPRIETARY NOTE  
 THIS DOCUMENT CONTAINS CONFIDENTIAL AND PROPRIETARY INFORMATION AND ALL DESIGN, MANUFACTURING, REPRODUCTION, USE, PATENT RIGHTS AND SALES RIGHTS ARE EXPRESSLY RESERVED BY SAMTEC, INC. THIS DOCUMENT SHALL NOT BE DISCLOSED, IN WHOLE OR PART, TO ANY UNAUTHORIZED PERSON OR ENTITY NOR REPRODUCED, TRANSFERRED OR INCORPORATED IN ANY OTHER PROJECT IN ANY MANNER WITHOUT THE EXPRESS WRITTEN CONSENT OF SAMTEC, INC.

520 PARK EAST BLVD. NEW ALBANY, IN 47150  
 PHONE: 812-944-6733 FAX: 812-948-5047  
 e-Mail: info@SAMTEC.com code 55322

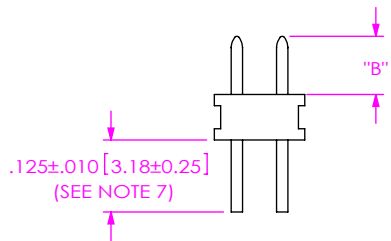
DESCRIPTION:  
 2MM X 2MM TERMINAL STRIP ASSEMBLY

DWG. NO.  
 TMMH-1XX-XX-XX-DV-XXX-X-XXX-XX

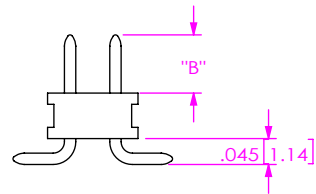
BY: PURVIS 10/08/1996 SHEET 1 OF 5



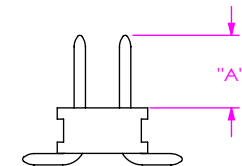
IN-PROCESS 1



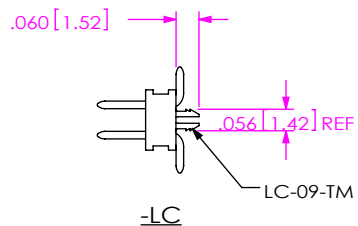
IN-PROCESS FOR STYLE -05



IN-PROCESS 3



IN-PROCESS 4



-LC

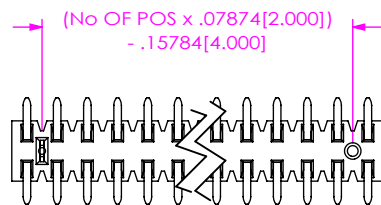
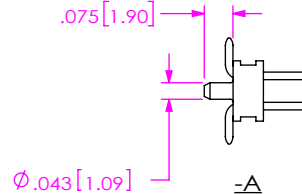


FIG 2  
(DIFFERENT AS SHOWN,  
OTHERWISE SAME AS FIG 1)



-A

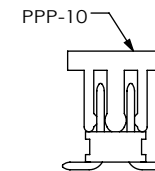
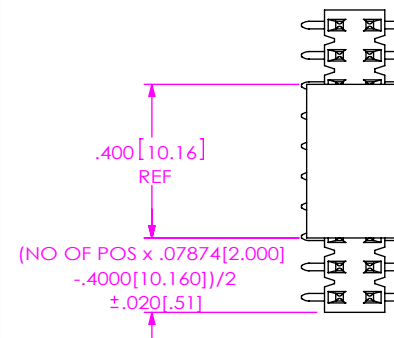
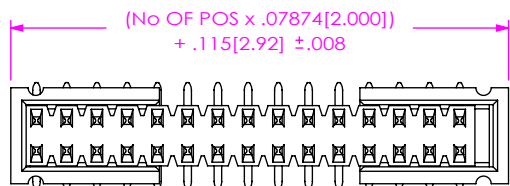


FIG 3  
-M  
(DIFFERENT AS SHOWN,  
OTHERWISE SAME AS FIG 1)



STYLE	"C"	"D"	SHROUD
-01	.202[5.13]	.230[5.84]	TMMH-ES-01
-04	.149[3.78]	.177[4.50]	TMMH-ES-04
-05	.149[3.78]	.177[4.50]	TMMH-ES-04

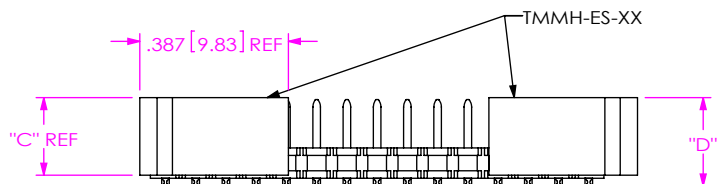
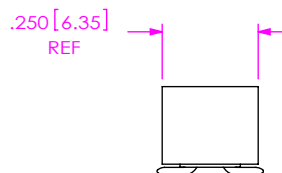


FIG 4  
-ES  
(DIFFERENT AS SHOWN,  
OTHERWISE SAME AS FIG 1)



.250 [6.35]  
REF

**PROPRIETARY NOTE**  
THIS DOCUMENT CONTAINS CONFIDENTIAL AND PROPRIETARY INFORMATION AND ALL DESIGN, MANUFACTURING, REPRODUCTION, USE, PATENT RIGHTS AND SALES RIGHTS ARE EXPRESSLY RESERVED BY SAMTEC, INC. THIS DOCUMENT SHALL NOT BE DISCLOSED, IN WHOLE OR PART, TO ANY UNAUTHORIZED PERSON OR ENTITY NOR REPRODUCED, TRANSFERRED OR INCORPORATED IN ANY OTHER PROJECT IN ANY MANNER WITHOUT THE EXPRESS WRITTEN CONSENT OF SAMTEC, INC.

DO NOT SCALE DRAWING



520 PARK EAST BLVD, NEW ALBANY, IN 47150  
PHONE: 812-944-6733 FAX: 812-948-5047  
e-Mail info@SAMTEC.com code 55322

DESCRIPTION:  
2MM X 2MM TERMINAL STRIP ASSEMBLY  
DWG. NO.  
TMMH-1XX-XX-XX-DV-XXX-X-XXX-XX  
BY: PURVIS 10/08/1996 SHEET 2 OF 5

STYLE	"E"	"F"	SHROUD
-01	.202[5.13]	.230[5.84]	TMMH-EL-01
-04	.149[3.78]	.177[4.50]	TMMH-EL-04
-05	.149[3.78]	.177[4.50]	TMMH-EL-04

STYLE	"J"	"K"	SHROUD
-01	.202[5.13]	.230[5.84]	TMMH-EC-01
-04	.149[3.78]	.177[4.50]	TMMH-EC-04
-05	.149[3.78]	.177[4.50]	TMMH-EC-04

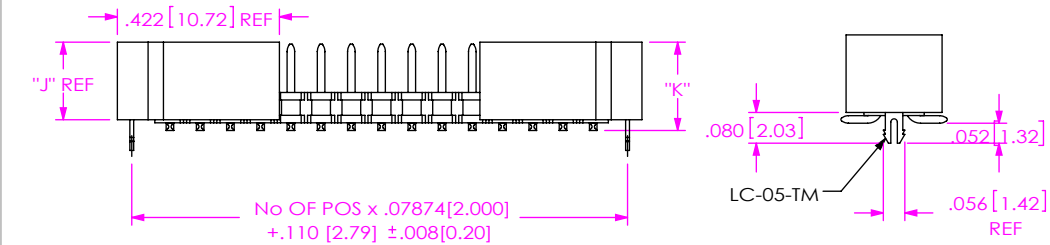
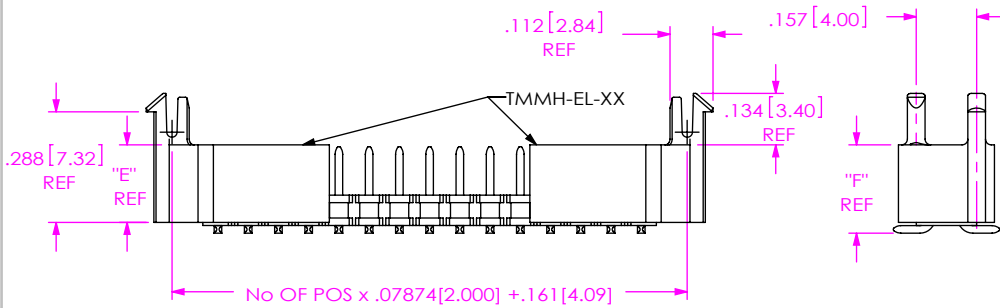
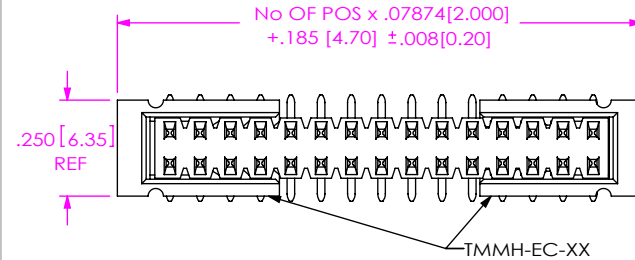
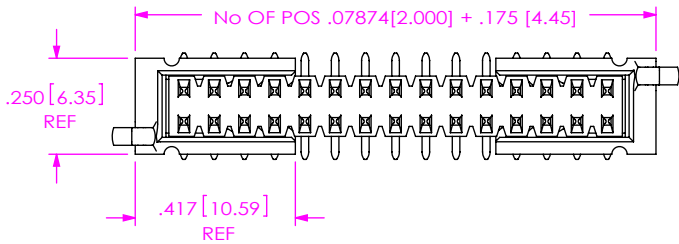
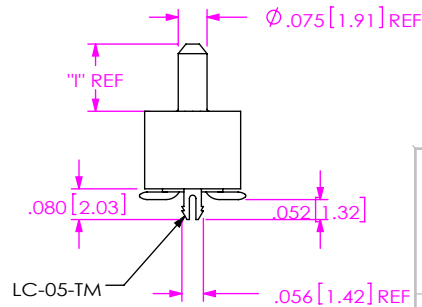
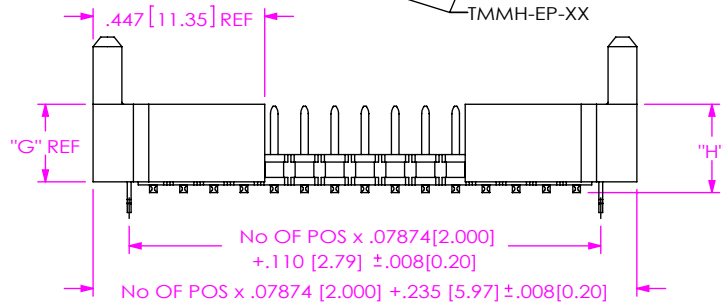
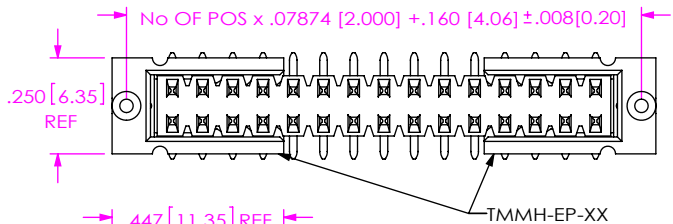


FIG 5  
-EL

(DIFFERENT AS SHOWN,  
OTHERWISE SAME AS FIG 1)

FIG 6  
-EC

(DIFFERENT AS SHOWN,  
OTHERWISE SAME AS FIG 1)



STYLE	"G"	"H"	"I"	SHROUD
-01	.202[5.13]	.230[5.84]	.175[4.45]	TMMH-EP-01
-04	.149[3.78]	.177[4.50]	.119[3.02]	TMMH-EP-04
-05	.149[3.78]	.177[4.50]	.119[3.02]	TMMH-EP-04

FIG 7  
-EPC

(DIFFERENT AS SHOWN,  
OTHERWISE SAME AS FIG 1)

PROPRIETARY NOTE

THIS DOCUMENT CONTAINS CONFIDENTIAL AND PROPRIETARY INFORMATION AND ALL DESIGN, MANUFACTURING, REPRODUCTION, USE, PATENT RIGHTS AND SALES RIGHTS ARE EXPRESSLY RESERVED BY SAMTEC, INC. THIS DOCUMENT SHALL NOT BE DISCLOSED, IN WHOLE OR PART, TO ANY UNAUTHORIZED PERSON OR ENTITY NOR REPRODUCED, TRANSFERRED OR INCORPORATED IN ANY OTHER PROJECT IN ANY MANNER WITHOUT THE EXPRESS WRITTEN CONSENT OF SAMTEC, INC.

SHEET SCALE: 2:1

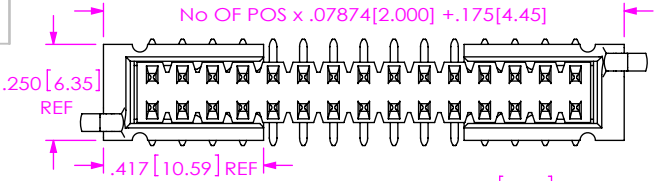


520 PARK EAST BLVD, NEW ALBANY, IN 47150  
PHONE: 812-944-6733 FAX: 812-948-5047  
e-Mail: info@SAMTEC.com code 55322

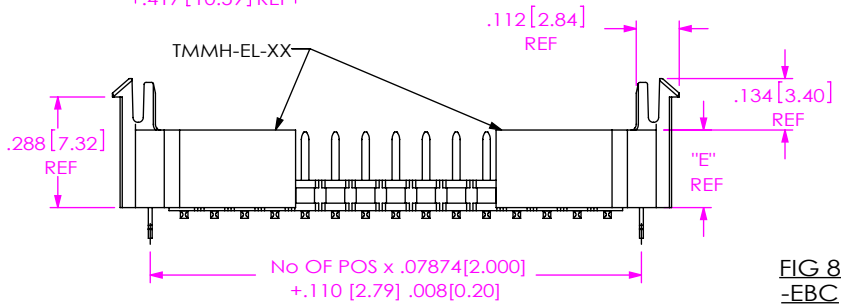
DESCRIPTION:  
2MM X 2MM TERMINAL STRIP ASSEMBLY

DWG. NO.  
TMMH-1XX-XX-XX-DV-XXX-X-XXX-XX

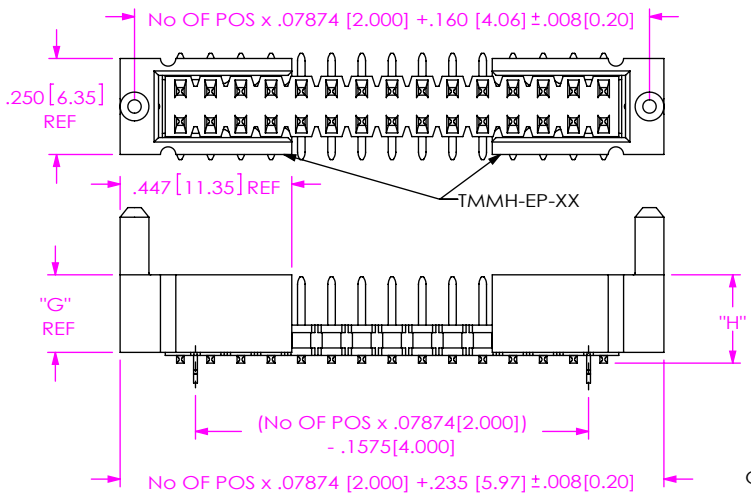
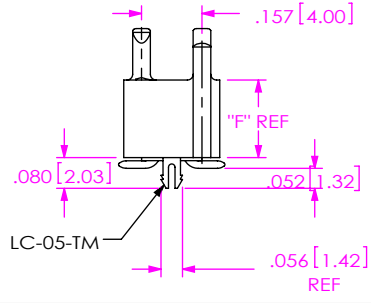
BY: PURVIS 10/08/1996 SHEET 3 OF 5



STYLE	"E"	"F"	SHROUD
-01	.202[5.13]	.230[5.84]	TMMH-EL-01
-04	.149[3.78]	.177[4.50]	TMMH-EL-04
-05	.149[3.78]	.177[4.50]	TMMH-EL-04

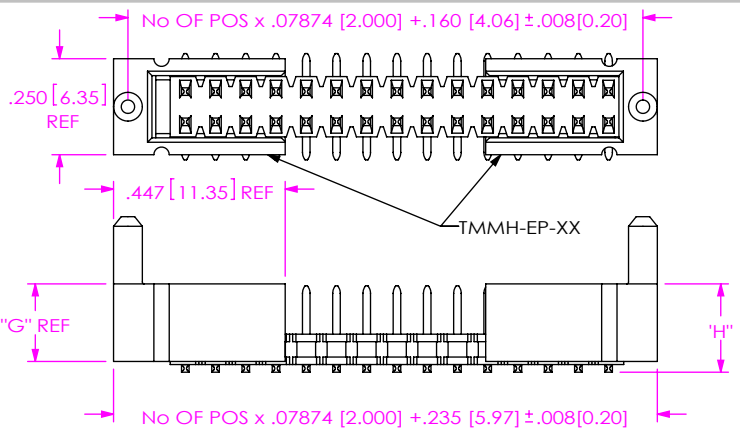
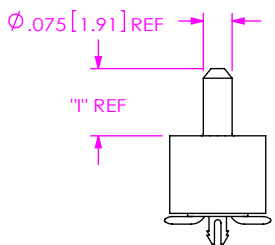


**FIG 8**  
-EBC  
(DIFFERENT AS SHOWN,  
OTHERWISE SAME AS FIG 1)



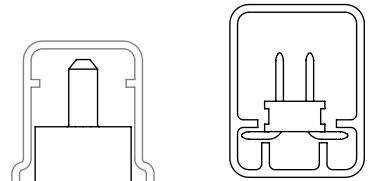
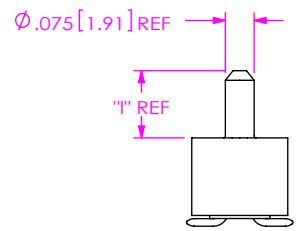
STYLE	"G"	"H"	"I"	SHROUD
-01	.202[5.13]	.230[5.84]	.175[4.45]	TMMH-EP-01
-04	.149[3.78]	.177[4.50]	.119[3.02]	TMMH-EP-04
-05	.149[3.78]	.177[4.50]	.119[3.02]	TMMH-EP-04

**FIG 9**  
-EP-LC  
(DIFFERENT AS SHOWN,  
OTHERWISE SAME AS FIG 2)



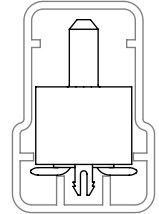
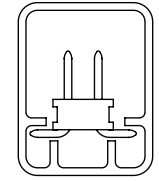
STYLE	"G"	"H"	"I"	SHROUD
-01	.202[5.13]	.230[5.84]	.175[4.45]	TMMH-EP-01
-04	.149[3.78]	.177[4.50]	.119[3.02]	TMMH-EP-04
-05	.149[3.78]	.177[4.50]	.119[3.02]	TMMH-EP-04

**FIG 10**  
-EP  
(DIFFERENT AS SHOWN,  
OTHERWISE SAME AS FIG 1)



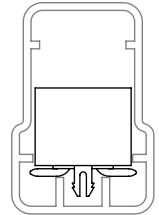
PT-TMMH001-DV-P

PT-TMMH002-DV-EX-P

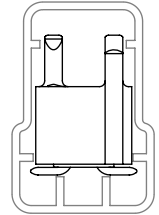


PT-TMMH001-DV-P

PT-TMMH002-DV-EX-P



PT-TMMH002-DV-EX-P



PT-TMMH002-DV-EX-P

**PACKAGING VIEW**

NONE, -A, -LC -M, -A-M -LC-M	PT-TMMH001-DV-P	TP-09
-EL-LC -EPC-M -EP-LC -ES, -EC -ES-A, -ES-LC -EL, -EL-M, -EL-A -EP, -EPC, -EBC, -EP-A-M -EP-A, -EC-M -ES-M, -ES-A-M -ES-LC-M	PT-TMMH002-DV-EX-P	TP-03

**PROPRIETARY NOTE**

THIS DOCUMENT CONTAINS CONFIDENTIAL AND PROPRIETARY INFORMATION AND ALL DESIGN, MANUFACTURING, REPRODUCTION, USE, PATENT RIGHTS AND SALES RIGHTS ARE EXPRESSLY RESERVED BY SAMTEC, INC. THIS DOCUMENT SHALL NOT BE DISCLOSED, IN WHOLE OR PART, TO ANY UNAUTHORIZED PERSON OR ENTITY NOR REPRODUCED, TRANSFERRED OR INCORPORATED IN ANY OTHER PROJECT IN ANY MANNER WITHOUT THE EXPRESS WRITTEN CONSENT OF SAMTEC, INC.

SHEET SCALE: 2:1

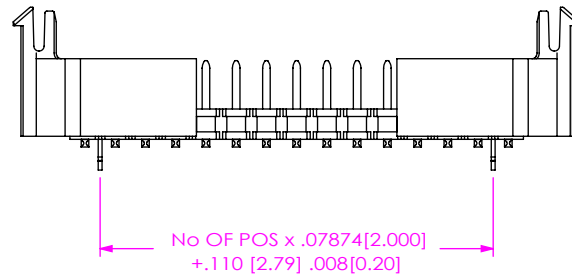


520 PARK EAST BLVD, NEW ALBANY, IN 47150  
PHONE: 812-944-6733 FAX: 812-948-5047  
e-Mail: info@SAMTEC.com code 53322

DESCRIPTION:  
2MM X 2MM TERMINAL STRIP ASSEMBLY

DWG. NO.  
TMMH-1XX-XX-XX-DV-XXX-X-XXX-XX

BY: PURVIS 10/08/1996 SHEET 4 OF 5



**FIG 11**  
**-EL-LC**  
 (DIFFERENT AS SHOWN,  
 OTHERWISE SAME AS FIG 8)

**PROPRIETARY NOTE**  
 THIS DOCUMENT CONTAINS CONFIDENTIAL AND PROPRIETARY INFORMATION AND ALL DESIGN, MANUFACTURING, REPRODUCTION, USE, PATENT RIGHTS AND SALES RIGHTS ARE EXPRESSLY RESERVED BY SAMTEC, INC. THIS DOCUMENT SHALL NOT BE DISCLOSED, IN WHOLE OR PART, TO ANY UNAUTHORIZED PERSON OR ENTITY NOR REPRODUCED, TRANSFERRED OR INCORPORATED IN ANY OTHER PROJECT IN ANY MANNER WITHOUT THE EXPRESS WRITTEN CONSENT OF SAMTEC, INC.



520 PARK EAST BLVD, NEW ALBANY, IN 47150  
 PHONE: 812-944-6733 FAX: 812-948-5047  
 e-Mail info@SAMTEC.com code 55322

SHEET SCALE: 2:1

DESCRIPTION:  
2MM X 2MM TERMINAL STRIP ASSEMBLY

DWG. NO.  
TMMH-1XX-XX-XX-DV-XXX-X-XXX-XX

BY: PURVIS 10/08/1996 SHEET 5 OF 5