

High Reliability and an Extensive Lineup allow these Omron products to fit into various applications.

New

# EE-SX Photomicrosensor Series Surface Mount Type Family

**Extensive Lineup**

Wide Range of product offerings include 2-5 mm slot width options with Phototransistor, Photo-IC and 2-channel output capabilities.

**Reliable SMT Technology**

Side printed solder joints grant highly reliable surface mount connections to printed circuit boards.



## The Technological Outline

Transmissive type SMD						
Model	Photo transistor Output	EE-SX1320	EE-SX1321 (2 ch Type)	EE-SX1330	EE-SX1340	EE-SX1350
	Photo-IC Output	EE-SX4320	—	—	EE-SX3340 EE-SX4340	EE-SX3350 EE-SX4350
Appearance						
Slot width	2mm		2mm	3mm	4mm	5mm
Aperture width W x H (mm)	Emitter : 1.4 x 1.4 Receiver : 0.3 x 1		Emitter : 1.4 x 1.4 (1) Receiver : 0.3 x 1 (2)	Emitter : 1.4 x 1.4 Receiver : 0.3 x 1	Emitter : 1.4 x 1.4 Receiver : 0.3 x 1	Emitter : 1.4 x 1.4 Receiver : 0.5 x 1.4
Housing size W x D x H (mm)	5.1 x 4 x 4		5.1 x 4 x 4	6 x 4 x 5	8 x 4 x 5.5	9 x 4 x 9

### Features

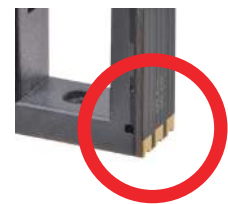

\*The side terminal/ flat bottomed solder joints, enable stable surface mount connections with high-reliability performance.

## Application

### ■ For equipment downsizing

Business equipment (label printer)



Network Camera



Business phone (Hook switch)



Push button (non-contact switch)

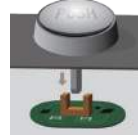

### ■ For equipment using double-sided PC boards

3D printer



Coffee server



Water pump



Gas meter



Home appliance (Knob module)

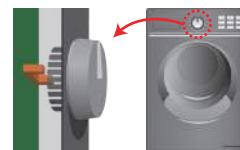

Contact Us

Americas HQ - 2895 Greenspoint Parkway, Suite 300, Hoffman Estates, IL 60169  
[www.components.omron.com](http://www.components.omron.com)  
[components@omron.com](mailto:components@omron.com)