

THIS DRAWING IS A CONTROLLED DOCUMENT.

REV NO 1528439

THIS INFORMATION IS CONFIDENTIAL AND PROPRIETARY TO TECCO AND APPLICATOR. IT IS TO BE USED ONLY FOR THE PURPOSES OF THE ORIGINAL ORDER AND ANY REPRODUCTION OR TRANSMISSION IN ANY FORM OR BY ANY MEANS, WITHOUT AUTHORIZATION FROM TECCO IS STRICTLY PROHIBITED.

PART NUMBER	REV	FIRST USED	TERMINATOR	FEED TYPE	DESCRIPTION
1528439-1	B	-	LEADMAKER	MECH POST FEED	CUTS CARRIER
1528439-2	B	-	BENCH	MECH PRE FEED	CUTS CARRIER
1528439-6	B	-	LEADMAKER	MECH POST FEED	CONTINUOUS CARRIER
7-1528439-1	B	-	LEADMAKER	MECH POST FEED	-1 AND SPARE PARTS
7-1528439-2	B	-	BENCH	MECH PRE FEED	-2 AND SPARE PARTS
7-1528439-6	B	-	LEADMAKER	MECH POST FEED	-6 AND SPARE PARTS
7-1528439-7	A	-	-	-	SPARE PARTS KIT

CRIMP DATA AMP TERMINAL AMP CRIMP SPECS			
TERMINAL NAME: TAB 5.8 X 0.8 ASSEMBLY.			
CRIMP	SIZE	TYPE	RANGE
WIRE	3.30 [.130 IN]	F	>2.5mm ² - 4.0mm ²
INSUL	6.60 [.260 IN]	0	6.00 MAX [.236 IN MAX]
WIRE STRIP LENGTH		APPL INSTRUCTION	
5.05-6.05 [.199-.238 IN]		408-8322 & 408-8490	
TERMINAL APPL SPEC		FEED	
114-18052		19.50 [.768 IN]	

TERMINALS APPLIED				
TERMINAL	SEAL	-	-	-
964314	963245	-	-	-
-	-	-	-	-
-	-	-	-	-
-	-	-	-	-
-	-	-	-	-
-	-	-	-	-
-	-	-	-	-
-	-	-	-	-
-	-	-	-	-
-	-	-	-	-
-	-	-	-	-

WIRE SIZE	CRIMP HEIGHT	REF SETTING
mm ² AWG	*	*
4.0mm ²	2.34 ±0.05 [.092 ±.002 IN]	C 9
-	-	-
-	-	-
-	-	-
-	-	-
-	-	-
-	-	-
-	-	-
-	-	-
-	-	-
-	-	-
-	-	-
-	-	-
-	-	-
-	-	-
-	-	-
-	-	-
-	-	-
-	-	-
-	-	-
-	-	-
-	-	-
-	-	-
-	-	-
-	-	-
-	-	-
-	-	-
-	-	-
-	-	-

SET UP GAGE	LAYOUT
458637-3	L1426465

1. RECOMMENDED SPARE PARTS.
2. GREASE RAM, CAM, CAM FOLLOWER AND FEED ROD LIGHTLY.
3. LUBRICATE DAILY PER THE APPLICATOR INSTRUCTION SHEET SUPPLIED WITH THE APPLICATOR.
4. THIS APPLICATOR APPLIES TERMINAL WITH A SEAL. INSULATION DIA QUOTED IS OUTSIDE DIAMETER OF SEAL. WIRE INSULATION DIA IS DEPENDENT ON SEAL BEING APPLIED. FULL TERMINAL INSULATION DIA RANGE 3.4-4.5mm[.134-.177IN]. SEAL P/N 963245 INSULATION DIA RANGE 3.4-3.7mm[.134-.146IN].
5. APPLY TORQ-SEAL IN ALLEN SOCKET TO FILL HOLE AFTER FLAT HD HAS BEEN ADJUSTED TO CORRECT HEIGHT AT QUALIFICATION. APPLY #1-23419-5 LOC-TITE TO THREADS.
6. CUT TO LENGTH AT ASSY.

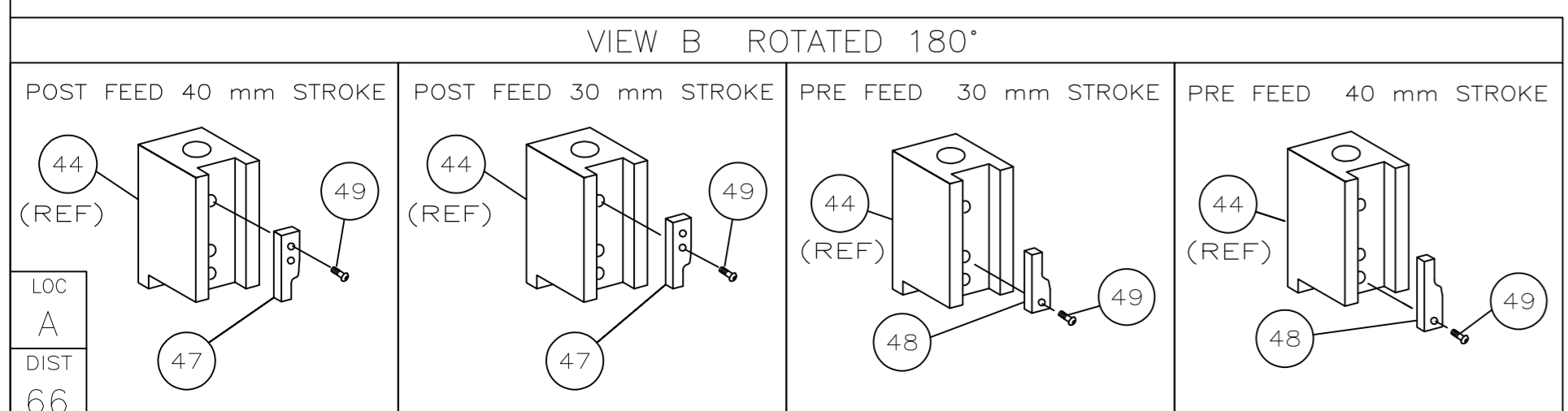

*** WARNING:**
ON INSTALLATION, SET WIRE DISC TO LARGEST WIRE SIZE SETTING. USE OF SETTINGS BELOW MIN REQUIRED CRIMP HEIGHT SETTING WILL CAUSE DAMAGE TO CRIMP TOOLING.

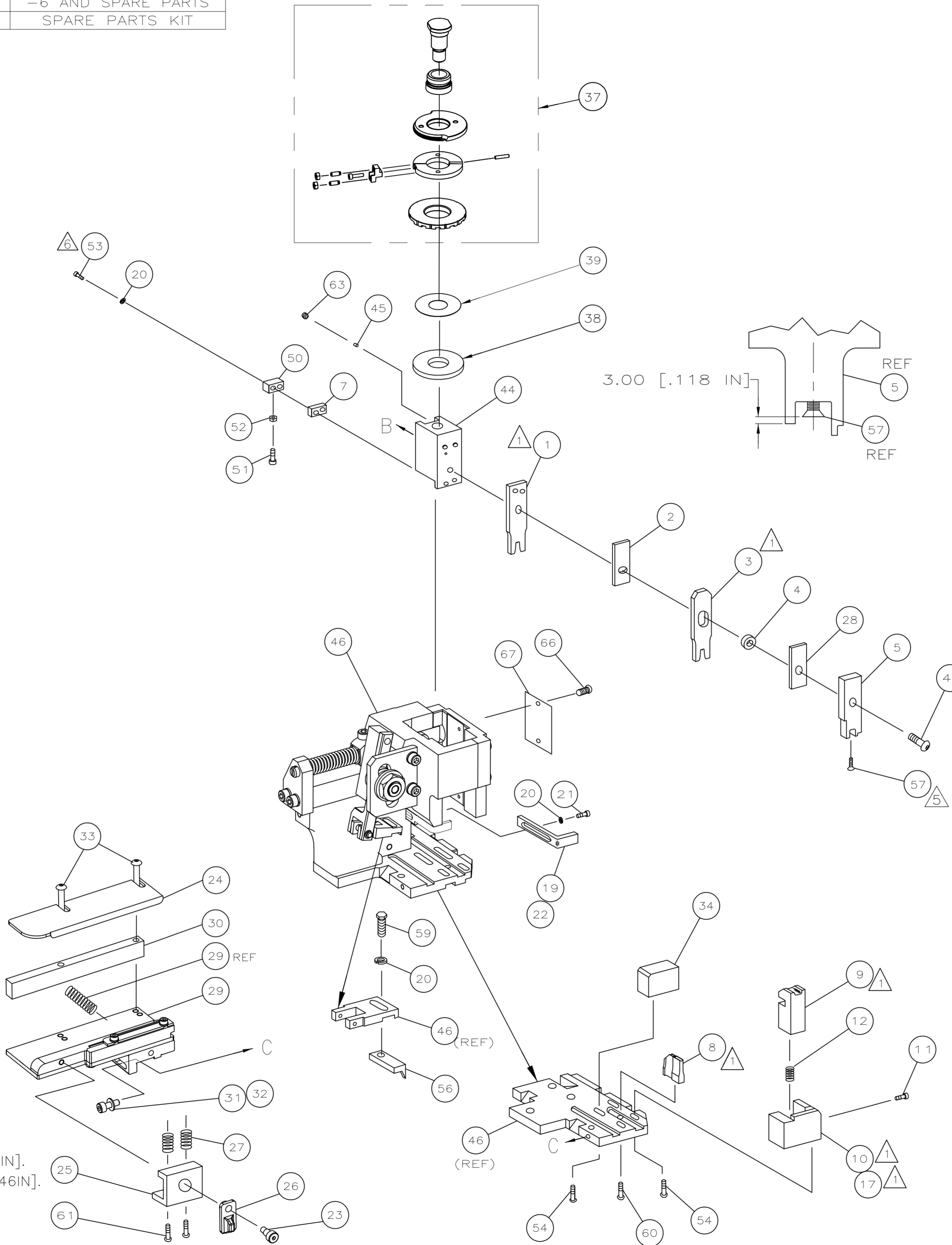
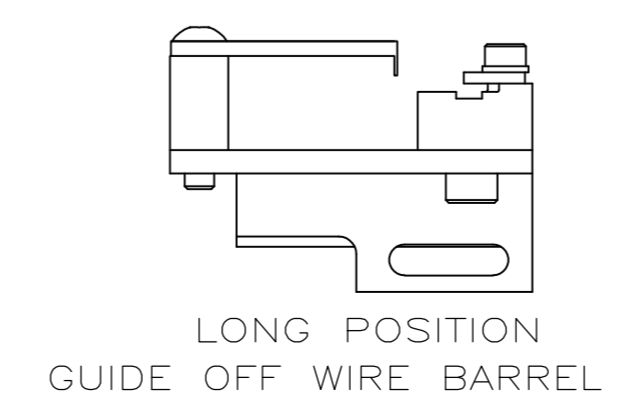

QTY	REQD	PER	ASSY	PART NO	DESCRIPTION	ITEM NO	
-	1	1	1	1	1	1528439 PRINT, APPLICATOR LOG SHEET	72
-	1	1	1	1	1	1338705-3 DOCUMENTATION PACKAGE	71
-	-	-	-	-	-		70
-	-	-	-	-	-		69
-	-	-	-	-	-		68
-	1	1	1	1	1	461264-5 PLATE, IDENTIFICATION	67
-	2	2	2	2	2	21017-2 SCR,DRIVE(#2x.19)ID PLATE	66
-	-	-	-	-	-		65
-	-	-	-	-	-		64
-	1	1	1	1	1	3-18031-0 SCR,SKT SET(M6X6)RAM	63
-	-	-	-	-	-		62
-	2	2	2	2	2	1-18024-5 SCR,BHC(M5X25)DRAG	61
-	1	1	1	1	1	18024-7 SCR,BHC(M4X10)ANVIL	60
-	1	1	1	1	1	5-18022-2 SCR,HEX(M4X8)FEED FINGER	59
-	-	-	-	-	-		58
-	1	1	1	1	1	985575-3 SCR,FHC(M3X10)DEP	57
-	1	1	1	1	1	1338685-1 PAWL, FEED	56
-	-	-	-	-	-		55
-	4	4	4	4	4	18024-8 SCR,BHC(M4x12)SHEAR HOLDER	54
-	2	2	2	2	2	9-18023-6 SCR,SHC(M4x14)TERM HLD DWN	53
-	1	1	1	1	1	18030-1 NUT,HEX(M3)HOLD DWN	52
-	1	1	1	1	1	811242-5 BUMPER, HOLDDOWN	51
-	1	1	1	1	1	690753-2 SPACER, TONKER	50
-	1	1	1	1	1	18024-3 SCR,BHC(M3X10)CAM	49
-	-	-	-	-	-		48
-	-	-	-	-	-		47
-	1	1	1	1	1	1338676-1 CAM, POST FEED 30 & 40 mm ST	46
-	1	1	1	1	1	1320999-3 APPLICATOR BASIC SUBASSY	45
-	1	1	1	1	1	690191-1 PLUG, NYLON	44
-	1	1	1	1	1	1333257-1 RAM	43
-	-	-	-	-	-		42
-	1	1	1	1	1	992285-2 SCR,SHC(M8X25)RAM LOW HD	41
-	-	-	-	-	-		40
-	1	1	1	1	1	690125-1 SHIM SUBASSY	39
-	1	1	1	1	1	469367-4 SPACER, FINE ADJUST	38
-	1	1	1	1	1	879103-2 FINE ADJUST HEAD SUBASSY	37
-	-	-	-	-	-		36
-	-	-	-	-	-		35
-	1	1	1	1	1	2-1320934-8 SUPPORT, TERMINAL	34
-	2	2	2	2	2	1-18024-0 SCR,BHC(M4X20)STRIP GUIDE	33
-	1	1	1	1	1	18027-2 WASHER, FLAT(M4)	32
-	1	1	1	1	1	1-18023-2 SCR,SKT CAP(M4X12)MOUNT BLOCK	31
-	1	1	1	1	1	1-1320908-0 SPACER, STRIP GUIDE	30
-	1	1	1	1	1	1633073-2 STRIP GUIDE PLATE ASSY	29
-	1	1	1	1	1	1-455888-5 SPACER, FRONT SHEAR DEP	28
-	2	2	2	2	2	1-22284-0 SPRING, DRAG	27
-	1	1	1	1	1	356835-1 LEVER, DRAG RELEASE	26
-	1	1	1	1	1	240792-1 DRAG, TERMINAL	25
-	1	1	1	1	1	1320928-1 PLATE, STRIP GUIDE	24
-	1	1	1	1	1	980371-4 SCR,SHC SHLD	23
-	1	-	-	-	-	690472-2 STRIPPER	22
-	1	1	1	1	1	1-18023-1 SCR,SHC(M4X10)STRIPPER	21
-	4	4	4	4	4	18025-2 WASHER,LOCK(M4)STRIPPER	20
-	-	-	-	-	-	690472-1 STRIPPER	19
-	-	-	-	-	-		18
-	1	-	-	-	-	1338684-2 HOLDER, SHEAR, FRONT (NO-CUT)	17
-	-	-	-	-	-		16
-	-	-	-	-	-		15
-	-	-	-	-	-		14
-	-	-	-	-	-		13
-	1	1	1	1	1	5-22280-0 SPRING, SHEAR	12
-	1	1	1	1	1	356885-5 STOP, SHEAR	11
-	-	-	-	-	-	1-1320921-0 HOLDER, SHEAR, FRONT (CUT)	10
-	1	1	1	1	1	318707-9 SHEAR, FLOAT (FRONT)	9
-	1	2	2	2	2	1333229-8 ANVIL	8
-	-	-	-	-	-	1-240641-7 SPACER, DEPRESSOR (REAR)	7
-	-	-	-	-	-		6
-	1	1	1	1	1	1338680-8 DEPRESSOR, SHEAR (FRONT)	5
-	1	1	1	1	1	238011-2 SPACER, BLOCK CRIMPER	4
-	1	2	2	2	2	1-1583690-2 CRIMPER, INSULATION	3
-	1	1	1	1	1	455888-4 SPACER, CRIMPER	2
-	1	2	2	2	2	1-456410-7 CRIMPER, WIRE	1

QTY REQD PER ASSY	REV	15JUL04	MATERIAL	HEAT TREAT
DWN M.CLIFFORD	CHK			
APVD F.BACKHURST	15JUL04			
NAME	FINE ADJ SIDE FD HD-I APPL		TE Connectivity	
SCALE	SIZE	DRAWING NO	SHEET	REV
	A1	1528439	1 of 1	B
CUSTOMER ACCESSIBLE PRODUCTION DRAWING				