

REVISIONS			
REV	DESCRIPTION, ECN, EAR NO.	DATE	APP'D
A	PROPOSAL	APR14/20	L.CHAN

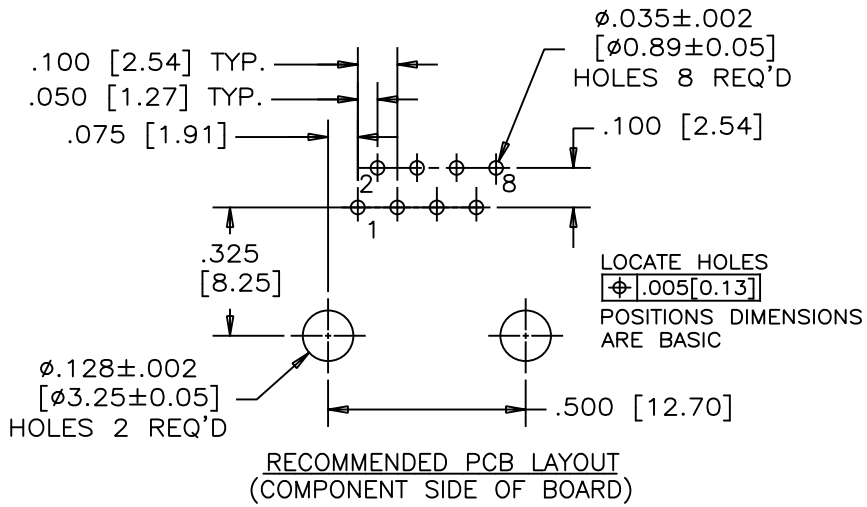
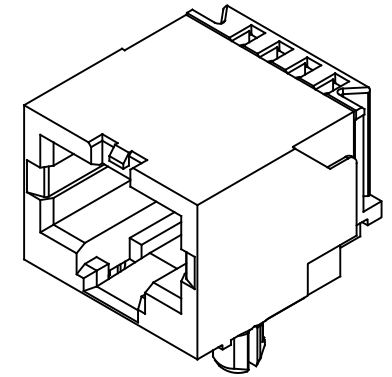
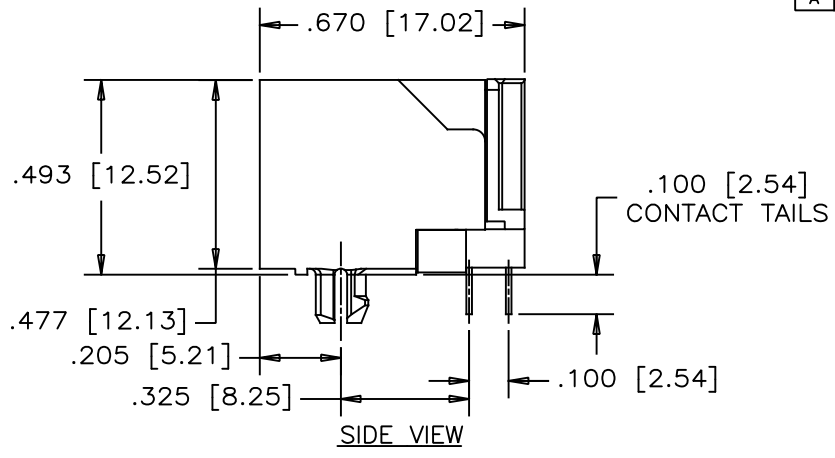
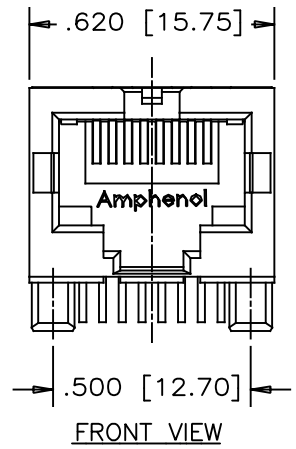

**MATERIALS:**  
**HOUSING:** ENGINEERING THERMOPLASTIC. FLAMMABILITY RATING UL 94V-0, COLOR: BLACK  
**CONTACTS:** PHOSPHOR BRONZE  
**PLATING:** SELECTIVE GOLD PLATING ON MATING SURFACE, SEE PART NO. FOR THICKNESS.  
 50µ" [1.27 MICRONS] MIN. NICKEL UNDERPLATE.  
 100µ" [2.54 MICRONS] MIN. MATTE-TIN OR GOLD FLASH ON CONTACT TAILS.

**RECOMMENDED SOLDERING TEMPERATURE:**  
 WAVE SOLDERING AT 260° MAXIMUM FOR 5~8 SECONDS.

**AMPHENOL PART NUMBER:** RJSBE-X080-C1

**GOLD PLATING OPTIONS:**  
 D= 6µ" GOLD PLATING  
 G= 15µ" GOLD PLATING  
 J= 30µ" GOLD PLATING  
 5= 50µ" GOLD PLATING

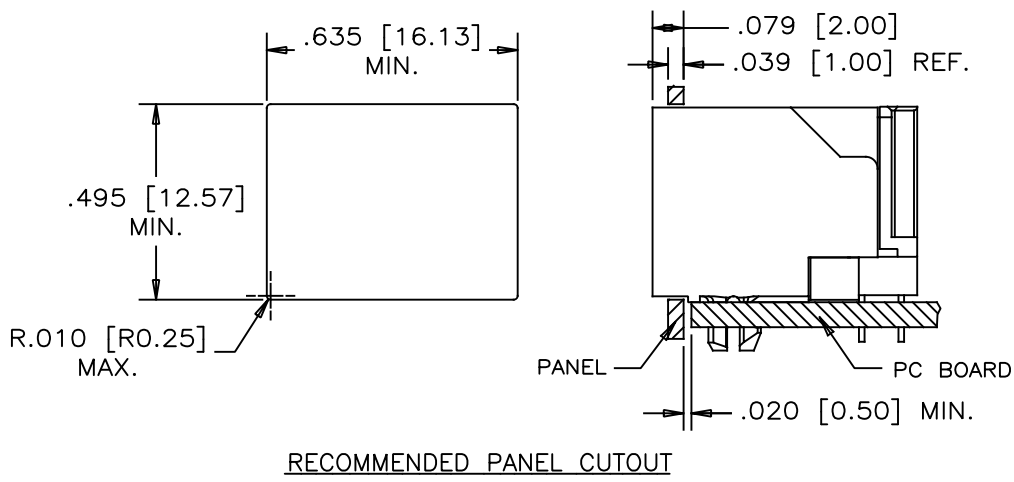

UNLESS SPECIFIED OTHERWISE		DRAWN RONNIE.C	APR14/20	Amphenol Canada Corp. Commercial Products
PRIMARY UNITS INCHES		CHECKED KELVIN.T	APR14/20	
SECONDARY MILLIMETERS		M.E. APP'D		SINGLE PORT MODULAR JACK, 8 POSITION, 8 CONTACTS, UNSHIELDED GOLD PLATING OPTION, WITHOUT LED -ROHS COMPLIANT
REFERENCE IN PARENTHESES		Q.A. APP'D		
GENERAL TOLERANCES		DWG APP'D		
1 DECIMAL PLACE		ENG. REL. NO.		DWG NO.
2 DECIMAL PLACES		REF.		P-RJSBE-X080-C1
3 DECIMAL PLACES	±.015	THIRD ANGLE PROJECTION	DO NOT SCALE DRAWING	REV A
ANGULAR DEGREES	±1.5°			CODE ID NO. 03554 DWG SIZE X SCALE 1:1 SHEET 1 OF 1