

THIS DRAWING IS A CONTROLLED DOCUMENT.

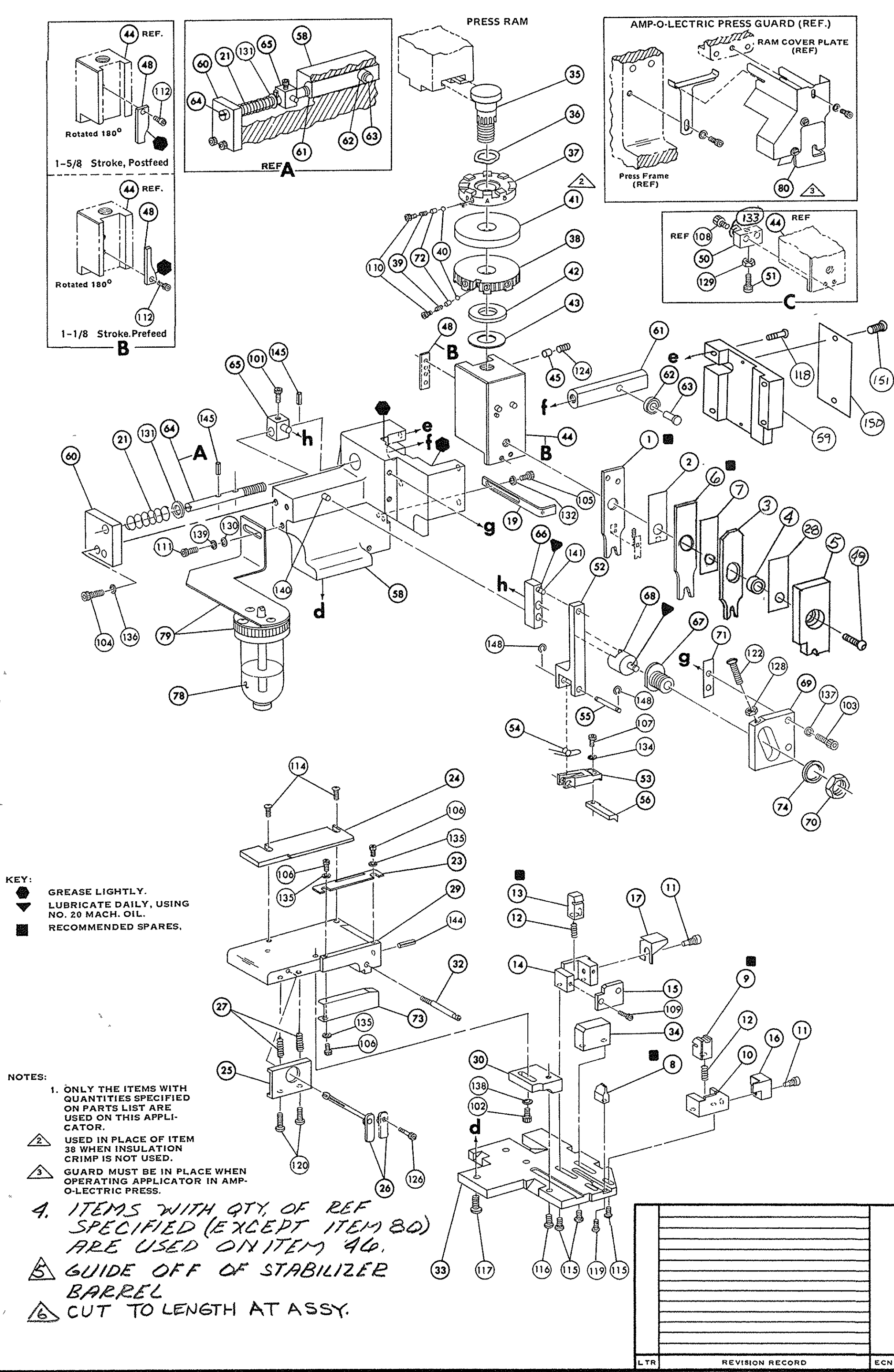

REF	21045-3	RING, RETNG "C" (.187 DIA) FEED FINGER PIN	148	REF	454485-1	HOUSING	58
REF	5-21028-1	PIN, SLTD SPRNG (.125 DIA x .50) ADJ ROD	145	REF	690542-2	PAWL, FEED	56
1	4-21028-0	PIN, SLTD SPRNG (.093 DIA x .75) S. G. PL	144	REF	240624-1	PIN, FEED FINGER	55
REF	1-21030-1	PIN, DOWEL (.187 DIA x .50) LEVER	141	REF	691499-1	SPRING, FEED FINGER	54
REF	1-21030-6	PIN, DOWEL (.187 DIA x 1.25) HOUSING	140	REF	690541-1	FINGER, FEED	53
1	21024-5	WASHER, LOCK (NO. 10) LUB ASSY	139	REF	455679-1	LEVER, TERMINAL FEED ARM	52
1	21024-5	WASHER, LOCK (NO. 10) STRIP GUIDE ADJ BLK	138	1	811242-2	BUMPER, HOLDDOWN	51
REF	21024-5	WASHER, LOCK (NO. 10) ADJ PLATE	137	1	690753-1	SPACER, TONKER	50
REF	21024-5	WASHER, LOCK (NO. 10) FEED GUIDE ROD	136	1	721002-9	BOLT, CRIMPER	49
3	21057-2	WASHER, LOCK (NO. 4) FRONT STRIP GUIDE	135	1	690602-5	CAM PREFEED 1/8 STROKE	48
1	21024-4	WASHER, LOCK (NO. 8) FEED FINGER	134	1	459456-1	APPL BASIC (SUB ASSY)	46
2	21024-4	WASHER, LOCK (NO. 8) DEPRESSOR	133	1	690191-1	PLUG, NYLON	45
1	21024-4	WASHER, LOCK (NO. 8) STRIPPER	132	1	455673-1	RAM	44
REF	21899-4	WASHER, FLAT (5/16 DIA) SCREW ADJ	131	2	690125-1	WASHER, LAMINATED	43
1	21899-2	WASHER, FLAT (NO. 10) LUB ASSY	130	2	690124-1	WASHER, RAM	42
1	21068-5	NUT, HEX MACH (6-32) HOLDDOWN	129	1	690124-1	DISC, SPACER	41
REF	21068-5	NUT, HEX MACH (6-32) FEED ADJ	128	1	23241-6	BALL, STEEL	40
1	22353-8	SCREW, SHLDR (.187 DIA x .250 LG) DRAG LEVER	126	1	690170-1	SPRING, COMPRESSION	39
1	21009-2	SCREW, SKT SET (1/4-20 x .25) (NYLOK) RAM	125	1	690142-1	DISC, INSULATION	38
REF	3-21064-2	SCREW, RD HD MACH (6-32 x 1.50) FEED ADJ	122	REF	1-690142-2	DISC, WIRE	37
2	2-21002-9	SCREW, BTN HD SKT CAP (10-32 x .75) DRAG	120	1	22480-5	WASHER, SPRING	36
1	22733-8	SCREW, BTN HD SKT CAP (8-32 x .38) ANVIL	119	1	690212-1	POST, RAM	35
REF	2-21002-9	SCREW, BTN HD SKT CAP (10-32 x .75) CAP	118	REF	460712-1	SUPPORT, TERMINAL	34
REF	1-24073-9	SCREW, BTN HD SKT CAP (NYLOK) 1/4-20 x .75 HSG	117	1	455675-1	PLATE, BASE	33
REF	2-21002-7	SCREW, BTN HD SKT CAP (10-32 x .50) S.G. ADJ BLK	116	1	690432-3	SCREW, ADJUSTMENT	32
4	2-21002-2	SCREW, BTN HD SKT CAP (8-32 x .50) SHEAR	115	1	455689-1	BLOCK, STRIP GUIDE ADJ	31
2	221002-2	SCREW, BTN HD SKT CAP (8-32 x .50) R. S. G.	114	1	455671-5	PLATE, STRIP GUIDE	30
1	1-21002-7	SCREW, BTN HD SKT CAP (6-32 x .39) CAM	112	REF	455888-3	SPACER, F. SHEAR DEPRESSOR	28
1	3-21000-4	SCREW, SKT HD CAP (10-32 x .38) LUB ASSY	111	1	22284-0	SPRING, DRAG	27
2	23030-1	SCREW, SKT HD CAP (6-32 x .25) (NYLOK) C.P. DISC	110	1	690546-1	LEVER, DRAG RELEASE	26
2	2-21000-7	SCREW, SKT HD CAP (6-32 x . ) R. SHEAR PLATE	109	1	240792-1	DRAG, STOCK	25
2	2-21000-7	SCREW, SKT HD CAP (8-32 x 4-6) DEPRESSOR	108	1	690504-3	GUIDE, STRIP REAR	24
1	222603-0	SCREW, SKT HD CAP (8-32 x .31) FEED FINGER	107	1	690438-1	GUIDE, STRIP FRONT	23
3	1-21000-3	SCREW, SKT HD CAP (4-40 x .25) F. STRIP GUIDE	106	REF	4-22284-9	SPRING, FEED RETURN	21
1	2-21000-7	SCREW, SKT HD CAP (8-32 x .50) STRIPPER	105	1	691353-1	STRIPPER	19
REF	3-21000-7	SCREW, SKT HD CAP (10-32 x .75) FEED ROD G.	104	1	455689-1	BLOCK, STRIP GUIDE ADJ	30
REF	3-21000-6	SCREW, SKT HD CAP (10-32 x .62) FEED ADJ BLK	103	1	455671-5	PLATE, STRIP GUIDE	29
1	3-21000-4	SCREW, SKT HD CAP (10-32 x .38) LUB ASSY	102	1	455888-3	SPACER, F. SHEAR DEPRESSOR	28
REF	3-21000-4	SCREW, SKT HD CAP (10-32 x .38) PIVOT BLOCK	101	1	22284-0	SPRING, DRAG	27
REF	455749-1	GUARD (WINDOW)	80	1	690459-1	HOLDER, SHEAR FRONT	10
1	1-465184-0	LUBRICATOR ASSY	79	1	454216-1	SHEAR, FLOAT FRONT	9
1	1-465184-0	OIL SYNTHETIC	78	1	1-458834-3	ANVIL	8
REF	458109-1	WASHER, FLAT, SPECIAL	77	1	455888-2	SPACER, SIZING TOOL	7
1	454877-3	PLATE, STRIP GUIDE COVER	76	1	460130-1	TOOL, SIZING	6
2	690603-1	SPRING, ASSIST	75	1	1-455889-3	DEPRESSOR, SHEAR FRONT	5
REQ.	PART NO.	DESCRIPTION	NO.	REQ.	PART NO.	DESCRIPTION	NO.

TERM APPL SPEC 114-25008

CRIMPING DATA					THIS APPLICATOR WILL APPLY	
PAD LETTER	CRIMP HEIGHT	WIRE SIZE	WIRE STRIP LENGTH	27269		
A	.048	18				
B	.043	20				
C	.040	22				
D	NOT USED					
CRIMP	SIZE	TYPE	FEED	USED ON		
WIRE	.070	"F"	.420	MACH NO.		
INSULATION	110	"D"		565435.5		
INSULATION RANGE	WIRE RANGE	APPLICATOR INSTRUCTION	A 3040			
.050-100 DIA	18-22					
REMARKS						
AMP-O-LECTRIC PRE FEED						
SET UP GAGE	LAYOUT NO.	AMP INCORPORATED HARRISBURG, PENNA.				
458837-1	681					
E ECR 05-009434		APPROVED		LOC A C		
D ECN A-153588		REL. 11/8/73		NO. 466007-2		
C DARKENED		SCALE NONE		REV E		
B REV. PER ECN		NAME				
A REV. PER ECN		DATE				
APPLICATOR MINIATURE QUICK CHANGE SIDE-FEED (CONTACT)						