

REV.	DATE	DESCRIPTION
NC	01/02/07	INITIAL RELEASE

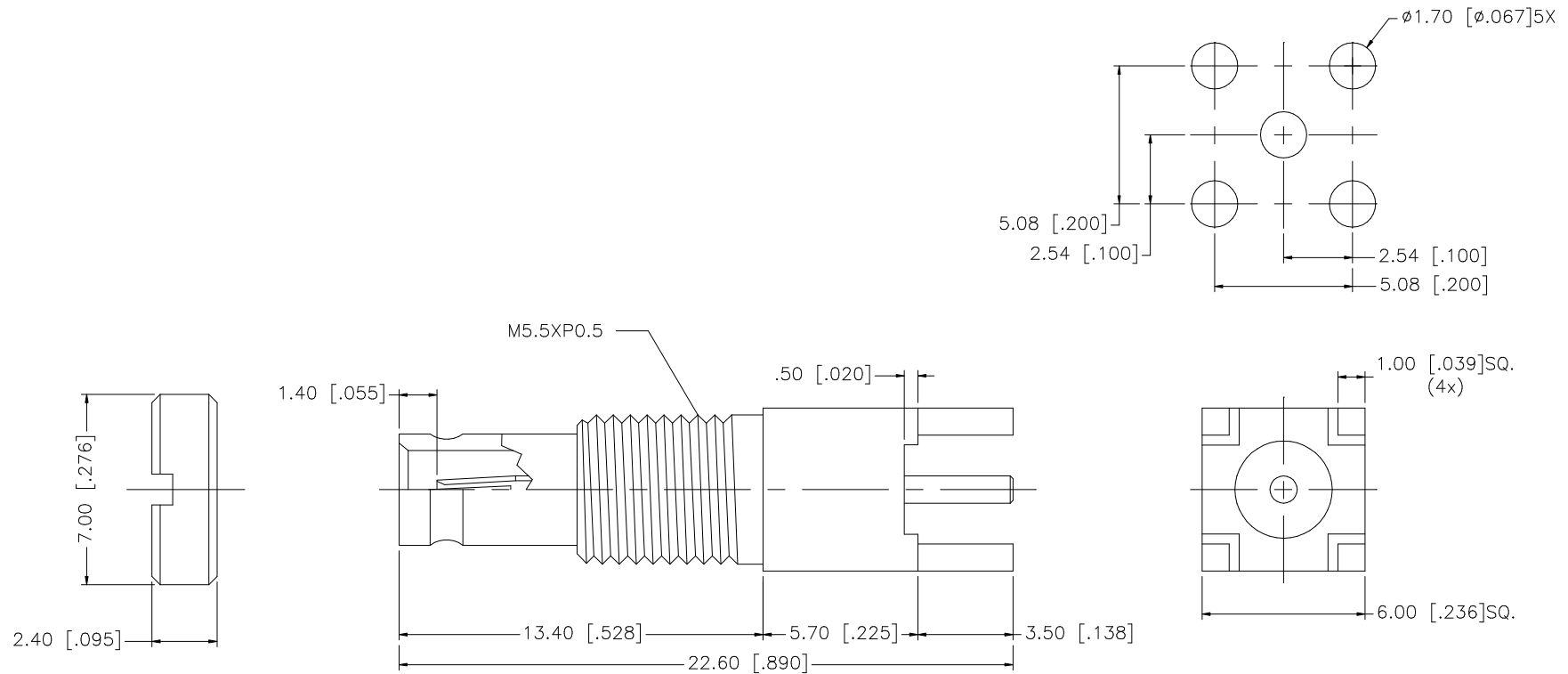

8				<small>UNLESS OTHERWISE SPECIFIED DIMENSIONS ARE IN MILLIMETERS. DIMENSIONS IN [ ] ARE IN INCHES AND FOR CUSTOMER REFERENCE ONLY.</small>  <small>UNLESS OTHERWISE SPECIFIED TOLERANCES FOR MILLIMETERS ARE:  0.5 - 8mm <math>\pm</math> 0.20mm  8 - 30mm <math>\pm</math> 0.40mm  30 - 120mm <math>\pm</math> 0.50mm</small>  <small>UNLESS OTHERWISE SPECIFIED TOLERANCES FOR INCHES ARE:  .020 - .315 = <math>\pm</math> 0.007"  .315 - 1.180 = <math>\pm</math> 0.015"  1.180 - 4.724 = <math>\pm</math> 0.020"</small>	APPROVALS	DATE	<h1 style="color: blue;">Amphenol Connex</h1>		
7					DRAWN	G.R.S.		01/02/07	
6						CHECKED		PART DESCRIPTION	
5						ISSUED		1.0/2.3 PCB BULKHEAD RECEPTACLE - 75ohm	
4	SPANNER NUT	BRASS	NICKEL		1	SHEET	1 OF 1	PART NO.	
3	CONTACT PIN	BER. COPPER	GOLD	1			282121-75		
2	INSULATOR	TEFLON	NATURAL	1			DWG. NO.		
1	BODY	BRASS	GOLD	1			282121-75.DWG		
	DESCRIPTION	MATERIAL	FINISH	QTY	DO NOT SCALE DRAWING	C:/282/282121-75.DWG	REV. A	SIZE A	SCALE NA