

REVISIONS			
REV	DESCRIPTION, ECN, EAR NO.	DATE	APP'D
A	PROPOSAL FOR EAR# RJ19077	JUN11/19	L.CHAN

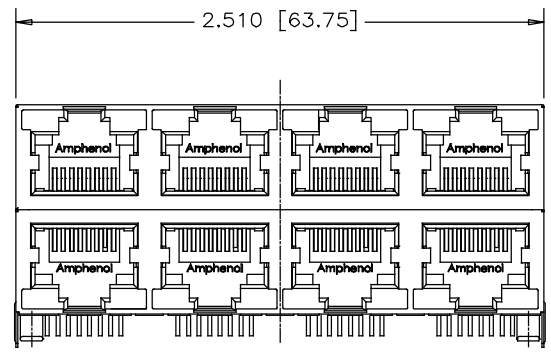

FRONT VIEW

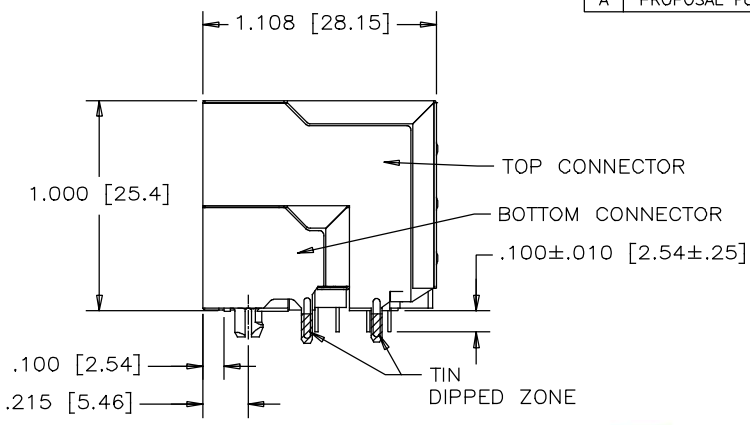

SIDE VIEW

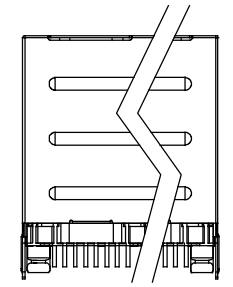

BACK VIEW

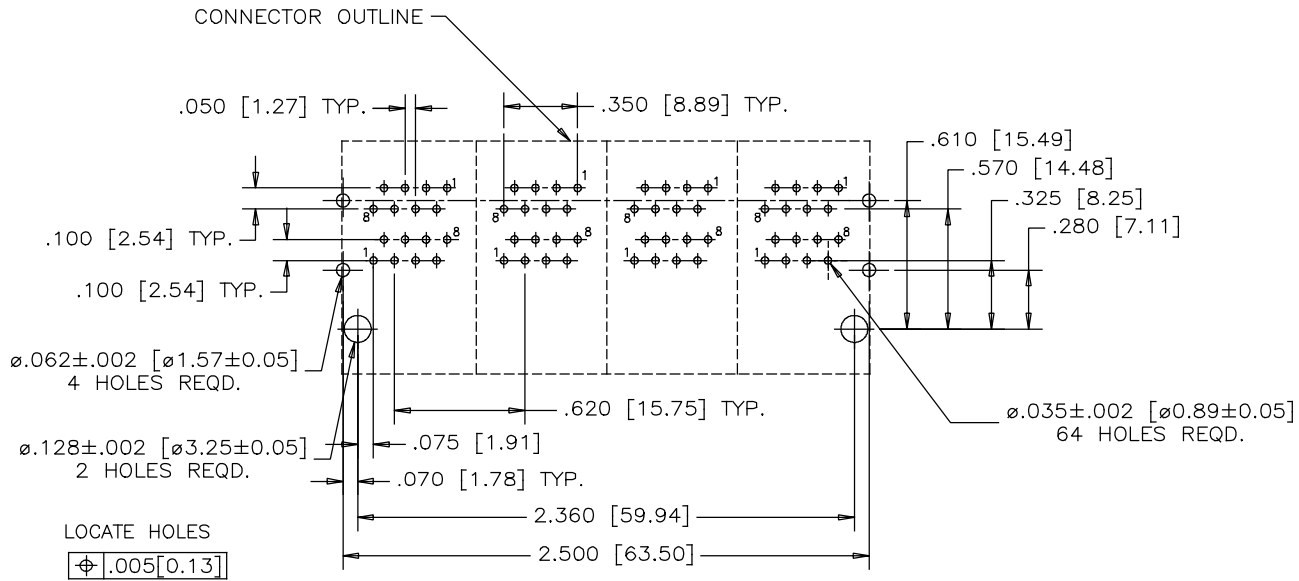

P.C.B. HOLE LAYOUT
(COMPONENT SIDE OF BOARD)

LOCATE HOLES
⊕ .005 [0.13]

HOLES DIMENSIONS ARE BASIC

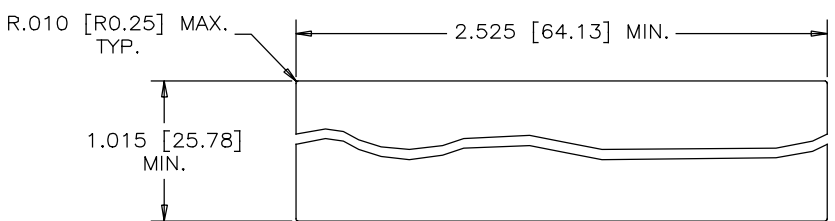

RECOMMENDED PANEL LAYOUT



MATERIALS:

- HOUSING: ENGINEERING THERMOPLASTIC, FLAMMABILITY RATING UL 94V-0
- CONTACTS: PHOSPHOR BRONZE
- PLATING: SELECTIVE GOLD PLATING ON MATING SURFACES. SEE PART NO. FOR THICKNESS.
50µ" [1.27 MICRONS] MIN. NICKEL UNDERPLATE.
100µ" [2.54 MICRONS] MIN. MATTE TIN OR GOLD FLASH ON CONTACT TAILS.
- SHIELD: COPPER ALLOY
PLATING: NICKEL WITH TIN DIPPED PCB TAIL.

UNLESS OTHERWISE SPECIFIED, THE TOLERANCE IS ±0.015[±0.38]

PART NUMBER: RJSAE-XF80-08

- GOLD PLATING OPTION:
- D=6u" GOLD PLATING
 - G=15u" GOLD PLATING
 - J=30u" GOLD PLATING
 - 5=50u" GOLD PLATING

UNLESS SPECIFIED OTHERWISE	DRAWN RONNIE.C JUN11/19	Amphenol Canada Corp. Commercial Products
PRIMARY UNITS INCHES	CHECKED L.CHAN JUN11/19	
SECONDARY MILLIMETERS	M.E. APP'D	TITLE STACKABLE MULTI-PORT MODULAR JACK, 8 POS. 8 CONTACTS, SHIELDED WITHOUT TAB, WITH .100INCH CONTACT TAILS, -RoHS COMPLIANT
REFERENCE IN PARENTHESES	Q.A. APP'D	DWG NO. P-RJSAE-XF80-08
1 DECIMAL PLACE	DWG APP'D	REF. EAR# RJ19077
2 DECIMAL PLACES	ENG. REL. NO.	REF. EAR# RJ19077
3 DECIMAL PLACES ±0.015	THIRD ANGLE PROJECTION	DO NOT SCALE DRAWING
ANGULAR DEGREES ±1.5°		CODE ID NO. 03554 DWG SIZE SCALE SHEET 1 OF 1