

- 1
- 2
- 3
- 4
- 5
- 6
- 7
- 8
- 9
- 13
- 14
- 15
- 16
- 17
- 18

MATERIAL

Glass-fibre reinforced polyamide based (PA) technopolymer, black or grey colour RAL 7040 (C33), matte finish.

ROTATING PIN

Nickel-plated steel.

STANDARD EXECUTION

Pass-through holes for M6 countersunk head screws.

TECHNOPOLYMER CENTRING INSERTS (SUPPLIED)

For profiles with slot dimensions from 6 to 12 mm.

FEATURES AND APPLICATIONS

This type of hinge can be used with profiles from 30 up to 60 mm, also combining different dimensions.

ROTATION ANGLE (APPROXIMATE VALUE)

Max 280° (-100° and +180° being 0° the condition where the two interconnected surfaces are on the same plane).

Do not exceed the rotation angle limit so as not to prejudice the hinge mechanical performance.

To choose the convenient type and the right number of hinges for your application, see the Guidelines (see page 1448).



FMM design

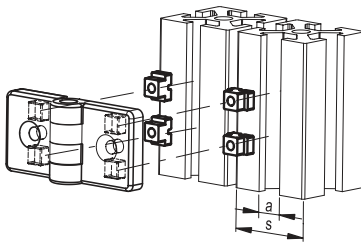
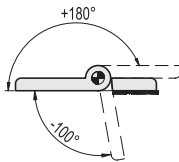

Profile dimension		Insert orientation	Insert colour
s	a		
30	6		Light grey
	8		
40÷45	8		Dark grey
	10		
50÷60	10		Black
	12		

Centring inserts			
Dimensions			Colour
l	l1	l2	
8	6	2	Light grey
10	8	4	Dark grey
12	10	5	Black

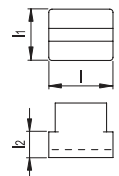



Description	AXIAL STRESS		RADIAL STRESS		90° ANGLED STRESS	
	Maximum working load Ea [N]	Load at breakage Ra [N]	Maximum working load Er [N]	Load at breakage Rr [N]	Maximum working load E90 [N]	Load at breakage R90 [N]
CFG.30/30 SH-6	440	2570	1850	3710	300	1700
CFG.30/40 SH-6	320	2280	1750	3490	590	870
CFG.30/45 SH-6	240	2150	1760	3520	190	780
CFG.30/60 SH-6	280	1510	1600	3190	180	850
CFG.40/40 SH-6	320	2280	1750	3490	220	870
CFG.40/45 SH-6	240	2150	1750	3490	390	780
CFG.40/60 SH-6	280	1510	1600	3190	180	850
CFG.45/45 SH-6	240	2150	1760	3520	190	780
CFG.45/60 SH-6	240	1510	1600	3190	180	780
CFG.60/60 SH-6	280	1510	1600	3190	180	850

mm	inch
36	1.42

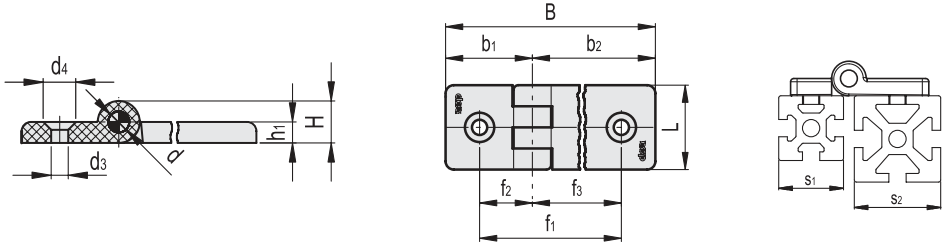

CFG.

METRIC

Code	Description	s1	s2	L	B	f1 ±0.25	f2	f3	H	h1	b1	b2	d	d3	d4	C# [Nm]	⚖️
423911	CFG.30/30 SH-6	30	30	36	54	35	17.5	17.5	16	8	27	27	8	6.5	12.5	5	32
423912	CFG.30/40 SH-6	30	40	36	64	40	17.5	22.5	16	8	27	37	8	6.5	12.5	5	34
423913	CFG.30/45 SH-6	30	45	36	69	42.5	17.5	25	16	8	27	42	8	6.5	12.5	5	35
423914	CFG.30/60 SH-6	30	60	36	84	50	17.5	32.5	16	8	27	57	8	6.5	12.5	5	38
423921	CFG.40/40 SH-6	40	40	36	74	45	22.5	22.5	16	8	37	37	8	6.5	12.5	5	36
423922	CFG.40/45 SH-6	40	45	36	79	47.5	22.5	25	16	8	37	42	8	6.5	12.5	5	37
423923	CFG.40/60 SH-6	40	60	36	94	55	22.5	32.5	16	8	37	57	8	6.5	12.5	5	40
423931	CFG.45/45 SH-6	45	45	36	84	50	25	25	16	8	42	42	8	6.5	12.5	5	38
423932	CFG.45/60 SH-6	45	60	36	99	57.5	25	32.5	16	8	42	57	8	6.5	12.5	5	41
423941	CFG.60/60 SH-6	60	60	36	114	65	32.5	32.5	16	8	57	57	8	6.5	12.5	5	45

CFG-C33

Code	Description	s1	s2	L	B	f1 ±0.25	f2	f3	H	h1	b1	b2	d	d3	d4	C# [Nm]	⚖️
423911-C33	CFG.30/30 SH-6-C33	30	30	36	54	35	17.5	17.5	16	8	27	27	8	6.5	12.5	5	32
423912-C33	CFG.30/40 SH-6-C33	30	40	36	64	40	17.5	22.5	16	8	27	37	8	6.5	12.5	5	34
423913-C33	CFG.30/45 SH-6-C33	30	45	36	69	42.5	17.5	25	16	8	27	42	8	6.5	12.5	5	35
423914-C33	CFG.30/60 SH-6-C33	30	60	36	84	50	17.5	32.5	16	8	27	57	8	6.5	12.5	5	38
423921-C33	CFG.40/40 SH-6-C33	40	40	36	74	45	22.5	22.5	16	8	37	37	8	6.5	12.5	5	36
423922-C33	CFG.40/45 SH-6-C33	40	45	36	79	47.5	22.5	25	16	8	37	42	8	6.5	12.5	5	37
423923-C33	CFG.40/60 SH-6-C33	40	60	36	94	55	22.5	32.5	16	8	37	57	8	6.5	12.5	5	40
423931-C33	CFG.45/45 SH-6-C33	45	45	36	94	50	25	25	16	8	42	42	8	6.5	12.5	5	38
423932-C33	CFG.45/60 SH-6-C33	45	60	36	99	57.5	25	32.5	16	8	42	57	8	6.5	12.5	5	41
423941-C33	CFG.60/60 SH-6-C33	60	60	36	114	65	32.5	32.5	16	8	57	57	8	6.5	12.5	5	45

Suggested tightening torque for assembly screws.