

PART NUMBER	TITLE	CABLE DESCRIPTION	LENGTH 'L'	CABLE COLOR
2153451121	Squba 3.6 F-F 75mm 16 AWG leads BK Sn	1X16AWG DISC MPPE BK UL11028 HKUP	75±3	BLACK
2153451122	Squba 3.6 F-F 150mm 16 AWG leads BK Sn	1X16AWG DISC MPPE BK UL11028 HKUP	150±5	BLACK
2153451123	Squba 3.6 F-F 225mm 16 AWG leads BK Sn	1X16AWG DISC MPPE BK UL11028 HKUP	225±5	BLACK
2153451124	Squba 3.6 F-F 300mm 16 AWG leads BK Sn	1X16AWG DISC MPPE BK UL11028 HKUP	300±5	BLACK
2153451125	Squba 3.6 F-F 450mm 16 AWG leads BK Sn	1X16AWG DISC MPPE BK UL11028 HKUP	450±5	BLACK
2153452121	Squba 3.6 F-F 75mm 16 AWG leads RD Sn	1X16AWG DISC MPPE RD UL11028 HKUP	75±3	RED
2153452122	Squba 3.6 F-F 150mm 16 AWG leads RD Sn	1X16AWG DISC MPPE RD UL11028 HKUP	150±5	RED
2153452123	Squba 3.6 F-F 225mm 16 AWG leads RD Sn	1X16AWG DISC MPPE RD UL11028 HKUP	225±5	RED
2153452124	Squba 3.6 F-F 300mm 16 AWG leads RD Sn	1X16AWG DISC MPPE RD UL11028 HKUP	300±5	RED
2153452125	Squba 3.6 F-F 450mm 16 AWG leads RD Sn	1X16AWG DISC MPPE RD UL11028 HKUP	450±5	RED

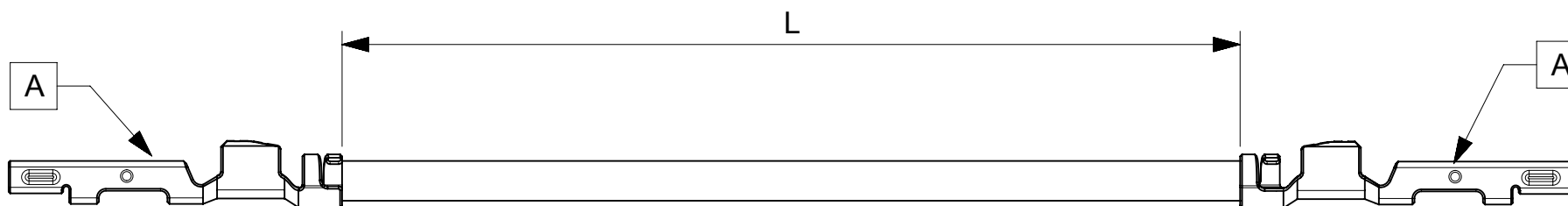

ITEM	PART#	DESCRIPTION	QTY	UOM
A	2077770001	Squba 3.6 female terminal 16 AWG	2	PC

- NOTES:**
1. Crimping to be done as per Molex standards.
  2. The product specification relies on the terminals & wire spec.

REVISION			
DATE	REV	DESCRIPTION	CHANGER
2021/05/27	A	INITIAL RELEASE	AS20

DOCUMENT STATUS	P1	RELEASE DATE	2021/05/31	12:34:16
-----------------	----	--------------	------------	----------

<b>FUNCTIONAL SYMBOLS</b> $\frac{F}{A} = 0$ $\frac{F}{E} = 0$ $\frac{F}{P} = 0$	<b>THIS DRAWING CONTAINS INFORMATION THAT IS PROPRIETARY TO MOLEX ELECTRONIC TECHNOLOGIES, LLC AND SHOULD NOT BE USED WITHOUT WRITTEN PERMISSION</b>		<b>CURRENT REV DESC:</b>		<p>SEE TABLE</p> <p>PRODUCT CUSTOMER DRAWING</p>			
	<b>DIMENSION UNITS</b> mm	<b>SCALE</b> NTS	EC NO: 665606 DRWN: AS20 2021/05/27 CHK'D: RDESAI01 2021/05/31 APPR: RDESAI01 2021/05/31					
	<b>GENERAL TOLERANCES (UNLESS SPECIFIED)</b>		<b>INITIAL REVISION:</b> DRWN: AS20 2021/05/27 APPR: RDESAI01 2021/05/31					
	<b>ANGULAR TOL</b> ± °		DOCUMENT NUMBER: 2153451121 DOC TYPE: PSD DOC PART: 000 REVISION: A					
<b>DIVISIONAL SYMBOLS</b>	4 PLACES ± 3 PLACES ± 2 PLACES ± 1 PLACE ± 0 PLACES ±	<b>DRAFT WHERE APPLICABLE MUST REMAIN WITHIN DIMENSIONS</b>	<b>THIRD ANGLE PROJECTION</b>	<b>DRAWING</b> A4-SIZE	<b>SERIES</b> 215345	<b>MATERIAL NUMBER</b> SEE TABLE	<b>CUSTOMER</b> GENERAL MARKET	<b>SHEET NUMBER</b> 1 OF 1