

MATERIAL AND FINISH:

Insulator: Thermoplastic, black, UL-94V-0 rated.

Solder Terminals: Brass, Tin plated.

ELECTRICAL SPECIFICATIONS:

Rated current: 10A

Rated voltage: 250VAC



Rated current: 15A

Rated voltage: 250VAC



RoHS
COMPLIANT

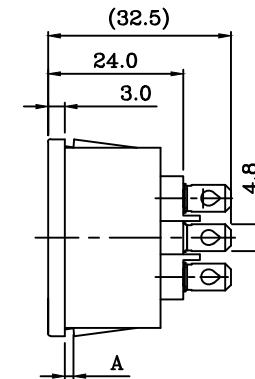
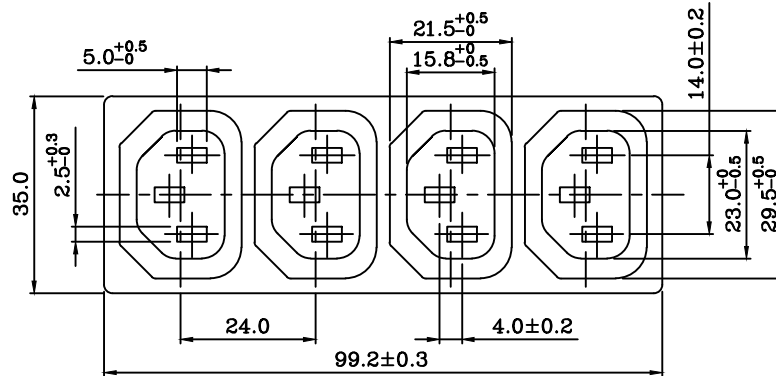
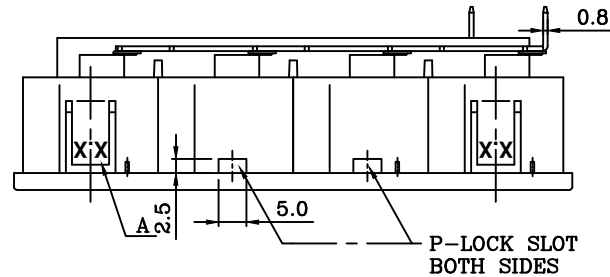
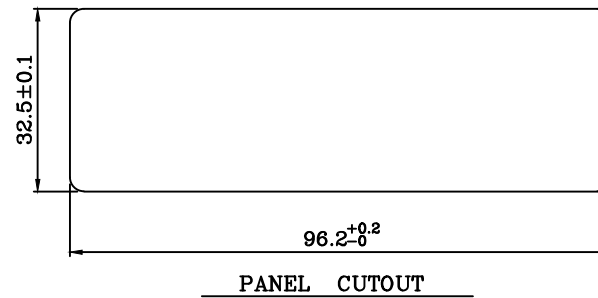
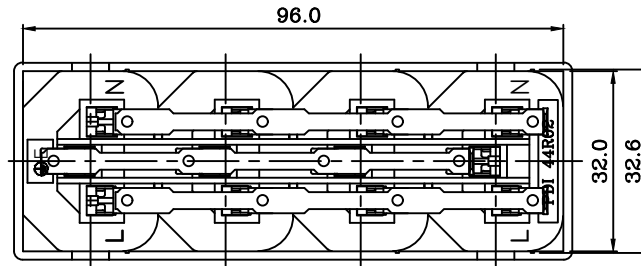

REVISIONS	CHNG	CHK	APPR
	CHANGE		
	REV	DATE	

P/N	A	MAX. PANEL THICKNESS
44R02-4131-100-PL	1.0	1.0
44R02-4131-120-PL	1.2	1.2
44R02-4131-150-PL	1.5	1.5
44R02-4131-170-PL	1.7	1.7
44R02-4131-200-PL	2.0	2.0
44R02-4131-250-PL	2.5	2.5

ADDITIONAL PANEL THICKNESS
AVAILABLE ON REQUEST

TOLERANCE UNLESS OTHERWISE SPECIFIED	
X	± 1
X.X	± 0.4
X.XX	± 0.20
DRAWN BY	PB
DATE:	6/1/22
CHECK BY	-
DATE:	-
APPR BY	
DATE:	

Power Dynamics, Inc.

Phone: 973 560-0019 Whippany, New Jersey Fax: 973 560-0076

PART: 4 GANG IEC 60320 C13 APPLIANCE OUTLET
SNAP IN; 4.8MM Q.C. TERMINALS; P-LOCK COMPATIBLE

PART #: 44R02-4131-XXX-PL		SHEET 1 of 1
SIZE: A	ALL DIMENSIONS FOR REFERENCE ONLY	REV: -
SCALE: NTS		