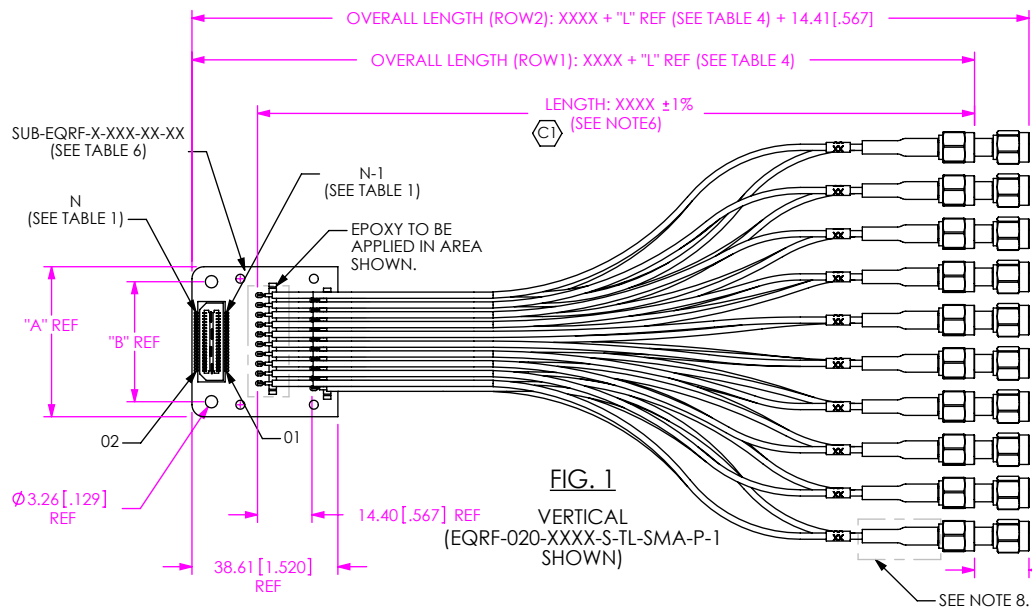

TABLE 4	
GENDER / ORIENTATION	"L"
-S/-S-M	20.88 [.822]
-T/-T-M	21.64 [.852]
-XL /-XR	17.35 [.683]

**THIS PRODUCT MANUFACTURED WITH LEAD-FREE PROCESSING**

DO NOT SCALE FROM THIS PRINT



EQRF-XXX-XXXX-X-X-XXXX-X-X

No OF POSITIONS  
-020, -040  
(PER ROW)  
(SEE TABLE 6, SHEET 4)

LENGTH  
-XXXX (MM)  
(0.152[0.6,0] MIN)  
(SEE NOTE 6)  
(SEE NOTE 10)

QXE GENDER  
-T: TERMINAL  
-S: SOCKET  
(SEE TABLE 6, SHEET 4)

COAX  
-1: CCA-316  
-2: CCA-178  
\*3: TCF-2650F-01-01  
(SEE TABLE 7, SHEET 4)  
\* NOT TOOLED

RF GENDER  
(SEE TABLE 7, SHEET 4)  
-P: PLUG  
-J: JACK

RF CONNECTOR  
(SEE TABLE 7, SHEET 4)  
-MCX  
-SMA  
-MMCX

QXE ORIENTATION  
-S: EDGE MOUNT WITH CPS  
-M: EDGE MOUNT WITHOUT CPS  
-R: TOP, RIGHT  
-L: TOP, LEFT  
(SEE TABLE 6, SHEET 4)  
(SEE NOTE 7)

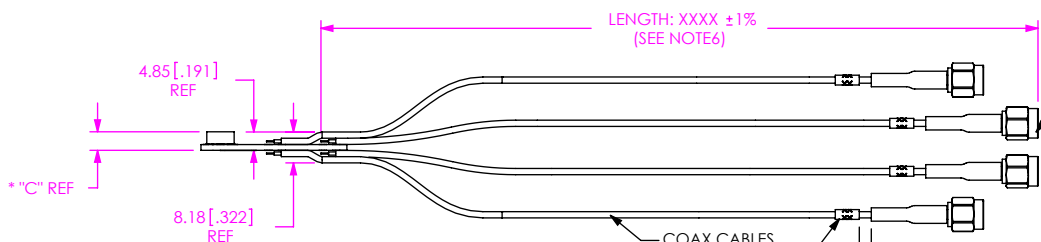
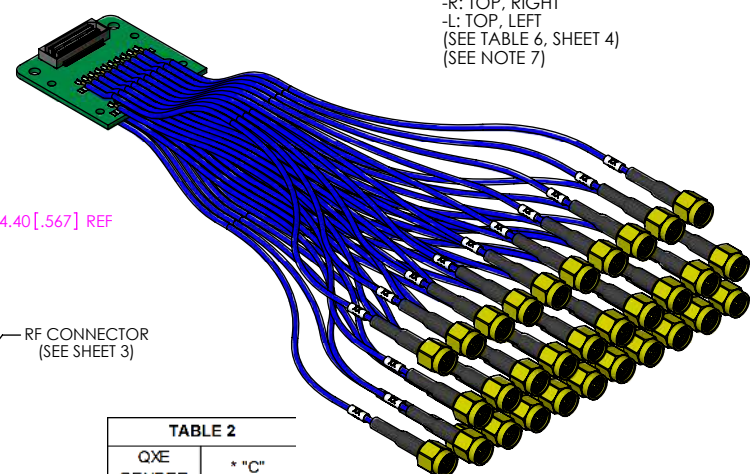
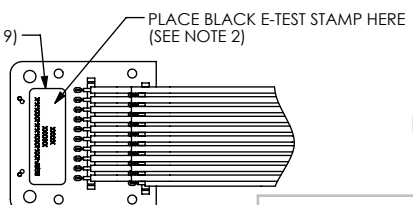

TABLE 2	
QXE GENDER	* "C"
-T	5.84 [.230]
-S	4.90 [.193]

\* -R/-L ORIENTATIONS ONLY

- NOTES:
1.  $\text{C}$  REPRESENTS A CRITICAL DIMENSION.
  2. ALL ASSEMBLIES TO BE 100% ELECTRICALLY TESTED FOR SHORTS AND OPENS. AFTER FINAL ELECTRICAL TEST, PLACE BLACK E-TEST STAMP ON HDRL-01 WHERE SHOWN. DO NOT OVERLAP LABEL INFO ON HDRL-01.
  3. ALL ASSEMBLIES TO BE 100% HI-POT TESTED AT 300V.
  4. WRAP HDRL-14 LABEL AROUND EACH CABLE; EACH LABEL TO INCLUDE CONNECTOR PINOUT NUMBER (SEE TABLE 9 & 10). NUMBER TO BE PRINTED ON LABEL 2 TIMES SO CAN BE SEEN FROM ANY ANGLE.
  5. PACKAGE ASSEMBLIES IN ANTI-STATIC & STATIC DISSIPATIVE BAGS.
  6. LENGTH IS EQUAL TO THE CORRESPONDING RFXXX OVERALL CABLE LENGTH. EQRF LENGTH IS METRIC AND RFXXX LENGTH IS METRIC.
  7. ALL -S/-M ORIENTATIONS TO USE CAPS WITHOUT EPOXY COVERING; ALL -R/-L OPTIONS TO HAVE EPOXY COVERING TERMINATION AREA ON TOP CABLE; SEE SHEET 2.
  8. RF CONNECTOR TO CABLE TRANSITION AREA TO BE COVERED WITH SHRINK WRAP JACKET. NOT SHOWN FOR CLARITY.
  9. HDRL-01 TO CONTAIN LINE 1 - PART NUMBER, LINE 2 - SHOP ORDER, LINE 3 - DATE CODE.
  10. CABLE LENGTHS LONGER THAN 1524 MILLIMETERS ARE NOT SUPPORTED BY S.I. TEST DATA.
  11. SHIP LOCK WASHER AND NUT IN ORIGINAL BAG WITH CABLE.
  12. TIGHTEN TO 1.4 - 1.7 IN-LBS.
  13. ALL POSITIONS ARE TRANSMITTED AS SIGNALS ACROSS COAX CENTER CONDUCTORS. CONNECTOR GROUND BLADES ARE TIED TO THE COAX SHIELD.



DESIGNED & DIMENSIONED IN MILLIMETERS[INCHES]

RECOMMENDED CABLE STRIPPING

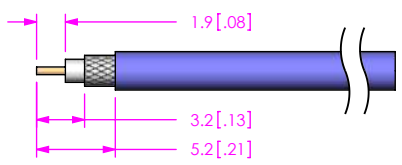

TABLE 1					
No OF POSITIONS	"A"	"B"	N	N-1	QTY OF COAX CABLES
-020	39.69 [1.563]	31.75 [1.250]	40	39	40
-040	65.60 [2.583]	51.75 [2.038]	80	79	80

UNLESS OTHERWISE SPECIFIED, DIMENSIONS ARE IN MM. TOLERANCES ARE:  
DECIMALS ANGLES  
.XX: ± [.30] .010 2°  
.XXX: ± [.13] .005  
.XXXX: [.05] ± .002

PROPRIETARY NOTE  
THIS DOCUMENT CONTAINS INFORMATION CONFIDENTIAL AND PROPRIETARY TO SAMTEC, INC. AND SHALL NOT BE REPRODUCED OR TRANSFERRED TO OTHER DOCUMENTS OR DISCLOSED TO OTHERS OR USED FOR ANY PURPOSE OTHER THAN THAT WHICH IT WAS OBTAINED WITHOUT THE EXPRESSED WRITTEN CONSENT OF SAMTEC, INC.



520 PARK EAST BLVD. NEW ALBANY, IN 47150  
PHONE: 812-944-6733 FAX: 812-948-5047  
e-Mail: info@SAMTEC.com code: 55322

MATERIAL: DO NOT SCALE DRAWING SHEET SCALE: 1:0.8  
PLATING: "H GOLD 30µ" ON CONTACT"

DESCRIPTION:  
0.8mm HIGH-SPEED COAX CABLE ASSEMBLY  
DWG. NO.  
EQRF-XXX-XXXX-X-X-XXXX-X-X

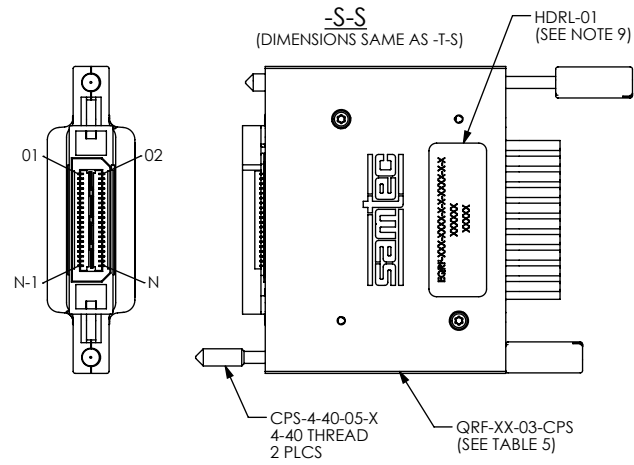
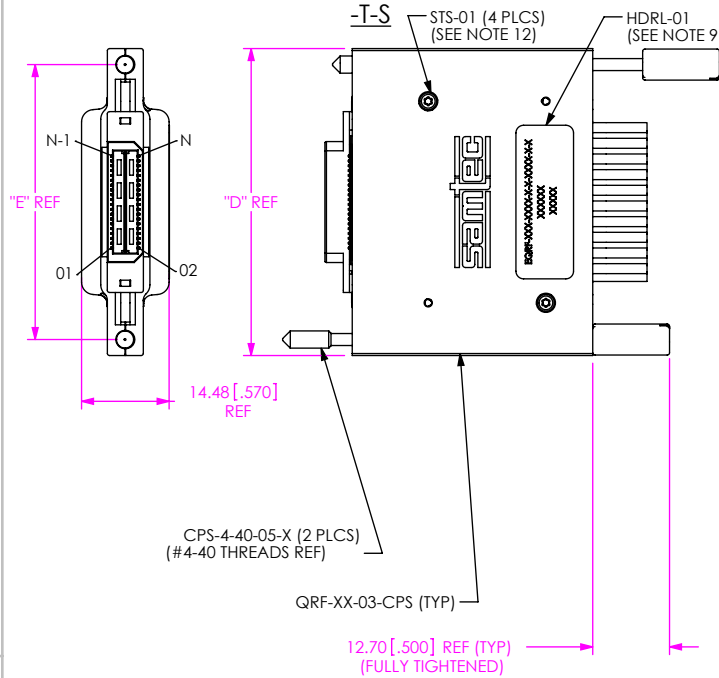
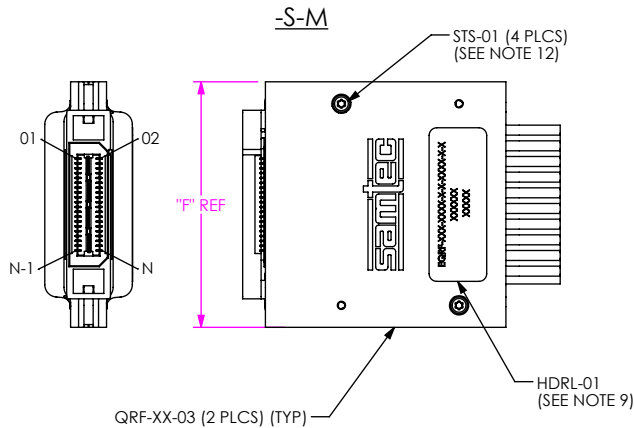
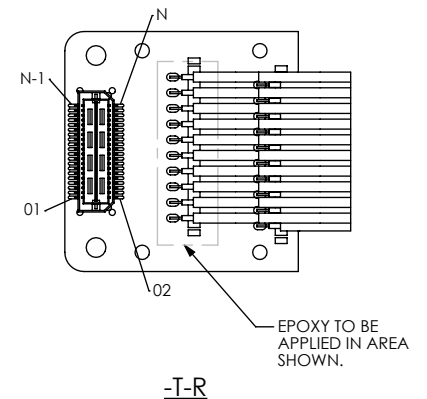
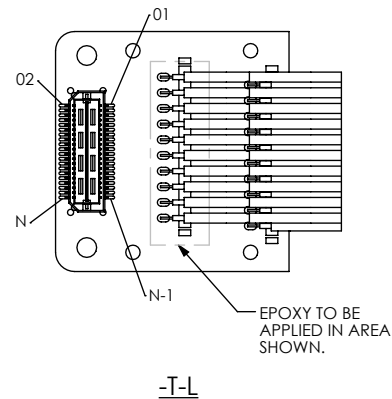
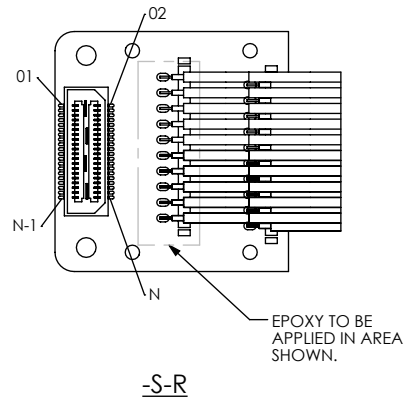
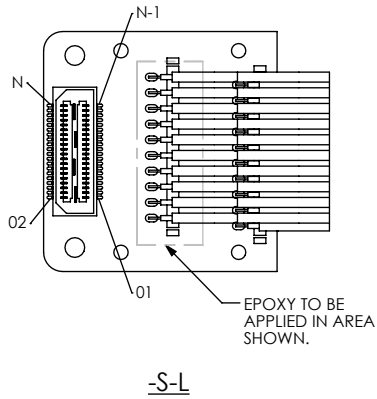

**TABLE 8**

No OF POSITIONS	"F"	QRF CAP
-020	40.61 [1.599]	QRF-01-03
-040	66.52 [2.619]	QRF-02-03

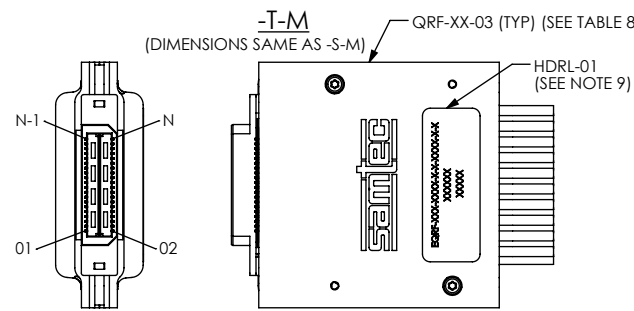

**TABLE 5**

No OF POSITIONS	"D"	"E"	QRF CAP
-020	50.76 [1.999]	45.47 [1.790]	QRF-01-03-CPS
-040	76.67 [3.019]	71.37 [2.810]	QRF-02-03-CPS

**PROPRIETARY NOTE**  
 THIS DOCUMENT CONTAINS INFORMATION CONFIDENTIAL AND PROPRIETARY TO SAMTEC, INC. AND SHALL NOT BE REPRODUCED OR TRANSFERRED TO OTHER DOCUMENTS OR DISCLOSED TO OTHERS OR USED FOR ANY PURPOSE OTHER THAN THAT WHICH IT WAS OBTAINED WITHOUT THE EXPRESSED WRITTEN CONSENT OF SAMTEC, INC.  
 DO NOT SCALE DRAWING  
 SHEET SCALE: 1:1.25

520 PARK EAST BLVD, NEW ALBANY, IN 47150  
 PHONE: 812-944-6733 FAX: 812-948-5047  
 e-Mail: info@SAMTEC.com code: 53322

DESCRIPTION:  
 0.8mm HIGH-SPEED COAX CABLE ASSEMBLY

DWG. NO.  
 EQRF-XXX-XXXX-X-X-XXXX-X-X

BY: KEVIN B 07/18/2005 SHEET 2 OF 6

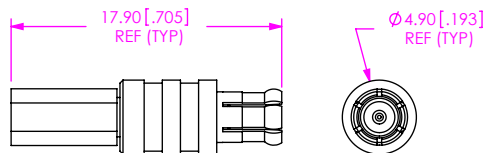

-MCX-P  
(FOR -1 & -3 COAX OPTIONS)

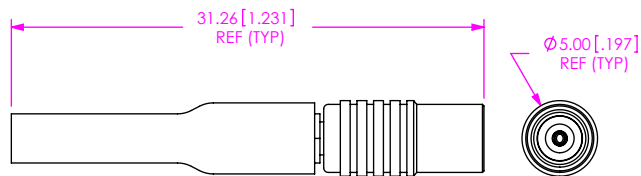

-MCX-J  
(FOR -1 & -3 COAX OPTIONS)

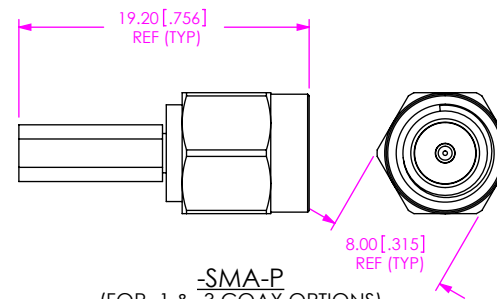

-SMA-P  
(FOR -1 & -3 COAX OPTIONS)

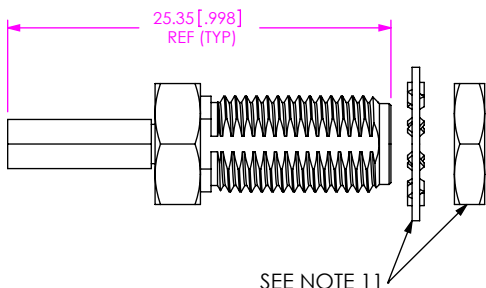

-SMA-J  
(FOR -1 & -3 COAX OPTIONS)

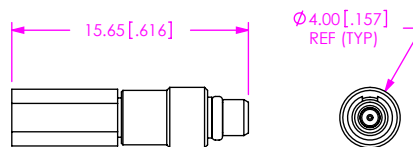
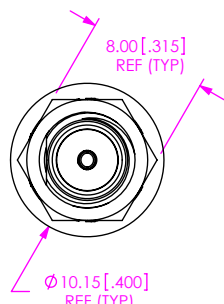

-MMCX-P  
(FOR -1 & -3 COAX OPTIONS)

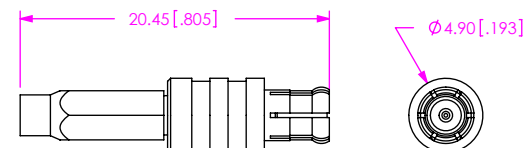

-MCX-P  
(FOR -2 COAX OPTION)

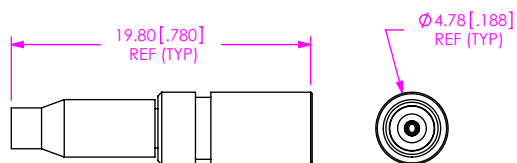

-MCX-J  
(FOR -2 COAX OPTION)

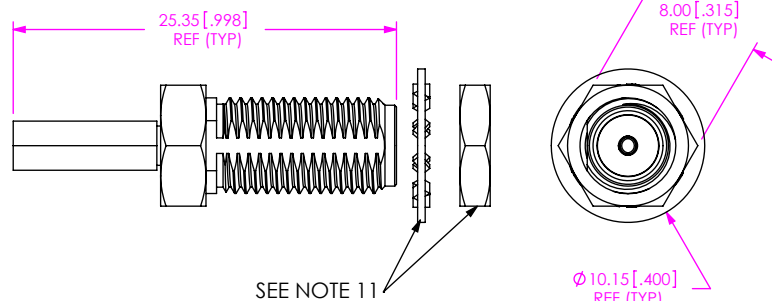

-SMA-J  
(FOR -2 COAX OPTION)

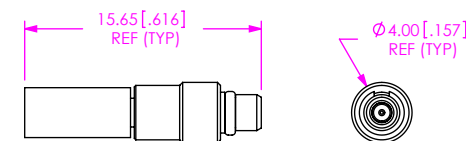

-MMCX-P  
(FOR -2 COAX OPTION)

PROPRIETARY NOTE

THIS DOCUMENT CONTAINS INFORMATION CONFIDENTIAL AND PROPRIETARY TO SAMTEC, INC. AND SHALL NOT BE REPRODUCED OR TRANSFERRED TO OTHER DOCUMENTS OR DISCLOSED TO OTHERS OR USED FOR ANY PURPOSE OTHER THAN THAT WHICH IT WAS OBTAINED WITHOUT THE EXPRESSED WRITTEN CONSENT OF SAMTEC, INC.

DO NOT SCALE DRAWING

SHEET SCALE: 2:1



520 PARK EAST BLVD, NEW ALBANY, IN 47150  
PHONE: 812-944-6733 FAX: 812-948-5047  
e-Mail: info@SAMTEC.com code: 55322

DESCRIPTION:  
0.8mm HIGH-SPEED COAX CABLE ASSEMBLY

DWG. NO.  
EQRF-XXX-XXXX-X-X-XXXX-X-X

BY: KEVIN B 07/18/2005 SHEET 3 OF 6

TABLE 6			
POSITIONS	QXE GENDER	QXE ORIENTATION	SUB-EQRF-X-XXX-XX-XX
-020	-T	-S/-M	SUB-EQRF-T-020-03-01
		-R	SUB-EQRF-T-020-01-01
		-L	SUB-EQRF-T-020-02-01
	-S	-S/-M	SUB-EQRF-S-020-03-01
		-R	SUB-EQRF-S-020-01-01
		-L	SUB-EQRF-S-020-02-01
-040	-T	-S/-M	SUB-EQRF-T-040-03-01
		-R	SUB-EQRF-T-040-01-01
		-L	SUB-EQRF-T-040-02-01
	-S	-S/-M	SUB-EQRF-S-040-03-01
		-R	SUB-EQRF-S-040-01-01
		-L	SUB-EQRF-S-040-02-01

TABLE 7					
RF CONNECTOR	RF GENDER	COAX	RF CONNECTOR PART #	COAX PART #	RFXXX P/N
-MCX	-P	1	MCX-P-C-H-ST-CA1	CCA-316	RF316-02SP1-SING-XXXX *
		2	MCX-P-C-H-ST-CA2	CCA-178	RF178-02SP1-SING-XXXX *
		3**	MCX-P-C-H-ST-CA1	TCF-2650F-01-01	N/A
	-J	1	MCX-J-C-H-ST-CA1	CCA-316	RF316-02SJ1-SING-XXXX *
		2	MCX-J-C-H-ST-CA2	CCA-178	RF178-02SJ1-SING-XXXX *
		3**	MCX-J-C-H-ST-CA1	TCF-2650F-01-01	N/A
-SMA	-P	1	SMA-P-C-H-ST-CA1	CCA-316	RF316-01SP1-SING-XXXX *
		2	N/A	N/A	N/A
		3**	SMA-P-C-H-ST-CA1	TCF-2650F-01-01	N/A
	-J	1	SMA-J-C-H-ST-BH1	CCA-316	RF316-01BJ1-SING-XXXX *
		2	SMA-J-C-H-ST-BH2	CCA-178	RF178-01BJ1-SING-XXXX *
		3**	SMA-J-C-H-ST-BH1	TCF-2650F-01-01	N/A
-MMCX	-P	1	MMCX-P-C-H-ST-CA1	CCA-316	RF316-03SP1-SING-XXXX *
		2	MMCX-P-C-H-ST-CA2	CCA-178	RF178-03SP1-SING-XXXX *
		3**	MMCX-P-C-H-ST-CA1	TCF-2650F-01-01	N/A

\*RFXXX OVERALL CABLE LENGTH (XXXX) IS EQUAL TO EQRF LENGTH.

\*\*NOT TOOLED

**PROPRIETARY NOTE**  
 THIS DOCUMENT CONTAINS INFORMATION CONFIDENTIAL AND PROPRIETARY TO SAMTEC, INC. AND SHALL NOT BE REPRODUCED OR TRANSFERRED TO OTHER DOCUMENTS OR DISCLOSED TO OTHERS OR USED FOR ANY PURPOSE OTHER THAN THAT WHICH IT WAS OBTAINED WITHOUT THE EXPRESSED WRITTEN CONSENT OF SAMTEC, INC.

DO NOT SCALE DRAWING

SHEET SCALE: 1:25:1



520 PARK EAST BLVD, NEW ALBANY, IN 47150  
 PHONE: 812-944-6733 FAX: 812-948-5047  
 e-Mail: info@SAMTEC.com code: 55322

DESCRIPTION:  
 0.8mm HIGH-SPEED COAX CABLE ASSEMBLY

DWG. NO.  
 EQRF-XXX-XXXX-X-X-XXXX-X-X

BY: KEVIN B 07/18/2005 SHEET 4 OF 6

TABLE 9

ONE BANK

CABLE	PINOUT OF CONNECTOR; BY ORIENTATION			
	S-L	S-R / S-S / S-M	T-L	T-R / T-S / T-M
C1, 01	4	37	38	3
C1, 02	8	33	34	7
C1, 03	12	29	30	11
C1, 04	16	25	26	15
C1, 05	20	21	22	19
C1, 06	24	17	18	23
C1, 07	28	13	14	27
C1, 08	32	9	10	31
C1, 09	36	5	6	35
C1, 10	40	1	2	39
C2, 01	1	40	39	2
C2, 02	5	36	35	6
C2, 03	9	32	31	10
C2, 04	13	28	27	14
C2, 05	17	24	23	18
C2, 06	21	20	19	22
C2, 07	25	16	15	26
C2, 08	29	12	11	30
C2, 09	33	8	7	34
C2, 10	37	4	3	38
C3, 01	38	3	4	37
C3, 02	34	7	8	33
C3, 03	30	11	12	29
C3, 04	26	15	16	25
C3, 05	22	19	20	21
C3, 06	18	23	24	17
C3, 07	14	27	28	13
C3, 08	10	31	32	9
C3, 09	6	35	36	5
C3, 10	2	39	40	1
C4, 01	39	2	1	40
C4, 02	35	6	5	36
C4, 03	31	10	9	32
C4, 04	27	14	13	28
C4, 05	23	18	17	24
C4, 06	19	22	21	20
C4, 07	15	26	25	16
C4, 08	11	30	29	12
C4, 09	7	34	33	8
C4, 10	3	38	37	4

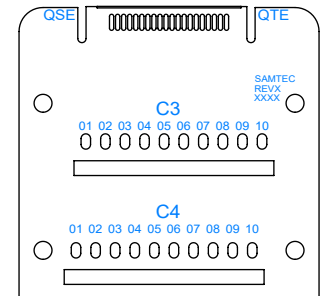
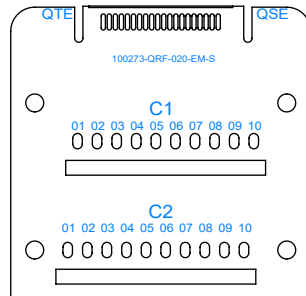
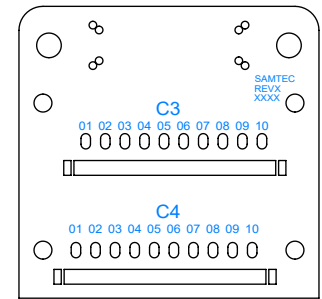
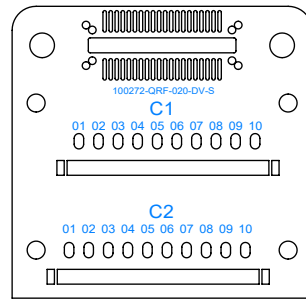

<p><b>PROPRIETARY NOTE</b> THIS DOCUMENT CONTAINS INFORMATION CONFIDENTIAL AND PROPRIETARY TO SAMTEC, INC. AND SHALL NOT BE REPRODUCED OR TRANSFERRED TO OTHER DOCUMENTS OR DISCLOSED TO OTHERS OR USED FOR ANY PURPOSE OTHER THAN THAT WHICH IT WAS OBTAINED WITHOUT THE EXPRESSED WRITTEN CONSENT OF SAMTEC, INC.</p> <p>DO NOT SCALE DRAWING</p> <p>SHEET SCALE: 1:1</p>		
	<p>520 PARK EAST BLVD., NEW ALBANY, IN 47150 PHONE: 812-944-6733 FAX: 812-948-5047 e-Mail: info@SAMTEC.com code: 55322</p>	
	<p>DESCRIPTION: 0.8mm HIGH-SPEED COAX CABLE ASSEMBLY</p>	
	<p>DWG. NO. EQRF-XXX-XXXX-X-X-XXXX-X-X</p>	
<p>BY: KEVIN B 07/18/2005</p>		<p>SHEET 5 OF 6</p>

TABLE 10  
IWO BANK

CABLE LANDING	PINOUT OF CONNECTOR, BY ORIENTATION			
	S-L	S-R / S-S / S-M	T-L	T-R / T-S / T-M
C1, 01	4	77	78	3
C1, 02	8	73	74	7
C1, 03	12	69	70	11
C1, 04	16	65	66	15
C1, 05	20	61	62	19
C1, 06	24	57	58	23
C1, 07	28	53	54	27
C1, 08	32	49	50	31
C1, 09	36	45	46	35
C1, 10	40	41	42	39
C1, 11	44	37	38	43
C1, 12	48	33	34	47
C1, 13	52	29	30	51
C1, 14	56	25	26	55
C1, 15	60	21	22	59
C1, 16	64	17	18	63
C1, 17	68	13	14	67
C1, 18	72	9	10	71
C1, 19	76	5	6	75
C1, 20	80	1	2	79
C2, 01	1	80	79	2
C2, 02	5	76	75	6
C2, 03	9	72	71	10
C2, 04	13	68	67	14
C2, 05	17	64	63	18
C2, 06	21	60	59	22
C2, 07	25	56	55	26
C2, 08	29	52	51	30
C2, 09	33	48	47	34
C2, 10	37	44	43	38
C2, 11	41	40	39	42
C2, 12	45	36	35	46
C2, 13	49	32	31	50
C2, 14	53	28	27	54
C2, 15	57	24	23	58
C2, 16	61	20	19	62
C2, 17	65	16	15	66
C2, 18	69	12	11	70
C2, 19	73	8	7	74
C2, 20	77	4	3	78
C3, 01	78	3	4	77
C3, 02	74	7	8	73
C3, 03	70	11	12	69
C3, 04	66	15	16	65
C3, 05	62	19	20	61
C3, 06	58	23	24	57
C3, 07	54	27	28	53
C3, 08	50	31	32	49
C3, 09	46	35	36	45
C3, 10	42	39	40	41
C3, 11	38	43	44	37
C3, 12	34	47	48	33
C3, 13	30	51	52	29
C3, 14	26	55	56	25
C3, 15	22	59	60	21
C3, 16	18	63	64	17
C3, 17	14	67	68	13
C3, 18	10	71	72	9
C3, 19	6	75	76	5
C3, 20	2	79	80	1
C4, 01	79	2	1	80
C4, 02	75	6	5	76
C4, 03	71	10	9	72
C4, 04	67	14	13	68
C4, 05	63	18	17	64
C4, 06	59	22	21	60
C4, 07	55	26	25	56
C4, 08	51	30	29	52
C4, 09	47	34	33	48
C4, 10	43	38	37	44
C4, 11	39	42	41	40
C4, 12	35	46	45	36
C4, 13	31	50	49	32
C4, 14	27	54	53	28
C4, 15	23	58	57	24
C4, 16	19	62	61	20
C4, 17	15	66	65	16
C4, 18	11	70	69	12
C4, 19	7	74	73	8
C4, 20	3	78	77	4

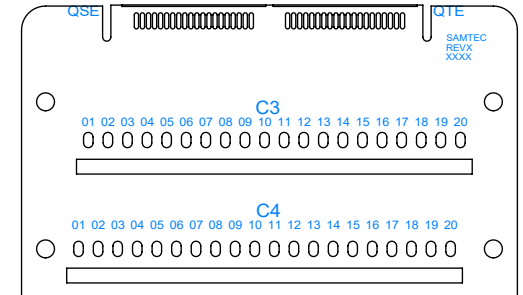
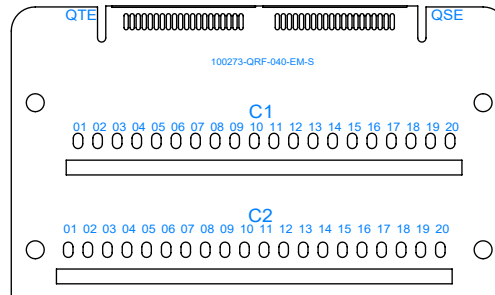
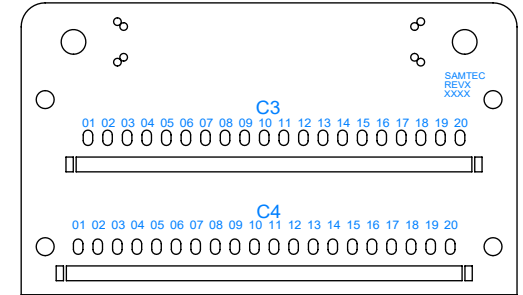
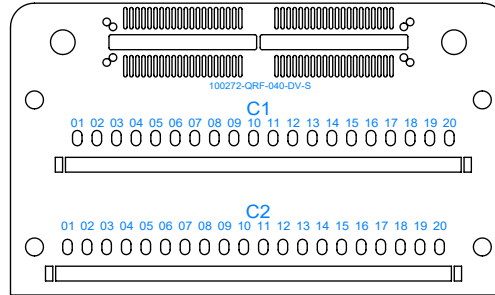

**PROPRIETARY NOTE**  
THIS DOCUMENT CONTAINS INFORMATION CONFIDENTIAL AND PROPRIETARY TO SAMTEC, INC. AND SHALL NOT BE REPRODUCED OR TRANSFERRED TO OTHER DOCUMENTS OR DISCLOSED TO OTHERS OR USED FOR ANY PURPOSE OTHER THAN THAT WHICH IT WAS OBTAINED WITHOUT THE EXPRESSED WRITTEN CONSENT OF SAMTEC, INC.

DO NOT SCALE DRAWING  
  
SHEET SCALE: 1:1



520 PARK EAST BLVD, NEW ALBANY, IN 47150  
PHONE: 812-944-6733 FAX: 812-948-5047  
e-Mail: info@SAMTEC.com code: 55322

DESCRIPTION:  
0.8mm HIGH-SPEED COAX CABLE ASSEMBLY

DWG. NO.  
EQRF-XXX-XXXX-X-X-XXXX-X-X

BY: KEVIN B 07/18/2005 SHEET 6 OF 6