

MOUNTING DETAIL

NOTES:

1. ACCEPTS MOLEX .093/(2.36) TERMINALS.
2. MATES WITH 1396-R* HOUSINGS.
3. RECOMMENDED DIRECTION OF PUNCH.
4. PART CONFORMS TO PRODUCT SPEC 02-09.
5. MATERIAL:
NYLON TYPE 6/6, 94V-2
NATURAL COLOR
6. CIRCUIT I.D. NUMBERS ON SIDE OF HOUSING
APPEAR ON PARTS FROM TOOLS BUILT AFTER
5/4/93.

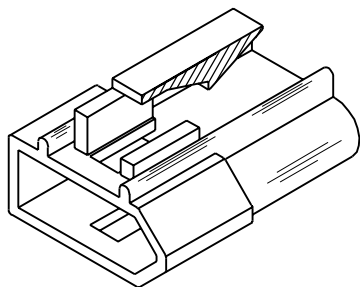
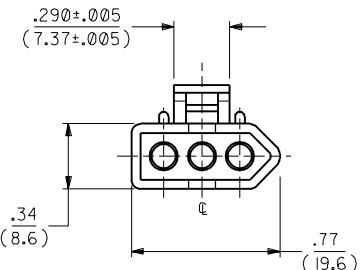

PLUG
SHOWN ABOVE WITH SIDE PANEL MOUNT

DD:MMK/YYY
THRU
WORK AREA
PLOT
ORP:SERV:NAME

B	I	B	A
ADD OKT. I.D. **S PER ECR U3 0683 5/4/93 RW			
REINSTATED 1396-P3 ECR * 1990991 KBW 09-06-89 RW			

MFG.	SH.	REV.	LTR.	REVISIONS
------	-----	------	------	-----------

DIMENSIONS SHOWN (METRIC) INCH UNLESS OTHERWISE SPECIFIED TOLERANCES ANGULAR ± 1/2°		▽ = 0		= 0		REVISE ONLY ON CAD SYSTEM	
TITLE		.093/(2.36) HOUSING PLUG, SIDE MOUNT		SHEET NO.		DATE	
3 PLACE ± .010 ---		INCH METRIC		1 OF 1		09/06/89	
2 PLACE ± .014 ± 0.25		1 PLACE --- ± 0.35		MOLEX INCORPORATED		U.S.A.	
DRAFT WHERE APPLICABLE MUST REMAIN WITHIN DIMENSIONS		PART NO.		DRWG. NO.		SIZE	
DRWG. BY KBW		CHK'D. BY RW		03-09-2037		SD-1396-P3	
APP'D. BY GWF		SCALE 2 : 1		FILE NAME SD1396SP3		DIV. CP	
THIS DRAWING CONTAINS INFORMATION THAT IS PROPRIETARY TO MOLEX INC. AND SHOULD NOT BE USED WITHOUT WRITTEN PERMISSION.							

1396

D

B

A