

DIMENSIONS					
POSITION	A ±0.10	B $\begin{smallmatrix} +0.15 \\ -0.05 \end{smallmatrix}$	C ±0.20	D ±0.23	E ±0.20
36	6	7.65	9.15	25.00	27.00
64	20	21.65	23.15	39.00	41.00
98	37	38.65	40.15	56.00	58.00
164	70	71.65	73.15	89.00	91.00

mat'l. code		N/A		surface 58		tolerance		projection		product family		EDGE CARD	
ltr		ecn no		dr		date		tolerances unless otherwise specified		title		PCI EXPRESS SMT TYPE GEN3 for SIOM	
A		T07-1031		S.Lin		03/28/07		.X ± 0.30		MM		sheet 1 of 4	
B		T07-1151		J.H		11/05/07		.XX ± 0.20		scale N/A		size	
C		ELX-DG-17423-		ST		04/10/14		.XXX ± 0.10		FCI		A4	
D		ELX-DG-17890-		ST		05/28/14		dr WINSTON_ZHU 20220527		dwg no		10073228	
E		ELX-DG-21161-		ST		05/28/15		engr WINSTON_ZHU 20220527		type		CUSTOMER Drawing	
								chr MARS_LONG 20220527					
								app HEAVEN_CEN 20220527					
sheet index		revision sheet		F									

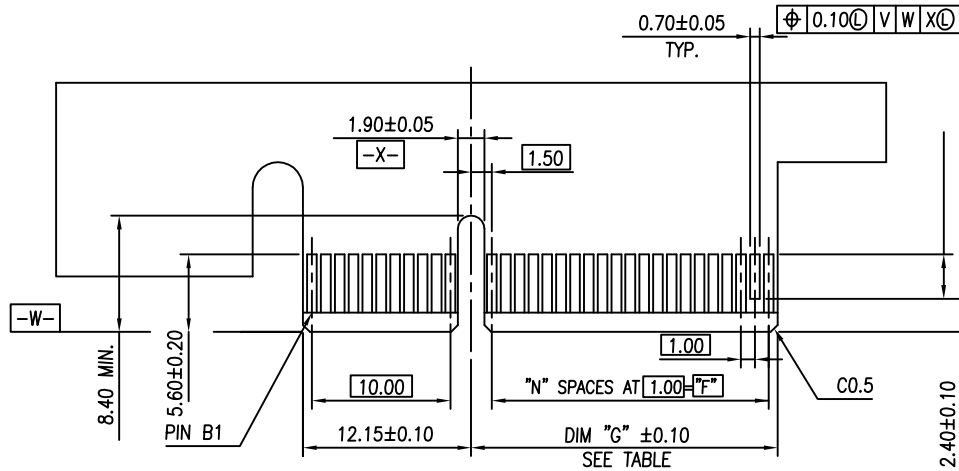

← I/O PANEL DIRECTION
PRIMARY (COMPONENT) SIDE

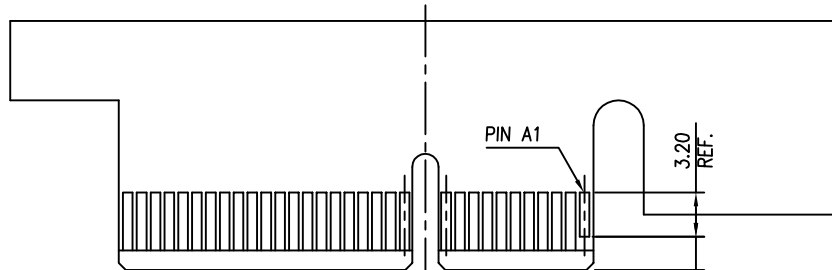

I/O PANEL DIRECTION →
SECONDARY (SOLDER) SIDE

ADD-IN CARD EDGE-FINGER DIMENSIONS

#	POS REF.	N	DIM "G"	DIM "F"	"F"
36		6	8.15	6.00	B17
64		20	22.15	20.00	B31
98		37	39.15	37.00	B48
164		70	72.15	70.00	B81

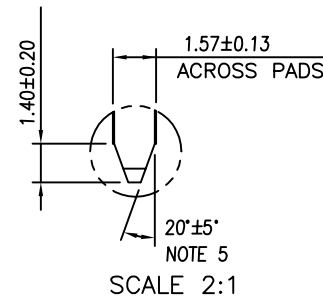

mat'l. code	N/A			surface	58	tolerance	/	projection	product family	EDGE CARD			
ltr	ecn no	dr	date	tolerances unless otherwise specified								title	
				angles	Line	.X ± 0.30		MM	PCI EXPRESS SMT TYPE GEN3 for SIOM				
				0°±2°	Line	.XX ± 0.20		scale N/A	sheet 2 of 4 size				
		dr	WINSTON_ZHU	20220527		.XXX ± 0.10			10073228 A4				
		engr	WINSTON_ZHU	20220527					type CUSTOMER Drawing				
		chr	MARS_LONG	20220527									
		appd	HEAVEN_CEN	20220527									
sheet index	revision	F											
	sheet												

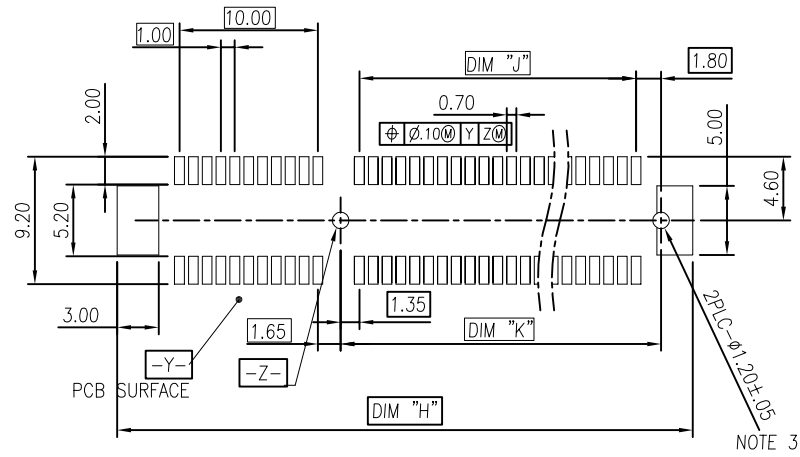

RECOMMENDED PCB LAYOUT, PAD TYPE

DIMENSIONS								
POSITION	A	B $\begin{smallmatrix} +0.15 \\ -0.05 \end{smallmatrix}$	C ± 0.20	D ± 0.23	E ± 0.20	H ± 0.10	J	K ± 0.10
36	6.00	7.65	9.15	25.00	27.00	28.00	6.00	9.15
64	20.00	21.65	23.15	39.00	41.00	42.00	20.00	23.15
98	37.00	38.65	40.15	56.00	58.00	59.00	37.00	40.15
164	70.00	71.65	73.15	89.00	91.00	92.00	70.00	73.15

POSITION OF CAP

mat'l. code		N/A		surface $\frac{58}{1}$		tolerance		projection		product family		EDGE CARD	
ltr		ecn no		dr		date		tolerances unless otherwise specified		title		PCI EXPRESS SMT TYPE GEN3 for SIOM	
								angles		MM			
								0°±2°		scale N/A			
				dr		WINSTON_ZHU 20220527				dwg no		sheet 3 of 4 size	
				engr		WINSTON_ZHU 20220527				10073228		A4	
				chr		MARS_LONG 20220527				type		CUSTOMER Drawing	
				app		HEAVEN_CEN 20220527							
sheet index		revision sheet		F									

NOTES:

1.MATERIAL:

HOUSING: HIGH TEMPERATURE NYLON, GLASS FILLED UL94V-0 RATED.

TERMINAL: COPPER ALLOY

PLATING: 50u" NICKEL UNDERPLATE ALL OVER
CONTACT AREA PLATING - SEE PRODUCT NUMBER CODE

SOLDER TAIL: TIN - SEE PRODUCT NO. CODE
100u" MIN. OVER 50u" NICKEL

METAL BOARD LOCKS: COPPER ALLOY

FINISH: 100u" TIN OVER 50u" NICKEL UNDERPLATE
SEE PRODUCT NUMBER CODE

2.RoHS COMPATIBLE PRODUCT SPECIFICATIONS

a - PLATING:

- "LF" MEANS THE PRODUCT IS LEAD-FREE, 2um MINIMUM MATTE TIN OVER 1.27um MINIMUM NICKEL UNDERPLATE.

b - MANUFACTURING PROCESS COMPATIBILITY

- THE HOUSING WILL WITHSTAND EXPOSURE TO 260°C±5°C SOLDER BATH TEMPERATURE FOR 5 SECONDS IN A REFLOW SOLDER APPLICATION WITH A 1.6mm MIN THICK CIRCUIT BOARD.

PRODUCT NUMBER CODE

10073228 -x 0 x 0 x T □ □

HOUSING COLOR OPTIONS

1-BLACK

RESERVE

TERMINAL PLATING OPTIONS

- 0-50u" Ni UNDERPLATE
- 30u" Au CONTACT AREA
- 100u" TIN TAIL AREA ----- COMPATIBLE RoHS
- 1-50u" Ni UNDERPLATE
- 15u" Au CONTACT AREA
- 100u" TIN TAIL AREA ----- COMPATIBLE RoHS
- 2-50u" Ni UNDERPLATE
- GOLD FLASH CONTACT AREA
- 100u" TIN TAIL AREA ----- COMPATIBLE RoHS

PACKAGING OPTIONS

- T: TRAY PACKAGING
- C: TRAY PACKAGING WITH 30MM CAP (FOR 64P, 98P, 164P ONLY)
- N: TRAY PACKAGING WITH MYLAR
- M: T&R PACKAGING WITH MYLAR (FOR 36P 64P AND 98P ONLY)

"LF" FOR TERMINAL PLATING OPTION 0,1,2

POS OPTIONS

- 0-36
- 1-64
- 2-98
- 3-164

RESERVE

mat'l. code		surface 58		tolerance		projection		product family	
N/A		/		/		⊕		EDGE CARD	
ltr	ecn no	dr	date	tolerances unless otherwise specified					
				angles	.X ± 0.30		MM		title
				0°±2°	.XX ± 0.20		scale N/A		PCI EXPRESS SMT TYPE GEN3 for SIOM
					.XXX ± 0.10				
		dr	WINSTON_ZHU	20220527					dwg no
		engr	WINSTON_ZHU	20220527					sheet 4 of 4
		chr	MARS_LONG	20220527					size
		app	HEAVEN_CEN	20220527					A4
sheet index		revision	F	type					
		sheet		CUSTOMER Drawing					