

| Product number | Loading Pattern | | | |
|----------------|-----------------|---|---|---|
| | ROW | 1 | 2 | 3 |
| 76268-1YZ | c | X | X | X |
| | b | | | |
| | a | X | X | X |
| 76268-3YZ | c | | | |
| | b | | | |
| | a | X | X | X |
| 76268-4YZ | c | X | X | X |
| | b | X | X | X |
| | a | X | X | X |
| 76268-5YZ | c | | | |
| | b | X | X | X |
| | a | X | X | X |

NOTE:-
 1. THE "LF" PRODUCTS MEET EUROPEAN UNION DIRECTIVES AND OTHER COUNTRY REGULATIONS AS DESCRIBED IN GS-22-008.
 2. LEAD FREE OR RoHS DIRECTIVE LABELLING TO BE PROVIDED AS PER GS-14-920 FOR LEAD FREE VERSION.

TOPVIEW FOR LOADING PATTERN

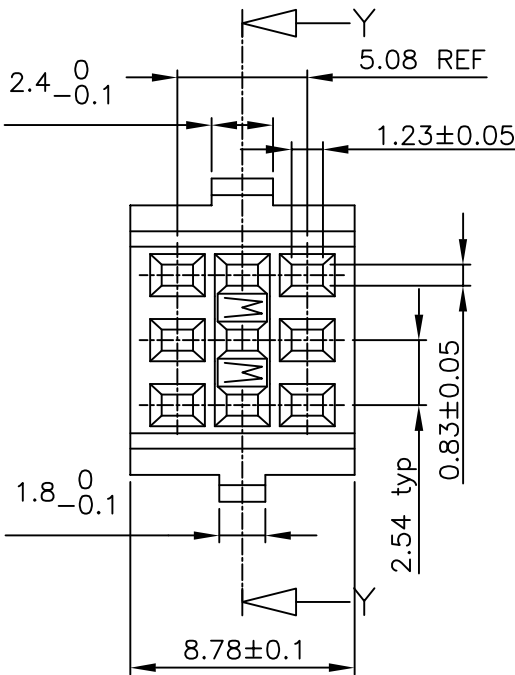
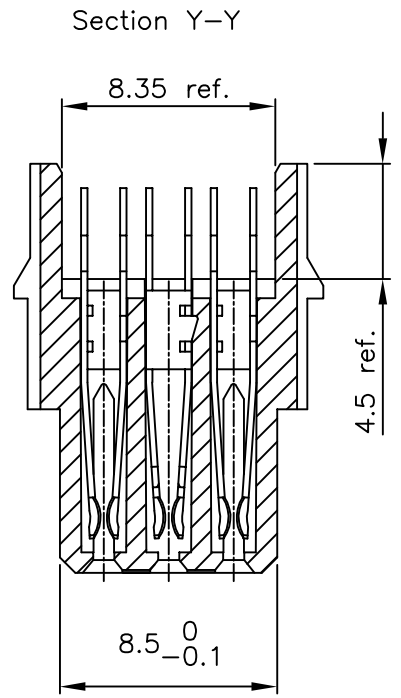
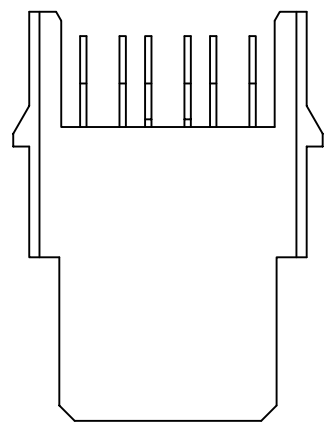
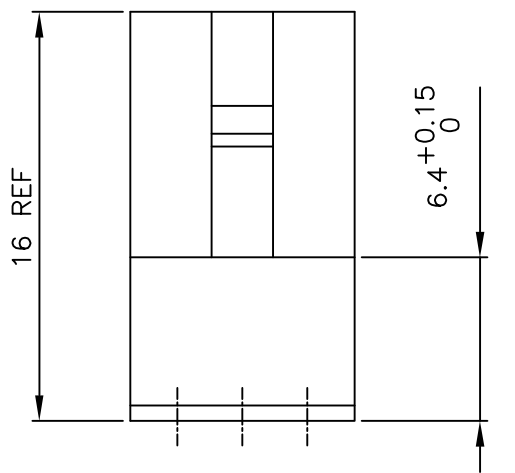
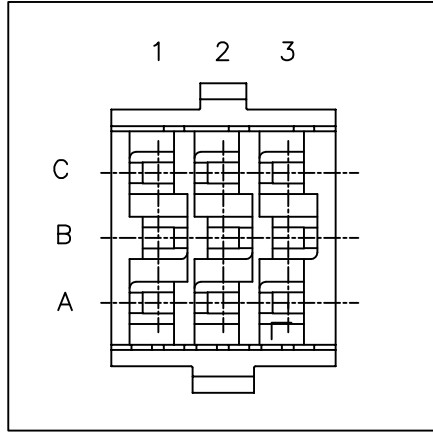

NOTES:
 1. MATERIAL HOUSING: POLYESTER 30% GLASS FILLED COLOUR GREY, FLAME RETARDANT PER UL-94-V0
 2. MATERIAL CONTACT: PHOSPHOR BRONZE
 3. CODE WW ON LEAD IN SIDE OF HOUSING APPLIES TO PIERCING TERMINAL IN RELATION TO AWG SIZE
 4. FOR CABLE APPLICATION SEE TA 301
 5. "LF" SUFFIX TO THE PRODUCT NUMBER FOR LEAD FREE OR RoHS COMPATIBLE PRODUCTS.

| | | | |
|-----------------|--------------------|-------------------------------|-----------------------------------|
| 76268-X91 | 26 | 1.25 um Au min over 3.0 um Ni | 0.03 um Au min over 0.1-0.2 um Ni |
| 76268-X52 | 30 | 1.25 um Au min over 3.0 um Ni | 0.1-0.2 um Ni |
| 76268-X51 | 26 | 1.25 um Au min over 3.0 um Ni | 0.1-0.2 um Ni |
| 76268-X42 | 30 | 2.0 um Au min over 3.0 um Ni | 0.1-0.2 um Ni |
| 76268-X41 | 26 | 2.0 um Au min over 3.0 um Ni | 0.1-0.2 um Ni |
| 76268-X22 | 30 | 0.5 um Au min over 3.0 um Ni | 0.1-0.2 um Ni |
| 76268-X21 | 26 | 0.5 um Au min over 3.0 um Ni | 0.1-0.2 um Ni |
| 76268-X12 | 30 | 1.0 um Au min over 3.0 um Ni | 0.1-0.2 um Ni |
| 76268-X11 | 26 | 1.0 um Au min over 3.0 um Ni | 0.1-0.2 um Ni |
| 76268-X02 | 30 | 3.0 um Au min over 3.0 um Ni | 0.1-0.2 um Ni |
| 76268-X01 | 26 | 3.0 um Au min over 3.0 um Ni | 0.1-0.2 um Ni |
| PRODUCT CODE YZ | CODE WW see note 3 | PLATING CONTACT AREA | PLATING PIERCING AREA |

| mat'l. code | | surface | tolerance | projection | product family |
|-------------|----------------|----------|------------|---------------------------------------|-----------------|
| see notes | | ISO 1302 | ISO 406 | ISO 101 | BACKPANEL |
| lfr | ecn no | dr | date | tolerances unless otherwise specified | title |
| G | H00085 | MVI | 1990-02-23 | angles | CableConnector |
| H | H20166 | MVI | 1992-03-31 | linear | ASSEMBLY 3x3POS |
| J | H20241 | MVI | 1992-06-16 | scale | dwg no |
| K | H30550 | MVI | 1993-08-04 | dr | M. Visschers |
| L | I05-0138 | MINI | 2005-08-08 | enr | 1992-03-20 |
| M | I06-0082 | MINI | 2006-06-01 | chr | RAKHEE GEORGE |
| N | I07-0020 | KR | 2007-02-06 | app | RAKHEE GEORGE |
| sheet index | revision sheet | N | 1 | | |



Copyright FCJ