

THIS DRAWING IS UNPUBLISHED. RELEASED FOR PUBLICATION
 © COPYRIGHT - TE Connectivity Ltd. ALL RIGHTS RESERVED.

| REVISIONS | | | | | |
|-----------|-----|---------------|-----------|-----|------|
| P | LTR | DESCRIPTION | DATE | DWN | APVD |
| H | | ECO-19-011579 | 26JUL2019 | RR | SH |

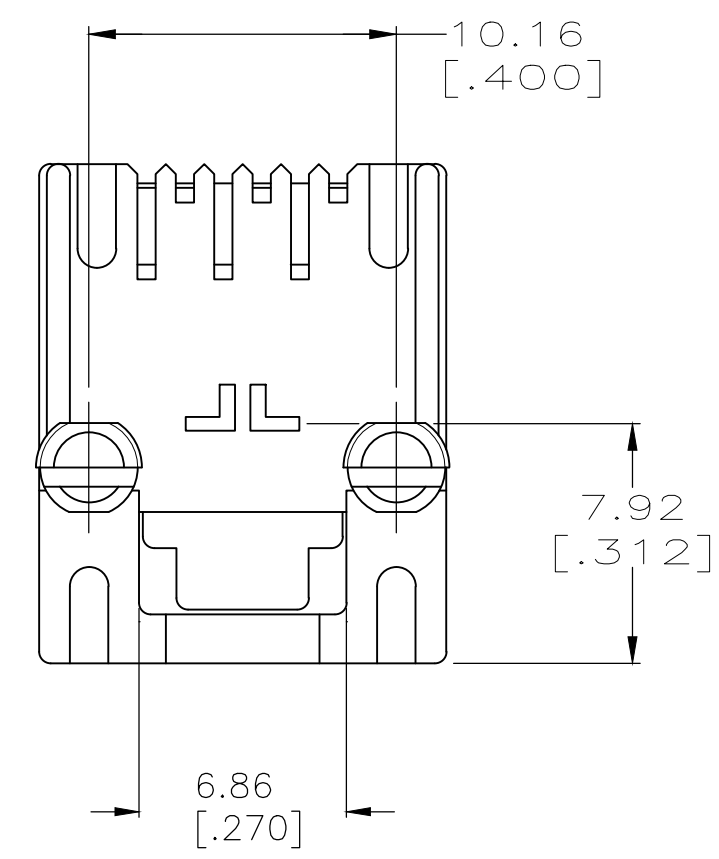
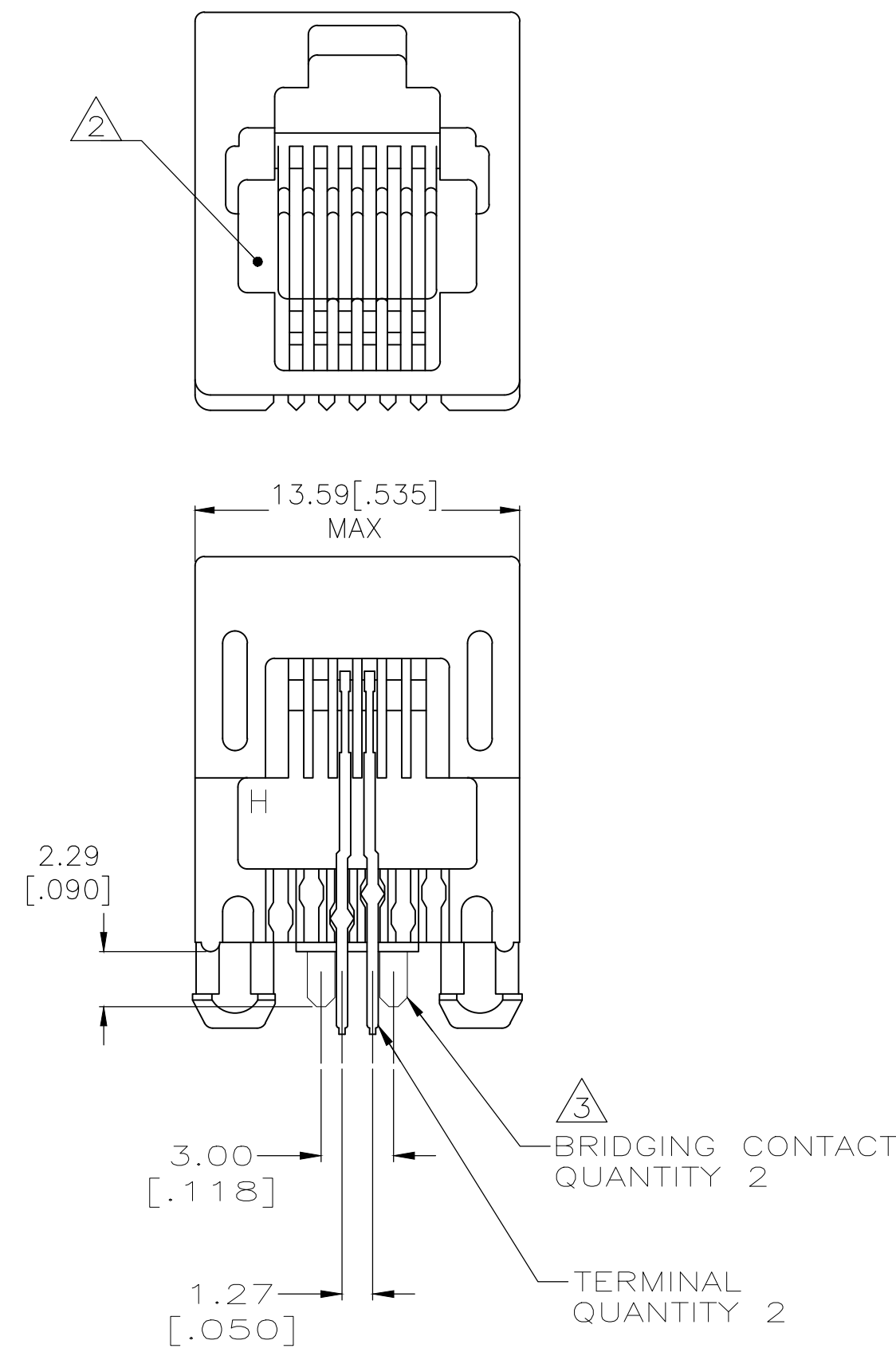
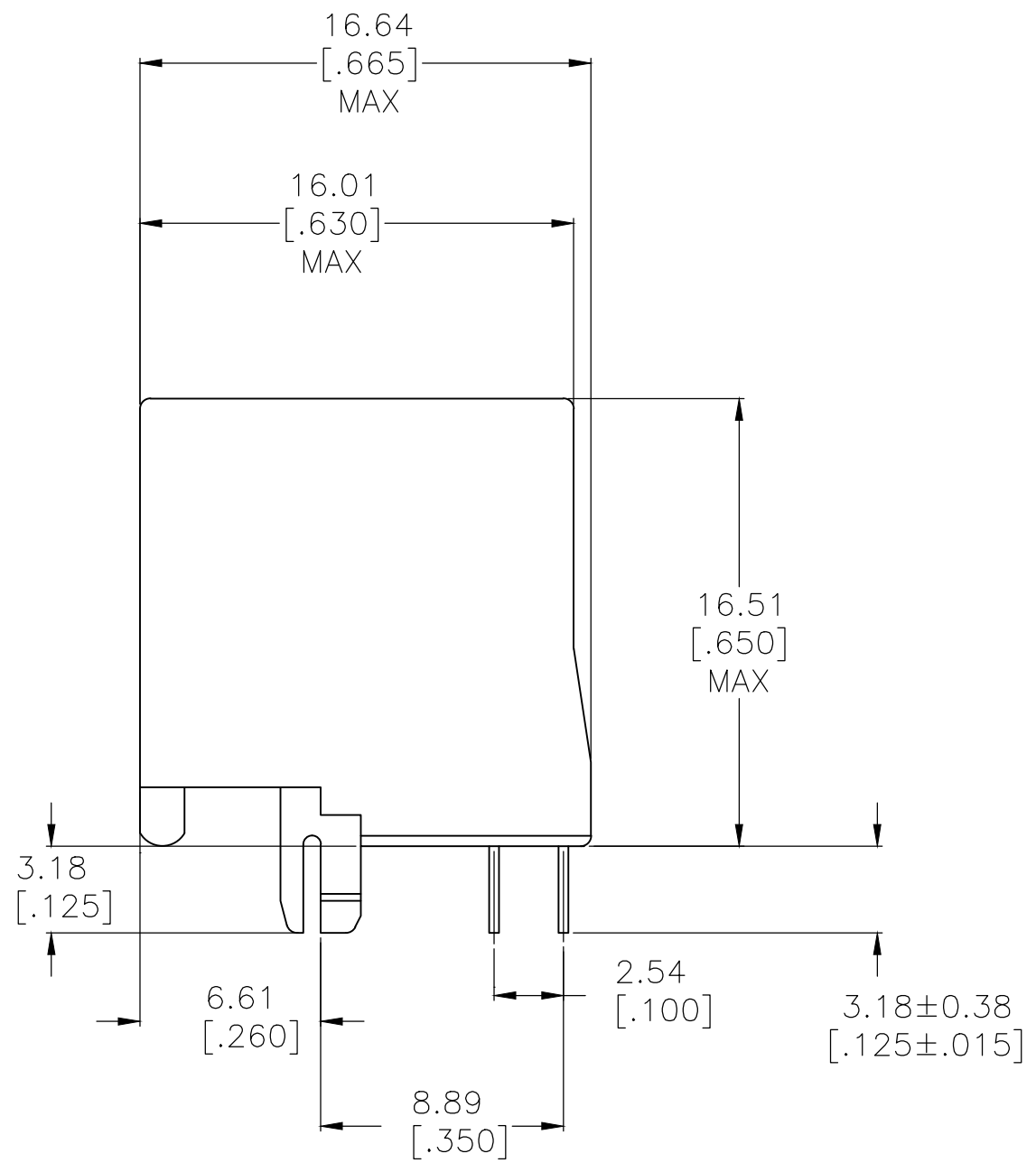

- MATERIAL: HOUSING - NYLON 94 VO, COLOR: BLACK
 TERMINAL - PHOS BRONZE PLATED WITH 1.27µm[.000050] THICK HARD GOLD IN LOCALIZED GOLD PLATE AREA AND 2.03µm[.000080] THICK MATTE TIN IN SOLDER AREA OVER 1.27µm[.000050] THICK NICKEL UNDERPLATE.
 BRIDGING CONTACT - BRASS PLATED WITH 1.27µm[.000050] THICK HARD GOLD IN LOCALIZED GOLD PLATE AREA AND 3.81µm[.000150] THICK MATTE TIN IN SOLDER AREA OVER 1.27µm[.000050] THICK NICKEL UNDERPLATE.

- CAVITY CONFORMS TO FCC RULES AND REGULATIONS PART 68 AND REA BULLETIN 345-.81 PE-76 SPECIFICATION FOR MODULAR TELEPHONE HARDWARE.
- BRIDGING CONTACTS COMPLETE CIRCUIT WHEN PLUG IS REMOVED.
- BULK PACKAGED IN A TRAY.
- CONTACTS COATED WITH BELLCORE APPROVED LUBRICANT, TECHNICAL REFERENCE GR-1217-CORE, ISSUE 1, NOVEMBER 1995.

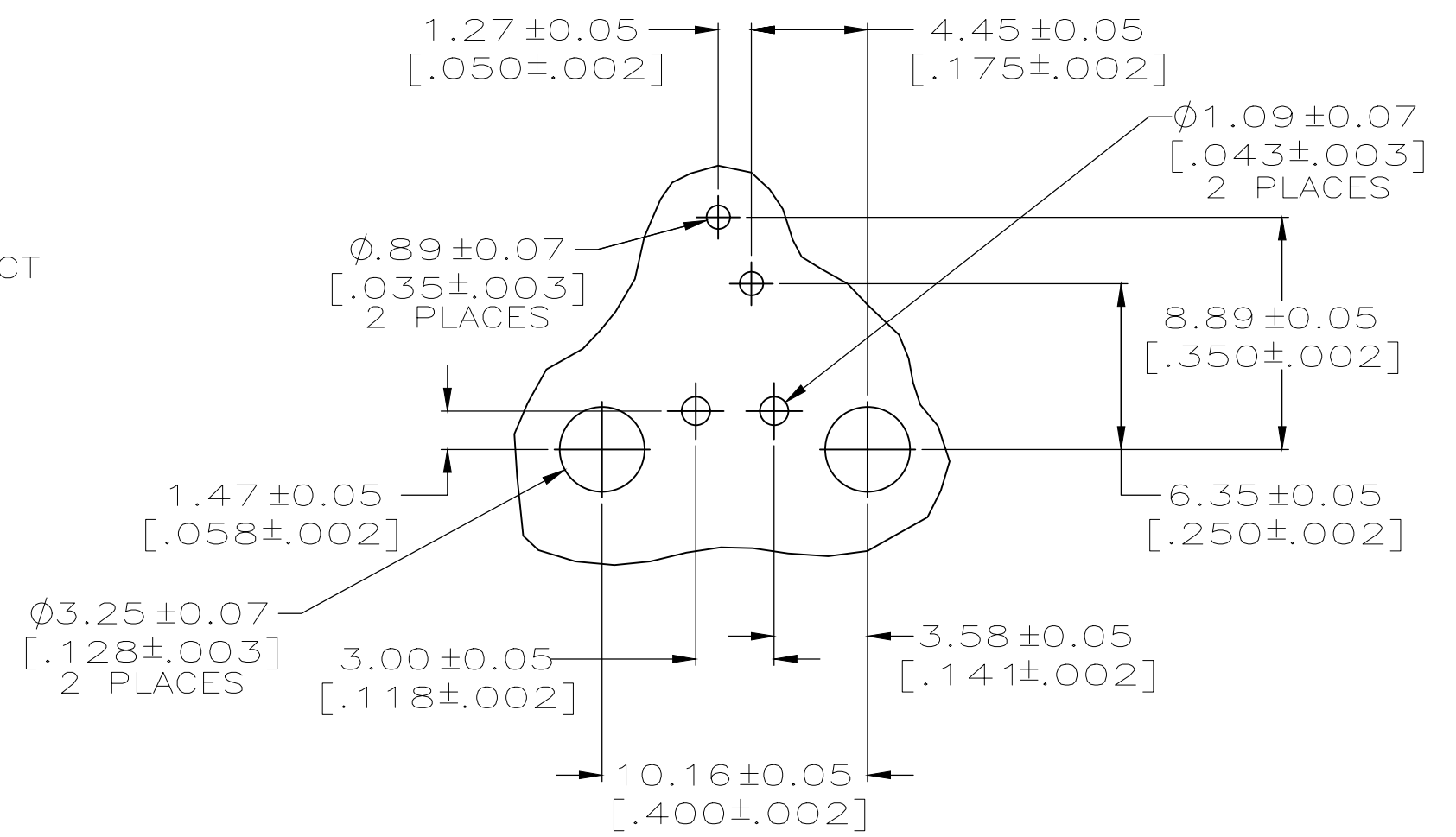

SUGGESTED PC BOARD LAYOUT
 VIEWED FROM TOP (COMPONENT SIDE)

| | | |
|----------|-------------|-------------|
| OBSOLETE | 5 | 1-5406010-2 |
| OBSOLETE | - | 5406010-2 |
| REMARKS | PART NUMBER | |

| | | | | |
|--|-------------------|-----------------------------|---|-----------------|
| THIS DRAWING IS A CONTROLLED DOCUMENT. | | DWN L.A.MAYER 16AUG2007 | | |
| DIMENSIONS: mm [INCHES] | | CHK P.RECCE 16AUG2007 | | |
| TOLERANCES UNLESS OTHERWISE SPECIFIED: | | APVD S.FLICKINGER 16AUG2007 | NAME | |
| 0 PLC ± - | 1 PLC ± - | PRODUCT SPEC 108-1721 | MODULAR JACK ASSEMBLY, FEED-THRU JACK, 6/2, TOP ENTRY, RJ-11T | |
| 2 PLC ± 0.13[.005] | 3 PLC ± - | APPLICATION SPEC 114-2048 | SIZE A2 | CAGE CODE 00779 |
| 4 PLC ± - | ANGLES ± - | WEIGHT 0.000000 | DRAWING NO C=5406010 | RESTRICTED TO - |
| MATERIAL SEE NOTE 1 | FINISH SEE NOTE 1 | CUSTOMER DRAWING | SCALE 4:1 | SHEET 1 OF 1 |
| | | | REV H | |