

THIS DOCUMENT IS THE PROPERTY OF  
KEYSTONE ELECTRONICS CORP. AND  
SHALL NOT BE REPRODUCED, DISTRIBUTED  
OR USED AS A BASIS FOR MANUFACTURE  
WITHOUT PRIOR WRITTEN PERMISSION  
FROM KEYSTONE ELECTRONICS CORP.

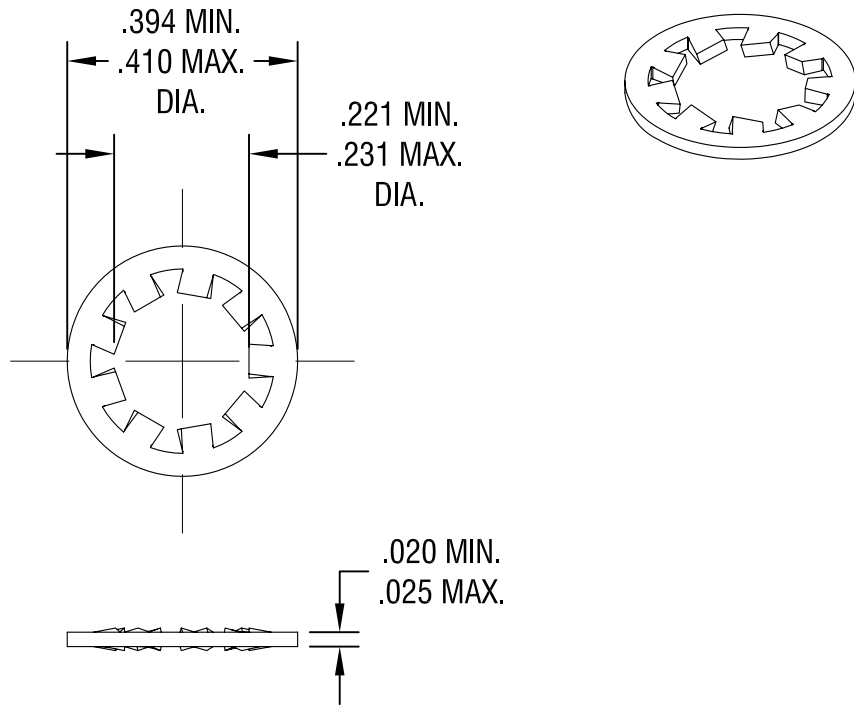

**NOTES:**

- 1. FINISH: .000100 NICKEL PLATE  
OVER .000100 COPPER PLATE

|                                   |                 |        |                |
|-----------------------------------|-----------------|--------|----------------|
| <b>KEYSTONE ELECTRONICS CORP.</b> |                 |        |                |
| ASTORIA, N.Y. 11105-2017          |                 |        |                |
| PART NAME                         |                 |        |                |
| INTERNAL TOOTH LOCK WASHER        |                 |        |                |
| MATERIAL                          |                 |        |                |
| PHOSPHOR BRONZE                   |                 |        |                |
| FINISH                            |                 | DRN BY | DATE           |
| AS NOTED                          |                 | NT     | 2.15.08        |
|                                   |                 | APP'D  | SCALE          |
|                                   |                 | LN     | 3X             |
| TOLERANCES                        | INCH [MM]       | CODE   | DWG NO.        |
| DECIMAL                           | ± .005 [± 0.15] | C/M    | <b>11362-5</b> |
| ANGULAR                           | ± 1°            |        |                |
| UNLESS OTHERWISE SPECIFIED        |                 |        |                |

| DATE | DESCRIPTION | REV. |
|------|-------------|------|
|      |             |      |