

NOTES:

1.0 MATERIALS:

- 1.1 HOUSING & LOCKNUT: STAINLESS STEEL PER ASTM-A582, TYPE 303.
- 1.2 CENTER CONTACT: BERYLLIUM COPPER ROD ALLOY C172, PER ASTM-B196.
- 1.3 DIELECTRIC: PTFE FLUOROCARBON PER ASTM-D1457.
- 1.4 LOCKWASHER: STAINLESS STEEL 400 SERIES.

2.0 PLATING:

- 2.1 HOUSING, LOCKNUT & LOCKWASHER: PASSIVATED PER MIL-F-14072 AND QQ-P-35
- 2.2 CENTER CONTACT: GOLD PER MIL-PRF-39012  
TYPE II, CLASS 2.

3.0 MECHANICAL:

- 3.1 INTERFACES PER MIL-STD-348 IN ACCORDANCE MIL-A-55339
- 3.2 CENTER CONTACT CAPTURED IN ACCORDANCE MIL-A-55339

4.0 ELECTRICAL:

- 4.1 VSWR 1.15:1 MAXIMUM FROM DC-4.0 GHz. FREQUENCY RANGE

5.0 DIMENSIONS IN BRACKETS ARE MILLIMETERS.

BNC JACK COMPATIBLE WITH MIL-PRF-39012 BNC SERIES CONNECTORS

SMA JACK COMPATIBLE WITH MIL-PRF-39012 SMA SERIES CONNECTORS

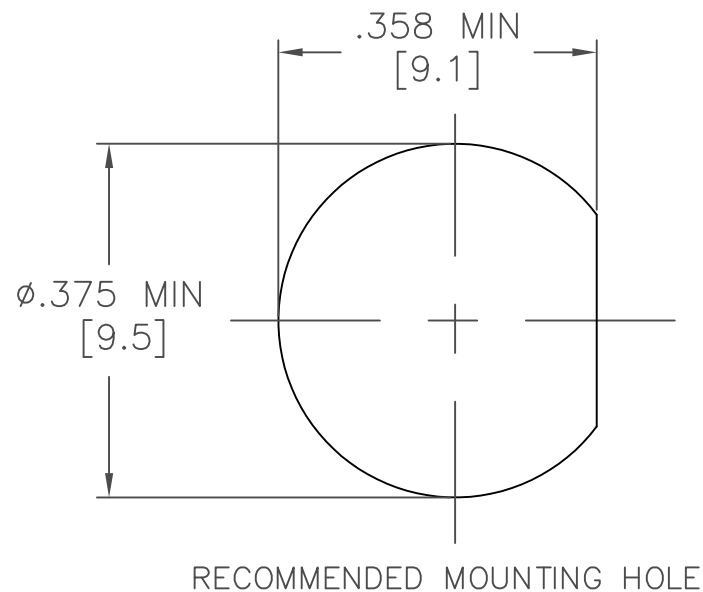
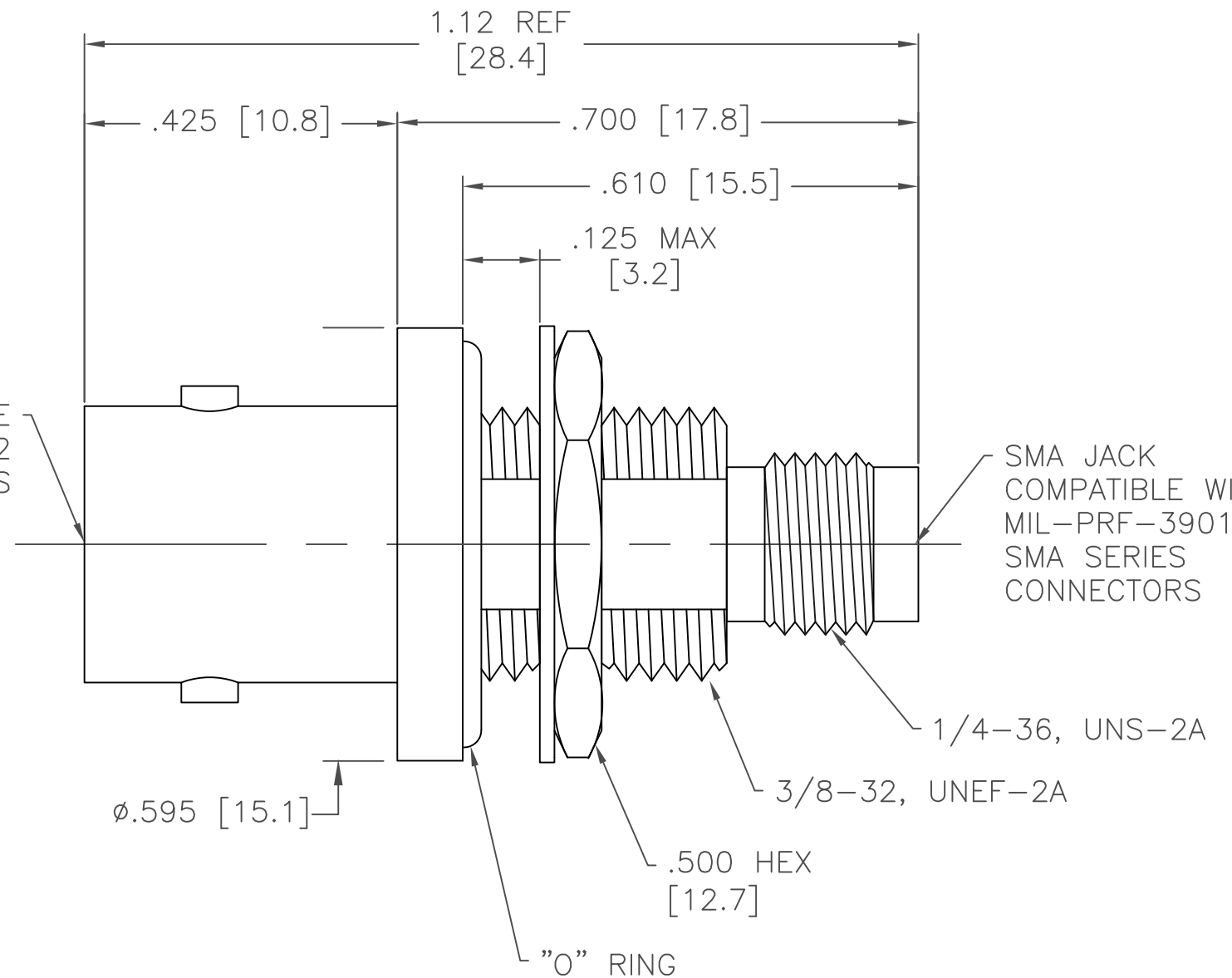

NOTICE: The information contained in this drawing is proprietary and must not be used without the permission of Emerson Network Power.

UNLESS OTHERWISE NOTED DIMENSIONS ARE IN INCHES AND TOLERANCES ARE:  
3 PLACE DECIMALS  $\pm .005$   
2 PLACE DECIMALS  $\pm .02$   
FRACTIONS  $\pm 1/64$   
PARALLELITY: T.I.R. \_\_\_\_\_  
FLATNESS: T.I.R. \_\_\_\_\_  
CONCENTRICITY: T.I.R. \_\_\_\_\_  
ANGLES AND PERPENDICULARITY:  $\pm 1'$

CAGE CODE  
**34078** *MIDWEST MICROWAVE*

**EMERSON**  
Network Power  
Connectivity Solutions

TITLE  
BNC JACK TO SMA JACK  
BLKHD FEEDTHRU ADAPTER  
OUTLINE DRAWING

DRAWN/DATE  
A.BEATTY  
8/25/94  
ENG./DATE  
A.OSGA  
9/2/94  
CHECKED/DATE  
M.HOLLMAN  
8/26/94  
APPROVED/DATE  
C.RIGGE  
11/18/98

DRAWING NUMBER  
ADT-2838-BF-SMF-02-01  
REV. B  
SCALE: 5=1 SHEET 1 of 1

REV.	DESCRIPTION	DATE
I	RELEASED	9/2/94
A	ECN 16928	12/3/98
A1	ADDED TITLEBLOCK	3/17/05
B	ECO 24058	1/31/12