



# 961 Series

## Rectangular Non-Relampable Snap-fit Panel Mount Indicator



### Overview

The 961 Series non-relampable snap mount rectangular indicator lights are designed for mounting into a 1.281" x .395" hole with panel thickness ranges from .045" to .090".

### Specifications

**Housing:** White Nylon (standard), black optional, other color available to special order.

**Bezel:** Sulfamate Nickel Plated.

**Terminations:** Wire leads: Black #18 wire gauge, PVC plastic insulated. UL-CSA rated at 105°C. 6" long. 1/2" stripped. Terminal: Brass, Tin-plated 1/4" or 3/16" quick connect.

**Incandescent AC or DC Voltage options:** 6 to 28 volts.

**High Brightness Neon AC Voltage options:** 125 to 250 volts.

**Lens:** Heat resistant, high strength polycarbonate. Fluted (standard). Smooth face available to special order.

**Lens Marking:** Lenses can be stamped. Contact Sales.

**Mounting:** Designed to snap securely into a 1.281" x .395" hole. Panel thickness ranges from .045" to .090"

**Note:** Assemblies "No-Lens" - Body Only - are not cURus

## Dimensions

All dimensions in inches.

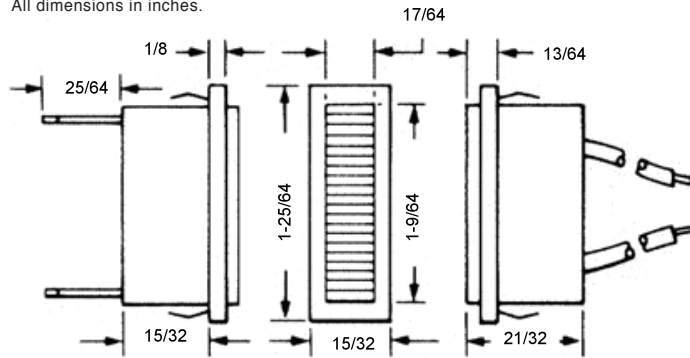

Wire Leads Version

0.187" Q.C. Terminals Version

0.250" Q.C. Terminals Version

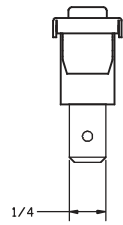
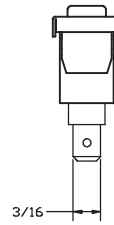
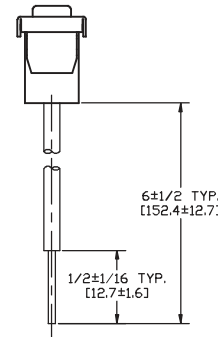

## Ordering Information

EXAMPLE 961 6 71 T 90 W AN											
Chrome Plated Bezel		Wire Leads		250 Volt Neon Lamp		Built-in 150K OHM	Rectangular Fluted Lens	White Housing	Amber Non-Diffusing Lens		
Series Number	Termination	Lamp				Resistor	Lens Type	Housing Color	Lens Color		
		Code	Volts	MA	Life(Hrs)						
961 Chrome Plated Bezel	6 6" Wire Leads	10	6.0	40	10,000	X None (No Resistor required with incandescent lamps)	90 <sup>5</sup> Rectangular (Fluted) Standard 91 Rectangular (Smooth) Optional	W White (Standard)	Nondiffusing (Clear)		
		12	6.3	200	5,000						
		02	6.3	200	20,000						
		13	14.0	80	1,500						
		03	14.0	80	15,000						
		15	28.0	40	4,000						
	7 187" Q.C. Terminals	04	NEON (High Brightness)					A 22K OHM T 150K OHM B 30K OHM E 100K OHM	B Black (Optional)	Y Yellow	
			70 <sup>2</sup>	125	1/3 W						10,000
			70 <sup>2</sup>	250	1/3 W						10,000
			56 <sup>3</sup>	125	1/3 W						10,000
8 .250 Q.C. Terminals	56 <sup>3</sup>	56 <sup>3</sup>	250	1/3 W	10,000	E 100K OHM	B Black (Optional)	Y Yellow			
		57 <sup>4</sup>	125	1/3 W	10,000						
		57 <sup>4</sup>	250	1/3 W	10,000	E 100K OHM					
<p><sup>2</sup> Standard Neon. Use with lens color AN, CN, RN, WN, or YN.  <sup>3</sup> Green Neon. Use with lens colors CN, GN or WN.  <sup>4</sup> Blue Neon. Use with lens color BN, CN, or WN.  <sup>5</sup> Only with nondiffusing lens colors.  <sup>6</sup> Do not use with neon lamps.</p>											
<p>AT Amber BT Colorless GT Green RT Red WT White YT Yellow</p>											

## Compliances and Approvals

