

DESIGNED FOR USE WITH	.141 S.R. CABLE
CABLE ENTRY DIAMETER MINIMUM	
HOUSING	.145
CONTACT	.0369

REVISIONS			
REV	DESCRIPTION	DATE	APPROVED
03 ₀	REVISED	6/30/97	PCV 7/1/97

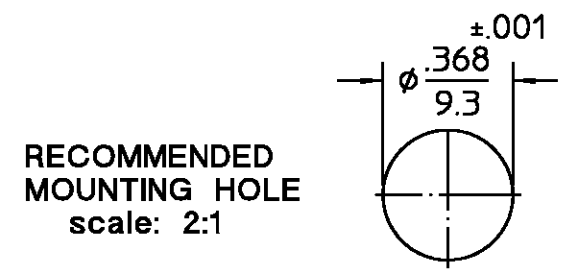

NOTES:
1. CAPTURED CENTER CONTACT

COMPONENT	MATERIAL	FINISH
HOUSING, OUTER MOUNTING NUT WASHER	STAINLESS STEEL PER ASTM-A484 AND ASTM-A582, TYPE 303	PASSIVATE PER QQ-P-35
INNER HOUSING	STAINLESS STEEL PER ASTM-A484 AND ASTM-A582, TYPE 303	GOLD PLATE PER MIL-G-45204
DIELECTRIC	PTFE FLUOROCARBON PER ASTM-D-1457	N/A
CENTER CONTACT CONTACT SLEEVE	BERYLLIUM COPPER PER ASTM-B-196 OR ASTM-B-197, ALLOY C17300, CONDITION H	GOLD PLATE PER MIL-G-45204
CONTACT RING	BERYLLIUM COPPER PER ASTM-B-194, ALLOY C17200, CONDITION H	GOLD PLATE PER MIL-G-45204
RETAINING RING	BERYLLIUM COPPER PER ASTM-B-194, ALLOY C17200, CONDITION H	NICKEL PLATE PER QQ-N-290
LOCKWASHER	CARBON STEEL 1050	GOLD PLATE PER MIL-G-45204
SPRING	MUSIC WIRE	NICKEL PLATE PER QQ-N-290

ELECTRICAL	ELECTRICAL (cont)	ENVIRONMENTAL
Nominal Impedance (Ohms) 50	RF High Potential @ Sea Level (VRMS MIN @ 5 MHz) 670	Temperature Rating -65° to +125°C
Frequency Range (GHz) DC to 22	I.R.(Megohms MIN) 5000	Vibration MIL-STD-202, Method 204, Condition D
Volt Rating (VRMS MAX) @ Sea Level 335		Shock MIL-STD-202, Method 213, Condition I
VSWR 1.05+.005f(GHz) DC to 18 GHz		Thermal Shock MIL-STD-202, Method 107, Condition B
1.05+.009f(GHz) DC to 22 GHz		Moisture Resistance MIL-STD-202, Method 106
Insertion Loss (dB MAX) .03x√f(GHz)		Corrosion - MIL-STD-202, Method 101, Condition B
RF Leakage (dB MIN) (Interface Only, Fully Mated) -(90-f(GHz))		
Corona, 70,000 Ft (VRMS MIN) 250		
Dielectric Withstanding Voltage (VRMS MIN) @ Sea Level 1000		
Contact Resistance (Milliohms MAX)		
Center Contact 2.0		
Outer Contact 2.0		
Cable to Housing 0.5		

MECHANICAL	
Interface Dimensions	MIL-STD-348A FIG. 321
Mating Characteristics:	
Insertion (MAX Lbs)	3
Withdrawal (MIN Oz)	1
Force to Engage (In-Lbs MAX) & Disengage (In-Lbs MAX)	3 & 15
Center Contact Captivation	
Axial (Lbs)	6
Cable Retention	
Axial Force (Lbs MIN)	30
Torque (In-Oz MIN)	16
Weight (Grams)	

.XXX = in
XX.X = mm (REF)

COMPONENT	MATERIAL	FINISH
UNLESS OTHERWISE SPECIFIED DIMENSIONS ARE IN INCHES	FRAC. DEC. ANGLES ± 1/64 ±.005 ± 1°	
DRAWN BY KCM	DATE 1/29/88	AMP Incorporated
CHECKED BY MH/M	3/30/88	140 Fourth Avenue
APPD BY DC	3/30/88	Waltham, MA 02451-7599
USE ASSY PROCEDURE	NO. A.P. 408-08281 (45-046)	TITLE OSP FLOATING PANEL FEEDTHRU CABLE JACK DIRECT SOLDER ATTACHMENT
SIZE B	CODE IDENT NO. 26805	4522-7941-02
SCALE 4:1	REV 03 ₀	SHEET 1 OF 1