

Banana Plug - Insulated Hex Body Solder Type Long Handle



INCHES (MILLIMETERS)
CUSTOMER DRAWINGS AVAILABLE UPON REQUEST

SPECIFICATIONS

Plug Body: Brass per QQ-B-626D

Plug Spring: Nickel silver per QQ-C-585

Finish: Nickel

Insulated Handle: Nylon 6/6 per ASTM D4066

RATINGS

Current: 15 amps

Breakdown Voltage: 3500 Vrms minimum

Contact Resistance: 0.010 ohms maximum

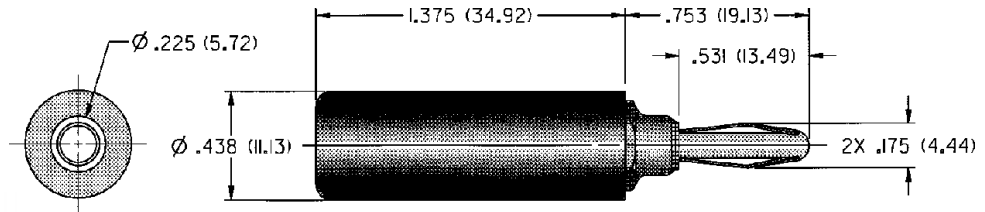

| NICKEL PLATING | |
|----------------|-------|
| 108-0752-001 | Black |

For Standard Banana Jack: .166 (4.23) Diameter

FEATURES:

- Solder type terminal uses up to 16 gauge wire
- Nylon UL approved for self extinguishing