

NOTES:

1. ALL PARTS ARE BULK PACKED.
2. CONTACTS ARE ASSEMBLED IN CONNECTOR WITH SOLDER CUPS FACING DIRECTLY OUTWARD
3. ALL DIMENSIONS ARE REFERENCE EXCEPT THOSE WITH A TOLERANCE

ASSEMBLY P/N	CONTACT QTY.		CABLE O.D. RANGE
	#16	#20	
W8C82-6SG-P-513	2	4	.13-.15 [3.3-3.8]
W8C82-6SG-P-516			.16-.18 [4.1-4.6]
W8C82-6SG-P-519			.19-.21 [4.8-5.3]
W8C82-6SG-P-522			.22-.25 [5.6-6.3]
W8C82-6SG-P-526			.25-.27 [6.4-6.9]
W8C82-6SG-P-528			.26-.285 [6.6-7.2]

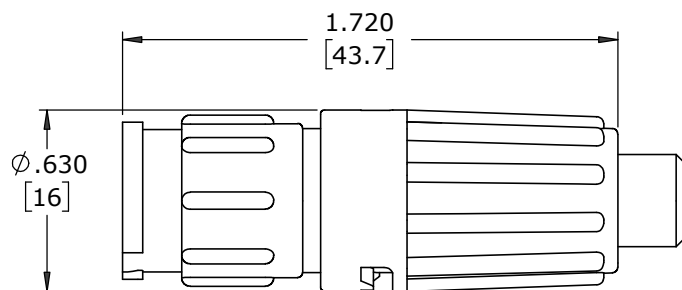
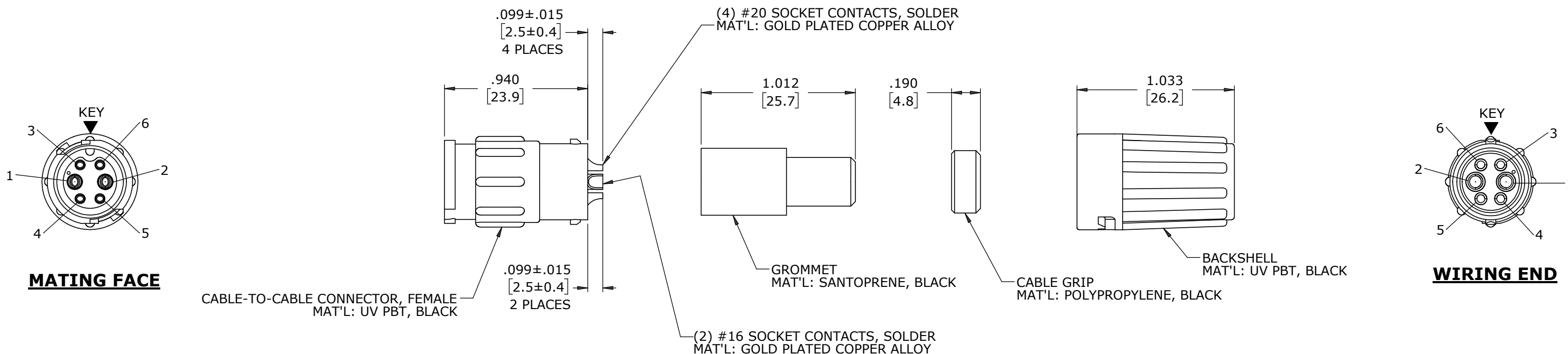

SHOWN ASSEMBLED
FOR CUSTOMER REFERENCE ONLY

DIMENSIONS IN BRACKETS [] ARE IN MILLIMETERS

CUSTOMER APPROVAL			
THIS DOCUMENT CONTAINS CONFIDENTIAL INFORMATION PROPRIETARY TO CONXALL CORPORATION. ANY REPRODUCTION, DISCLOSURE, OR USE OF THIS DOCUMENT /INFORMATION IS EXPRESSLY PROHIBITED UNLESS AUTHORIZED IN WRITING BY CONXALL CORPORATION.			
APPROVED BY: _____	MA 07-20-20	PNK 01-18-18	RELEASED PER PDR 16014-10
DATE: _____	INIT: _____	DATE: _____	DESCRIPTION: PDR16014
ALL INFORMATION ILLUSTRATED IS THE PROPERTY OF "CONXALL CORPORATION". UNAUTHORIZED DUPLICATION OR DISTRIBUTION OF THIS DOCUMENT IS PROHIBITED.		ORIG. DRAWN BY: PNK	DATE: 01-18-18
ALL UNITS ARE IN FEET, INCHES, FRACTIONS OF INCHES AND DECIMALS.		CHECKED BY: _____	<p>601 E. WILDWOOD VILLA PARK, IL 60181</p>
UNLESS OTHERWISE SPECIFIED TOLERANCES: 3 PLACE DECIMALS ±.010 ANGLES ±1° FRACTIONS ±1/16		APPROVED BY: _____	
SCALE: NTS	SIZE: B	SHEET: 1 OF 1	CUSTOMER: STANDARD PRODUCT
FILE: W8C82-6SG-P-5XX	DIRECTORY: SLW	PART NUMBER: W8C82-6SG-P-5XX	REV: A

RoHS COMPLIANT