

| REVISIONS |     |                           |           |     |      |
|-----------|-----|---------------------------|-----------|-----|------|
| P         | LTR | DESCRIPTION               | DATE      | DMN | APVD |
| C         |     | REVISED PER ECR-14-001435 | 21JUL2016 | RS  | PO   |
| D         |     | REVISED PER ECO-16-018096 | 19JUL2017 | RK  | PO   |

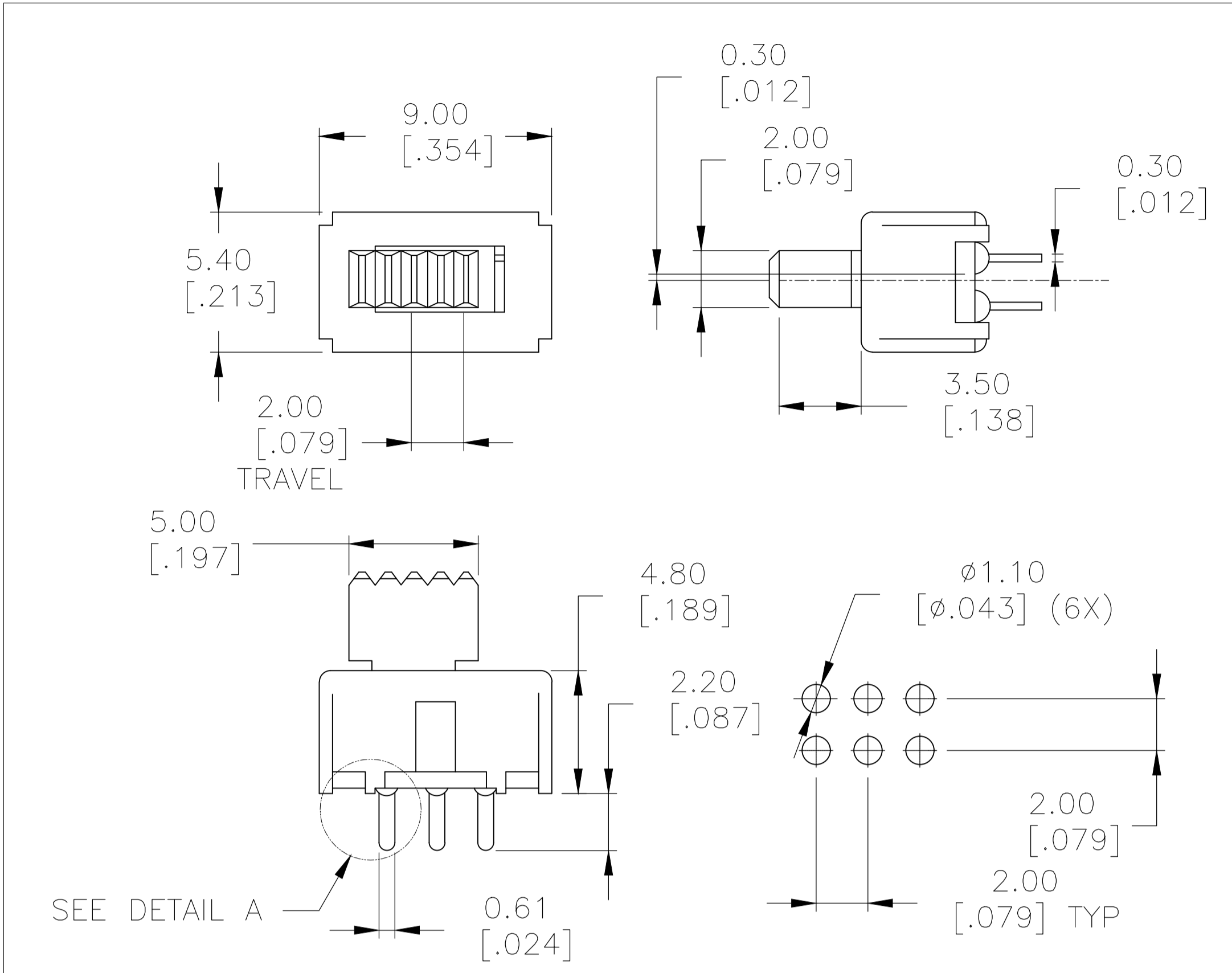

RECOMMENDED HOLE LAYOUT  
TOLERANCE ±.002 UNLESS OTHERWISE NOTED

**SSB 22**

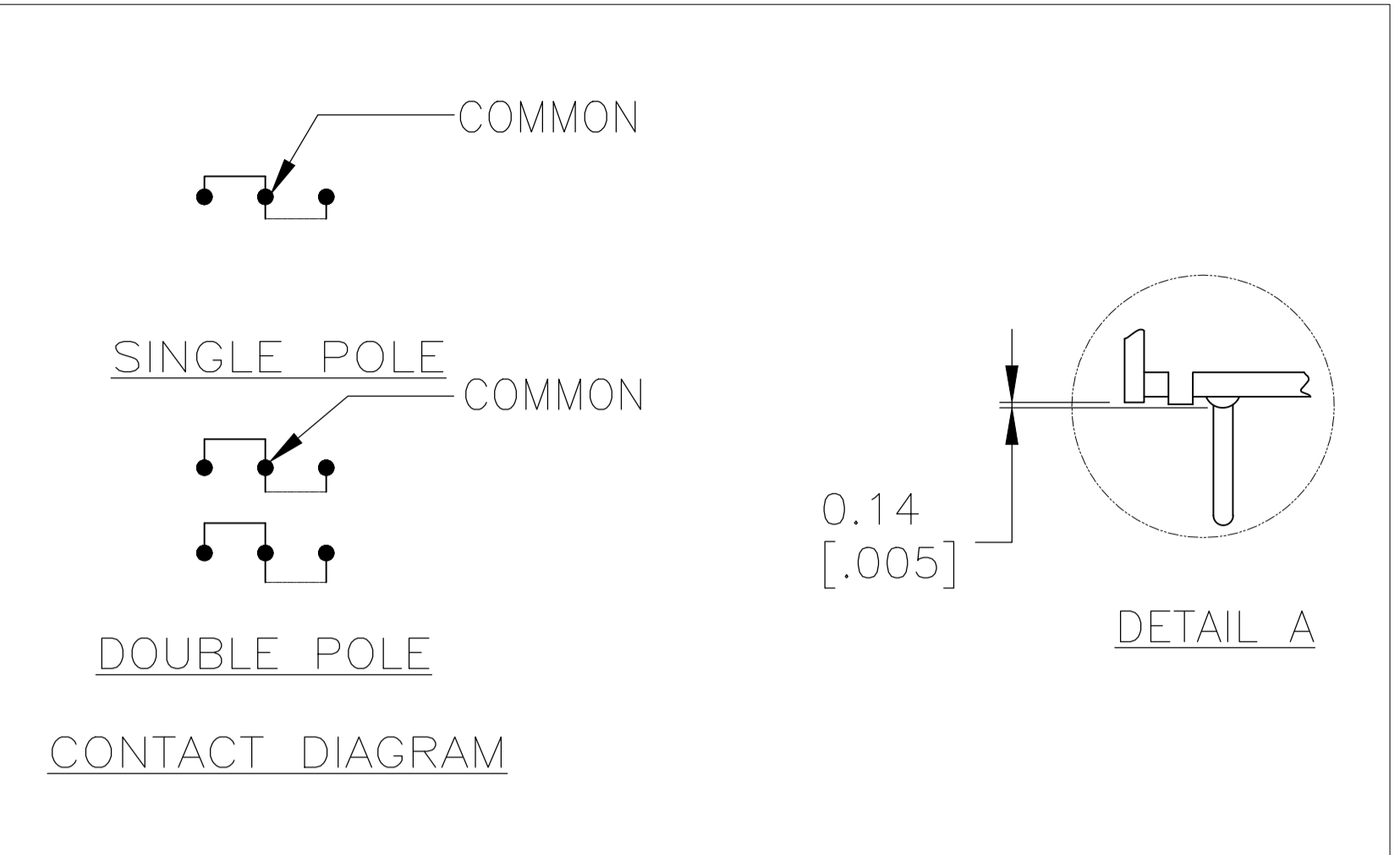

- NOTES:
- ALL MATERIALS AND FINISHES SHALL COMPLY WITH EU DIRECTIVE 2002/95/EC OF 27JAN2003 (ROHS).
  - SEE SHEET 2 OF 2 FOR SSB42 AND SSB\*\*R PART NUMBERS.
- ⚠ OBSOLETE

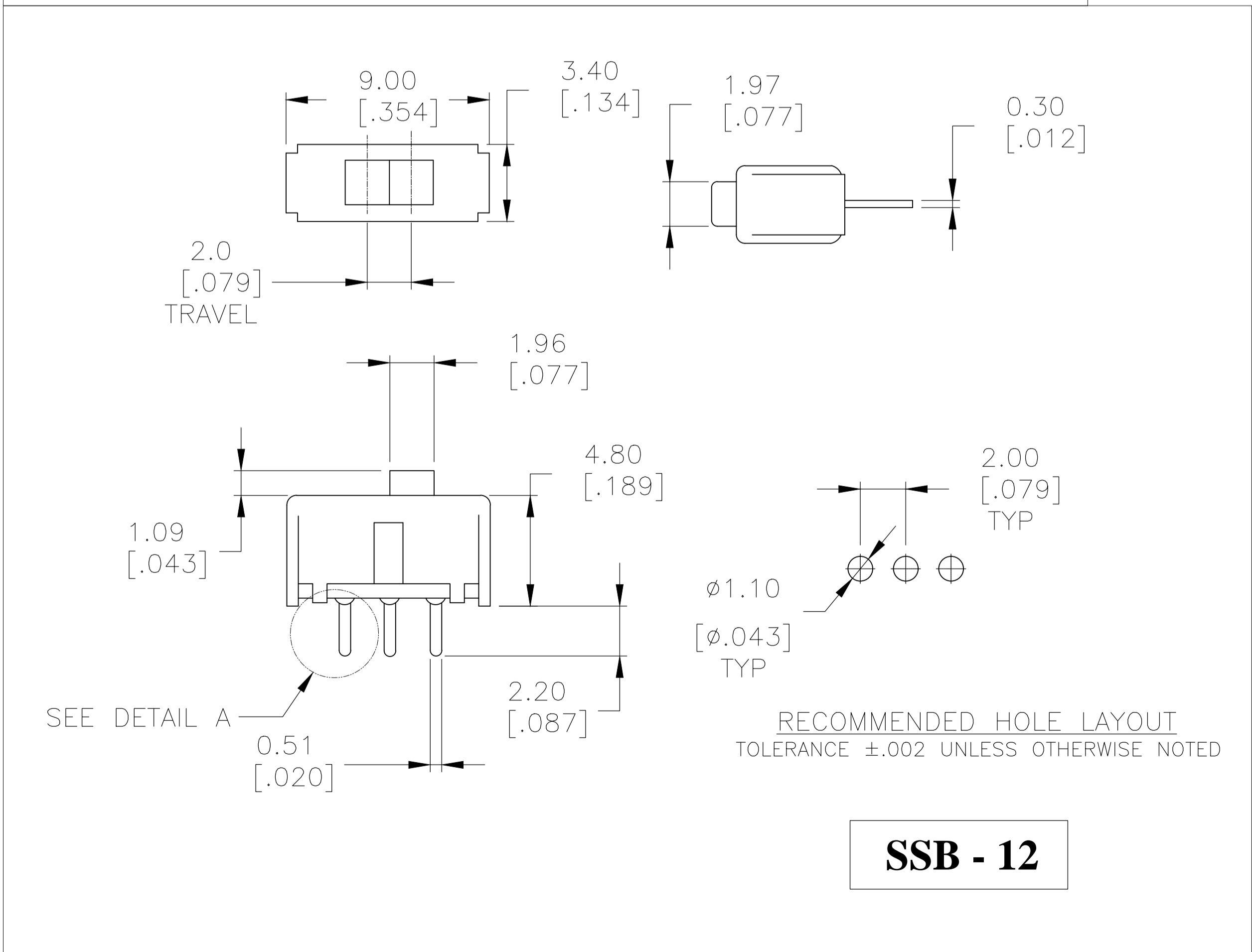

RECOMMENDED HOLE LAYOUT  
TOLERANCE ±.002 UNLESS OTHERWISE NOTED

**SSB - 12**

SPECIFICATIONS:  
MAKE BEFORE BREAK

MATERIALS:  
FRAME, STEEL-PLATE TIN OVER NICKEL  
TERMINAL BOARD, PHENOLIC, NATURAL  
ACTUATOR, POM, UL94-HB, BLACK  
MOVING CONTACT, COPPER ALLOY-PLATE SILVER OR GOLD OVER NICKEL  
FIXED CONTACT/TERMINAL, COPPER ALLOY-PLATE SILVER OR GOLD OVER NICKEL

ELECTRICAL:  
CONTACT RATING, (SILVER)100mA@30VDC, (GOLD) .4VA @ 20V DC  
INITIAL CONTACT RESISTANCE, 30 MILLIOHMS MAX  
FINAL CONTACT RESISTANCE, 100 MILLIOHMS MAX  
INSULATION RESISTANCE, 100 MEGOHMS MIN.  
DIELECTRIC STRENGTH, 500 V AC for 1 MINUTE

MECHANICAL:  
ACTUATION FORCE, 250 +/-150 GRAMS  
ACTUATION TRAVEL, .079  
LIFE EXPECTANCY, 10,000 CYCLES

ENVIRONMENTAL:  
OPERATING TEMPERATURE, -20 to +85 DEGREES C  
STORAGE TEMPERATURE, -40 to +100 DEGREES C  
HUMIDITY AND TEMPERATURE CYCLING PER EIA-364-31B, METHOD III (SILVER)  
MIXED FLOWING GAS PER EIA-364-65A, CLASS IIIA, 20 DAYS (GOLD)  
THERMAL SHOCK, PER EIA-364-32C, -40 to +100 DEGREES C  
SOLDERABILITY, PER EIA-364-52, CLASS 2, CATEGORY 1, 95% MINIMUM COVERAGE  
RESISTANCE TO SOLDER HEAT,  
PER 109-202, CONDITION B (240 +/-5 C FOR 10 +2/-0 SECONDS)

| Configuration | Terminal Pairs         | Material | Contacts | Part Number | TE P/N      |
|---------------|------------------------|----------|----------|-------------|-------------|
| 4PDT          | 1-2, 4-5<br>7-8, 10-11 | GOLD     | 4PDT     | SSB42G      | 2-1437575-9 |
|               | 2-3, 5-6<br>8-9, 11-12 | SILVER   | 4PDT     | SSB42       | 2-1437575-8 |
| DPDT          | 1-2, 4-5<br>7-8, 10-11 | GOLD     | DPDT     | SSB22RG     | 2-1437575-5 |
|               | 2-3, 5-6<br>8-9, 11-12 | SILVER   | DPDT     | SSB22R      | 2-1437575-4 |
| SPDT          | 1-2, 4-5<br>7-8, 10-11 | GOLD     | SPDT     | SSB12RG     | 2-1437575-1 |
|               | 2-3, 5-6<br>8-9, 11-12 | SILVER   | SPDT     | SSB12R      | 2-1437575-0 |
| SPDT          | 1-2, 4-5<br>7-8, 10-11 | GOLD     | SPDT     | SSB12G      | 1-1437575-9 |
|               | 2-3, 5-6<br>8-9, 11-12 | SILVER   | SPDT     | SSB12       | 1-1437575-8 |
| LEFT          | RIGHT                  | PLATING  | TYPE     | ALCO P/N    | TE P/N      |

THIS DRAWING IS A CONTROLLED DOCUMENT. DIN B.S.VISWESWARA 25SEP05

|                         |  |      |      |
|-------------------------|--|------|------|
| DIMENSIONS: mm [INCHES] | TOLERANCES UNLESS OTHERWISE SPECIFIED: | APVD | NAME |
| 0 PLC ± .01             | 1 PLC ± .02                            |      |      |
| 2 PLC ± .025[.010]      | 3 PLC ± .025                           |      |      |
| 4 PLC ± .025            | ANGLES ± 1'                            |      |      |

MATERIAL: SEE ABOVE FINISH: -

WEIGHT: A1 00779

CUSTOMER DRAWING SCALE: 6:1 SHEET: 1 OF 2 REV: D

**STE** TE Connectivity

SLIDE SWITCH, LOW PROFILE SSB SERIES

SIZE: CAGE CODE: DRAWING NO: RESTRICTED TO: 2-1437575-3

| REVISIONS |     |             |      |      |
|-----------|-----|-------------|------|------|
| P         | LTR | DESCRIPTION | DATE | APPD |
| -         | -   | SEE SHEET 1 | -    | -    |

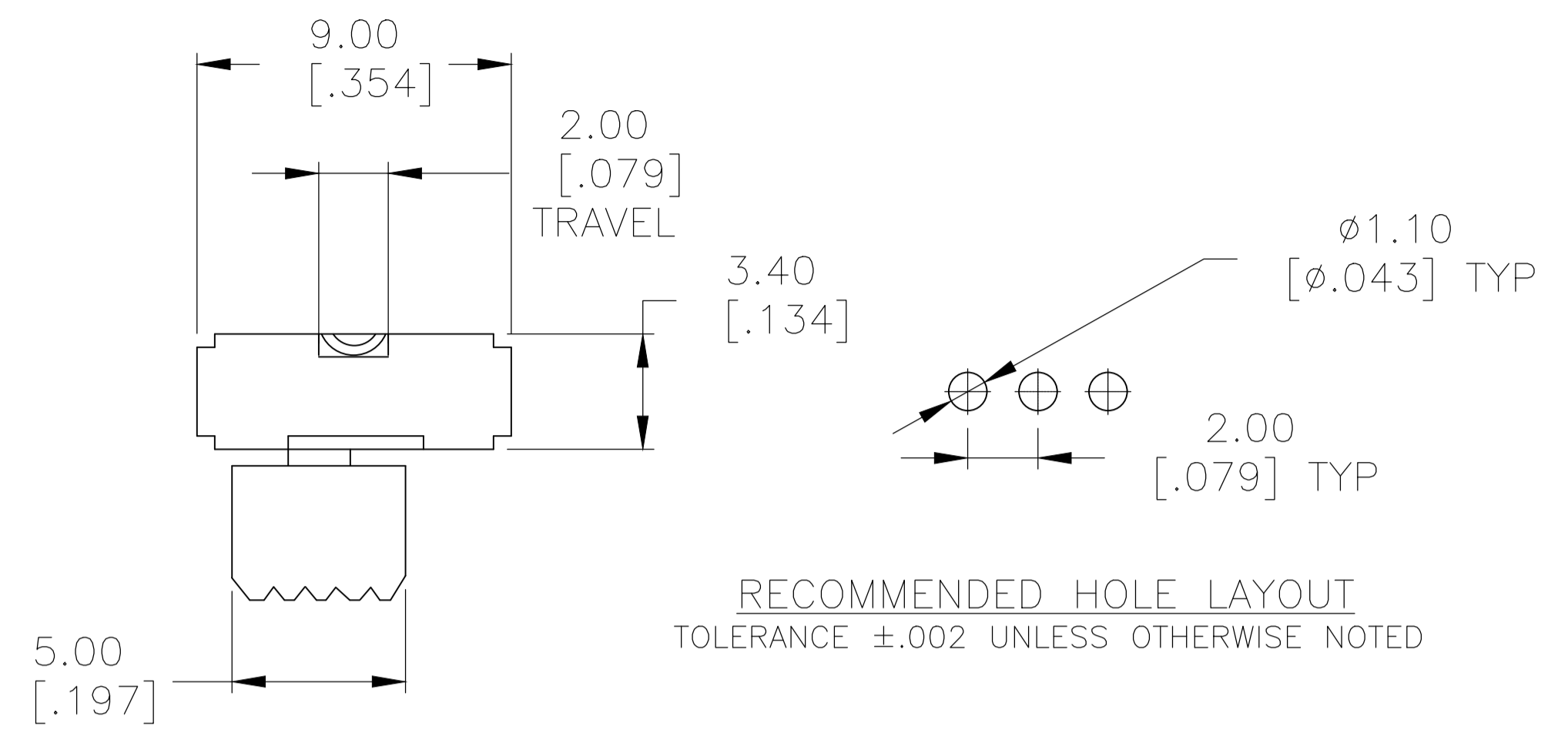

RECOMMENDED HOLE LAYOUT  
TOLERANCE ±.002 UNLESS OTHERWISE NOTED

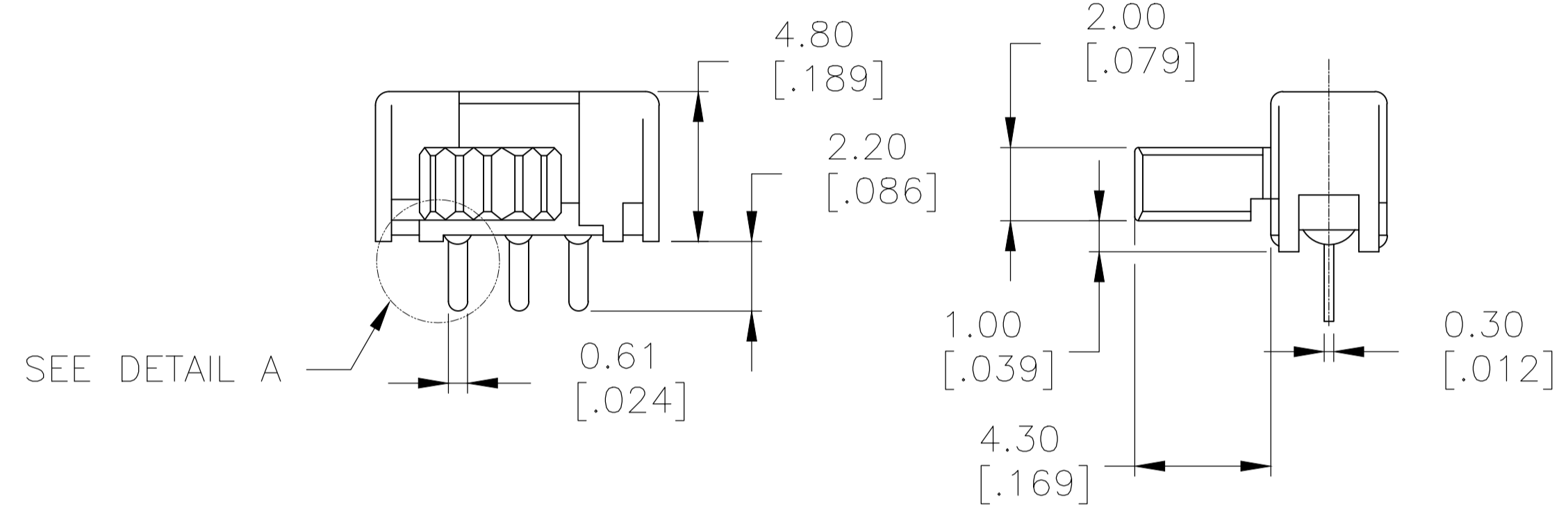

**SSB -12R**

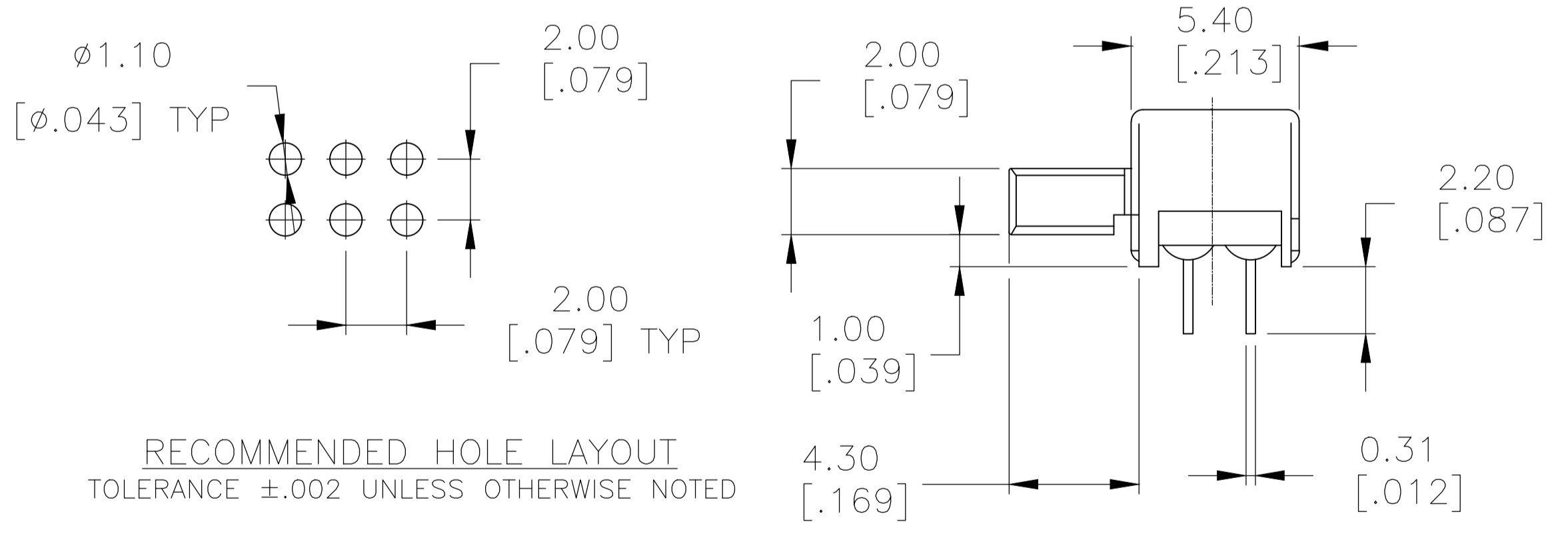

RECOMMENDED HOLE LAYOUT  
TOLERANCE ±.002 UNLESS OTHERWISE NOTED

**SSB -22R**

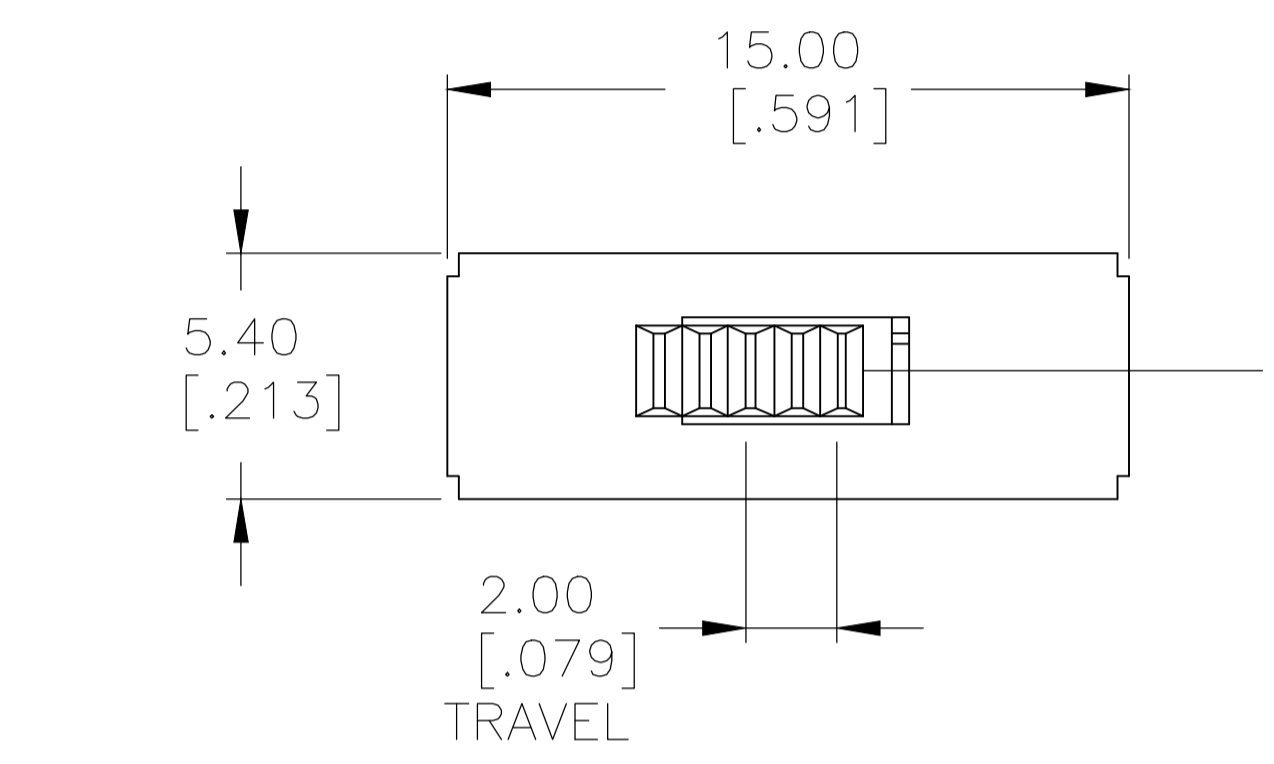

**SSB-42**

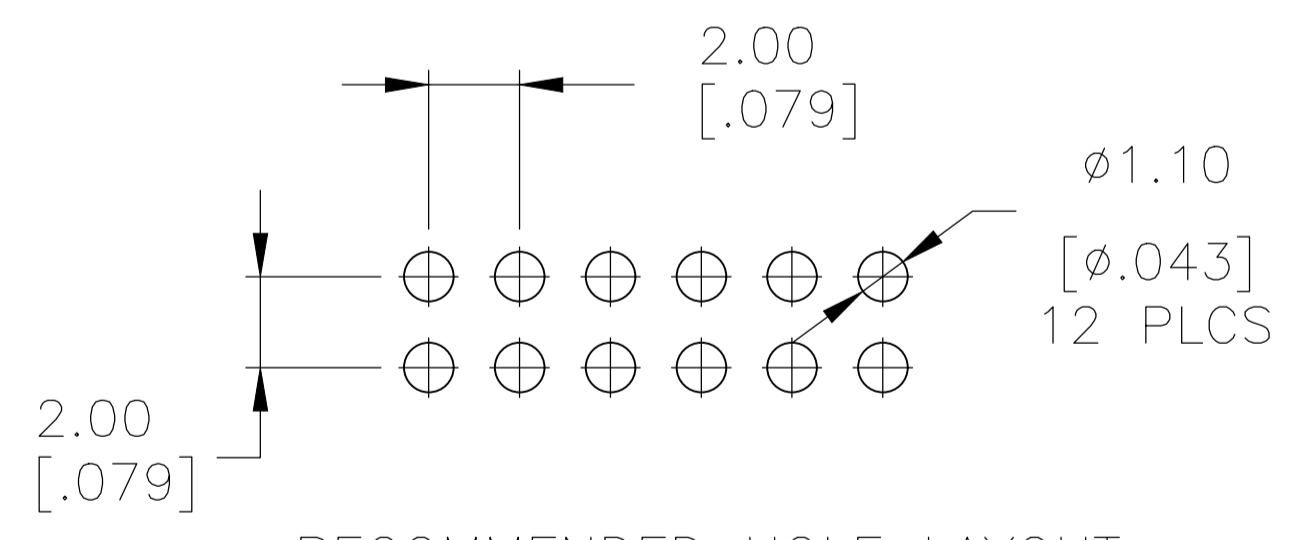
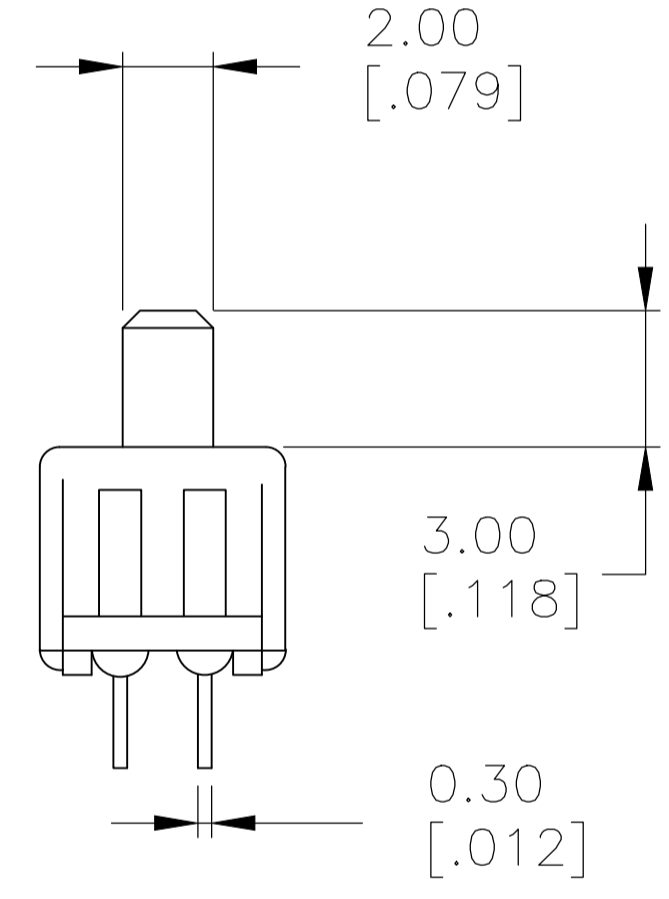
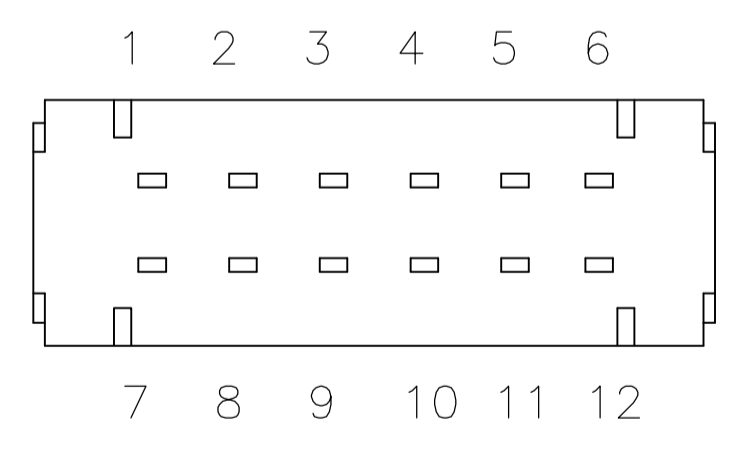
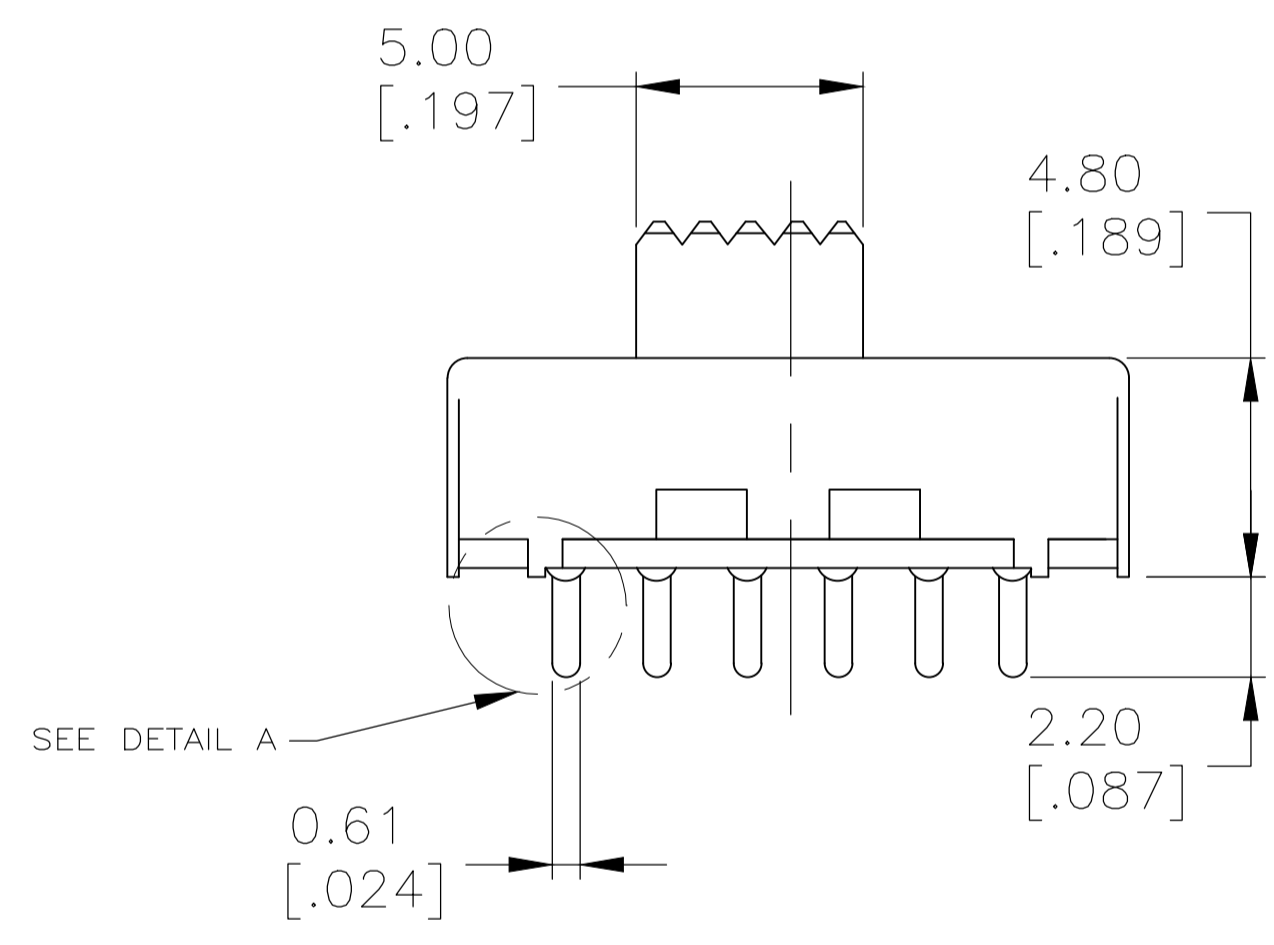

RECOMMENDED HOLE LAYOUT  
TOLERANCE ±.002 UNLESS OTHERWISE NOTED

|  |              |                  |                  |                                      |                     |
|--|--------------|------------------|------------------|--------------------------------------|---------------------|
| THIS DRAWING IS A CONTROLLED DOCUMENT. |              | DIN              | B.S.VISWESWARA   | 25SEP05                              | <br>TE Connectivity |
| DIMENSIONS: mm [INCHES]                |              | CHK              | -                | -                                    |                     |
| TOLERANCES UNLESS OTHERWISE SPECIFIED: |              | APVD             | -                | -                                    | NAME                |
| 0 PLC                                  | ± .01        | PRODUCT SPEC     |                  | SLIDE SWITCH, LOW PROFILE SSB SERIES |                     |
| 1 PLC                                  | ± .01        | APPLICATION SPEC |                  | -                                    |                     |
| 2 PLC                                  | ± 0.25[.010] | SIZE             | CAGE CODE        | DRAWING NO                           | RESTRICTED TO       |
| 3 PLC                                  | ± .01        | A1               | 00779            | 2-1437575-3                          | -                   |
| 4 PLC                                  | ± .01        | WEIGHT           | CUSTOMER DRAWING |                                      | -                   |
| ANGLES                                 | ± 1°         | SCALE            | 6:1              | SHEET                                | 2 OF 2              |
| MATERIAL                               | SEE ABOVE    | FINISH           | -                | REV                                  | D                   |