

LOC		DIST		REVISIONS			
AD	00	REV	DATE	BY	CHK	APP	
A1		REVISED PER ECO-05-012281	25MAY06	SSK	MS		
A2		REVISED PER ECO-09-024927	10NOV09	KK	AEG		

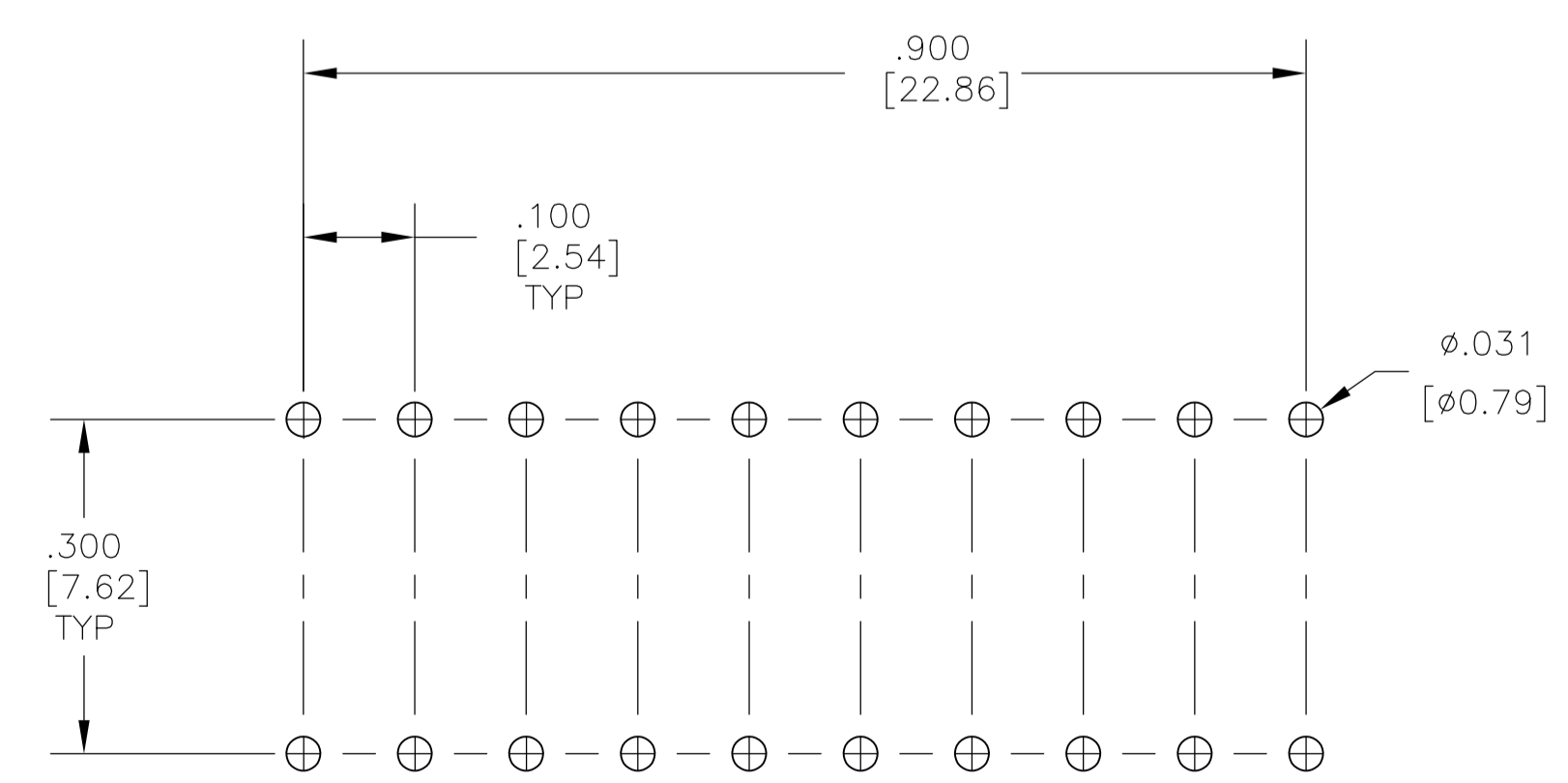
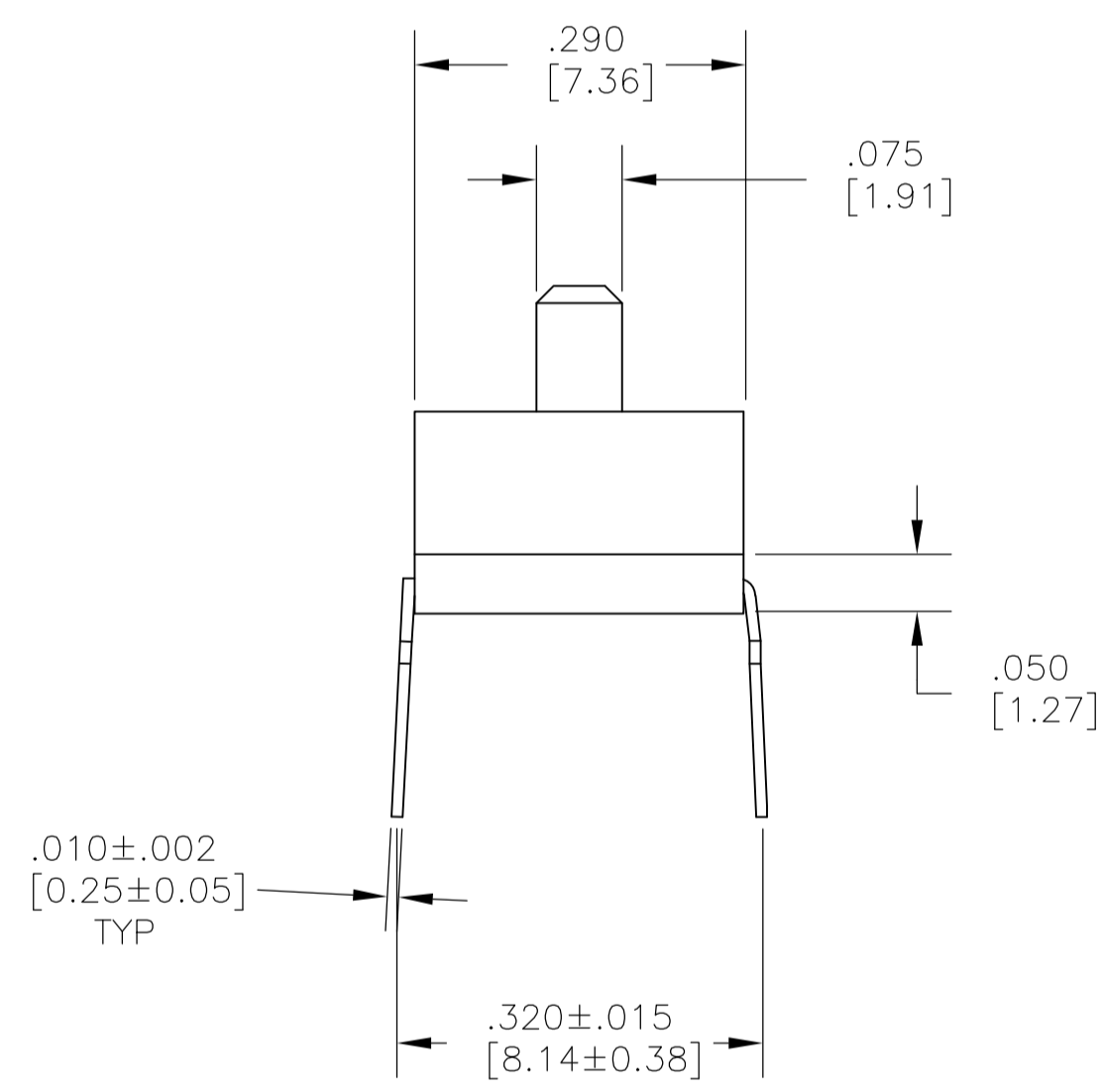
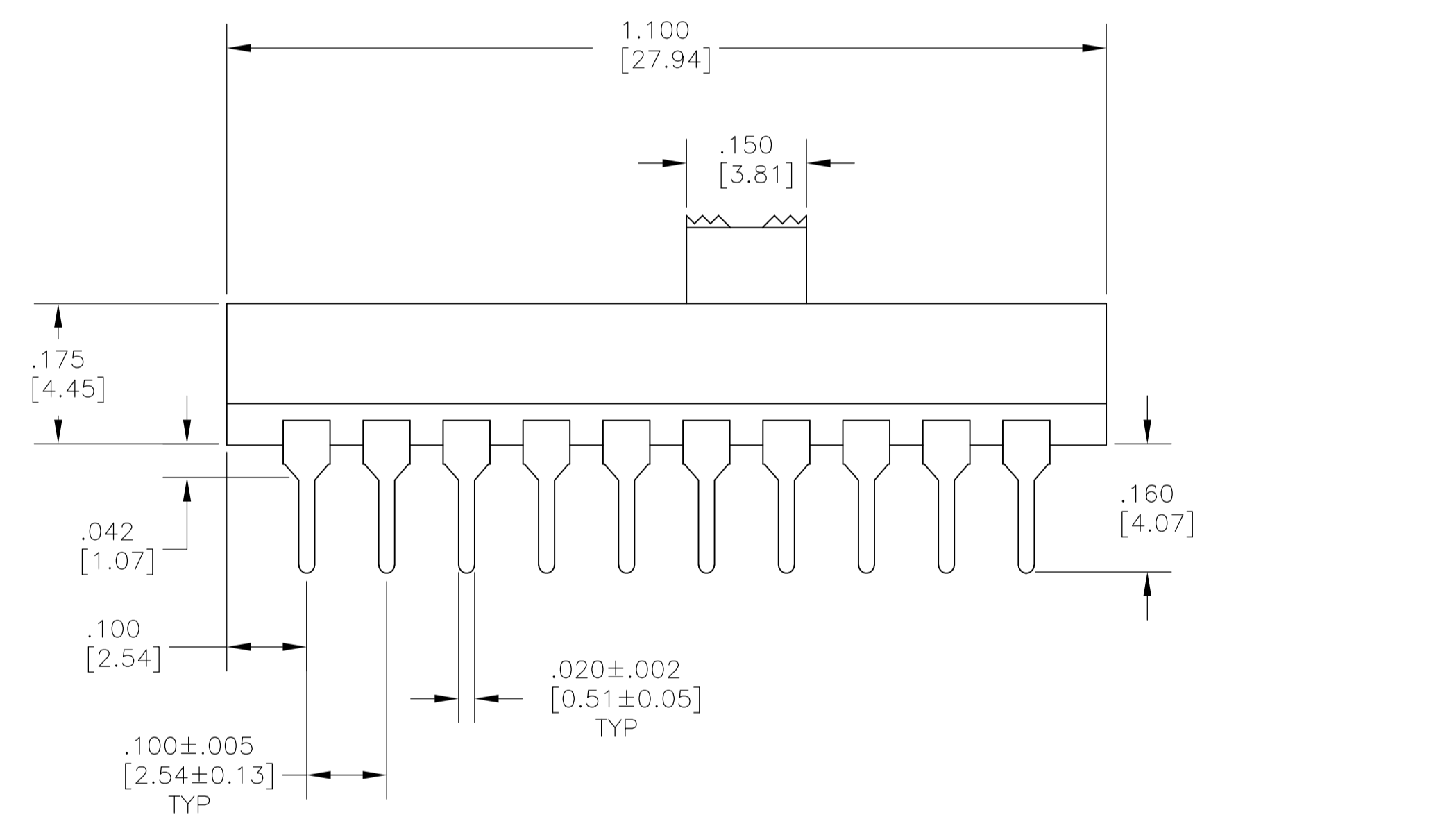
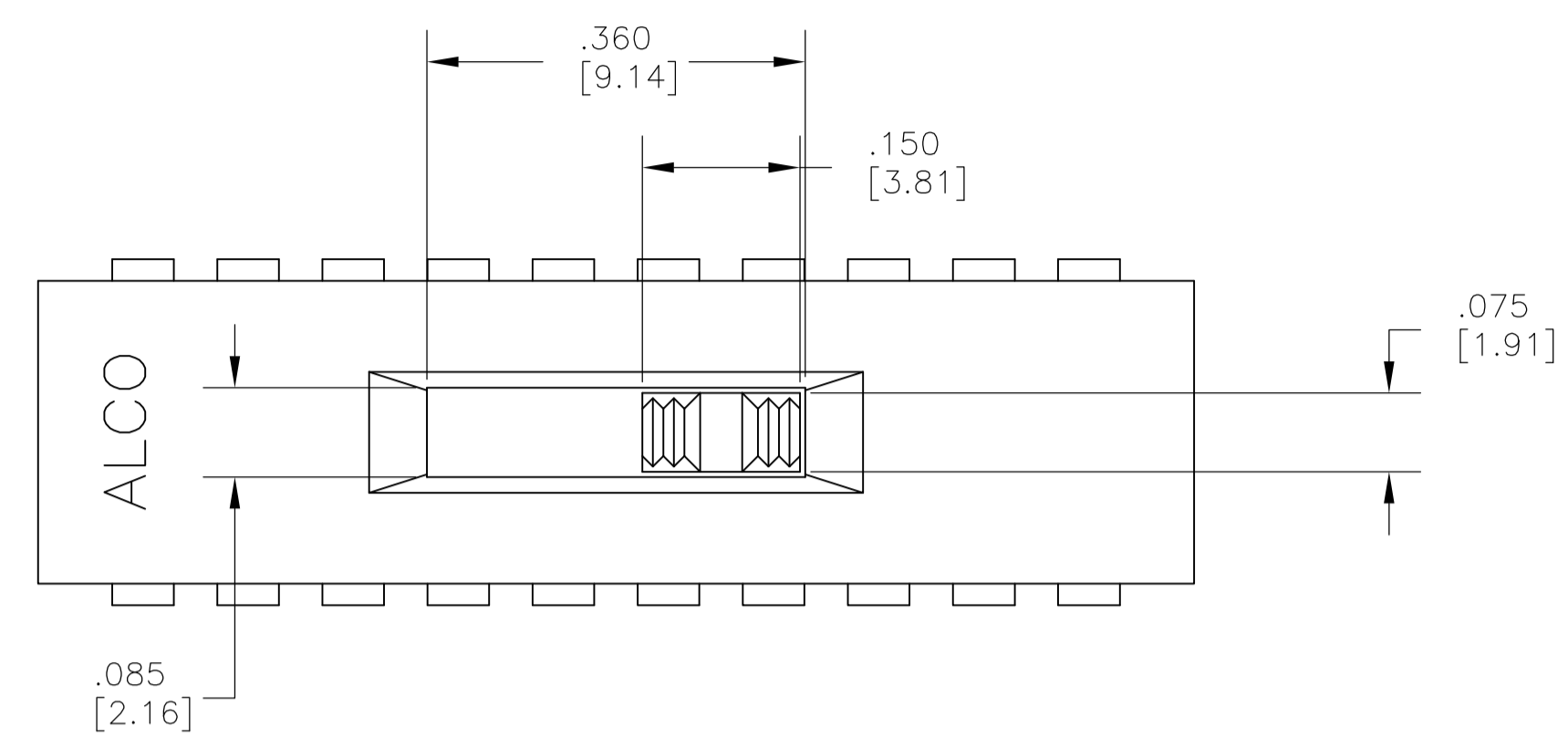

PRINTED CIRCUIT BOARD  
HOLE PATTERN

**SPECIFICATIONS:**

4P3T  
MAKE-BEFORE-BREAK

**MATERIALS:**

BASE/COVER-PCT UL94V-0, BLACK  
 ACTUATOR-NYLON PA46 UL94V-0, NATURAL  
 MOVING CONTACT-COPPER ALLOY, SILVER OVER NICKEL  
 FIXED CONTACT-COPPER ALLOY, SILVER OVER NICKEL  
 TERMINAL-COPPER ALLOY, TIN/LEAD OVER NICKEL OR TIN OVER NICKEL

**ELECTRICAL:**

CONTACT RATING, 30 MILLIAMPS @ 115V AC PER EIA-448, METHOD 6  
 CONTACT RESISTANCE, 25 MILLIOHMS MAX @ 100mA 2-4V DC, PER EIA-364-23B, EACH POSITION  
 INSULATION RESISTANCE, 1000 MEGOHM MIN @ 500V DC, PER EIA-364-21C EACH POSITION  
 DIELECTRIC STRENGTH, 600V RMS @ SEA LEVEL, PER EIA-364-20B, CONDITION 1, EACH POSITION  
 LIFE EXPECTANCY, ELECTRICAL, 15,000 CYCLES @ FULL LOAD

**MECHANICAL:**

ACTION FORCE, 800 GRAMS MAX.  
 ACTION TRAVEL, .100 ± .010  
 LIFE EXPECTANCY, 15,000 CYCLES

**ENVIRONMENTAL:**

OPERATING TEMPERATURE, -40° TO +80°C, PER EIA 448, METHOD 10  
 STORAGE TEMPERATURE, -40° TO +80°C  
 HUMIDITY AND TEMPERATURE CYCLING PER EIA-364-31B, METHOD III  
 SOLDERABILITY, PER EIA-364-52, CLASS 2, CATEGORY 1, 95% MINIMUM COVERAGE  
 RESISTANCE TO SOLDER HEAT, PER 109-202, CONDITION B

**NOTES:**

- SWITCH TO BE SUPPLIED WITH CLOSED END COVERS
  - PACKAGING LABEL TO BE ASE71016/61-0176
  - PARTS TO BE PACKAGED IN TUBES WITH 19 SWITCHES PER TUBE
  - CUSTOMER-TELLABS
  - ALL MATERIALS AND FINISHES SHALL COMPLY WITH EU DIRECTIVE 2002/95/EC OF 27JAN2003 (ROHS)
- ⚠️ OBSOLETE PARTS: OBSOLETE CIS STREAMLINING PER D.RENAUD/D.SINISI

5	ASE7101604	1825463-1
6	SUPERSEDED	ASE71016 4-1437581-2
NOTES	T&B P/N	TYCO P/N

THIS DRAWING IS A CONTROLLED DOCUMENT.

DIMENSIONS: INCHES [mm]	TOLERANCES UNLESS OTHERWISE SPECIFIED:	DIN 15FEB05	15FEB05
0 PLC ± -	1 PLC ± -	2 PLC ± -	3 PLC ± .010
4 PLC ± ± 1°	ANGLES ± ± 1°		

MATERIAL	FINISH	WEIGHT	SIZE	CAGE CODE	DRAWING NO	RESTRICTED TO
-	-	-	A1	00779	4-1437581-2	-

CUSTOMER DRAWING SCALE 6:1 SHEET 1 OF 1 REV A2