

THIS DRAWING IS UNPUBLISHED. RELEASED FOR PUBLICATION 20
 © COPYRIGHT 20 BY TYCO ELECTRONICS CORPORATION. ALL RIGHTS RESERVED.

LOC		DIST		REVISIONS			
P	LTR	DESCRIPTION	DATE	DWN	APVD		
	A	ECR-08-009407	14/04/08	MJG	JA		
	B	ECR-08-019535	04/08/08	MJG	JA		

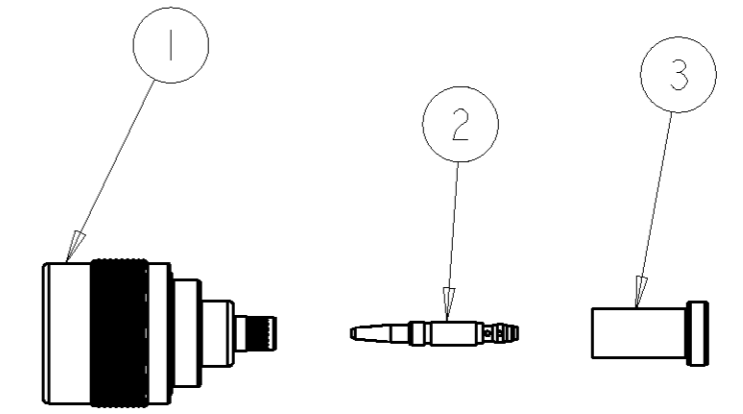
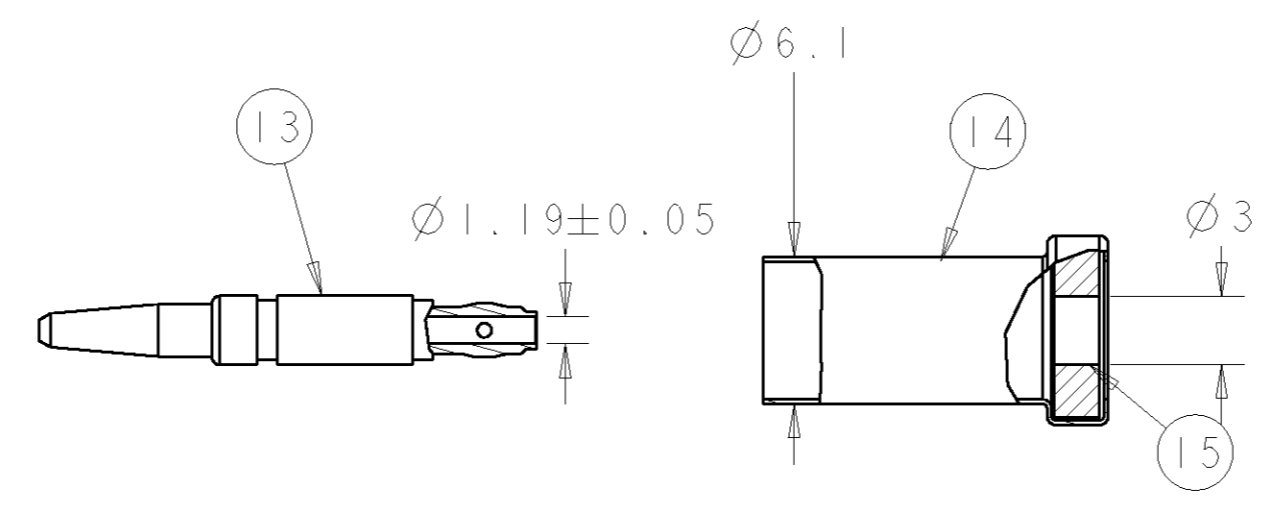
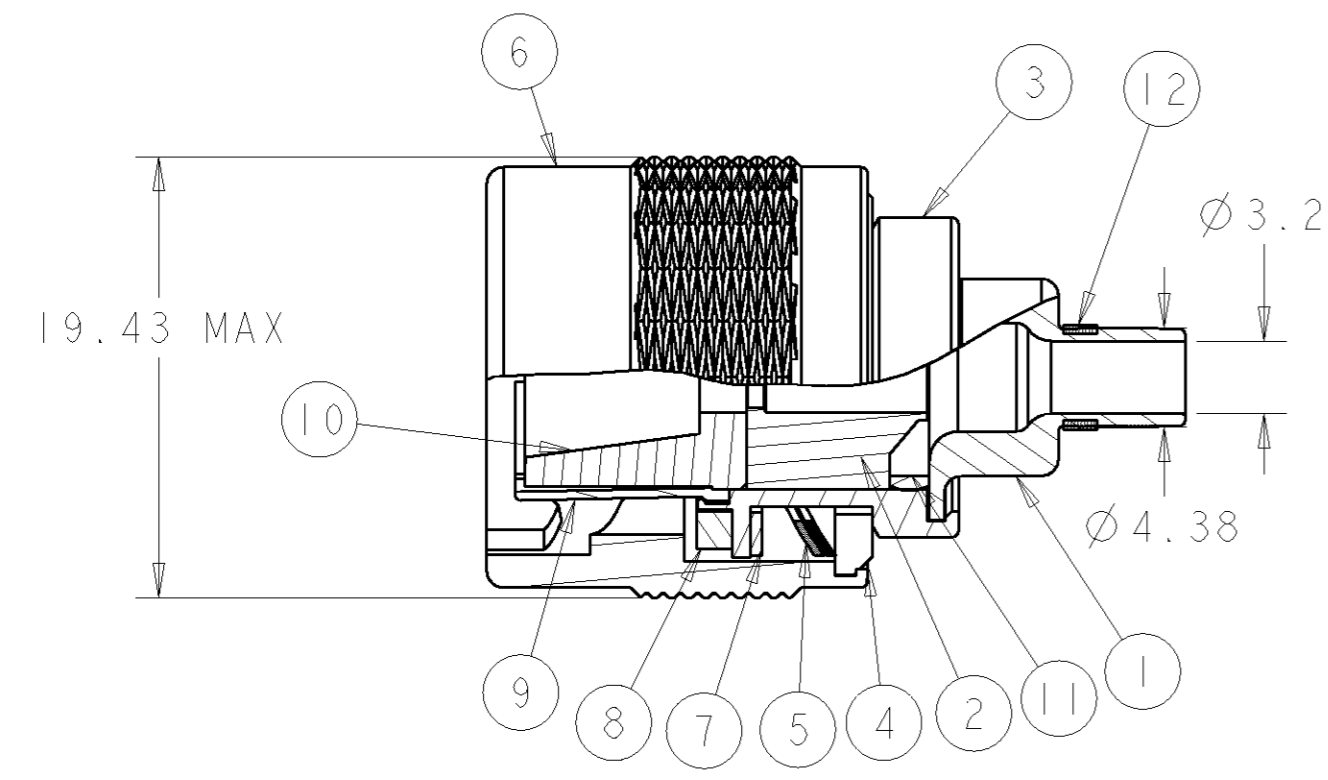

NOTES:

- ① ELECTROPLATE SILVER OVER COPPER (TARNISH RESISTANT)
- ② ELECTROPLATE SILVER
- ③ ELECTROPLATE GOLD OVER NICKEL
- ④ ELECTROPLATE NICKEL
- 5. FOR USE ON CABLE FILECA F1703/4
- 6. CRIMP WITH HAND TOOL 220045-2
- 7. PRODUCT WEIGHT APPROX 28g

QTY	FINISH	MATERIAL	DESCRIPTION	ITEM	DESCRIPTION	COMPONENT		
1	NONE	SILICONE RUBBER	SEAL	15	PLUG ASSEMBLY SERIES C	1		
1	①	BRASS	FERRULE	14			FERRULE ASSY	3
1	③	BeCu	CONTACT	13			CONTACT	2
1	NONE	SILICONE RUBBER	SEAL	12				
1	①	BRASS	BUSHING	11				
1	NONE	PTFE	DIELECTRIC	10				
1	①	BeCu	OUTER CONTACT	9				
1	NONE	SILICONE RUBBER	GASKET	8				
1	NONE	PTFE	SPLIT WASHER	7				
1	①	BRASS	COUPLING NUT	6				
2	①	BeCu	SPRING WASHER	5				
2	④	BRASS	HALF WASHER	4				
1	①	BRASS	BODY	3				
1	NONE	PTFE	DIELECTRIC	2				
1	①	BRASS	INNER FERRULE	1				

THIS DRAWING IS A CONTROLLED DOCUMENT FOR TYCO ELECTRONICS CORPORATION. IT IS SUBJECT TO CHANGE AND THE CONTROLLING ENGINEERING ORGANIZATION SHOULD BE CONTACTED FOR THE LATEST REVISION.

DWN: M. GREENER 24/09/07
 CHK: J. AMBROSE 24/09/07
 APVD: J. AMBROSE 24/09/07

Tyco Electronics Tyco Electronics UK Ltd. Bideford, North Devon, EX39 4HE

NAME: C SERIES PLUG CRIMP 50 OHMN FILECA 1703/4

SIZE: A2 CAGE CODE: 200779 DRAWING NO: 108-12005 RESTRICTED TO: -
 WEIGHT: - SCALE: 1:1 SHEET 1 OF 2 REV B



MATERIAL: SEE TABLE
 DIMENSIONS: mm
 TOLERANCES UNLESS OTHERWISE SPECIFIED:
 0 PLC ±0.4
 1 PLC ±0.4
 2 PLC ±0.4
 3 PLC ±0.4
 4 PLC ±
 ANGLES ±2

CUSTOMER DRAWING

THIS DRAWING IS UNPUBLISHED. RELEASED FOR PUBLICATION 20
 © COPYRIGHT 20 BY TYCO ELECTRONICS CORPORATION. ALL RIGHTS RESERVED.

LOC	DIST	REVISIONS					
B	E	P	LTR	DESCRIPTION	DATE	DWN	APVD
		-		SEE SHEET 1			

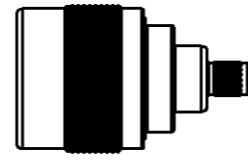
COMPONENTS

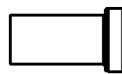
	MAIN BODY	CONTACT	FERRULE
			

FOR CABLE SEE FRONT SHEET

STEP 1:

1. SLIDE FERRULE OVER CABLE

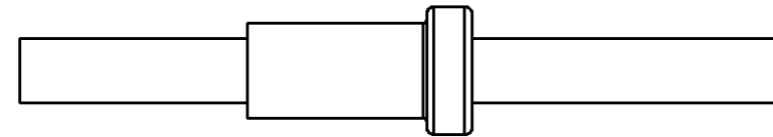

STEP 4:

1. PRESS CABLE SUB ASSEMBLY INTO BODY UNTIL CONTACT IS FULLY LOCATED ON DIELECTRIC
2. ENSURE THE KNURLED FERRULE INSERTS BETWEEN THE DIELECTRIC AND CABLE BRAID

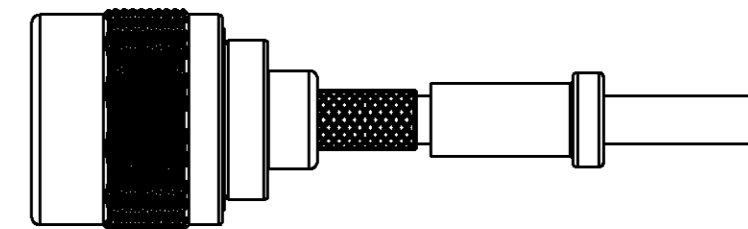

STEP 2:

1. STRIP CABLE TO DIMENSIONS SHOWN
2. OPTIONAL TINNING OF CONTACT HERE REQUIRED

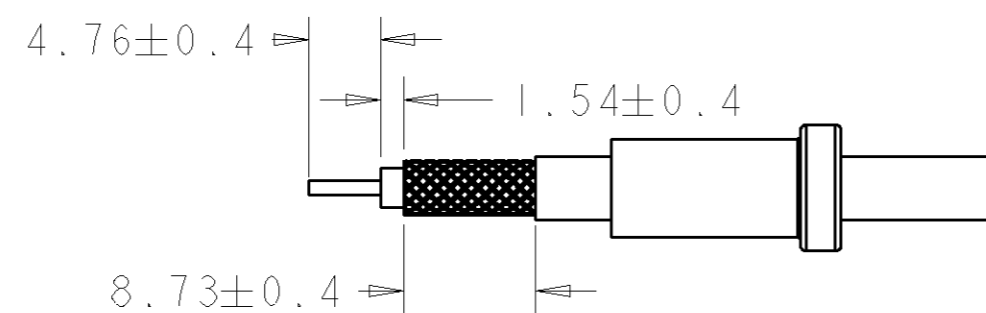

STEP 5:

1. SLIDE CRIMP FERRULE UNTIL IT BUTTS AGAINST THE HOUSING BODY
2. CRIMP USING TOOL 220045-2

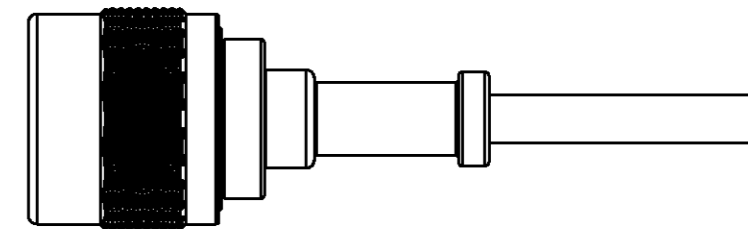

STEP 3:

1. FIT CONTACT OVER CENTRE CONDUCTOR TO BUTT AGAINST DIELECTRIC
2. SOLDER CONTACT TO CONDUCTOR

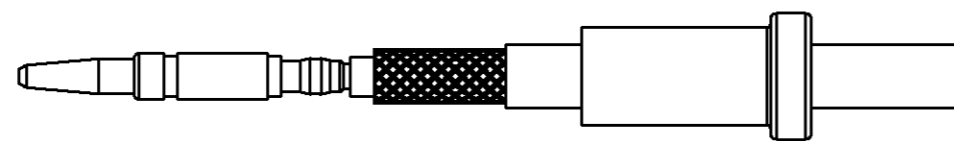

<small>THIS DRAWING IS A CONTROLLED DOCUMENT FOR TYCO ELECTRONICS CORPORATION IT IS SUBJECT TO CHANGE AND THE CONTROLLING ENGINEERING ORGANIZATION SHOULD BE CONTACTED FOR THE LATEST REVISION.</small>		DWN M.GREENER 24/09/07 CHK J.AMBROSE 24/09/07 APVD J.AMBROSE 24/09/07	Tyco Electronics UK Ltd. Bideford, North Devon, EX39 4HE
DIMENSIONS: mm	TOLERANCES UNLESS OTHERWISE SPECIFIED: 0 PLC ±0.5 1 PLC ±0.5 2 PLC ±0.5 3 PLC ±0.5 4 PLC ± ANGLES ±0.5 FINISH	PRODUCT SPEC 108-12005 APPLICATION SPEC - WEIGHT - CUSTOMER DRAWING	NAME C SERIES PLUG CRIMP 50 OHM FILECA 1703/4 SIZE A200779 CAGE CODE G-134289 DRAWING NO 134289 RESTRICTED TO -
SEE TABLE		SCALE 1:1 SHEET 2 OF 2 REV B	