

LOC		DIST		REVISIONS			
CM	00	REV	DATE	DESCRIPTION	DATE	BY	APPV
C		REVISED PER	ECO-12-007810		28JUL12	KH	SM

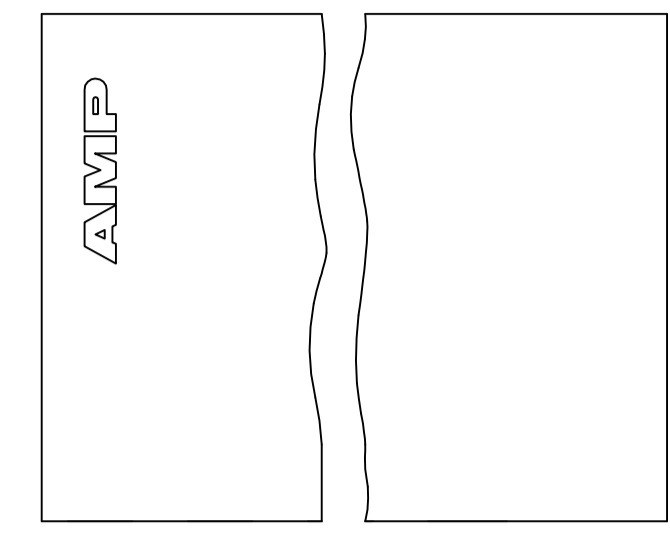

- 1 UNIT ACCEPTS 1.14 [.045] SQUARE OR ROUND POST.
- 2 UNIT ACCEPTS STANDARD SL-156 CONTACTS.
- 3 UNIT ACCEPTS KEYING PLUG 640254-1 AND KEYING PIN 640255-1.
- 4 CIRCUIT I.D. NUMBER(S), TO BE LOCATED SEQUENTIALLY AS SHOWN.
- 5 DIMENSIONS IN BRACKETS ARE IN INCHES.
- 6 ACCEPTS UP TO .110 INCH INSULATION WIRE.
- 7 OBSOLETE PARTS: OBSOLETE CIS STREAMLINING PER D.RENAUD/D.SINISI

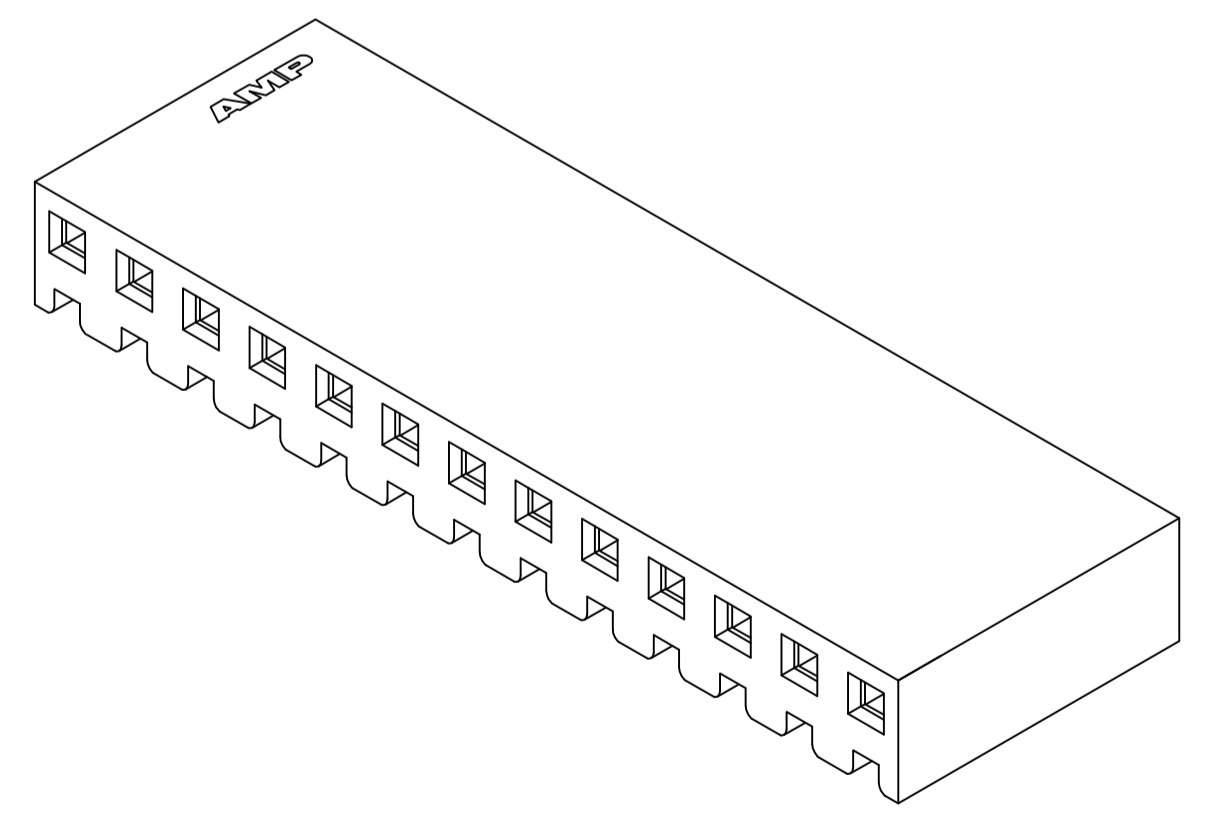
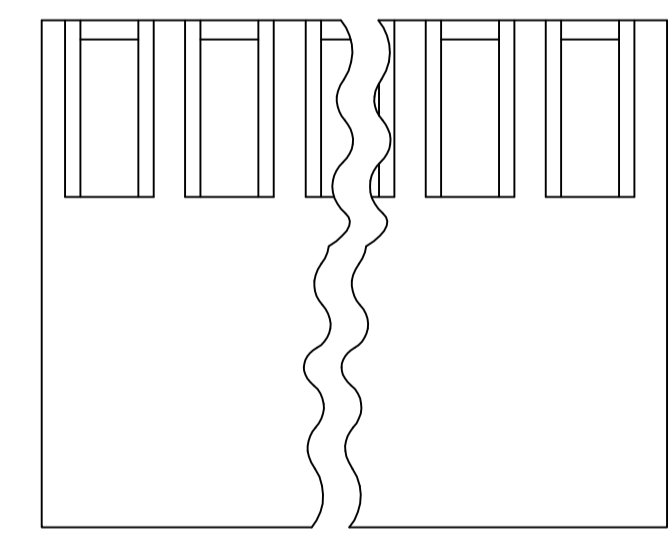
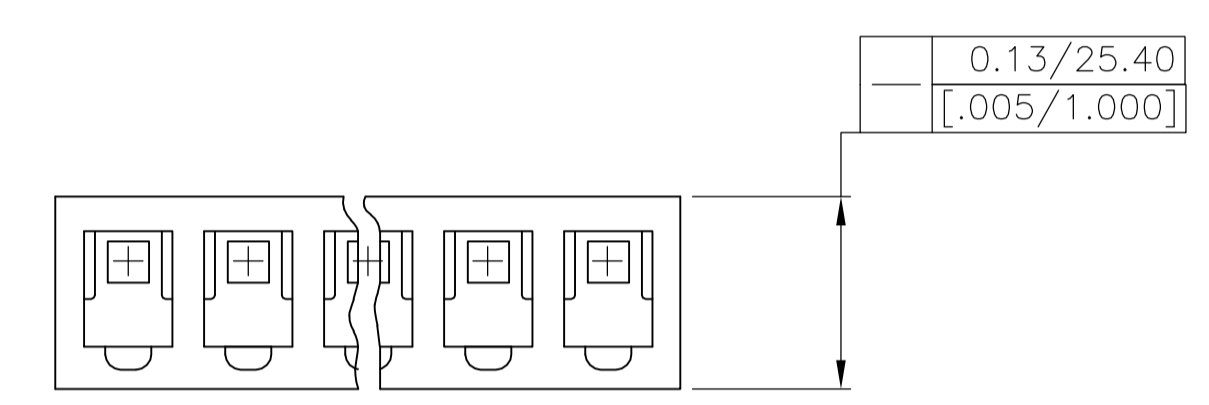
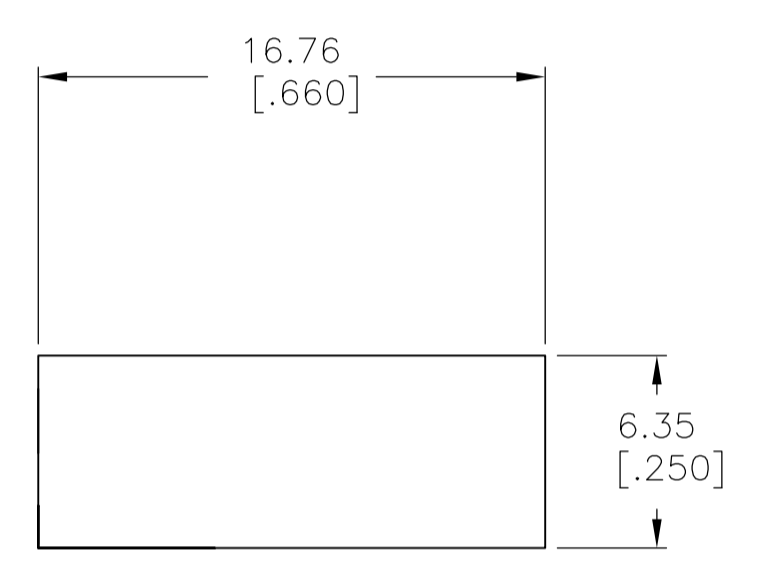
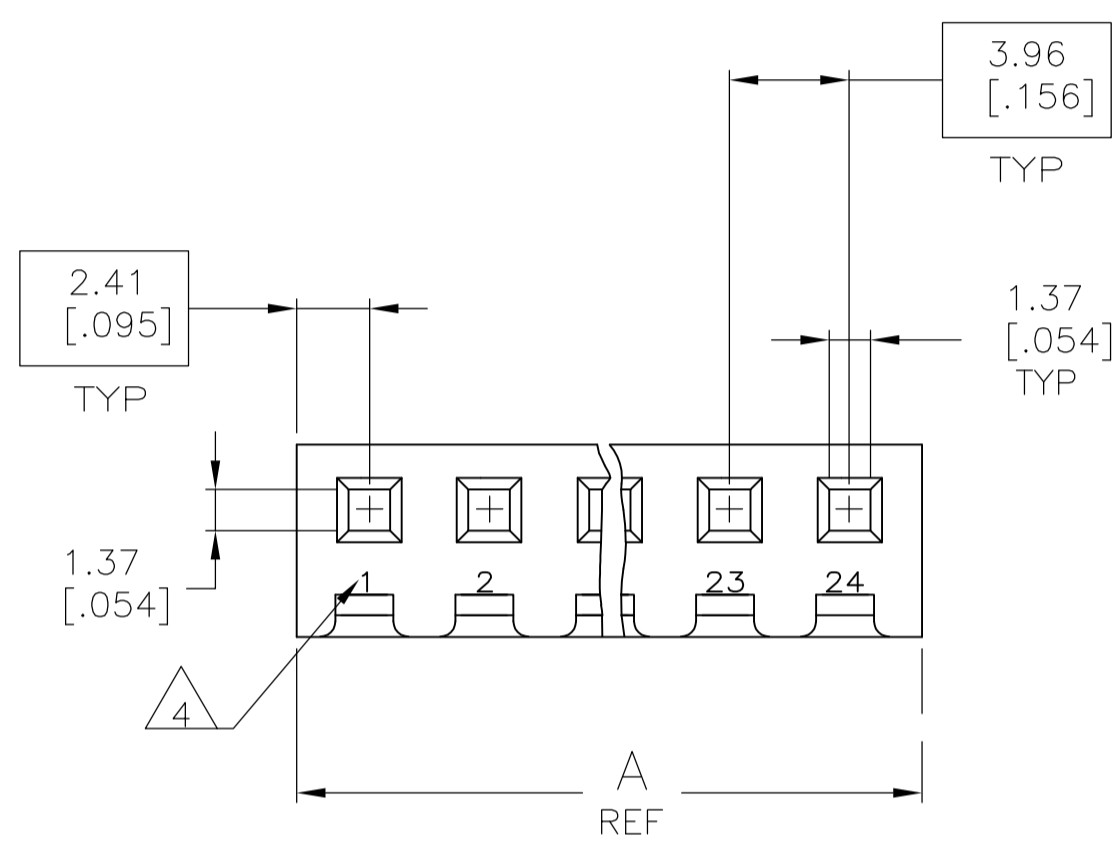

3-DIMENSIONAL MODEL NTS

DIM A	NO. OF CIRCUITS	PART NO.
△ OBSOLETE	95.96 [3.778]	24 2-647400-4
△ OBSOLETE	92.00 [3.622]	23 2-647400-3
	88.04 [3.466]	22 2-647400-2
△ OBSOLETE	84.07 [3.310]	21 2-647400-1
△ OBSOLETE	80.11 [3.154]	20 2-647400-0
△ OBSOLETE	76.15 [2.998]	19 1-647400-9
△ OBSOLETE	72.19 [2.842]	18 1-647400-8
△ OBSOLETE	68.22 [2.686]	17 1-647400-7
△ OBSOLETE	64.26 [2.530]	16 1-647400-6
△ OBSOLETE	60.30 [2.374]	15 1-647400-5
	56.34 [2.218]	14 1-647400-4
△ OBSOLETE	52.37 [2.062]	13 1-647400-3
△ OBSOLETE	48.41 [1.906]	12 1-647400-2
△ OBSOLETE	44.45 [1.750]	11 1-647400-1
	40.49 [1.594]	10 1-647400-0
△ OBSOLETE	36.53 [1.438]	9 647400-9
△ OBSOLETE	32.56 [1.282]	8 647400-8
△ OBSOLETE	28.60 [1.126]	7 647400-7
△ OBSOLETE	24.64 [.970]	6 647400-6
△ OBSOLETE	20.68 [.814]	5 647400-5
△ OBSOLETE	16.71 [.658]	4 647400-4
△ OBSOLETE	12.75 [.502]	3 647400-3
△ OBSOLETE	8.79 [.346]	2 647400-2
△ OBSOLETE	4.83 [.190]	1 647400-1

THIS DRAWING IS A CONTROLLED DOCUMENT.

DIMENSIONS: mm [INCHES]	TOLERANCES UNLESS OTHERWISE SPECIFIED:	DIN L. McEACHIN 28MAR00	APVD J. ELLIS 28MAR00	NAME	STE TE Connectivity
0 PLC ± -	1 PLC ± -	2 PLC ± -	3 PLC ± 0.13 [.005]	4 PLC ± -	ANGLES ± 0° 30'
MATERIAL NYLON,UL94V-0,NAT	FINISH -	APVD J. ELLIS 28MAR00	NAME	HOUSING, SL-156, FOR LARGE WIRE INSULATION	RESTRICTED TO
WEIGHT -	SIZE A1	CAGE CODE 00779	DRAWING NO. 647400	SCALE 4:1	SHEET 1 OF 1
CUSTOMER DRAWING	REV C				