

TECHNICAL SPECIFICATIONS

D-Sub Hood:

Material: Zinc, Nickel Plated
 Operating Temperature: -25°C to +90°C
 Cable Entry: 90° Side Entry
 Jackscrews: UNC 4-40, M3 on request
 Cable O.D:
 9-way: Up to 8,1mm
 15-way: Up to 8,1mm
 25-way: Up to 11,4mm
 37-way: Up to 16,5mm
 50-way: Up to 16,5mm
 Type of grommets: Compression Inserts

Female D-Sub Solder Cup:

Insulator: PBT, Black, UL94 V-0
 Shell: Steel, Tin Plated
 Contact pins: Copper Alloy
 Stamped & Formed Pins: Class 3, 100 inserts min.
 Machined Contact Pins: Class 1, 500 inserts min.
 Contact Plating: Selective Gold over Nickel
 Operating Temperature: -55°C to +105°C
 Withstanding voltage: 1000V for 1 minute
 Insulator resistance: 1000MΩ min.

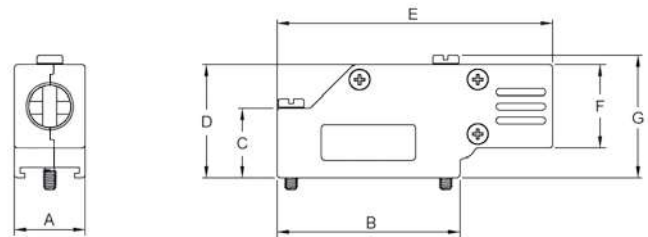

Features:

- Available in sizes 9-15-25
 Other sizes on request
- Suitable for any common Sub-D connector
- Re-Openable

Size	A	B	C	D	E	F	G
9	15,0	31,0	15,0	24,4	50,8	18,0	26,5
15	15,3	39,2	15,0	24,0	59,0	18,0	26,5
25	16,0	54,0	23,0	34,5	73,0	24,5	37,0

Ordering information - Black Insulator:

Size:	P/N - Kitted:	Class 3 - 100 inserts min.
9-way	6355-0099-11	DCMR09-ULP-DBS-K
15-way	6355-0099-12	DCMR15-ULP-DBS-K
25-way	6355-0099-13	DCMR25-ULP-DBS-K

Size:	P/N - Kitted:	Class 1 - 500 inserts min.
9-way	6355-0099-31	DCMR09-ULP-DMS-K
15-way	6355-0099-32	DCMR15-ULP-DMS-K
25-way	6355-0099-33	DCMR25-ULP-DMS-K

Ordering information - White Insulator:

Size:	P/N - Kitted:	Class 3 - 100 inserts min.
9-way	6355-8099-11	DCMR09-ULP-DBS-W-K
15-way	6355-8099-12	DCMR15-ULP-DBS-W-K
25-way	6355-8099-13	DCMR25-ULP-DBS-W-K

Size:	P/N - Kitted:	Class 1 - 500 inserts min.
9-way	6355-8099-31	DCMR09-ULP-DMS-W-K
15-way	6355-8099-32	DCMR15-ULP-DMS-W-K
25-way	6355-8099-33	DCMR25-ULP-DMS-W-K

