

QUARTER TURN KNOB LOCK (PLASTIC)



*Example with cam. Cam sold separately.

Specifications

- Material:
 - Housing: Polyamide DIN-EN ISO 1043-1 PA6 GFR 30
 - Driver: Zinc Alloy (Zamak) or PA6 GFR 30
 - Cam: Steel or Plastic

Features

- Clip install for easy assembly
- Mounting nut not required
- Special 20 mm x 26 mm cut out
- There is no IP 65 version of this lock
- Can be used for panel thickness 0.8 mm to 1.8 mm
- Applications: Electric panels, machinery covers

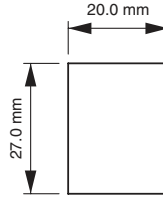
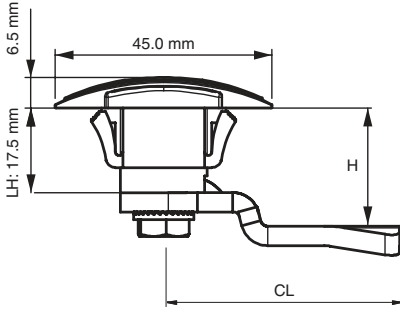

Cut Out

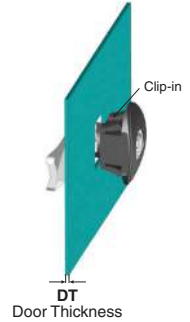
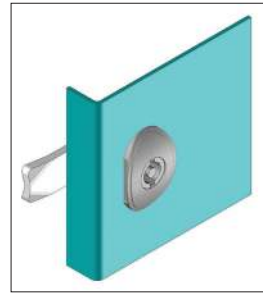

Driver/Head Style

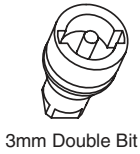

3mm Double Bit

Item Number	Driver	Cam
Nylon / Black		
060111300	3mm Double Bit	Select Cam Below

Item Number	Driver / Head Style	Cam
Zinc Alloy / Nylon		
2612000700	Locking	Select Cam Below
26120201300	3mm Double Bit	Select Cam Below

Steel Cam

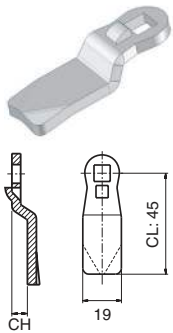

Material: Steel
Finish: Zinc plated
Thickness: 4 mm

Item Number	CH (mm)	CL (mm)	H (mm)
30403033	0	45	17.5
30403439	1	45	18.5
30403159	2	45	19.5
30403063	3	45	20.5
30403149	4	45	21.5
30403160	6	45	23.5
30403161	8	45	25.5
30403162	10	45	27.5
30403045	12	45	29.5
30403163	14	45	31.5
30403151	16	45	33.5
30403165	18	45	35.5
30403166	20	45	37.5

Item Number	CH (mm)	CL (mm)	H (mm)
30403167	22	45	39.5
30403168	24	45	41.5
30403169	-2	45	15.5
30403170	-4	45	13.5
30403171	-6	45	11.5
30403172	-8	45	9.5
30403173	-10	45	7.5
30403174	-12	45	5.5
30403175	-14	45	3.5
30402005	6	35	-
30402008	4	45	-
30402013	-4	45	-

Nylon Cam

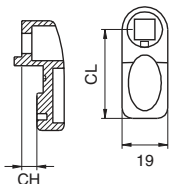

Item Number	CH (mm)	CL (mm)	H (mm)
30402004	0	35	17.5
30402011	0	25	17.5
30402005	6	35	23.5
30402008	4	45	21.5
30402013	-4	45	13.5