

NOTES:

- 1) PACKAGING MATERIALS: EMBOSSED CARRIER TAPE IS POLYSTYRENE (PS), TOP COVER TAPE IS A COMPOSITE OF POLYETHYLENE TEREPHTHALATE (PET), POLYETHYLENE (PE), AND POLYFILM (PEF), CARRIER REEL IS POLYSTYRENE (PS).
- 2) EACH REEL MUST BE LOADED WITH 300 CONNECTORS (SEE NOTE 4).
- 3) THE FOLLOWING NOTES HAVE BEEN DERIVED FROM THE E.I.A. STANDARDS 481.
- 4) CONNECTOR MINIMUMS/REEL ARE SHOWN ABOVE; IN NO CASE SHALL THERE BE TWO CONSECUTIVE COMPONENTS MISSING BETWEEN THE FIRST AND LAST PART OF ANY REEL.
- 5) THE TOP COVER TAPE SHALL BE CLEAR ONLY, NOT EXTEND OVER THE EDGES OF THE CARRIER TAPE OR COVER ANY PART OF THE SPROCKET HOLES.
- 6) ADJACENT LAYERS OF TAPE SHALL NOT STICK TOGETHER WHEN WOUND ON THE CARRIER REEL.
- 7) THE TOP COVER TAPE MUST BE SECURELY ATTACHED TO THE EMBOSSED CARRIER TAPE BY USE OF HEAT.
- 8) EACH REEL SHALL HAVE A LABEL AFFIXED TO IT WITH THE FOLLOWING INFORMATION: PART NO. (CUSTOMER PART NO.), QUANTITY, AND DATE CODE.
- 9) TAPE SPLICES ARE NOT PERMITTED.
- 10) THE TOP COVER TAPE SHALL HAVE A TOTAL PEEL STRENGTH OF 0.1-0.7 NEWTONS WHEN PULLED OPPOSITE THE DIRECTION OF CARRIER TAPE TRAVEL. THE CARRIER AND/OR COVER TAPE SHALL BE PULLED WITH A VELOCITY OF APPROX. 120 mm/MINUTE.
- 11) ALL DIMENSIONS ARE SHOWN FOR REFERENCE ONLY.

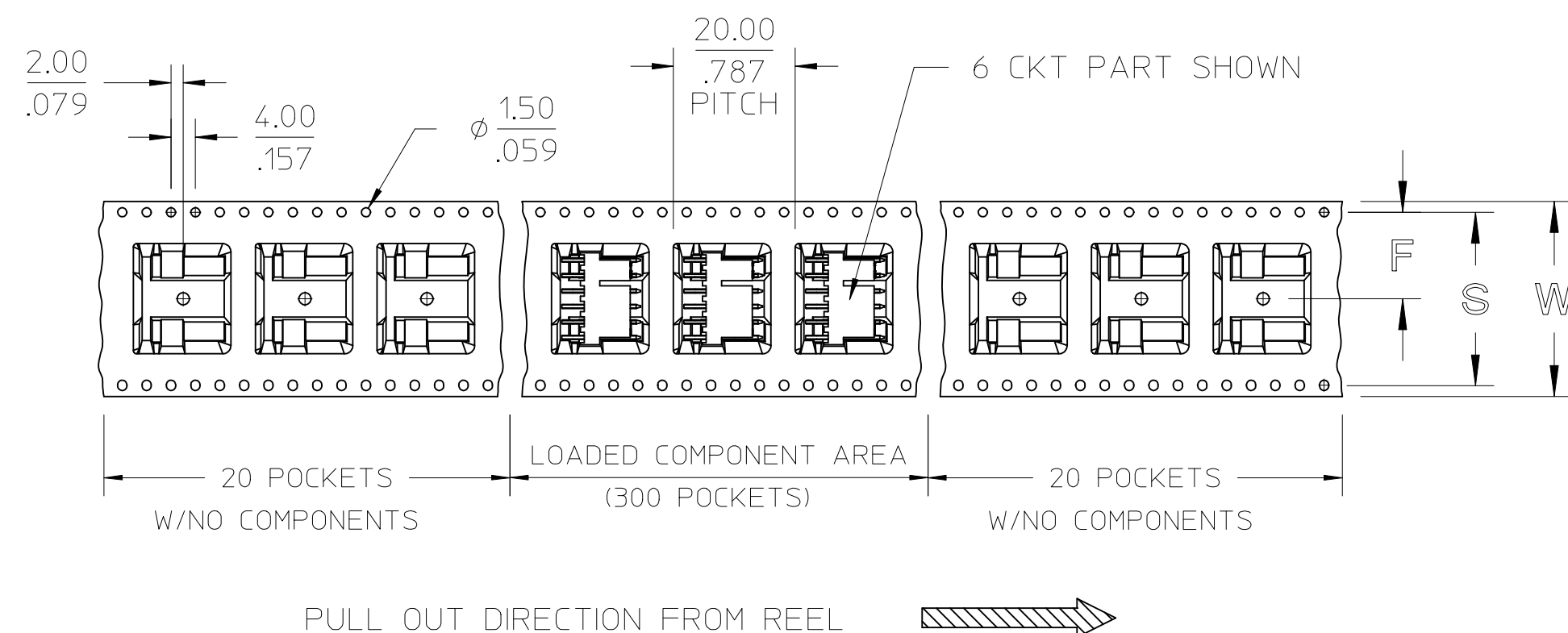

COVER TAPE 24MM EC NO: UCP2015-2680 DRWN:MKIPPER 2015/01/06 CHKD:NGUYEN 2015/01/13 APPR:FSMITH 2015/01/15	DESCRIPTION	QUALITY SYMBOLS	GENERAL TOLERANCES (UNLESS SPECIFIED)		DIMENSION STYLE MM/IN		SCALE ---	DESIGN UNITS METRIC	THIRD ANGLE PROJECTION		
		▽=0	4 PLACES	mm	INCH	DRAWN BY	DATE	TITLE KK 254 RPC TAPE & REEL PK SPEC. FOR RIGHT ANGLE HEADER ASS'Y			
		▽=0	3 PLACES	± ---	± ---	MKIPPER	2014/02/21				
		▽=3	2 PLACES	± ---	± ---	CHECKED BY	DATE	DOCUMENT NO. PK-171857-0001			
			1 PLACE	± ---	± ---	JBELL	2014/02/24	SHEET NO. 1 OF 3			
			0 PLACE	± ---	± ---	APPROVED BY	DATE	THIS DRAWING CONTAINS INFORMATION THAT IS PROPRIETARY TO MOLEX INCORPORATED AND SHOULD NOT BE USED WITHOUT WRITTEN PERMISSION			
			ANGULAR ±1/2°		MATERIAL NO. N/A						
			DRAFT WHERE APPLICABLE MUST REMAIN WITHIN DIMENSIONS		SIZE C						

TAPE AND REEL SPECIFICATIONS FOR RIGHT ANGLE THRU HOLE KK 254 RPC

ASSEMBLY ITEM NO.	CKT. SIZE	EMBOSSED TAPE ITEM NO.	PARTS PER REEL	CARTON PART #	REELS/CARTON	PARTS PER CARTON	COVER TAPE ITEM NO.	TAKE-UP REEL ITEM NO.	DIM F	DIM W	DIM S	DIM C
171857-*002	2	70180-5472	300	085-01-0014	11	3300	43655-0012	70180-6511	11.50/.453	24.00/.945	N/A	25.60/1.008
171857-*003	3	70180-5473	300	085-01-0014	11	3300	43655-0012	70180-6511	11.50/.453	24.00/.945	N/A	25.60/1.008
171857-*004	4	70180-5474	300	085-01-0014	11	3300	43655-0012	70180-6511	11.50/.453	24.00/.945	N/A	25.60/1.008
171857-*005	5	70180-5475	300	085-01-0014	11	3300	43655-0012	70180-6511	11.50/.453	24.00/.945	N/A	25.60/1.008
171857-*006	6	70180-5476	300	085-01-0014	9	2700	43655-0001	70180-6512	14.20/.559	32.00/1.260	28.40/1.118	33.60/1.323
171857-*007	7	70180-5477	300	085-01-0014	9	2700	43655-0001	70180-6512	14.20/.559	32.00/1.260	28.40/1.118	33.60/1.323
171857-*008	8	70180-5478	300	085-01-0014	7	2100	43655-0002	70180-6513	20.20/.795	44.00/1.732	40.40/1.591	45.60/1.795
171857-*009	9	70180-5479	300	085-01-0014	7	2100	43655-0002	70180-6513	20.20/.795	44.00/1.732	40.40/1.591	45.60/1.795
171857-*010	10	70180-5480	300	085-01-0014	7	2100	43655-0002	70180-6513	20.20/.795	44.00/1.732	40.40/1.591	45.60/1.795
171857-*011	11	70180-5481	300	085-01-0014	7	2100	43655-0002	70180-6513	20.20/.795	44.00/1.732	40.40/1.591	45.60/1.795
171857-*012	12	70180-5482	300	085-01-0014	7	2100	43655-0002	70180-6513	20.20/.795	44.00/1.732	40.40/1.591	45.60/1.795

PULL OUT DIRECTION FROM REEL 

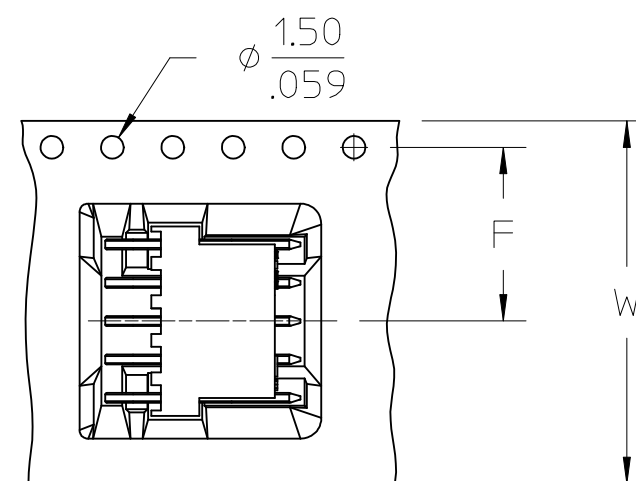
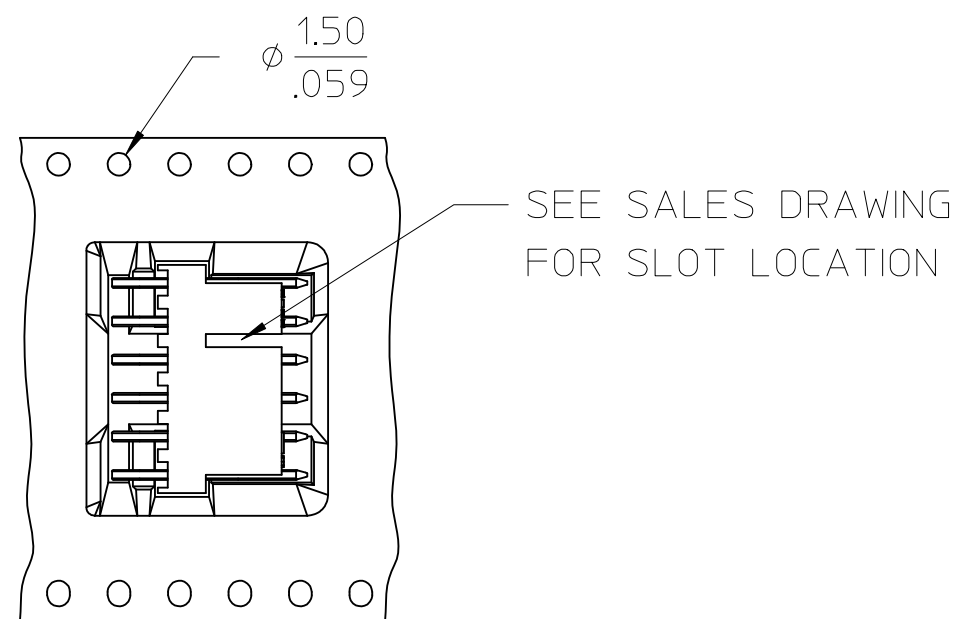

TYPICAL PART ORIENTATION FOR 2-5 CIRCUIT SIZES (24MM WIDE CARRIER TAPE)

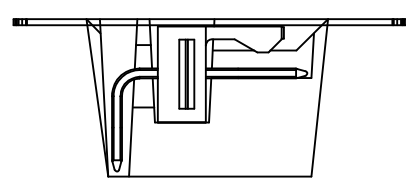

TYPICAL PART ORIENTATION FOR 6-12 CIRCUIT SIZES (32 AND 44MM WIDE CARRIER TAPE)

SEE SHEET 1 EC NO: UCP2015-2680 DRWN:MKIPPER 2015/01/06 CHKD:NGUYEN 2015/01/13 APPR:FSMITH 2015/01/15	REV DESCRIPTION A1	QUALITY SYMBOLS	GENERAL TOLERANCES (UNLESS SPECIFIED)	DIMENSION STYLE	SCALE	DESIGN UNITS	THIRD ANGLE PROJECTION																		
		$\nabla = 0$ $\nabla = 0$ $\nabla = 0$	<table border="1"> <tr><th colspan="2">mm</th><th>INCH</th></tr> <tr><td>4 PLACES</td><td>± ---</td><td>± ---</td></tr> <tr><td>3 PLACES</td><td>± ---</td><td>± ---</td></tr> <tr><td>2 PLACES</td><td>± ---</td><td>± ---</td></tr> <tr><td>1 PLACE</td><td>± ---</td><td>± ---</td></tr> <tr><td>0 PLACE</td><td>± ---</td><td>± ---</td></tr> </table>	mm		INCH	4 PLACES	± ---	± ---	3 PLACES	± ---	± ---	2 PLACES	± ---	± ---	1 PLACE	± ---	± ---	0 PLACE	± ---	± ---	MM/IN	---	METRIC	TITLE KK 254 RPC TAPE & REEL PK SPEC. FOR RIGHT ANGLE HEADER ASS'Y molex DOCUMENT NO. PK-171857-0001 SHEET NO. 2 OF 3
		mm		INCH																					
		4 PLACES	± ---	± ---																					
		3 PLACES	± ---	± ---																					
2 PLACES	± ---	± ---																							
1 PLACE	± ---	± ---																							
0 PLACE	± ---	± ---																							
	ANGULAR ±1/2°	DRAWN BY	DATE	TITLE																					
	DRAFT WHERE APPLICABLE MUST REMAIN WITHIN DIMENSIONS	MKIPPER	2014/02/21																						
		CHECKED BY	DATE																						
		JBELL	2014/02/24																						
		APPROVED BY	DATE																						
		FSMITH	2014/05/13																						
				MATERIAL NO.																					
				N/A																					
				SIZE	THIS DRAWING CONTAINS INFORMATION THAT IS PROPRIETARY TO MOLEX INCORPORATED AND SHOULD NOT BE USED WITHOUT WRITTEN PERMISSION																				
				C																					

PACKAGING FOR REELS OF PARTS PACKAGED IN 24mm WIDE TAPE

PACKAGING FOR REELS OF PARTS PACKAGED IN 32mm WIDE TAPE

PACKAGING FOR REELS OF PARTS PACKAGED IN 44mm WIDE TAPE

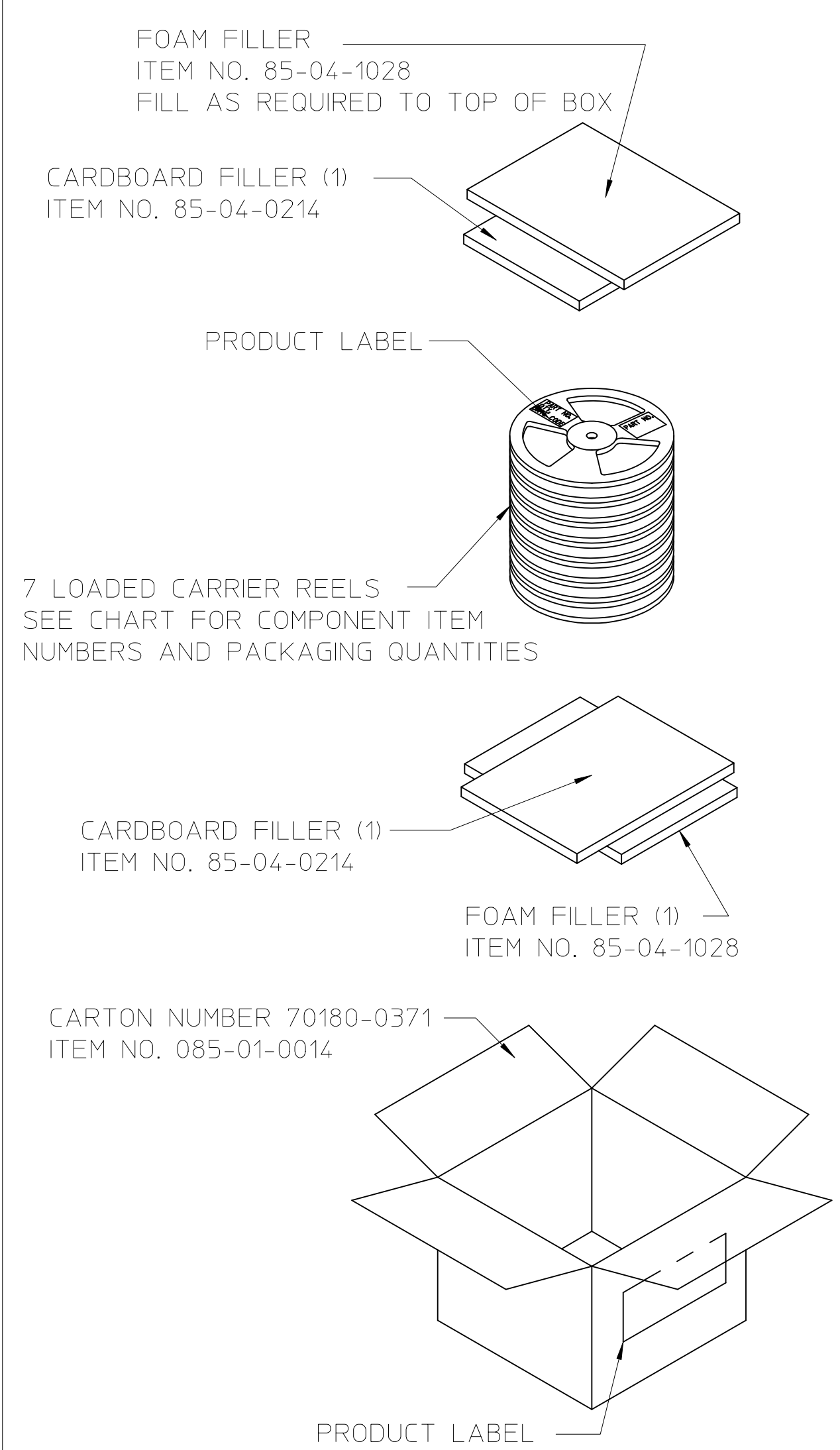
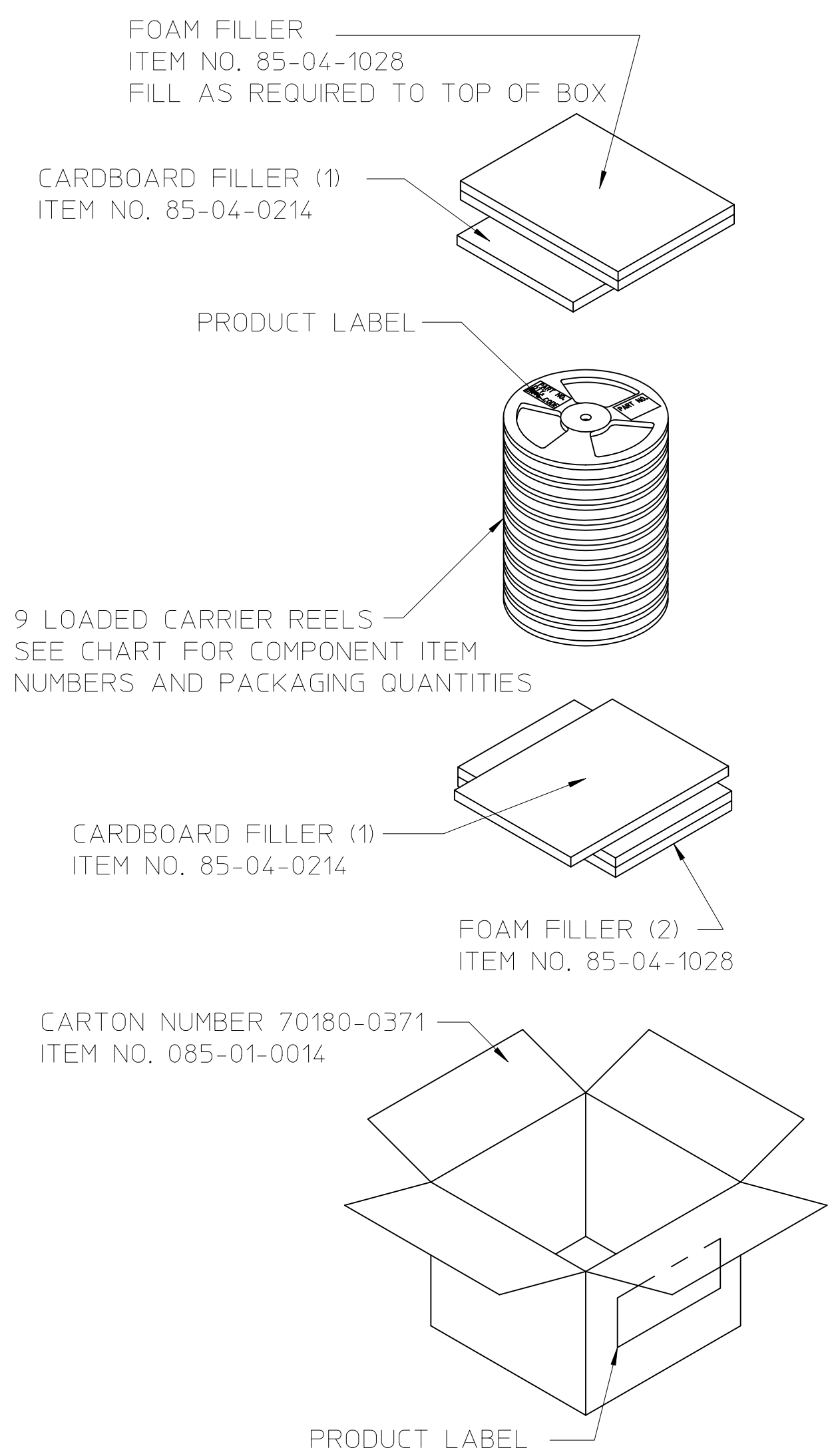
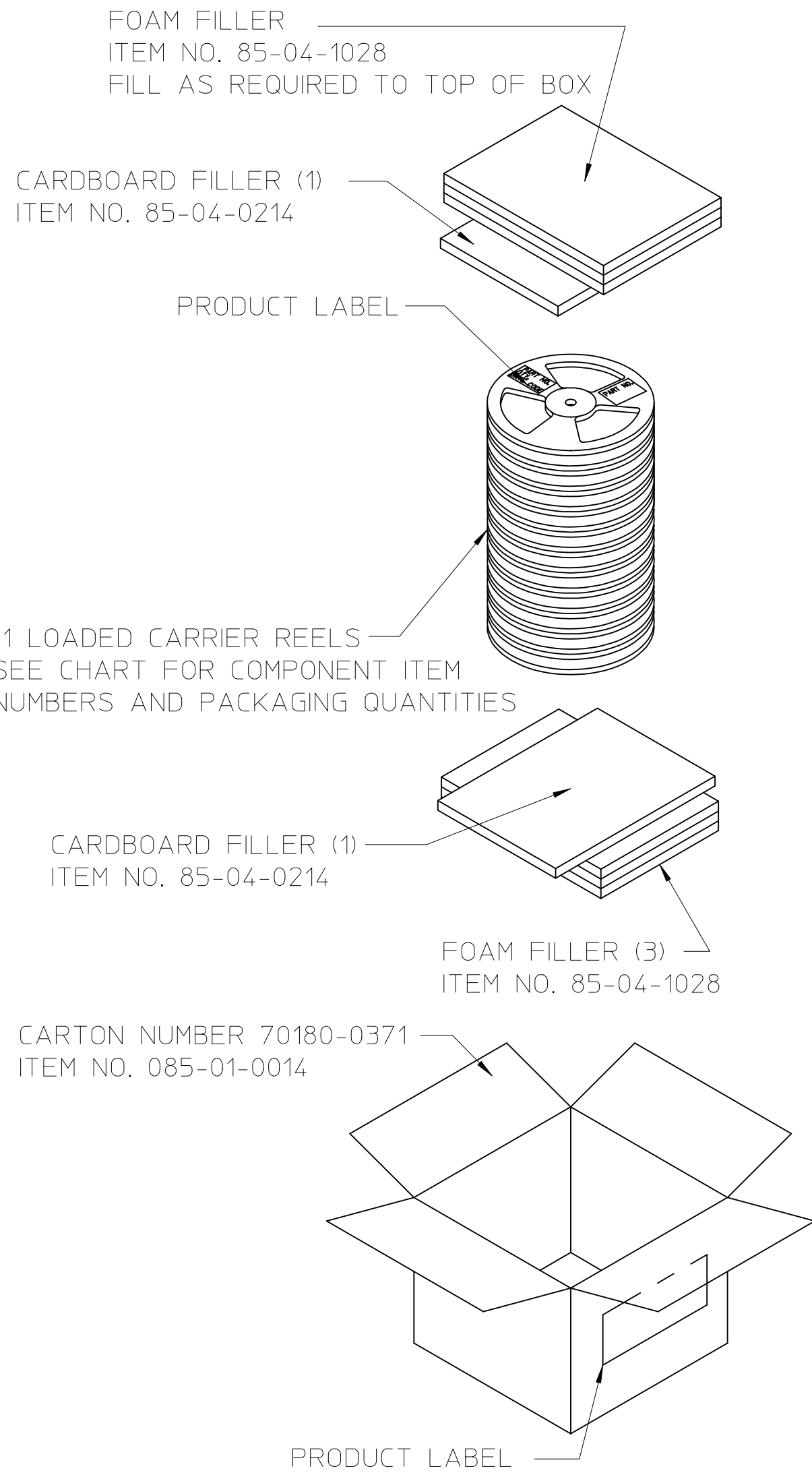

SEE SHEET 1 EC NO: UCP2015-2680 DRWN:MKIPPER 2015/01/06 CHKD:NGUYEN 2015/01/13 APPR:FSMITH 2015/01/15	QUALITY SYMBOLS	GENERAL TOLERANCES (UNLESS SPECIFIED)		DIMENSION STYLE	SCALE	DESIGN UNITS	THIRD ANGLE PROJECTION	
	$\nabla = 0$	mm	INCH	MM/IN	---	METRIC	DRAWN BY DATE	
	$\nabla = 0$	4 PLACES ± ---	± ---				MKIPPER 2014/02/21	
	$\nabla = 0$	3 PLACES ± ---	± ---				CHECKED BY DATE	
		2 PLACES ± ---	± ---				JBELL 2014/02/24	
	1 PLACE ± ---	± ---				APPROVED BY DATE		
	0 PLACE ± ---	± ---				FSMITH 2014/05/13		
		ANGULAR ±1/2°		MATERIAL NO.	DOCUMENT NO.		SHEET NO.	
		DRAFT WHERE APPLICABLE MUST REMAIN WITHIN DIMENSIONS		N/A	PK-171857-0001		3 OF 3	
A1		THIS DRAWING CONTAINS INFORMATION THAT IS PROPRIETARY TO MOLEX INCORPORATED AND SHOULD NOT BE USED WITHOUT WRITTEN PERMISSION						