

REV.	ECN NO.	DESCRIPTION	SIGN	DATE
C1	N/A	INITIAL DRAWING	Victory	2019/08/23

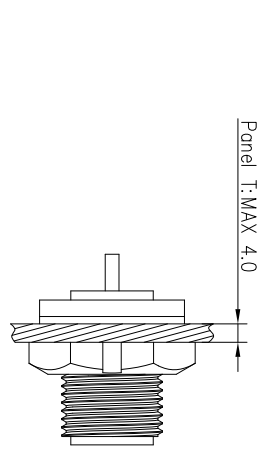
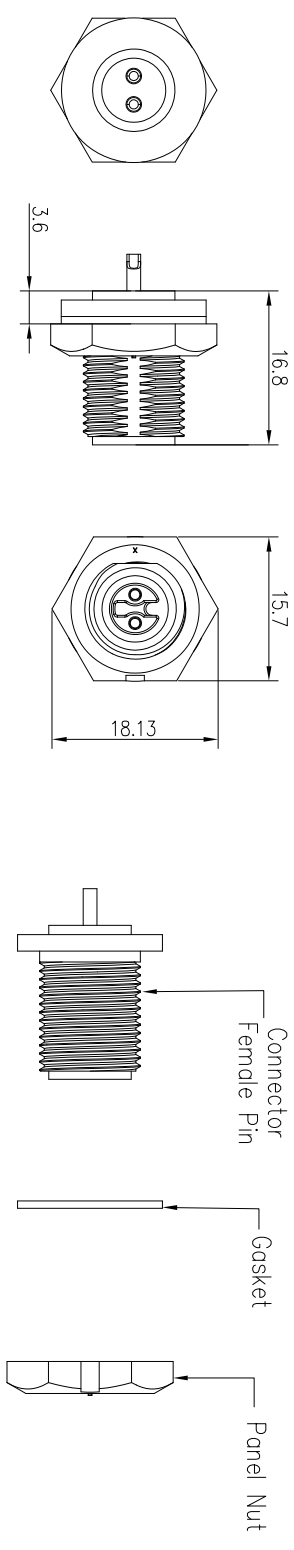
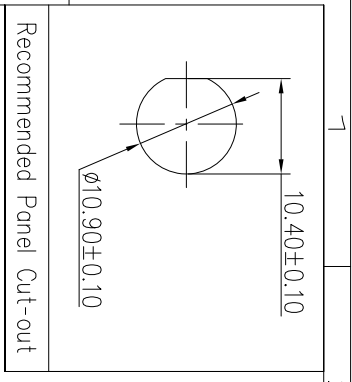

21XXX615-01
Pin Number

Pin	P/N: 21002615-01	P/N: 21003615-01	P/N: 21004615-01
2 Pin			

Pin Assignments Front View

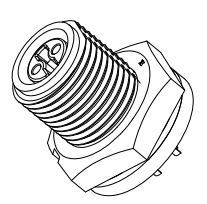

- Specification:
1. Operation Temperature: -45°C~105°C.
 2. Insulation Resistance: 100MΩ at DC 500V.
 3. Contact Resistance: <10mΩ.
 4. Withstand Voltage: 1500V AC.
 5. Operating Current: 5A.
 6. Operating Voltage: AC 110V.
 7. Waterproof Rate: IP67(Mated).
 8. Connector: Nylon+GF, Black.
 9. Panel Nut: Nylon, Black.
 10. Gasket: Silicon, Gray.
 11. Female Pin: Copper Alloy, Gold Plated.
 12. Torque Rate: 0.5~0.7N • m.
 13. RoHS Compliant.
 14. UL Compliant.
 15. Mating Cap P/N: 806-00028-00

UNIT: mm			DESCRIPTION	Mini Series Screw Type Front Mount With Female Pin
TOLERANCE	X	±0.25	SCALE	4:5
.XX	±0.15		REV	C1
.XXX	±0.05		SIZE	A4
ANGLES	±1°		SHEET	1 OF 1
			* : Inspection Item	

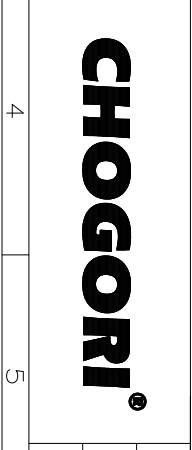

PART NO	21XXX615-01	DRAWN BY	Victory	DATE	2019/08/23
DWG NO		CHECKED BY	Ivan	DATE	2019/08/23
CUSTOMER		APPROVED BY	Ponson	DATE	2019/08/23