

PCB LAYOUT: COMPONENT SIDE 4 TO 8 CKT
RECOMMEND PCB THICKNESS: 1.57mm

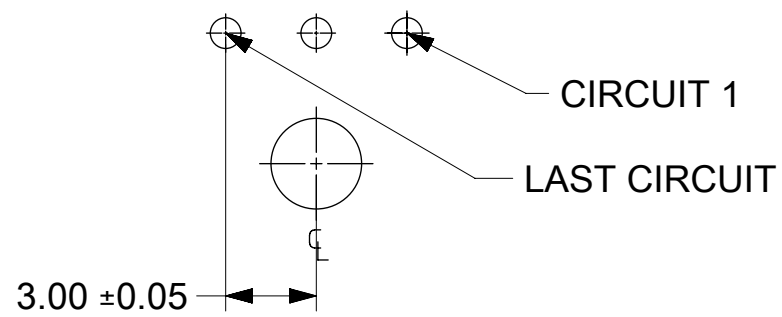

PCB LAYOUT: 3 CKT HEADER

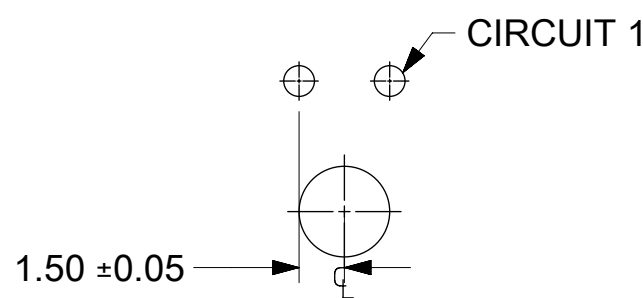

PCB LAYOUT: 2 CKT HEADER

TIN PLATING					
CIRCUIT	PART NUMBER	A	B	C	D
2	215760-1002	6.85	3.00	NA	2.95
3	215760-1003	9.85	6.00	NA	2.95
4	215760-1004	12.85	9.00	4.70	7.70
5	215760-1005	15.85	12.00	7.70	10.70
6	215760-1006	18.85	15.00	10.70	13.70
7	215760-1007	21.85	18.00	13.70	16.70
8	215760-1008	24.85	21.00	16.70	19.70

15 MICROINCH GOLD					
CIRCUIT	PART NUMBER	A	B	C	D
2	215760-2002	6.85	3.00	NA	2.95
3	215760-2003	9.85	6.00	NA	2.95
4	215760-2004	12.85	9.00	4.70	7.70
5	215760-2005	15.85	12.00	7.70	10.70
6	215760-2006	18.85	15.00	10.70	13.70
7	215760-2007	21.85	18.00	13.70	16.70
8	215760-2008	24.85	21.00	16.70	19.70

30 MICROINCH GOLD					
CIRCUIT	PART NUMBER	A	B	C	D
2	215760-3002	6.85	3.00	NA	2.95
3	215760-3003	9.85	6.00	NA	2.95
4	215760-3004	12.85	9.00	4.70	7.70
5	215760-3005	15.85	12.00	7.70	10.70
6	215760-3006	18.85	15.00	10.70	13.70
7	215760-3007	21.85	18.00	13.70	16.70
8	215760-3008	24.85	21.00	16.70	19.70

LEGEND

215760 - * * * *

SERIES NO. _____

PLATING OPTION
 1 :TIN
 2: 15MICROINCH AU
 3. 30MICROINCH AU

CKT NO. _____

NOTES:

- HOSING MATERIAL: GLASS FILLED LIQUID CRYSTAL POLYMER, UL 94V-0, GLOW WIRE ,COLOR: BLACK
TERMINAL MATERIAL: HIGH COPPER ALLOY
- FINISH:
OPTION 1: REFLOW MATTE TIN OVER NICKEL
OPTION 2: SELECT 15MICROINCH GOLD AND SELECT MATTE TIN OVER NICKEL.
OPTION 3: SELECT 30MICROINCH GOLD AND SELECT MATTE TIN OVER NICKEL.
- PRODUCT SPECIFICATION : 2064600000-PS
- PRODUCT TEST SUMMARY: 2157590005-TS
- TRAY PACK : 2157600002-PK
- MATE WITH RECEPTACLE 215759
- THIS PART CONFORMS TO CLASS 'B' REQUIREMENTS OF COSMETIC SPECIFICATION PS-45499-002.

THIS DRAWING CONTAINS INFORMATION THAT IS PROPRIETARY TO MOLEX ELECTRONIC TECHNOLOGIES, LLC AND SHOULD NOT BE USED WITHOUT WRITTEN PERMISSION												
FUNCTIONAL SYMBOLS	DIMENSION UNITS	SCALE	CURRENT REV DESC:									
$\nabla_A = 0$	mm	5:1	<p>EC NO: 691178 DRWN: ZIXUAQ 2022/01/06 CHK'D: XQZHANG 2022/01/19 APPR: XQZHANG 2022/01/19</p> <p>INITIAL REVISION: DRWN: HPAN18 2020/10/15 APPR: YXZHENG 2021/02/08</p>									
$\nabla_C = 0$	GENERAL TOLERANCES (UNLESS SPECIFIED)											
$\nabla_P = 0$	ANGULAR TOL ± °											
DIVISIONAL SYMBOLS	4 PLACES ±											
	3 PLACES ±		PRODUCT CUSTOMER DRAWING									
	2 PLACES ± 0.25		DOCUMENT NUMBER			DOC TYPE	DOC PART	REVISION				
	1 PLACE ± 0.36		2157600003-SD			PSD	000	A2				
	0 PLACES ±		MATERIAL NUMBER			CUSTOMER			SHEET NUMBER			
DRAFT WHERE APPLICABLE MUST REMAIN WITHIN DIMENSIONS		THIRD ANGLE PROJECTION	DRAWING	SERIES	MATERIAL NUMBER		CUSTOMER		SHEET NUMBER			
			C-SIZE	215760	SEE NOTES		GENERAL MARKET		1 OF 1			