



Copyright FCI.

A

B

C

D

1

2

3

4

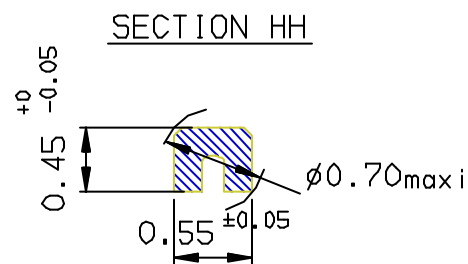
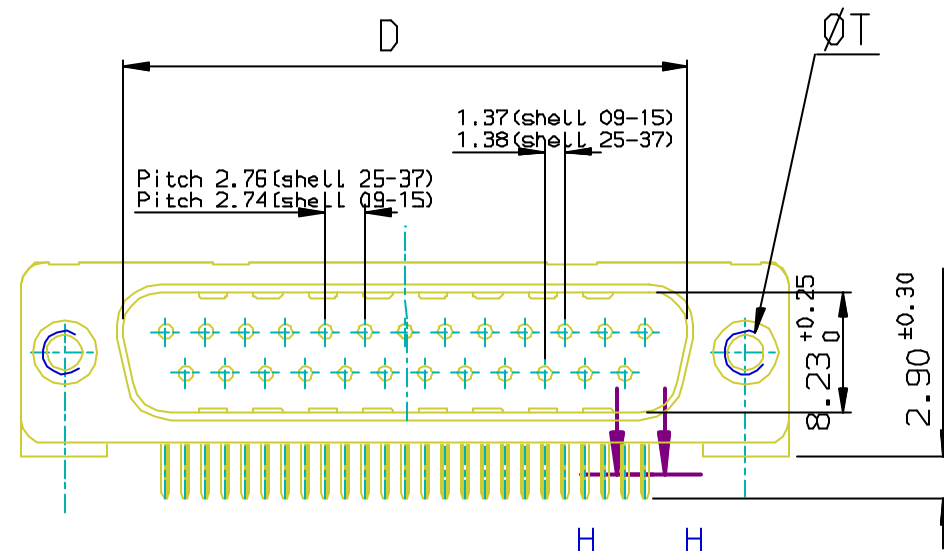
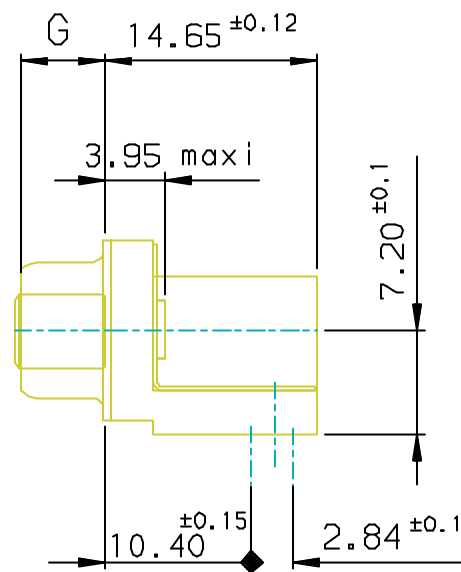
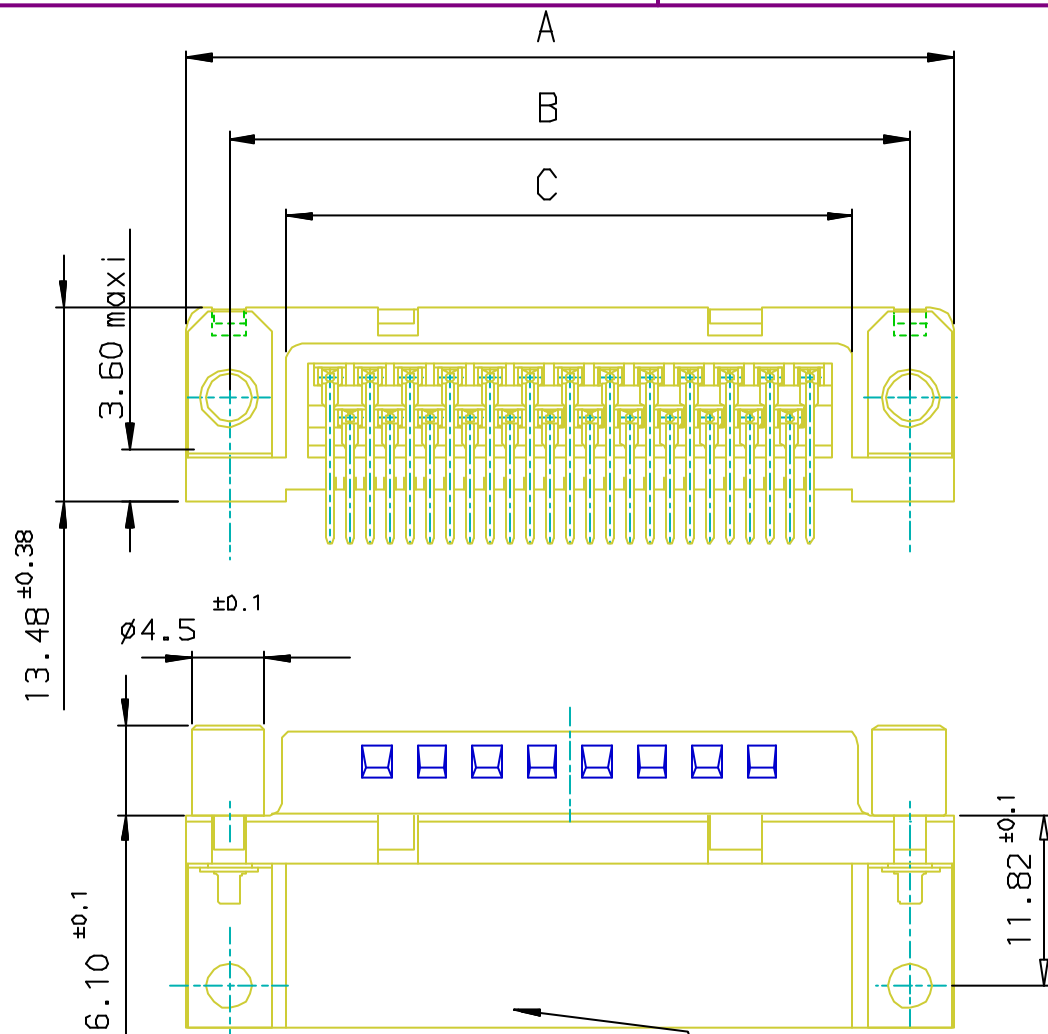

PC card drilling dimensions (after plating)  
(thickness 1.60 ± 0.20 mm)

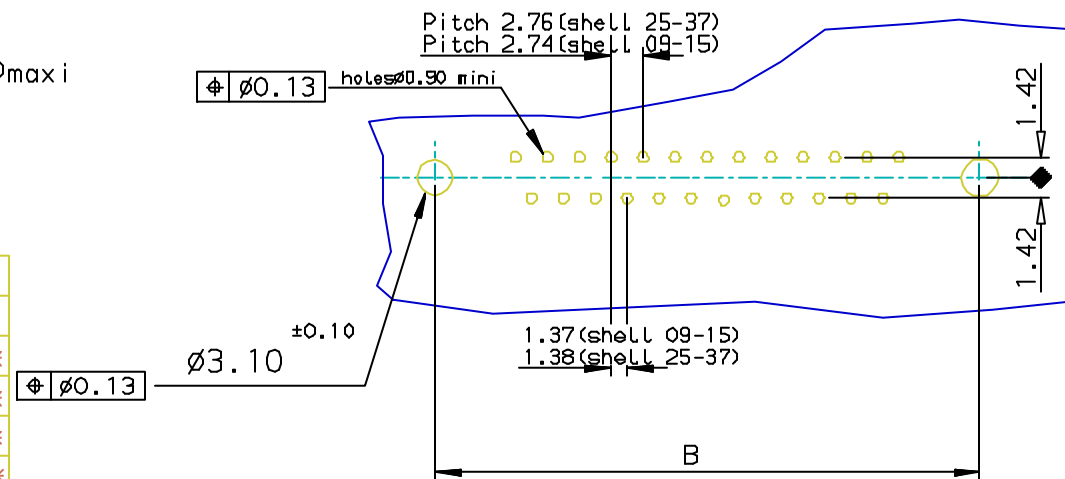

Part Number & Date Code Printing

SHELL	A ±0.38	B ±0.12	C ±0.10	D ±0.25	G ±0.25	Plating: 0.76 µ AU	Plating: Flash AU
09	30.81	24.99	16.96	16.79	5.90	D09P23A6U*00**	D09P23A4U*00**
15	39.14	33.32	25.18	25.12	5.90	D15P23A6U*00**	D15P23A4U*00**
25	53.03	47.04	39.12	38.84	5.70	D25P23A6U*00**	D25P23A4U*00**
37	69.32	63.50	55.68	55.30	5.70	D37P23A6U*00**	D37P23A4U*00**

**REQUIREMENTS**

**Technical characteristics:**

Shell: steel tin / Zinc Cr3 plated  
 Insulators: self-extinguishing black polyster, UL class 94V0  
 Contacts size 20, brass, gold on mating end, bright tin on termination end over nickel on entire contact  
 Cycles :500 for protection 6  
 :200 for protection 4

Metal plate for electrical continuity: brass, tin/Zinc Cr3 plated  
 Screw: brass, tin/Zinc Cr3 plated torque: 0.5N/m

**Electrical characteristics:**

max. current rating: 5A  
 Test voltage: 1000V  
 Rated voltage: 300V  
 Contact resistance: <15mΩ  
 Shell resistance: <5mΩ  
 Insulation resistance: >5000MΩ

**Climatic characteristics:**

Operating temperature range: -55°C +125°C

**Dimensions:**

in accordance with MIL-C-24308

Threaded ØT M3 = I  
 Threaded ØT 4.40 = V  
 LF FOR LEAD FREE

FOR ROHS DETAILS REFER DWG.N0: C01-8646-0000

European Views

rev	ecn no	dr	date
B	105-0124	JS	2005/07/27
C	106-0074	SK	2006/06/08
-	-	-	-
-	-	-	-
-	-	-	-
-	-	-	-

www.fciconnect.com		surface ISO 1302 ✓	tolerance std ISO 406 ISO 1101	projection mm
TOLERANCES UNLESS OTHERWISE SPECIFIED				
Dr	JOHN SLEEBA	1996/08/29	ANGULAR	0.X ±0.1
Eng	GEORGE VJ	1996/08/29	LINEAR	0.XX ±0.1
Chr	GEORGE VJ	2005/07/27	0.XX* ±1*	0.XXX ±0.1
Appr	KVSD	2005/07/27	Product family	D-SUB Spec ref -
FCI		title MALE CONNECT.DELTA D RIGHT ANGLE WITH SCREW ,HARPOON & METAL PLATE.		Rev. C
catalog no		DELTA-D		dwg no C01-8646-0735
		CUSTOMER		sheet 1 of 1

REV F - 2006-04-17

1

2

3

4