

# Customer Information Sheet

DRAWING No.: P25-0822

SHEET 2 OF 2

IF IN DOUBT - ASK

©

NOT TO SCALE

THIRD ANGLE PROJECTION

ALL DIMENSIONS IN mm

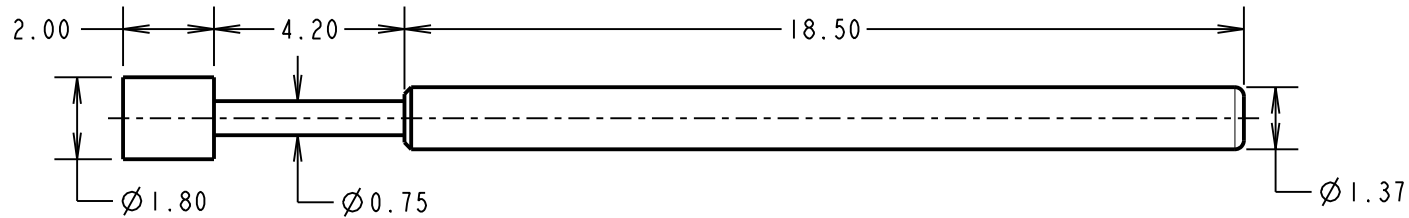

**NOTES:**

1. TO BE USED WITH SLEEVE S25-XX2.
2. SUITABLE FOR A MINIMUM DISTANCE BETWEEN CENTRES OF 2.54mm.

**SPECIFICATIONS:**

**MATERIAL:**

- PLUNGER = BERYLLIUM COPPER
- BARREL = BRASS
- SPRING = STAINLESS STEEL

**FINISH:**

- PLUNGER AND BARREL = GOLD

**ELECTRICAL:**

- CURRENT RATING = 3A
- CONTACT RESISTANCE = 50mΩ MAX AT 2/3 TRAVEL

**MECHANICAL:**

- DURABILITY = 100,000 MIN CYCLES
- FULL TRAVEL = 4.20mm
- SPRING FORCES:
  - AT FULL TRAVEL = 1.47N ± 0.29N (150g ± 20%)
  - AT 2/3 TRAVEL = 1.13N ± 0.23N (115g ± 20%)

**ENVIRONMENTAL:**

- OPERATING TEMPERATURE = -40°C TO +180°C

MSP	6	21.07.17	20124
NAME	ISS.	DATE	C/NOTE
APPROVED:		M.PERREN	
CHECKED:		M.PLESTED	
DRAWN:		W.J.BOURNE	
CUSTOMER REF.:			
ASSEMBLY DRG:			

**HARWIN**

www.harwin.com  
technical@harwin.com

THIS DRAWING AND ANY INFORMATION OR DESCRIPTIVE MATTER SET OUT HEREON ARE CONFIDENTIAL AND COPYRIGHT PROPERTY OF THE HARWIN GROUP AND MUST NOT BE DISCLOSED, LOANED, COPIED OR USED FOR MANUFACTURING, TENDERING OR FOR ANY OTHER PURPOSE WITHOUT THEIR WRITTEN PERMISSION.

**TOLERANCES**

- X. = ±1mm
- X.X = ±0.50mm
- X.XX = ±0.10mm
- X.XXX = ±0.01mm
- ANGLES = ±5°
- UNLESS STATED

**MATERIAL:**

SEE ABOVE

**FINISH:**

SEE ABOVE

**S/AREA:**

mm<sup>2</sup>

**TITLE:**

2.54mm MIN. CENTRE  
TWO-PIECE SPRING PROBE

**DRAWING NUMBER:**

P25-0822

SHT  
2 OF 2