

# "High Frequency Ceramic Solutions"

## 967/1795 MHz Diplexer

Detail Specification

P/N 0967DP18A1795

Rev 11/13/01 Page 1 of 2

Part Number	Frequency (MHz)	Attenuation Low Band	Attenuation High Band	Return Loss
0967DP18A1795_	954 - 980	0.75 dB max.	20 dB min.	12 dB min.
	1710 - 1880	20 dB min.	0.55 dB max.	12 dB min.

Input Power	Impedance	Operating Temperature Range	Reel Qty
3 Watts max	50 Ω	-40 to +85°C	3000

### Mechanical Dimensions

	L	W	T	a	b	c	g	p
Inches	0.126 ± .006	0.064 ± .006	0.034 ± .004	0.022 ± .006	0.014 ± .006	0.012 + .004/-0.008	0.016 ± .006	0.039 ± .004
mm	3.2 ± 0.15	1.6 ± 0.15	0.85 ± 0.1	0.55 ± 0.15	0.35 ± 0.15	0.3+0.1/-0.2	0.4 ± 0.15	1.0 ± 0.1

### Terminal Configuration

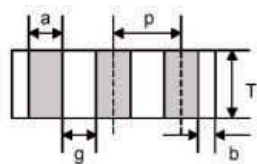
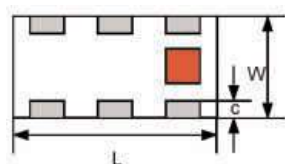

No.	Function	No.	Function
1	Low Band Port (P2)	4	GND
2	GND	5	Common Port (P3)
3	High Band Port (P1)	6	GND

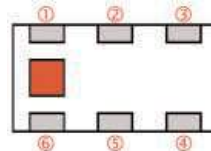

### Mounting Considerations

Mount these devices with brown colored side facing up. Line width should be designed to provide 50Ω impedance matching characteristics.

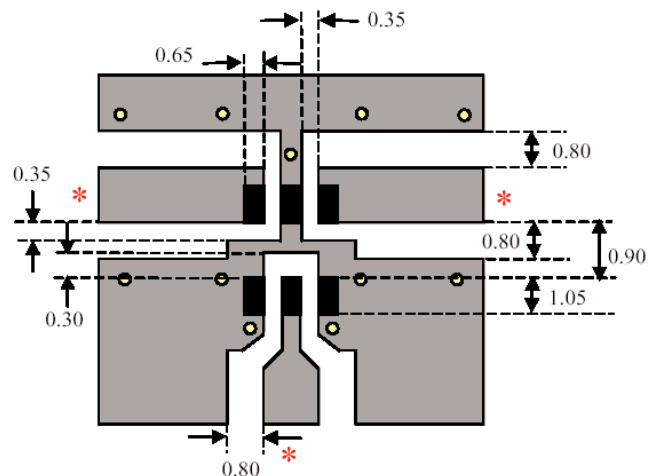

- Solder Resist
- Land
- Through-hole (φ 0.3)

*Johanson Technology, Inc. reserves the right to make design changes without notice.  
All sales are subject to Johanson Technology, Inc. terms and conditions.*

# “High Frequency Ceramic Solutions”

## 967/1795 MHz Diplexer

Detail Specification

P/N 0967DP18A1795

Rev 11/13/01 Page 2 of 2

